

Traffic Control Plan STAGE II

Refer to Standard 701321 for additional signs, details & devices

City
of
Geneseo

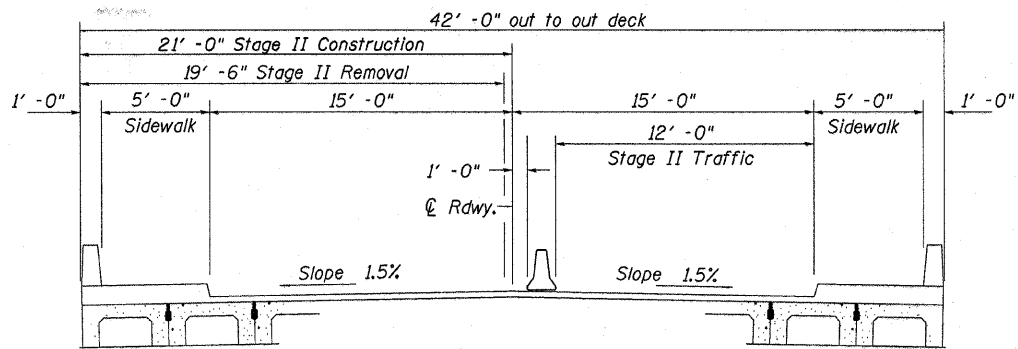

CROSS SECTION
Looking East

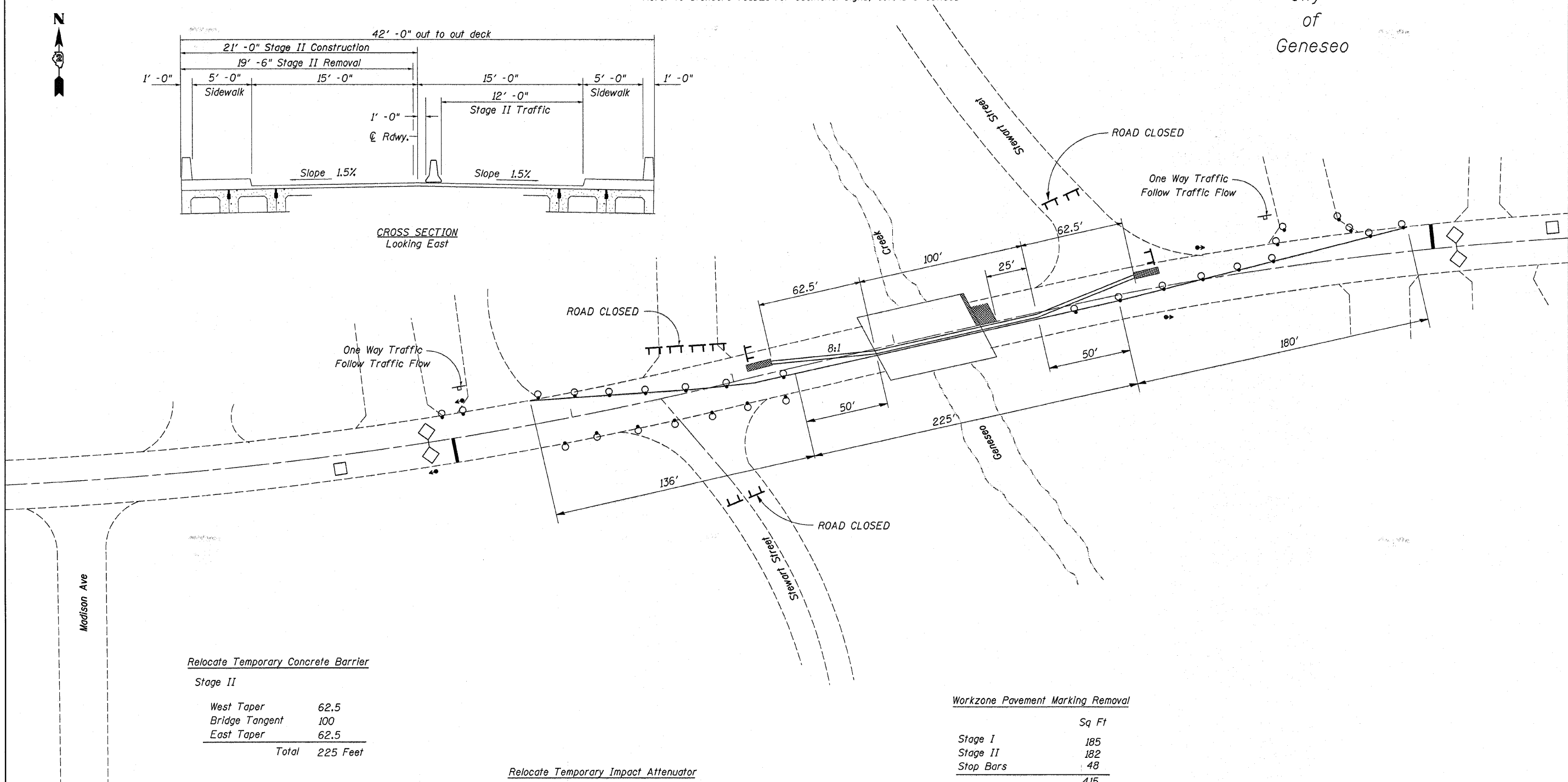

Relocate Temporary Concrete Barrier

Stage II

West Taper	62.5
Bridge Tangent	100
East Taper	62.5
Total	225 Feet

Relocate Temporary Impact Attenuator

Stage II	Each
West	1
East	1
Total	2 Each

Workzone Pavement Marking Removal

	Sq Ft
Stage I	185
Stage II	182
Stop Bars	48
Total	415

Note: Reduce sign spacing to 200' where the speed limit is 30 MPH.

FILE NAME =	USER NAME = lirkdj	DESIGNED -	REVISED -	STATE OF ILLINOIS DEPARTMENT OF TRANSPORTATION	Traffic Control Plan Stage II		F.A.U. RTE.	SECTION	COUNTY	TOTAL SHEETS	SHEET NO.	
D:\BRVCADD plans\Henry County\0370133\Pl\A1eng.dgn	DRAWN -	REVISED -	REVISED -		5671	(4B-1)R-M	Henry	13	5			
PLOT SCALE = 3/8" = 1' IN.	CHECKED -	REVISED -	REVISED -		CONTRACT NO. 64F97							
PLOT DATE = Tue Jan 19 09:26:26 2010	DATE -	REVISED -	REVISED -		ILLINOIS FED. AID PROJECT							
					SCALE: _____	SHEET NO. _____	OF _____ SHEETS	STA. _____	TO STA. _____			