

STATE OF ILLINOIS  
DEPARTMENT OF TRANSPORTATION

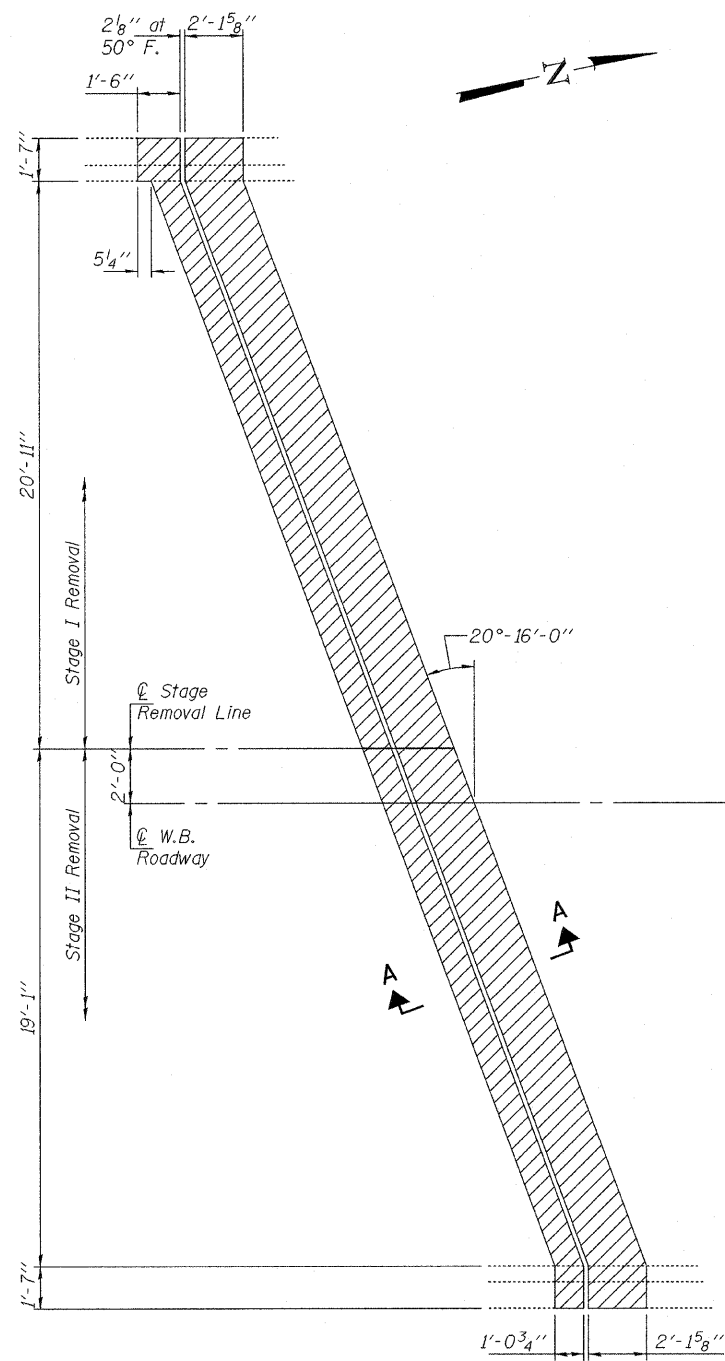

**REMOVAL PLAN**  
South Abutment

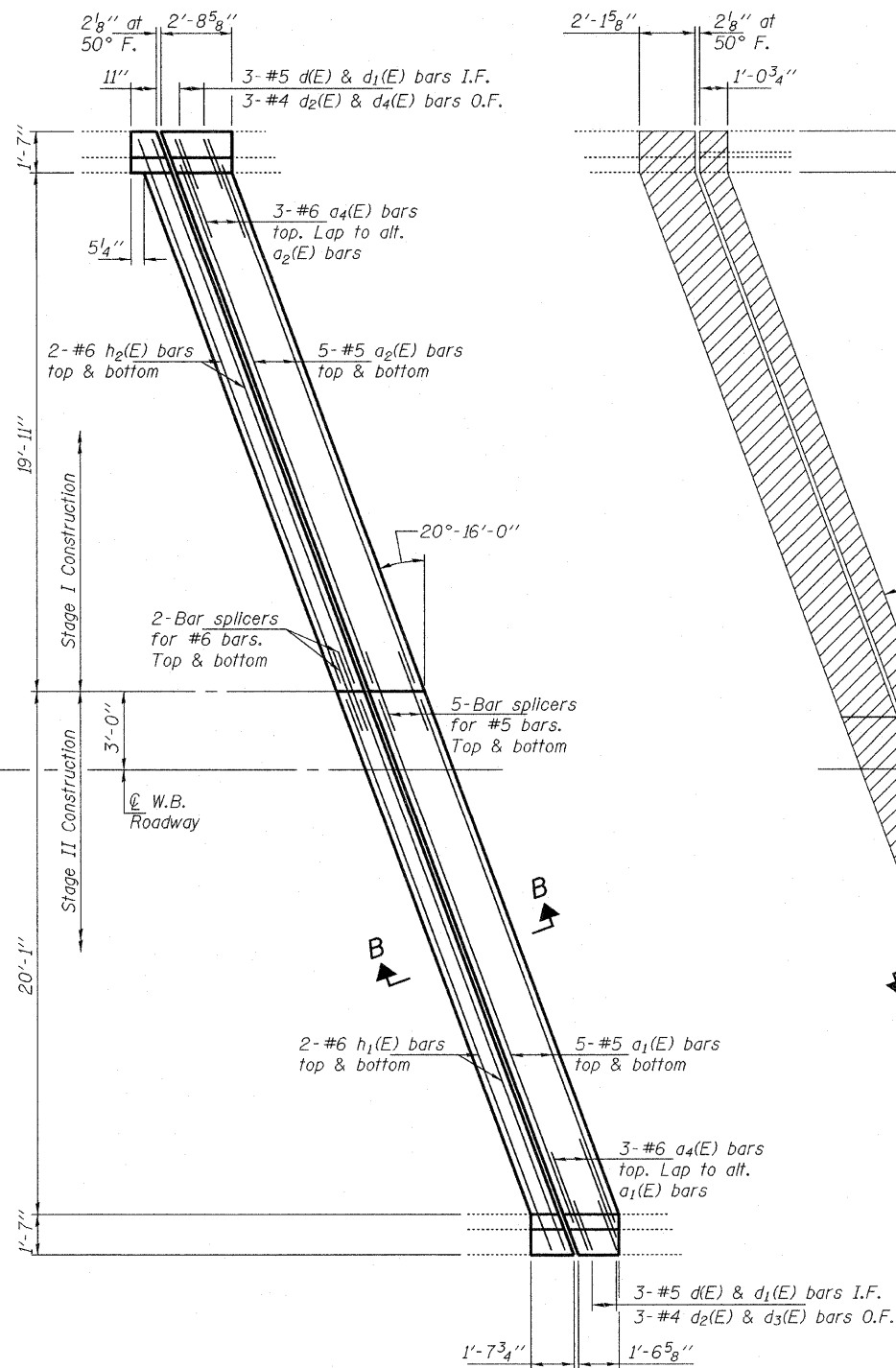

**REPLACEMENT PLAN**  
South Abutment

Notes:  
Hatched areas indicate removal.  
For Sections A-A & B-B, bar details and  
Bill of Material, see sheet 4 of 7.

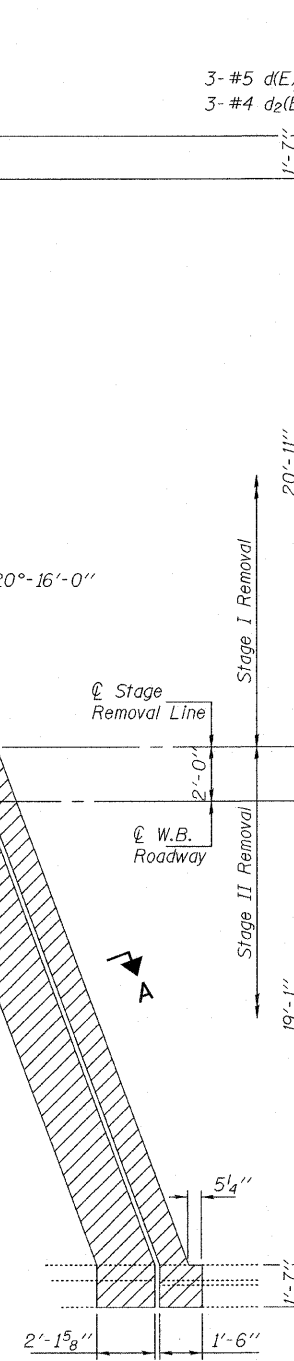

**REMOVAL PLAN**  
North Abutment

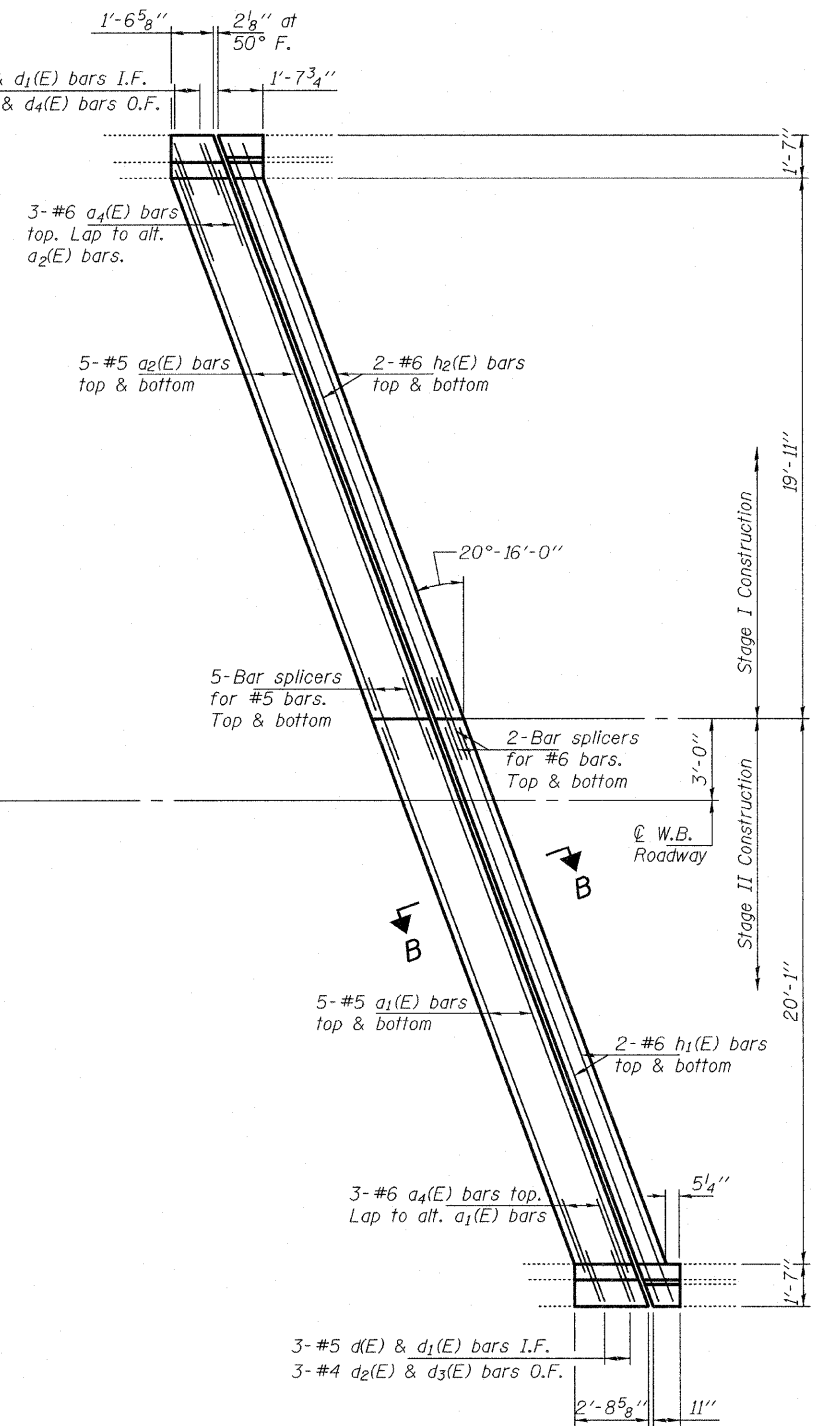

**REPLACEMENT PLAN**  
North Abutment

**JOINT REPLACEMENT DETAILS**  
SN 101-0068 (W.B.)

DESIGNED	IJL
CHECKED	ATH
DRAWN	Kyle M. Steffen
CHECKED	IJL ATH

MARCH 9, 2010  
EXAMINED *A. Carl Pomeroy*  
ENGINEER OF STRUCTURAL SERVICES  
PASSED *Ralph E. Anderson*  
ENGINEER OF BRIDGES AND STRUCTURES

SHEET NO. 3	F.A.I. RTE.	SECTION	COUNTY	TOTAL SHEETS	SHEET NO.
	39	(4VBY, 4VBY-1, 5HB)M	WINNEBAGO	36	19
7 SHEETS	CONTRACT NO. 64G12				
FED. ROAD DIST. NO.		ILLINOIS FED. AID PROJECT			