

STATE OF ILLINOIS
DEPARTMENT OF TRANSPORTATION

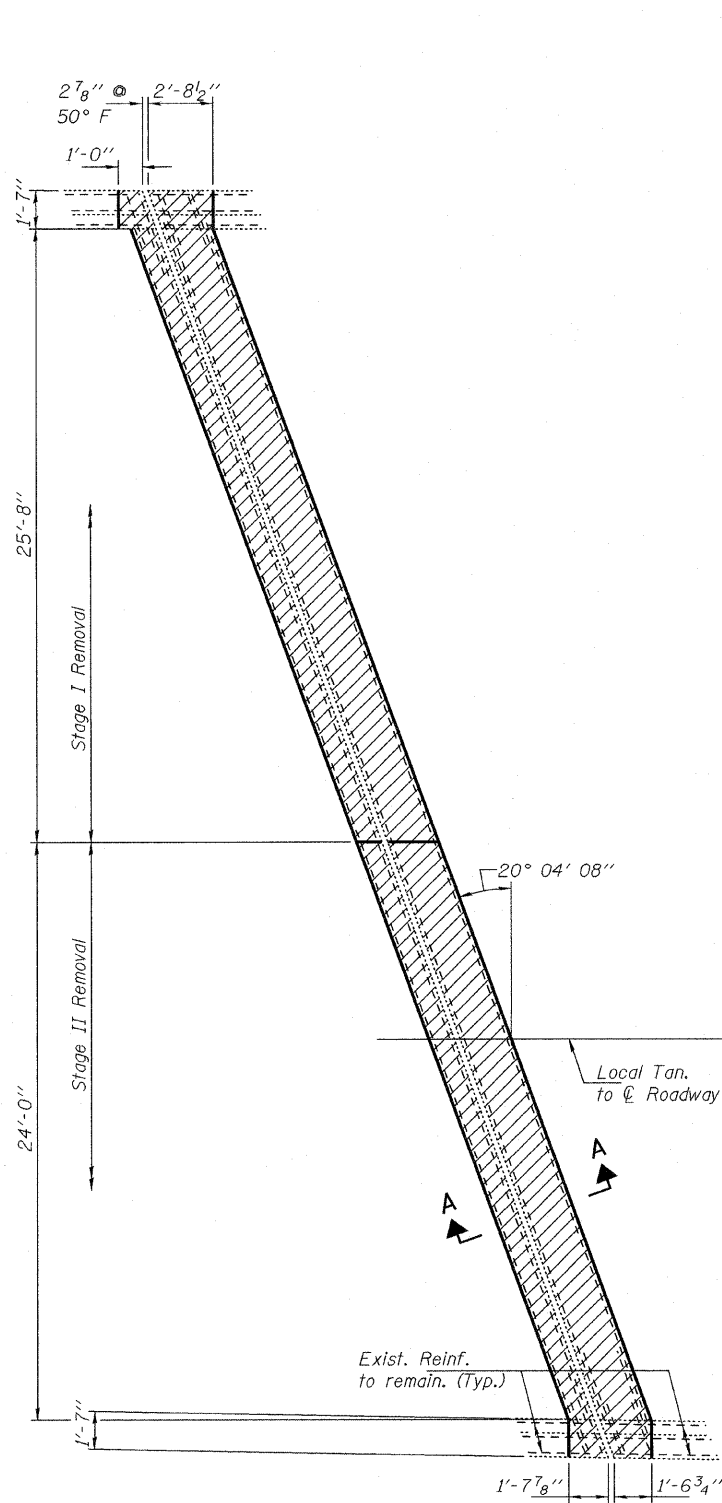

REMOVAL PLAN
South Abutment

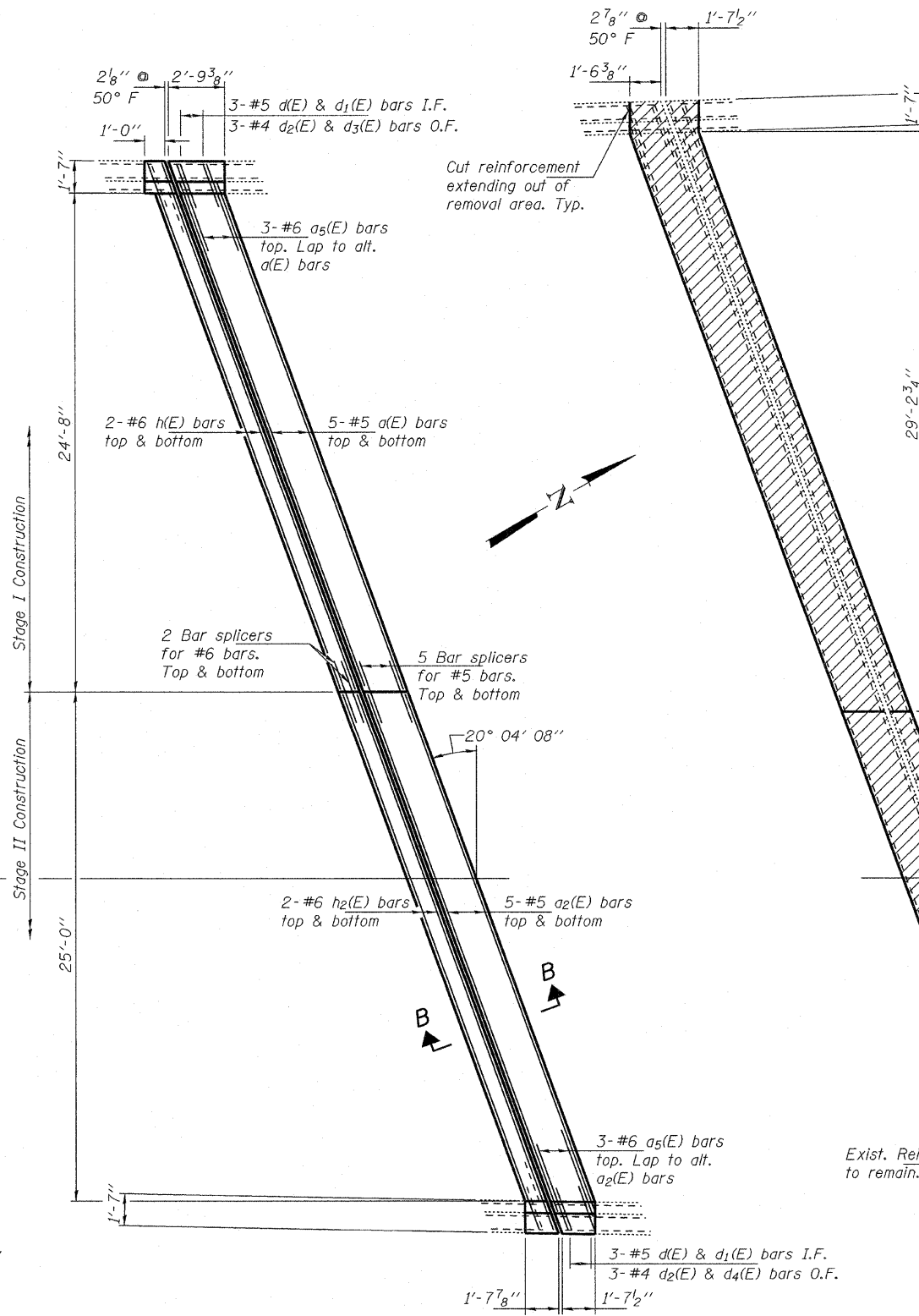

REPLACEMENT PLAN
South Abutment

Notes:
Hatched areas indicate removal.
Cut a(E) thru a2(E) & h(E) thru h2(E) bars as required.
For Sections A-A & B-B, bar details and Bill of Material, see sheet 4 of 7.

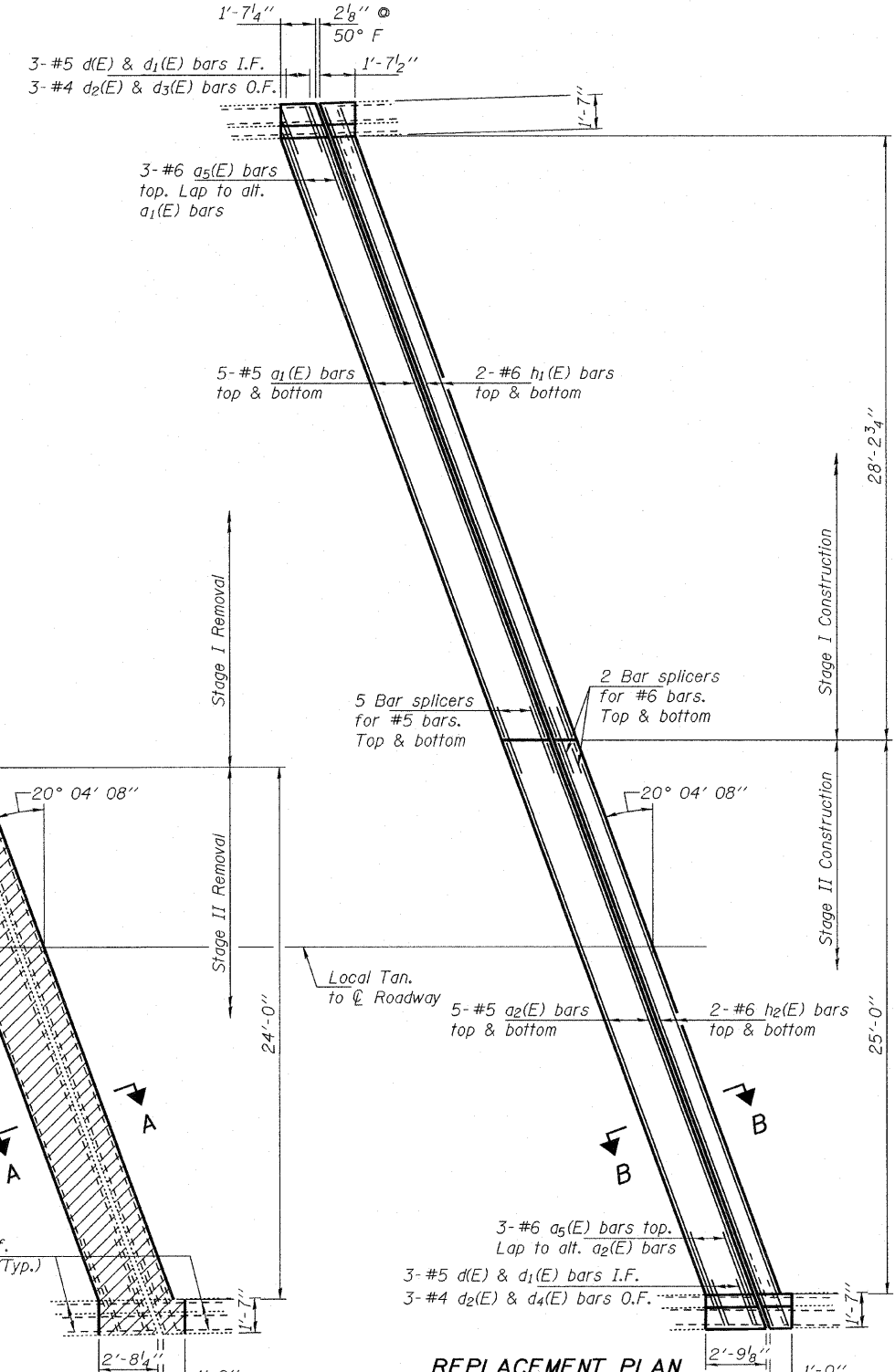

REMOVAL PLAN
North Abutment

REPLACEMENT PLAN
North Abutment

JOINT REPLACEMENT DETAILS
FAI 39 OVER HARRISON AVE.
SN 101-0072

DESIGNED	IJL
CHECKED	ATH
DRAWN	baliva
CHECKED	IJL ATH

MARCH 9, 2010
EXAMINED *A. Carl Pover*
ENGINEER OF STRUCTURAL SERVICES
PASSED *Ralph E. Anderson*
ENGINEER OF BRIDGES AND STRUCTURES

SHEET NO. 2	F.A.I. RTE.	SECTION	COUNTY	TOTAL SHEETS	SHEET NO.
	39	(4VBY,4VBY-1,5HB)M	WINNEBAGO	36	31
7 SHEETS	CONTRACT NO. 64G12				
FED. ROAD DIST. NO.		ILLINOIS FED. AID PROJECT			