

F. A. S. S. NO.	SECTION	COUNTY	TOTAL SHEETS	SHEET NO.
317	36 BR	IROQUOIS	21	20

STA. 1250+85 TO STA. 1252+50
 FED. ROAD DIST. NO. ILLINOIS FED. AID PROJECT

CONTRACT NO. 66171

FINAL SURVEY	DATE
SURVEYED	
PLOTTED	
NOTE BOOK	
AREAS CHECKED	
NO.	

ORIGINAL SURVEY	DATE
SURVEYED	
PLOTTED	
NOTE BOOK	
AREAS CHECKED	
NO.	

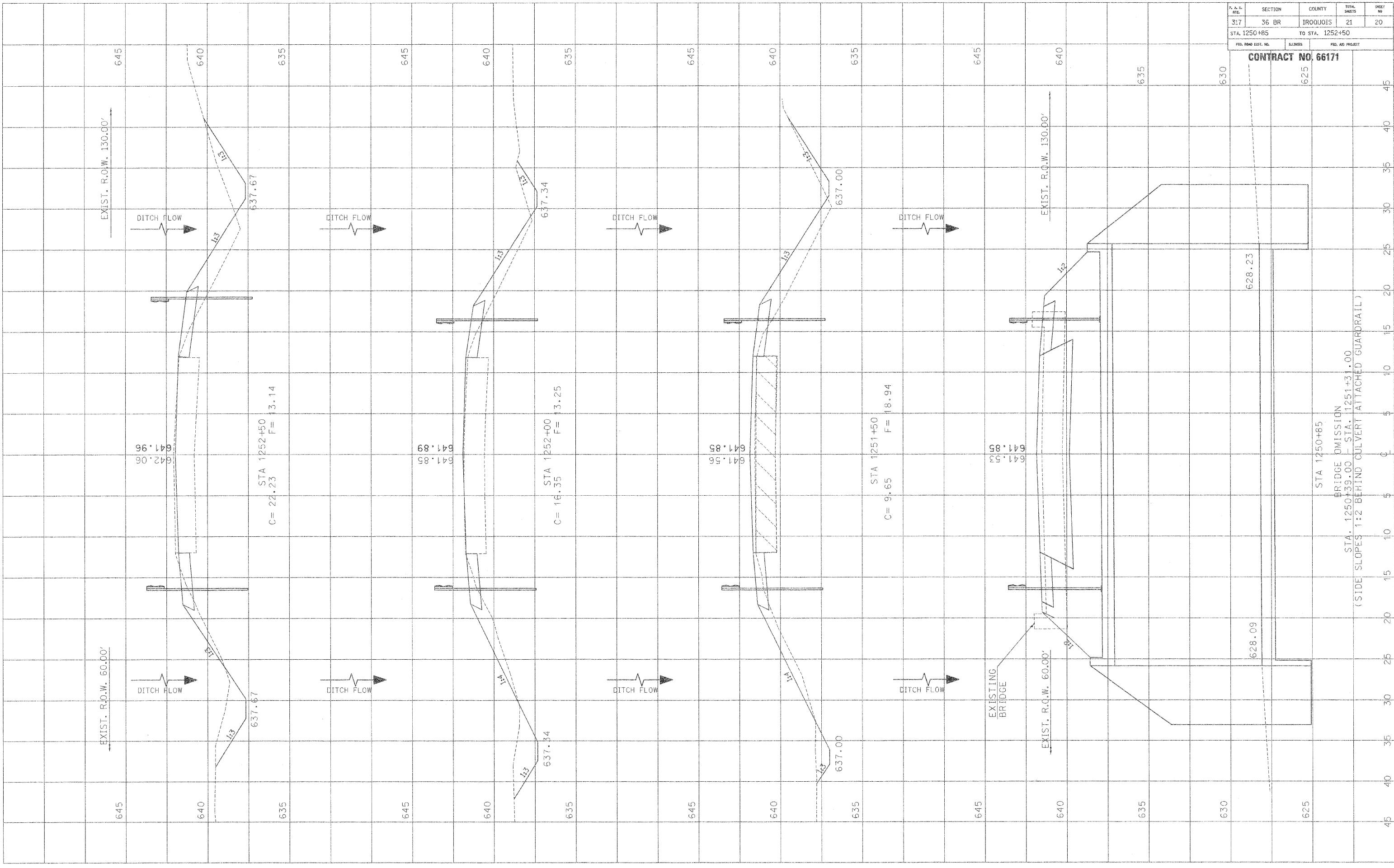

STA 1250+85
 BRIDGE OMISSION
 STA. 1250+39.00 - STA. 1251+31.00
 (SIDE SLOPES 1:2 BEHIND CULVERT ATTACHED GUARDRAIL)

628.09

628.23

EXISTING BRIDGE
 EXIST. R.O.W. 60.00'

EXIST. R.O.W. 130.00'

DITCH FLOW

DITCH FLOW

DITCH FLOW

DITCH FLOW

DITCH FLOW

DITCH FLOW

DITCH FLOW

DITCH FLOW

EXIST. R.O.W. 60.00'

EXIST. R.O.W. 130.00'

STA 1252+50
 C= 22.23 F= 13.14

STA 1252+00
 C= 16.35 F= 13.25

STA 1251+50
 C= 9.65 F= 18.94