

F.A.I. RTE.	SECTION	COUNTY	TOTAL SHEETS	SHEET NO.
80	(50-3)HBK	LASALLE	492	75
STA. 124+50.00		TO STA. 136+67.35		
FED. ROAD DIST. NO.		ILLINOIS	FED. AID PROJECT	

PIONEER HYBRID INTERNATIONAL, INC.

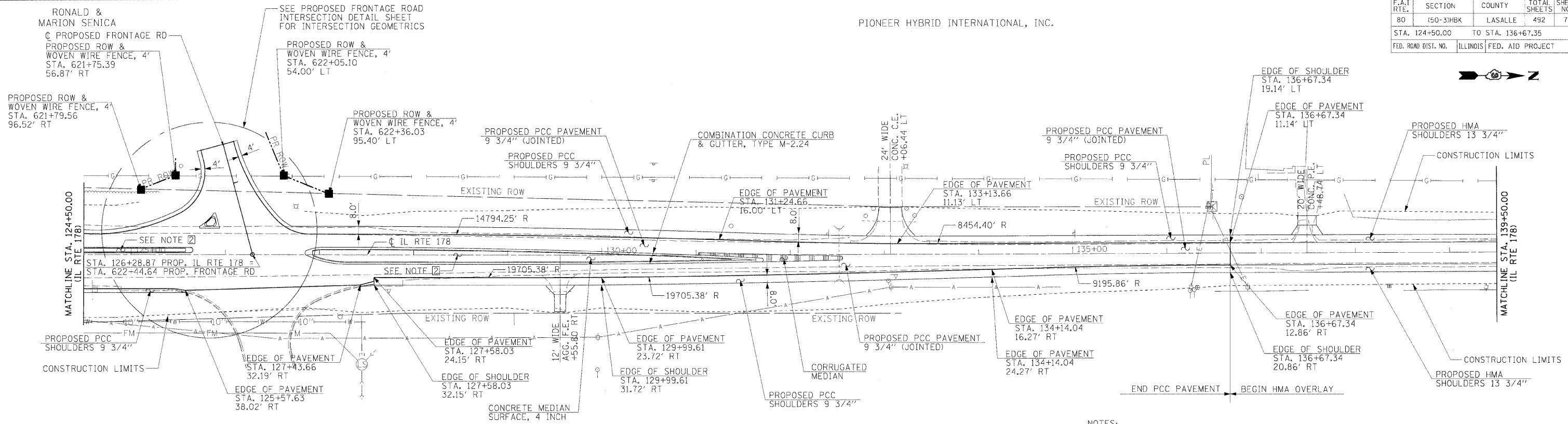

DATE	BY	REVISION

HANSON
 Professional Services Inc.
 Springfield, Illinois 62709-2886
 Offices Nationwide

DATE	BY	REVISION

MODEL NAME = IL_Rte_178_Sht_4
 PLOT DATE = 12/23/2009
 FILE NAME = C:\PW\Export\VC-701\JOB\AN.dgn
 PLOT SCALE = 50.0000 / in.
 USER NAME = John00944

LAYOUT	MEW	05/16/06
DRAWN	MEW	05/16/06
REVIEWED	RAC	08/31/06

JANUS & PETER FERRACUTTI

MICHAEL WELSH (LIVING TRUST)

NOTE: SEE DRAINAGE & UTILITIES SHEETS FOR ADDITIONAL DRAINAGE INFORMATION

- NOTES:
- SEE ENTRANCE DETAIL SHEET FOR ADDITIONAL GEOMETRICS OF ENTRANCES.
 - SEE IL RTE 178 PROPOSED MEDIAN DETAIL FOR THE GEOMETRICS OF MEDIAN ALONG IL RTE 178.

