

F.A.I. RTE.	SECTION	COUNTY	TOTAL SHEETS	SHEET NO.
80	(50-3)HBK	LASALLE	492	83
STA. 10+00.00		TO STA. 18+25.33		
FED. ROAD DIST. NO.		ILL. NOTES	FED. AID PROJECT	

DATE	BY	REVISION

**HANSON**  
 Hanson Professional Services Inc.  
 1111 S. Illinois St., Suite 100  
 Springfield, Illinois 62703-2886  
 Spring Offices Nationwide

DATE	BY	REVISION

MODEL NAME = Temporary Ramp L  
 PLOT DATE = 12/23/2019  
 FILE NAME = C:\PWA\Exp\AC-707\_TR.dgn  
 PLOT SCALE = 50/0.0000 / in.  
 USER NAME = John@0944

LAYOUT	RSJ	01/19/06
DRAWN	RSJ	01/19/06
REVIEWED	RJC	08/31/06

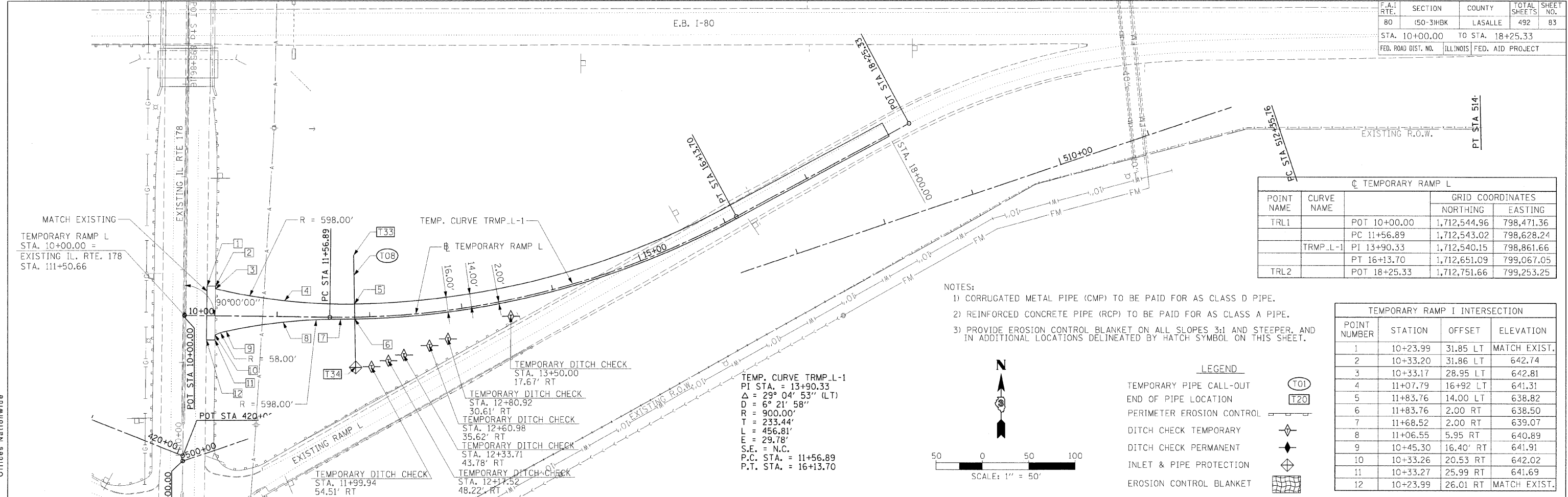

TEMPORARY RAMP L				
POINT NAME	CURVE NAME	GRID COORDINATES		
		NORTHING	EASTING	
TRL1	POT 10+00.00	1,712,544.96	798,471.36	
	PC 11+56.89	1,712,543.02	798,628.24	
	PI 13+90.33	1,712,540.15	798,861.66	
	PT 16+13.70	1,712,651.09	799,067.05	
TRL2	POT 18+25.33	1,712,751.66	799,253.25	

- NOTES:
- 1) CORRUGATED METAL PIPE (CMP) TO BE PAID FOR AS CLASS D PIPE.
  - 2) REINFORCED CONCRETE PIPE (RCP) TO BE PAID FOR AS CLASS A PIPE.
  - 3) PROVIDE EROSION CONTROL BLANKET ON ALL SLOPES 3:1 AND STEEPER, AND IN ADDITIONAL LOCATIONS DELINEATED BY HATCH SYMBOL ON THIS SHEET.

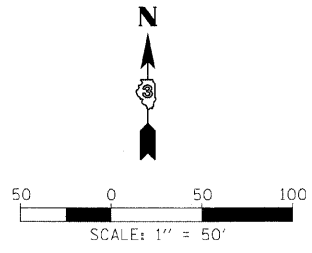

LEGEND

- TEMPORARY PIPE CALL-OUT (Symbol: circle with T01)
- END OF PIPE LOCATION (Symbol: circle with T20)
- PERIMETER EROSION CONTROL (Symbol: diamond with cross)
- DITCH CHECK TEMPORARY (Symbol: diamond with cross)
- DITCH CHECK PERMANENT (Symbol: diamond with cross)
- INLET & PIPE PROTECTION (Symbol: diamond with cross)
- EROSION CONTROL BLANKET (Symbol: hatched area)

TEMPORARY RAMP I INTERSECTION			
POINT NUMBER	STATION	OFFSET	ELEVATION
1	10+23.99	31.85 LT	MATCH EXIST.
2	10+33.20	31.86 LT	642.74
3	10+33.17	28.95 LT	642.81
4	11+07.79	16+92 LT	641.31
5	11+83.76	14.00 LT	638.82
6	11+83.76	2.00 RT	638.50
7	11+68.52	2.00 RT	639.07
8	11+06.55	5.95 RT	640.89
9	10+45.30	16.40' RT	641.91
10	10+33.26	20.53 RT	642.02
11	10+33.27	25.99 RT	641.69
12	10+23.99	26.01 RT	MATCH EXIST.

