

F.A.I. RTE.	SECTION	COUNTY	TOTAL SHEETS	SHEET NO.
80	150-31HBK	LASALLE	492	150
STA.		TO STA.		
FED. ROAD DIST. NO.		ILLINOIS FED. AID PROJECT		

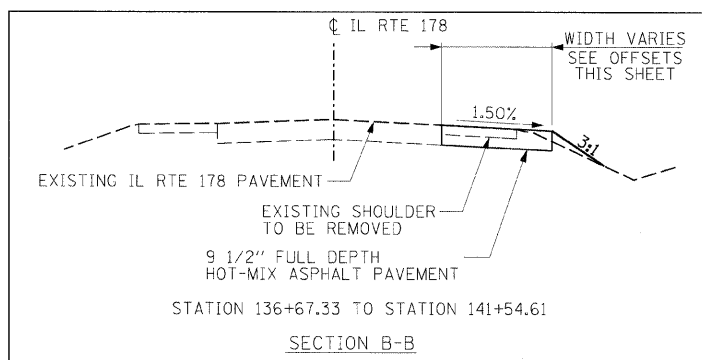
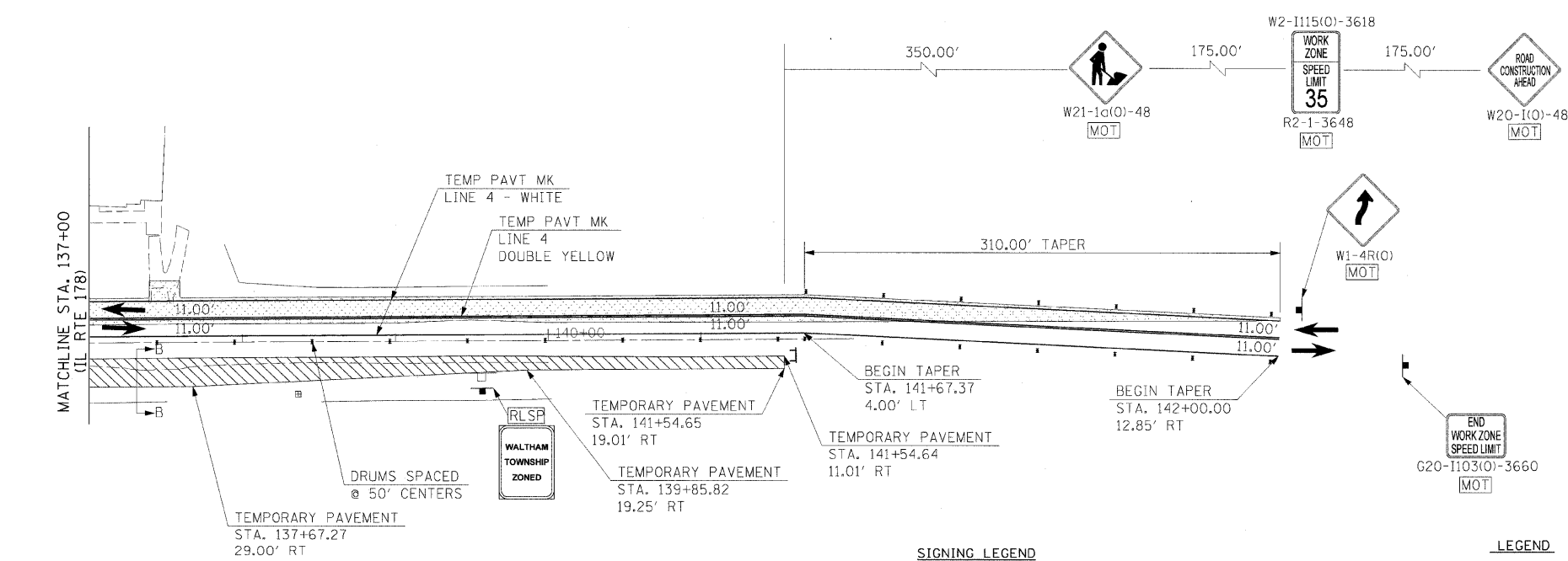
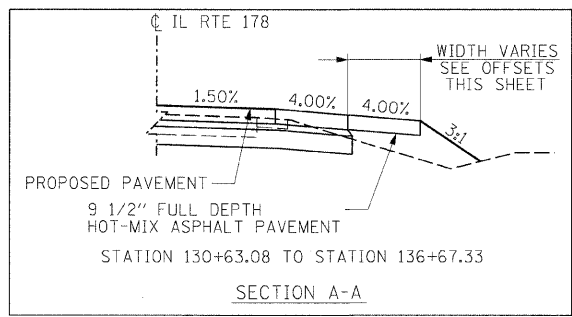
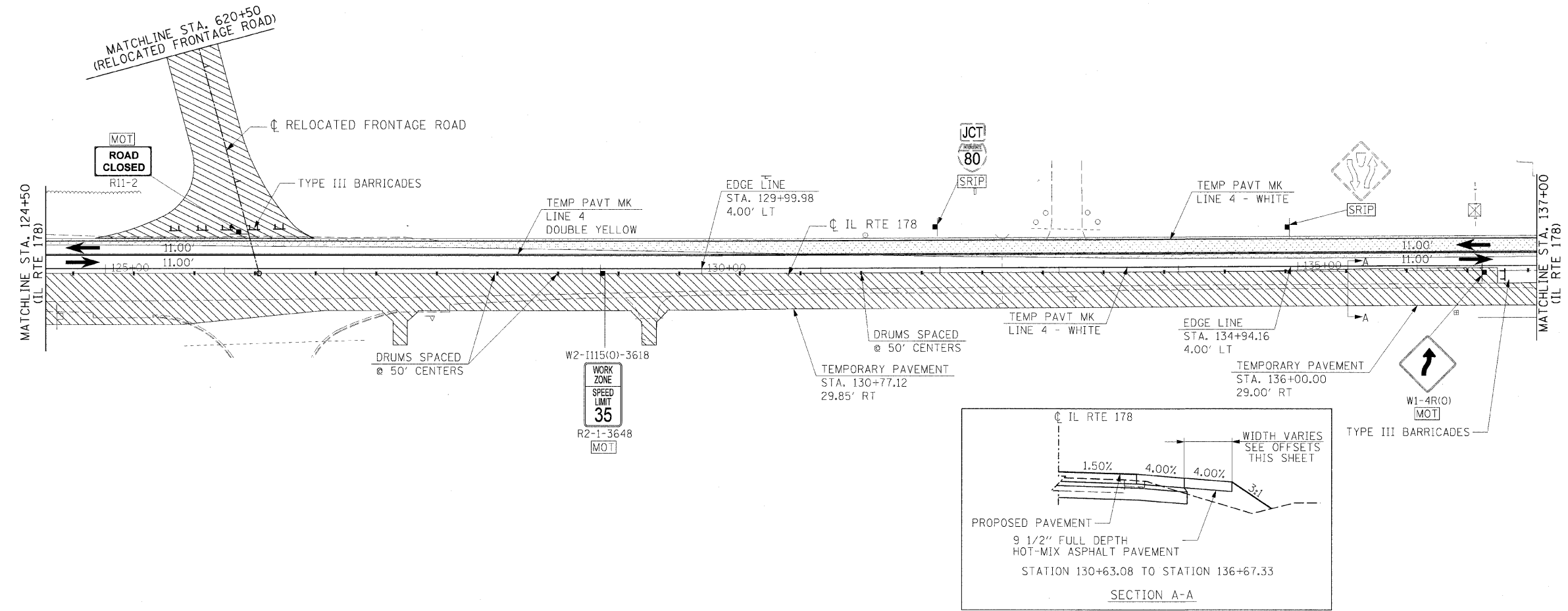

**SIGNING LEGEND**

- [RSPA] REMOVE SIGN PANEL ASSEMBLY (AT END OF STAGE)
- [RSP] REMOVE SIGN PANEL (AT END OF STAGE)
- [RLSP] RELOCATE SIGN PANEL
- [RLSPA] RELOCATE SIGN PANEL ASSEMBLY
- [SRIP] SIGN TO REMAIN IN PLACE
- [TAS] TEMPORARY ACCESS SIGNS
- [MOT] SIGNS TO BE PAID FOR THROUGH TRAFFIC CONTROL STANDARDS

**LEGEND**

- [Hatched Box] CONSTRUCTION AREA
- [Dotted Box] TEMPORARY PAVEMENT
- [Square with X] DRUMS OR TYPE II BARRICADES
- [Arrow] TRAFFIC FLOW
- [Line with Dash] TEMPORARY CONCRETE BARRIER
- [T-shaped] TYPE III BARRICADES
- [Square] SIGN

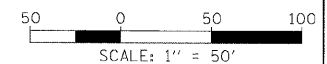

REVISIONS	
NAME	DATE

ILLINOIS DEPARTMENT OF TRANSPORTATION

MAINTENANCE OF TRAFFIC  
STAGE 1 PHASE I  
SHEET 6 OF 12

SCALE: VERT. N/A  
HORIZ. 1"=50'

DATE: \_\_\_\_\_

DRAWN BY: \_\_\_\_\_  
CHECKED BY: \_\_\_\_\_

**HANSON**  
Hanson Professional Services Inc.  
1525 South Sixth Street  
Springfield, Illinois 62703-2888  
Offices Nationwide

MODEL NAME = 5.1 Phase 1 Sht. 6  
PLOT DATE = 12/23/2009 AC-101C.S1.dgn  
PLOT SCALE = 50.0000 1/1  
USER NAME = John@09/14

LAYOUT	MEW	DATE