

F.A.I. RTE.	SECTION	COUNTY	TOTAL SHEETS	SHEET NO.
80	(50-3)H8K	LASALLE	492	175
STA.		TO STA.		
FED. ROAD DIST. NO.		ILLINOIS FED. AID PROJECT		

NOTES:

1. DETOUR TO BE USED DURING STAGE 2 PHASE I RECONSTRUCTION OF IL RTE 178 OVERHEAD STRUCTURE DURING BEAM REMOVAL AND BEAM REPLACEMENT.
2. ALL STOP AHEAD AND STOP SIGNS ON TEMPORARY RAMP K & J AND EXISTING IL. RTE. 178 THAT CONFLICT WITH FLAGGERS TRAFFIC CONTROL SHALL BE TAKEN DOWN OR COVERED DURING THIS PERIOD.
3. ALL FLAGGERS AT EACH RESPECTIVE INTERSECTION SHALL BE IN SIGHT OF EACH OTHER AND BE IN DIRECT COMMUNICATIONS AT ALL TIMES.
4. ALL SIGNS ARE TO BE REMOVED AT THE COMPLETION OF THE OPERATION AND EXISTING SIGNING RESTORED TO ITS EXISTING CONDITION.
5. SIGNS MAY BE ADJUSTED TO FIT CONDITIONS.



LEGEND

- AREAS OF CONSTRUCTION FOR THIS STAGE
- TRAFFIC FLOW FOR THIS STAGE
- LOCATION OF FLAGGERS CONTROLLING TRAFFIC W/ LIGHT STATION

© Copyright Hanson Professional Services Inc. 2009
HANSON
 Hanson Professional Services Inc.
 1525 South Sixth Street
 Springfield, Illinois 62703-2886
 Offices Nationwide

MODEL NAME = DETOUR
 PLOT DATE = 10/23/2009
 DRAWN BY = RSJ
 REVIEWED BY = MTM
 USER NAME = JohnM09044

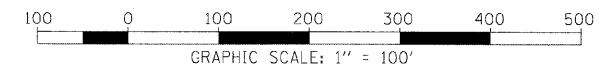
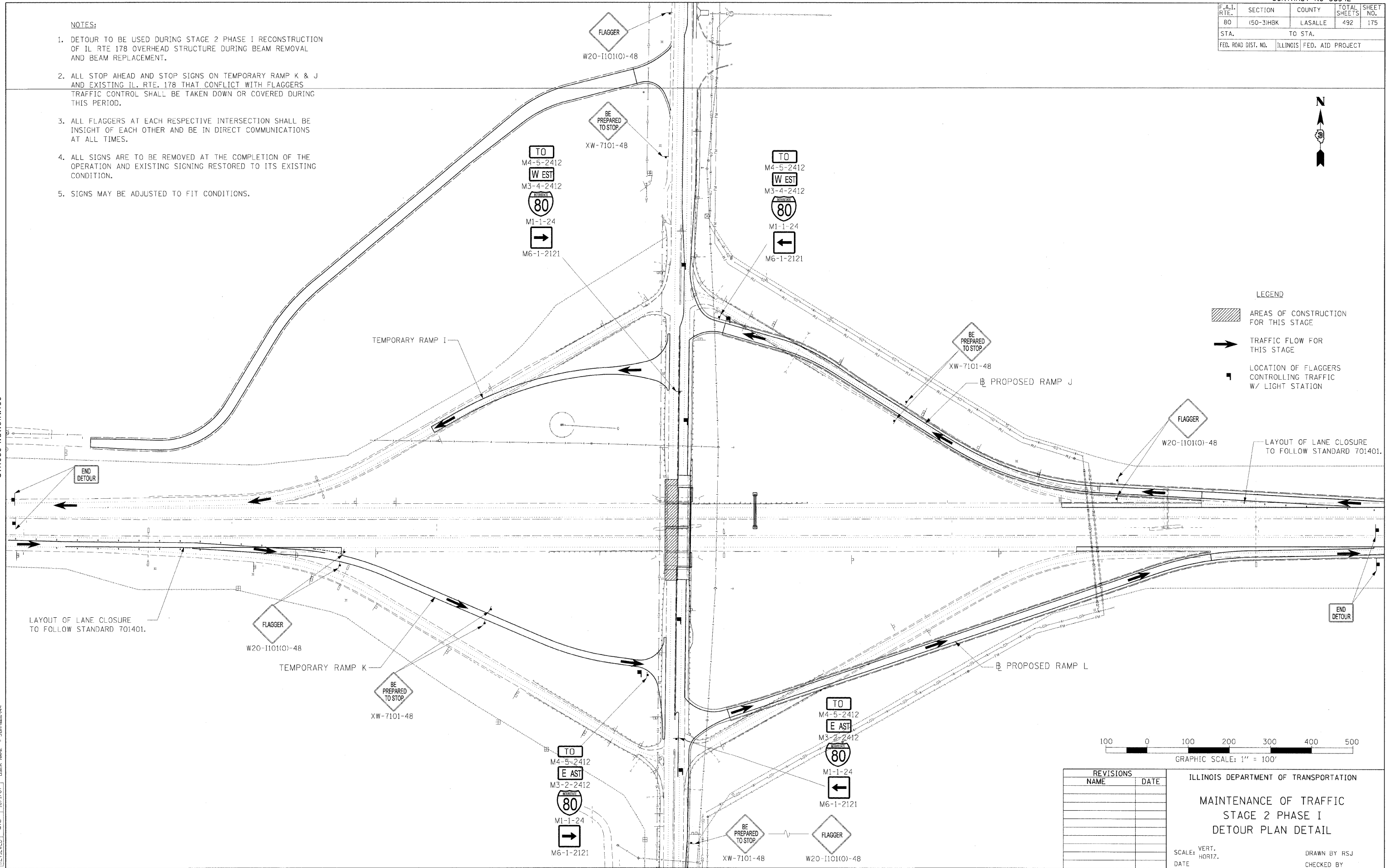

REVISIONS	
NAME	DATE

ILLINOIS DEPARTMENT OF TRANSPORTATION

**MAINTENANCE OF TRAFFIC
STAGE 2 PHASE I
DETOUR PLAN DETAIL**

SCALE: VERT.
HORIZ.
DATE

DRAWN BY RSJ
CHECKED BY