

F.A. RTE.	SECTION	COUNTY	TOTAL SHEETS	SHEET NO.
80	(50-3)HBK	LASALLE	492	202
STA. 200+00.00		TO STA. 214+00.00		
FED. ROAD DIST. NO.		ILLINOIS FED. AID PROJECT		

- NOTES:
- SEE DRAINAGE PIPE AND STRUCTURE SCHEDULES FOR DRAINAGE INFORMATION.
 - SEE ROADWAY PLAN & PROFILE SHEETS FOR VERTICAL CURVE INFORMATION AND PROPOSED DITCH GRADES.
 - CORRUGATED METAL PIPE (CMP) TO BE PAID FOR AS CLASS D PIPE.
 - REINFORCED CONCRETE PIPE (RCP) TO BE PAID FOR AS CLASS A PIPE.

PRIOR TO BEGINNING CONSTRUCTION PLACE TEMPORARY CONSTRUCTION FENCE AROUND IDNR RADIO BEACON & BURIED ANTENNA. THE FIELD ENGINEER WILL LOCATE THE PLACEMENT OF THE FENCE. THE CONTRACTOR SHALL MAINTAIN THE FENCE FOR THE DURATION OF CONSTRUCTION.

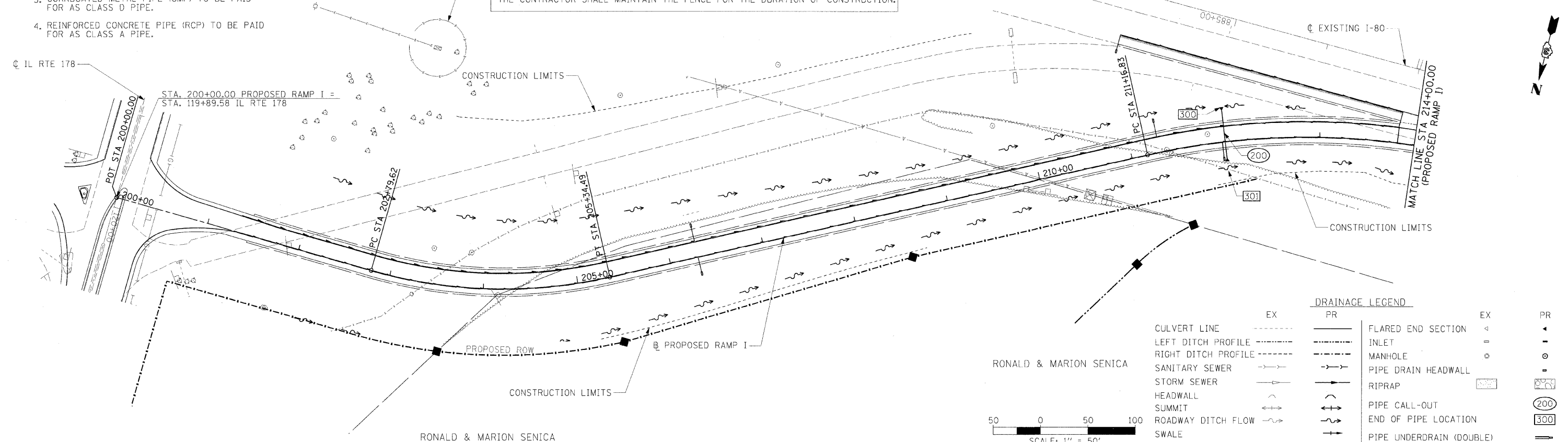

RONALD & MARION SENICA

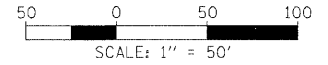

DRAINAGE LEGEND

CULVERT LINE	EX	PR	FLARED END SECTION	EX	PR
LEFT DITCH PROFILE	---	---	INLET	□	□
RIGHT DITCH PROFILE	---	---	MANHOLE	○	○
SANITARY SEWER	---	---	PIPE DRAIN HEADWALL	—	—
STORM SEWER	---	---	RIPRAP	▨	▨
HEADWALL	---	---	PIPE CALL-OUT	○	○
SUMMIT	↑	↑	END OF PIPE LOCATION	□	□
ROADWAY DITCH FLOW	→	→	PIPE UNDERDRAIN (DOUBLE)	—	—
SWALE	---	---			
PIPE UNDERDRAIN (SINGLE)	---	---			

PLAN

NO.	DATE	BY

SURVEYED: _____
 ALIGNED: _____
 NOTE BOOK NO. _____
 CHECKED: _____
 DATE FILED: _____
 FILED: _____

HANSON
 Hanson Professional Services Inc.
 1825 South Sixth Street
 Springfield, IL 62761
 Spring Offices Nationwide

PROFILE

NO.	DATE	BY

SURVEYED: _____
 GRADES CHECKED: _____
 NOTE BOOK NO. _____
 CHECKED: _____
 DATE FILED: _____
 FILED: _____

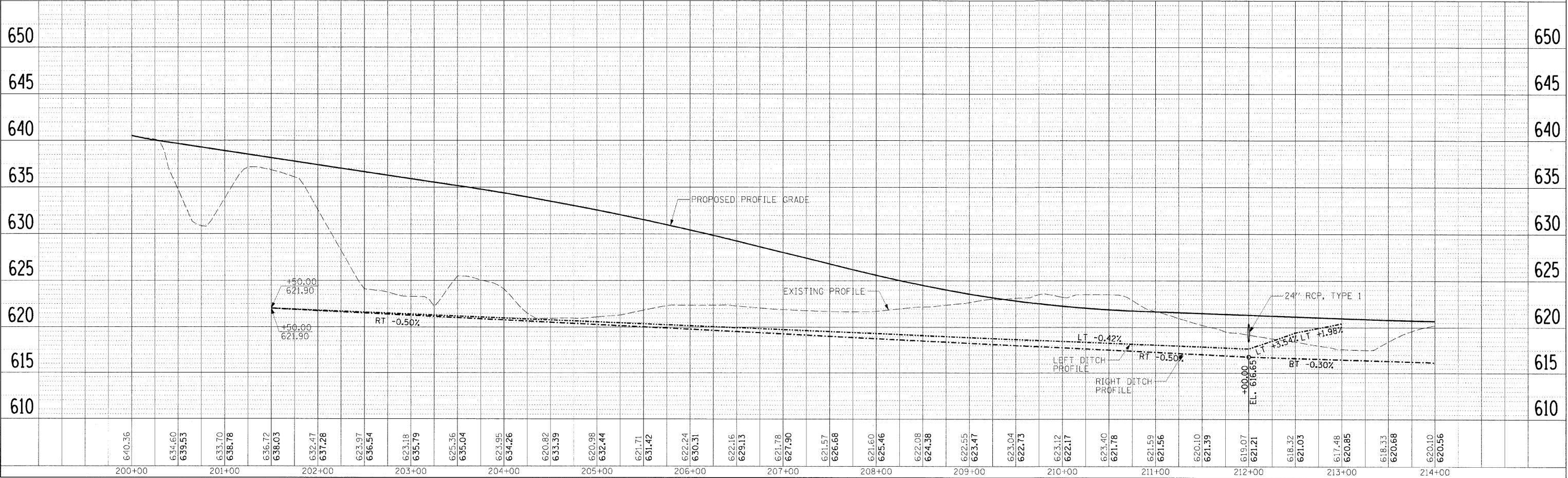

LAYOUT

NO.	DATE	BY

SURVEYED: _____
 GRADES CHECKED: _____
 NOTE BOOK NO. _____
 CHECKED: _____
 DATE FILED: _____
 FILED: _____