

F.A.I. RTE.	SECTION	COUNTY	TOTAL SHEETS	SHEET NO.
80	(50-3)HBK	LASALLE	492	210
STA. 95+00.00		TO STA. 109+50.00		
FED. ROAD DIST. NO.		ILLINOIS FED. AID PROJECT		

LASALLE COUNTY
ASPHALT CO.

BONNIE BENNETT & DEE CRUSK

ETNA OIL CO.

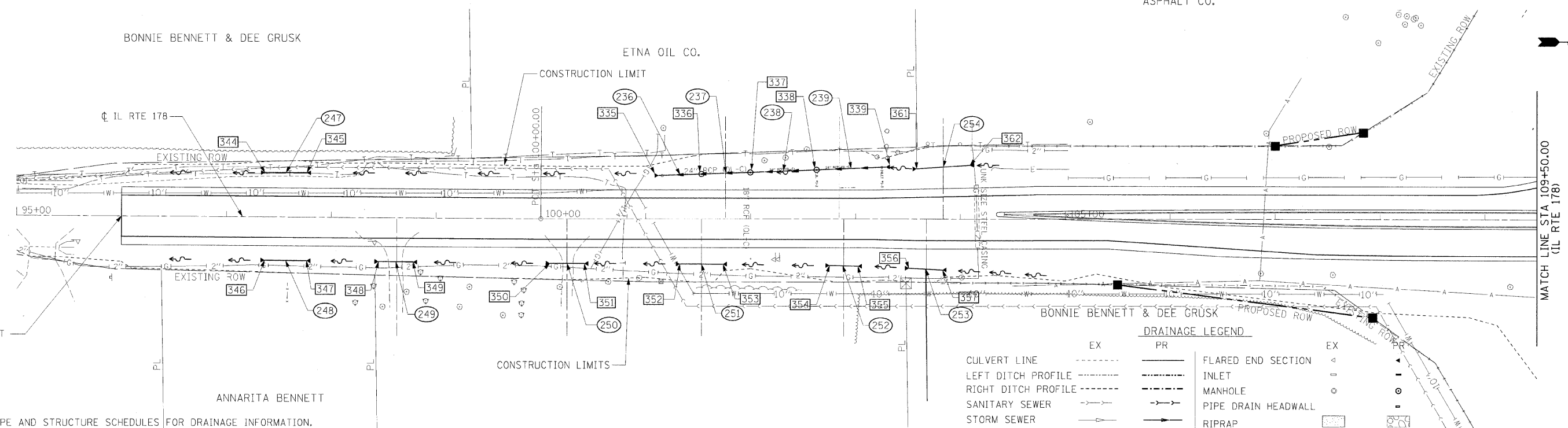

BEGIN IMPROVEMENT
STA 96+00

MATCH LINE STA 109+50.00
(IL RTE 178)

DRAINAGE LEGEND

CULVERT LINE	---	EX	PR	FLARED END SECTION	EX
LEFT DITCH PROFILE	---	---	---	INLET	△
RIGHT DITCH PROFILE	---	---	---	MANHOLE	○
SANITARY SEWER	---	---	---	PIPE DRAIN HEADWALL	□
STORM SEWER	---	---	---	RIPRAP	▨
HEADWALL	---	---	---	PIPE CALL-OUT	○
SUMMIT	---	---	---	END OF PIPE LOCATION	○
ROADWAY DITCH FLOW	---	---	---	PIPE UNDERDRAIN (SINGLE)	---
SWALE	---	---	---	PIPE UNDERDRAIN (DOUBLE)	---
PIPE UNDERDRAIN (SINGLE)	---	---	---		

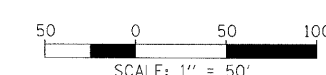

NOTES:

1. SEE DRAINAGE PIPE AND STRUCTURE SCHEDULES FOR DRAINAGE INFORMATION.
2. SEE ROADWAY PLAN & PROFILE SHEETS FOR VERTICAL CURVE INFORMATION AND PROPOSED DITCH GRADES.
3. CORRUGATED METAL PIPE (CMP) TO BE PAID FOR AS CLASS D PIPE.
4. REINFORCED CONCRETE PIPE (RCP) TO BE PAID FOR AS CLASS A PIPE.

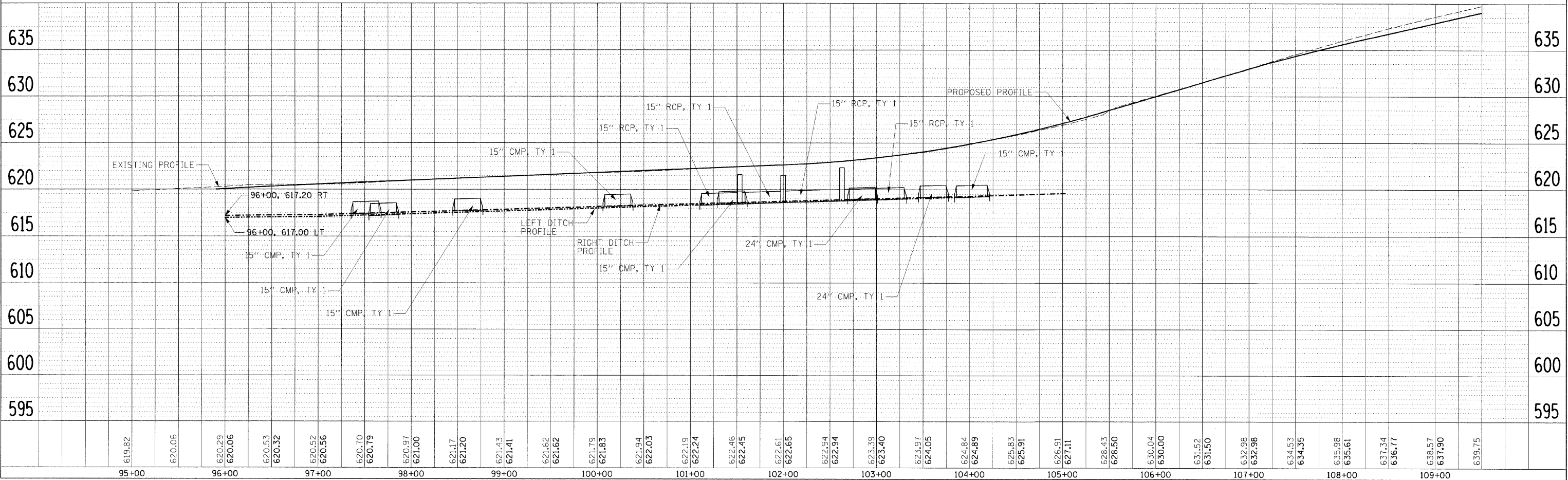

HANSON
Hanson Professional Services Inc.
1625 South Sixth Street
Springfield, Illinois 62703-2886

DATE	BY
DATE	BY

PLAN
SURVEYED
ALIGNED
CHECKED
NOTE BOOK NO.
DATE CHECKED
BY
NO.

DATE	BY
DATE	BY

PROFILE
SURVEYED
GRADES CHECKED
NOTE BOOK NO.
DATE CHECKED
BY
NO.

LAYOUT	KET	01/12/06
DRAWN	KET	01/12/06
REVIEWED	RVC	08/31/06

MODEL NAME = IL RTE 178-2
FILE NAME = C:\P\178\178-2.dgn
PLOT SCALE = 5/8"=1'-0"
USER NAME = JohnH0914