

F.A.I. RTE.	SECTION	COUNTY	TOTAL SHEETS	SHEET NO.
80	150-31HBK	LASALLE	492	214
STA. 604+25.58		TO STA. 618+00.00		
FED. ROAD DIST. NO.		ILLINOIS FED. AID PROJECT		

RONALD & MARION SENICA

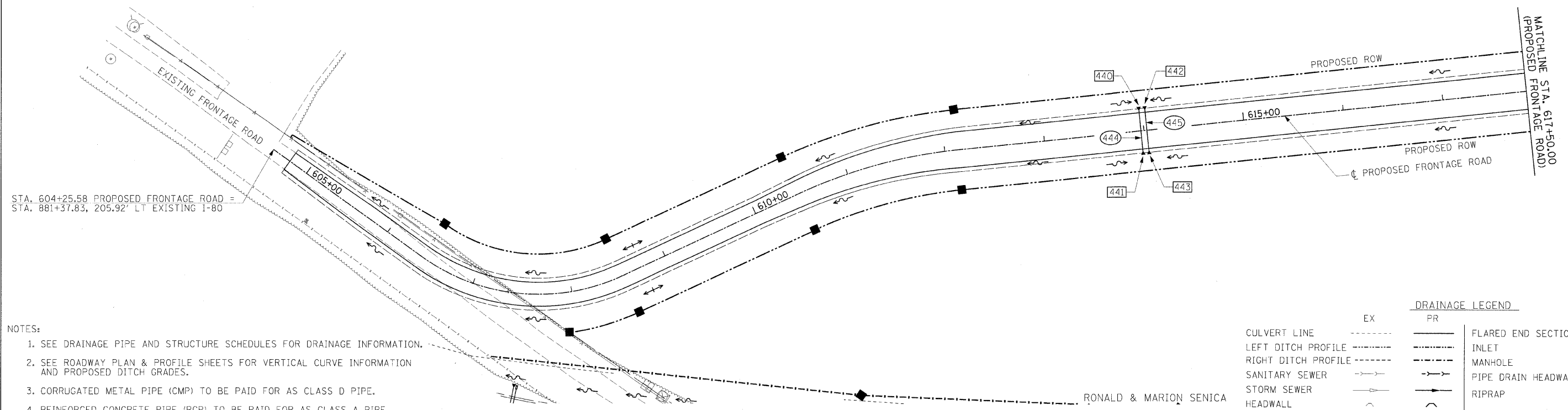

STA. 604+25.58 PROPOSED FRONTAGE ROAD =
STA. 881+37.83, 205.92' LT EXISTING I-80

NOTES:

1. SEE DRAINAGE PIPE AND STRUCTURE SCHEDULES FOR DRAINAGE INFORMATION.
2. SEE ROADWAY PLAN & PROFILE SHEETS FOR VERTICAL CURVE INFORMATION AND PROPOSED DITCH GRADES.
3. CORRUGATED METAL PIPE (CMP) TO BE PAID FOR AS CLASS D PIPE.
4. REINFORCED CONCRETE PIPE (RCP) TO BE PAID FOR AS CLASS A PIPE.

DRAINAGE LEGEND

	EX	PR		EX	PR
CULVERT LINE	---	---	FLARED END SECTION	4	4
LEFT DITCH PROFILE	---	---	INLET	□	□
RIGHT DITCH PROFILE	---	---	MANHOLE	○	○
SANITARY SEWER	---	---	PIPE DRAIN HEADWALL	■	■
STORM SEWER	---	---	RIPRAP	▨	▨
HEADWALL	---	---	PIPE CALL-OUT	200	300
SUMMIT	---	---	END OF PIPE LOCATION	300	300
ROADWAY DITCH FLOW	---	---	PIPE UNDERDRAIN (DOUBLE)	---	---
SWALE	---	---			
PIPE UNDERDRAIN (SINGLE)	---	---			

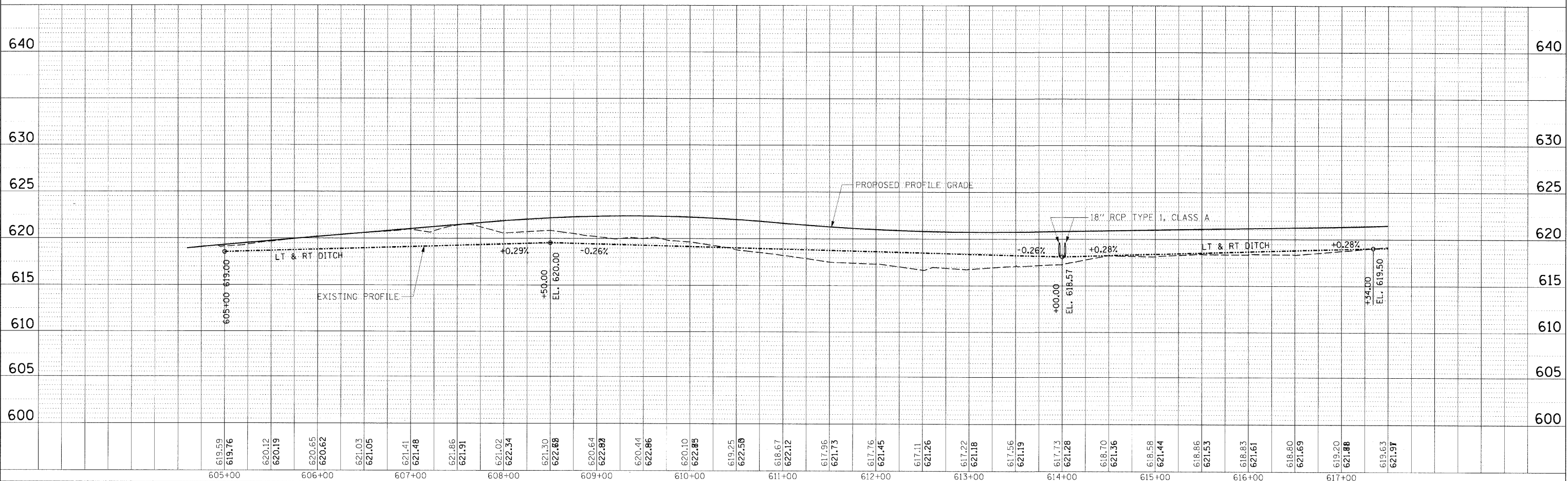
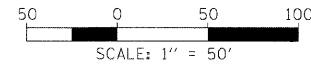

DRAINAGE & UTILITIES FRONTAGE ROAD

PLAN	DATE
BY	
DATE	
NO.	
NO.	

© Copyright Hanson Professional Services Inc. 2009
HANSON
 Hanson Professional Services Inc.
 1525 South Sixth Street
 Springfield, Illinois 62703-2886
 Spring Offices Nationwide

PROFILE	DATE
BY	
DATE	
NO.	
NO.	

MODEL NAME = FRONTAGE RD-1	DATE = 08/31/06
FILE NAME = C:\P\LE\proj\1-C-8200\RD.dgn	
PLT SCALE = 50.0000 / 1 in.	
USER NAME = JohnB2944	
DRAWN	RC
REVIEWED	RC