

F.A.P. RTE.	SECTION	COUNTY	TOTAL SHEETS	SHEET NO.
68	(3)BR-1	LASALLE	44	1

CONTRACT NO. 66619
P-93-029-99
D-93-037-00

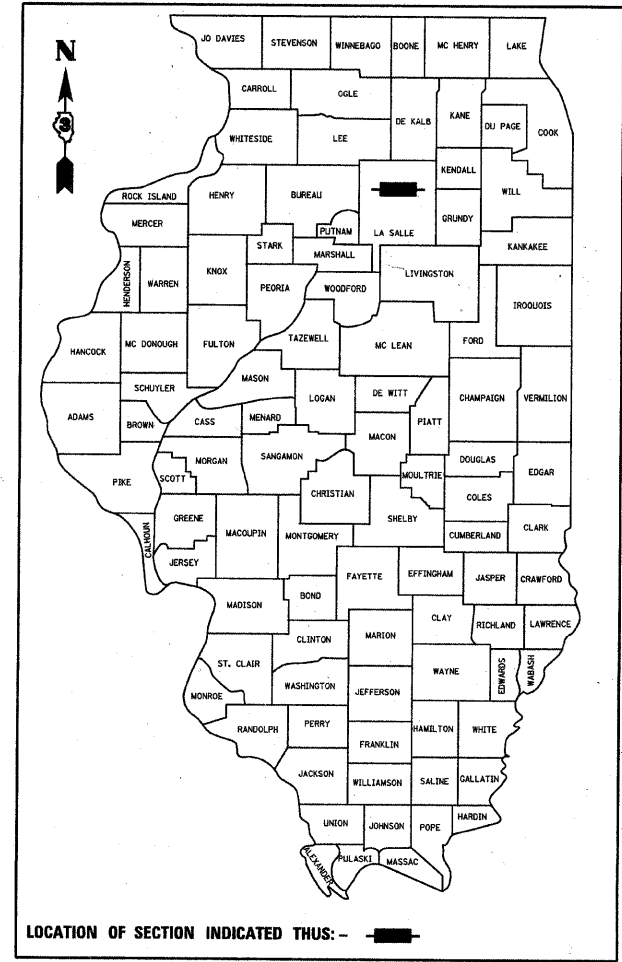

LOCATION OF SECTION INDICATED THUS: - ■ -
RURAL MINOR ARTERIAL
ADT 2500 (2005)
PC = 2,000 SU = 325 MU = 175
DESIGN SPEED = 55 MPH

STATE OF ILLINOIS
DEPARTMENT OF TRANSPORTATION
DIVISION OF HIGHWAYS

SUBMITTED January 26 2010
George Peterson
DEPUTY DIRECTOR OF HIGHWAYS, REGION ENGINEER

March 9 2010
Scott E. Stitt, P.E.
REGISTERED ENGINEER OF DESIGN AND ENVIRONMENT

March 9 2010
Christine M. Roeder
DIRECTOR OF HIGHWAYS, CHIEF ENGINEER

**PRINTED BY THE AUTHORITY
OF THE STATE OF ILLINOIS**

STATE OF ILLINOIS
DEPARTMENT OF TRANSPORTATION
DIVISION OF HIGHWAYS

**PROPOSED
HIGHWAY PLANS**

F.A.P. ROUTE 68 (US 52 & IL 23)
SECTION (3)BR-1

LASALLE COUNTY
C-93-024-06
BRIDGE REPLACEMENT AT CROOKED LEG CREEK

0.3 MILES EAST OF US 52 /IL 23 INTERSECTION

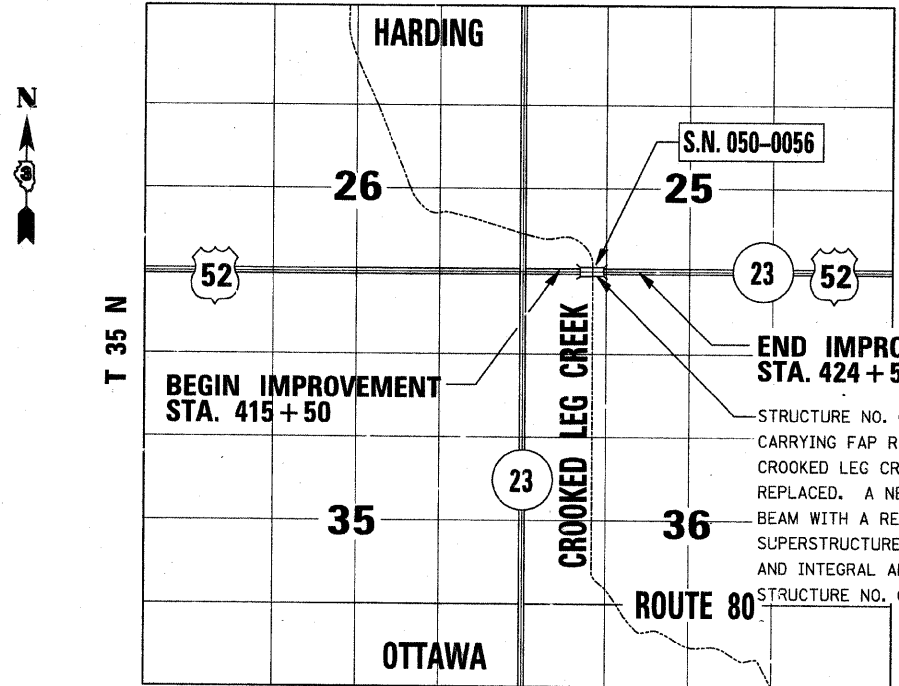

LOCATION MAP
SCALE: 1" = 1 MILE
GROSS LENGTH OF PROJECT = 900 FEET = 0.170 MI.
NET LENGTH OF PROJECT = 900 FEET = 0.170 MI.

INDEX OF SHEETS

- COVER SHEET, INDEX OF SHEETS & HIGHWAY STANDARDS
- GENERAL NOTES & COMMITMENTS
- SUMMARY OF QUANTITIES
- TYPICAL SECTIONS
- 5-6 SCHEDULE OF QUANTITIES
- ALIGNMENT TIES & BENCHMARKS
- 8-9. PLAN & PROFILE SHEETS
10. TRAFFIC CONTROL STAGING PLAN
- 11.-33D. STRUCTURE PLAN
- 34.-35. MISCELLANEOUS DETAILS
- 36.-44. CROSS SECTIONS

HIGHWAY STANDARDS

- 000001-05 STANDARD SYMBOLS, ABBREVIATIONS AND PATTERNS
- 001001-02 AREAS OF REINFORCEMENT BARS
- 001006 DECIMAL OF AN INCH AND OF A FOOT
- 280001-05 TEMPORARY EROSION CONTROL SYSTEMS
- 420401-08 BRIDGE APPROACH PAVEMENT
- 515001-03 NAME PLATE FOR BRIDGES
- 542401-01 METAL END SECTION FOR PIPE CULVERTS
- 630001-08 STEEL PLATE BEAM GUARDRAIL
- 630201-06 PCC/MA STABILIZATION AT STEEL PLATE BEAM GUARDRAIL
- 630301-05 SHOULDER WIDENING FOR TYPE 1 (SPECIAL) GUARDRAIL TERMINALS
- 631031-08 TRAFFIC BARRIER TERMINAL, TYPE 6
- 635006-03 REFLECTOR AND TERMINAL MARKER PLACEMENT
- 635011-02 REFLECTOR MARKER AND MOUNTING DETAILS
- 701006-03 OFF-RD OPERATIONS, 2L, 2W, 4.5 m (15') TO 600 mm (24") FROM PAVEMENT EDGE
- 701011-02 OFF-RD MOVING OPERATIONS, 2L, 2W, DAY ONLY
- 701101-02 OFF-RD OPERATIONS, MULTILANE, 4.5 m (15') TO 600 mm (24") FROM PAVEMENT EDGE
- 701201-03 LANE CLOSURE, 2L, 2W, DAY ONLY, FOR SPEEDS ≥ 45 MPH
- 701206-02 LANE CLOSURE, 2L, 2W, NIGHT ONLY, FOR SPEEDS ≥ 45 MPH
- 701301-03 LANE CLOSURE, 2L, 2W, SHORT TIME OPERATIONS
- 701306-02 LANE CLOSURE, 2L, 2W, SLOW MOVING OPERATIONS DAY ONLY, FOR SPEEDS ≥ 45 MPH
- 701311-03 LANE CLOSURE 2L, 2W MOVING OPERATIONS - DAY ONLY
- 701321-10 LANE CLOSURE, 2L, 2W, BRIDGE REPAIR WITH BARRIER
- 701901-01 TRAFFIC CONTROL DEVICES
- 704001-06 TEMPORARY CONCRETE BARRIER
- 780001-02 TYPICAL PAVEMENT MARKINGS
- 781001-03 TYPICAL APPLICATIONS RAISED REFLECTIVE PAVEMENT MARKERS

MICROFILMED _____
REEL NUMBER _____
AWARDED _____
RESIDENT ENGINEER _____
AS BUILT CHANGES WERE MADE
ON THE FOLLOWING SHEETS _____

DISTRICT NO. 3 (815) 434-6131
PROJECT ENGINEER: JOE KANNEL
UNIT CHIEF: MICHELE LINDEMANN
CONTRACT NO. 66619

J.U.L.I.E.
JOINT UTILITY LOCATION INFORMATION FOR EXCAVATION
1-800-892-0123



Ali A. Gharamti 6/19/08
ALI A. GHARAMTI DATE
ILLINOIS PROFESSIONAL ENGINEER NO. 062-046049
RENEWAL DATE: 11/30/2009