

F.A.U. RTE.	SECTION	COUNTY	TOTAL SHEETS	SHEET NO.
I-80	50-8 HBR	LASALLE	143	20
STA. 303+00.00		TO STA. 309+14.95		
FED. ROAD DIST. NO. 3 ILLINOIS FED. AID PROJECT				

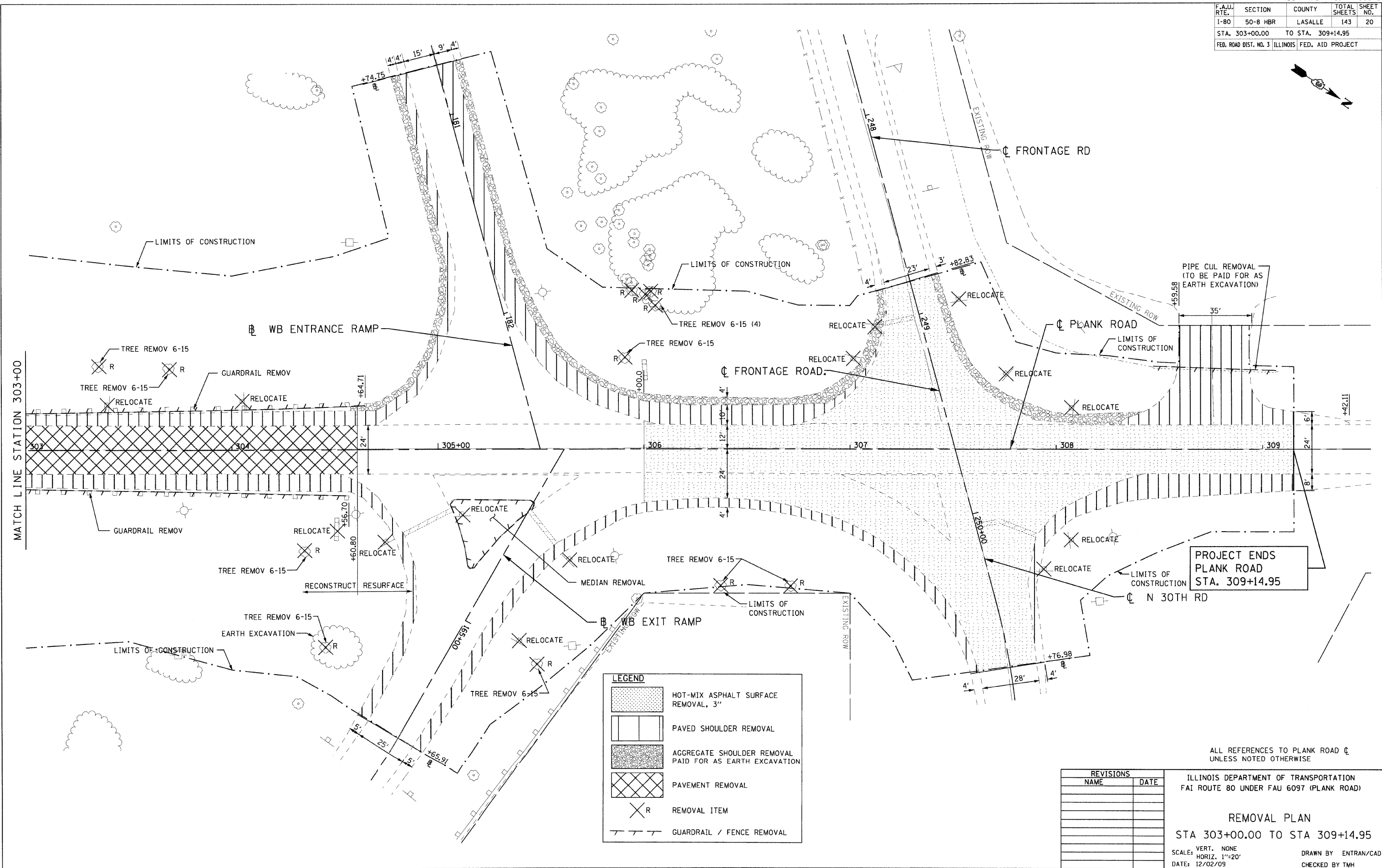
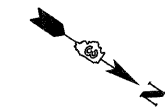

MATCH LINE STATION 303+00

**PROJECT ENDS  
PLANK ROAD  
STA. 309+14.95**

LEGEND	
	HOT-MIX ASPHALT SURFACE REMOVAL, 3"
	PAVED SHOULDER REMOVAL
	AGGREGATE SHOULDER REMOVAL PAID FOR AS EARTH EXCAVATION
	PAVEMENT REMOVAL
	REMOVAL ITEM
	GUARDRAIL / FENCE REMOVAL

ALL REFERENCES TO PLANK ROAD C UNLESS NOTED OTHERWISE

REVISIONS	
NAME	DATE

ILLINOIS DEPARTMENT OF TRANSPORTATION  
FAI ROUTE 80 UNDER FAU 6097 (PLANK ROAD)

**REMOVAL PLAN**  
STA 303+00.00 TO STA 309+14.95

SCALE: VERT. NONE  
HORIZ. 1"=20'  
DATE: 12/02/09  
DRAWN BY ENTRAN/CAD  
CHECKED BY TMH

PLOT DATE = 2/4/2010  
 FILE NAME = c:\p\enr\2009\66645\001\road\pl\rm03.dwg  
 PLOT SCALE = 20.00 / 1 IN.  
 PLOT TIME = 4:08:57 PM

