

FAU RTE.	SECTION	COUNTY	TOTAL SHEETS	SHEET NO.
I-80	50-8 HBR	LASALLE	143	39
STA.	TO STA.			
FED. ROAD DIST. NO. 3	ILLINOIS		FED. AID PROJECT	

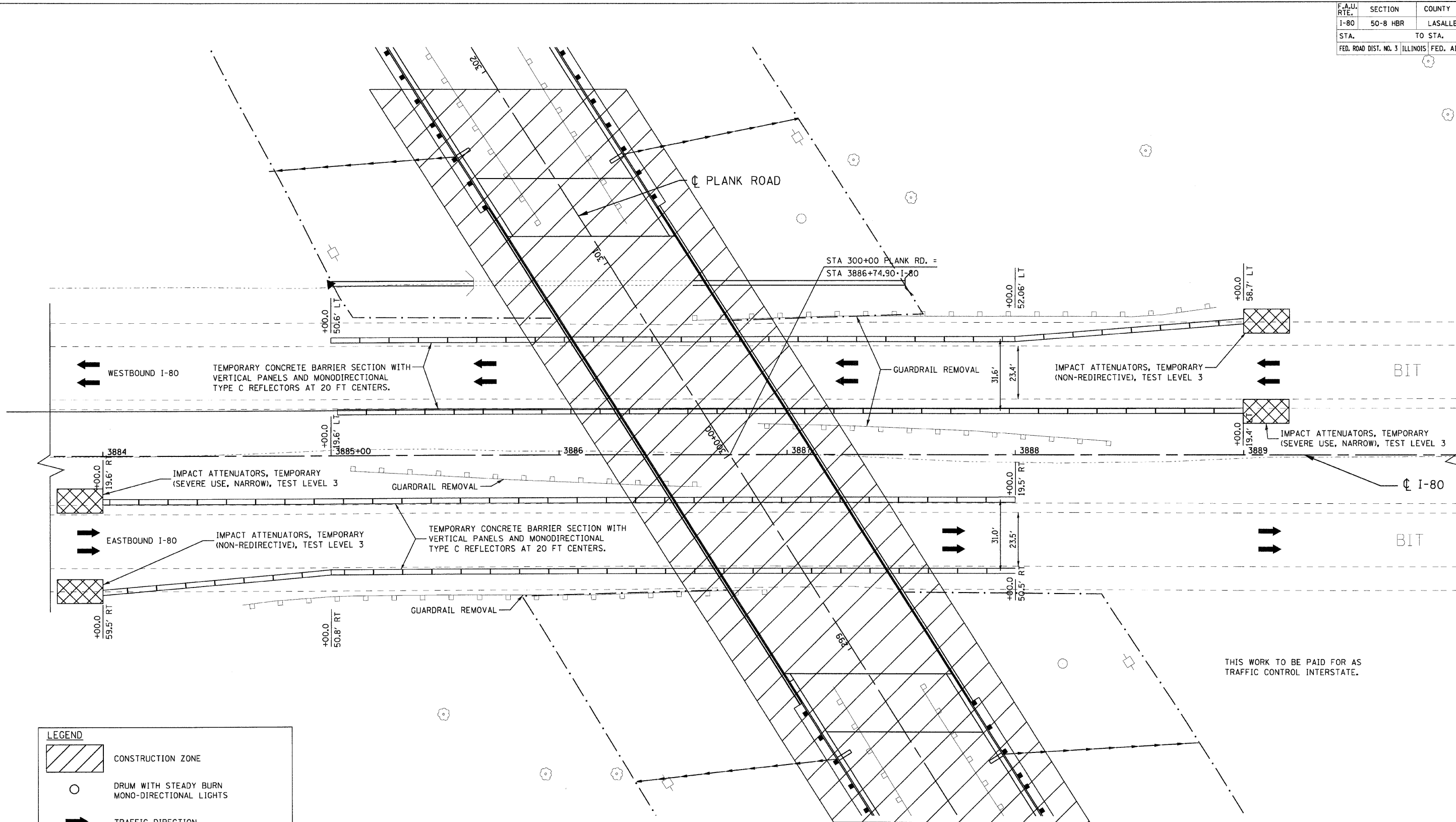

THIS WORK TO BE PAID FOR AS TRAFFIC CONTROL INTERSTATE.

LEGEND	
	CONSTRUCTION ZONE
	DRUM WITH STEADY BURN MONO-DIRECTIONAL LIGHTS
	TRAFFIC DIRECTION
	TEMPORARY CONCRETE BARRIER WALL
	TYPE III BARRICADE
	IMPACT ATTENUATOR

NOTE:
SEE STANDARD 701321 FOR DETAILS NOT SHOWN

REVISIONS	
NAME	DATE

ILLINOIS DEPARTMENT OF TRANSPORTATION
FAI ROUTE 80 UNDER FAU 6097 (PLANK ROAD)
MAINTENANCE OF TRAFFIC
INTERSTATE 80

SCALE: VERT. NONE
HORIZ. 1"=20'
DATE: 12/02/09
DRAWN BY: ENTRAN/CAD
CHECKED BY: TMH

PLOT DATE = 2/4/2010
FILE NAME = G:\projects\2004885\001\cadd\PLINT2_04.dwg
PLOT SCALE = 20.00 / IN.
PLOT TIME = 4:11:58 PM

