

Benchmark: Chiseled square on the SW corner of the Northeast Wingwall of the existing Plank Road Bridge SN 050-0082. Elev = 676.75.
 Existing Structure: SN 050-0082 originally built as Plank Road over FAI Rte 80, Section 50-8HB in 1961. The concrete deck was repaired in 1986. The existing bridge is a four span bridge, 242'-0" long by 35'-0" wide. The deck is supported by continuous wide flange steel beams on multi-column piers and open abutments, on a 32°-16' skew angle. Existing structure to be removed and replaced utilizing stage construction.

Salvage: None

STATE OF ILLINOIS
 DEPARTMENT OF TRANSPORTATION

APPROVED
 FOR STRUCTURAL ADEQUACY ONLY

Ralph E. Anderson (TSP)
 ENGINEER OF BRIDGES AND STRUCTURES

ROUTE NO.	SECTION	COUNTY	TOTAL SHEETS	SHEET NO.
FAI 80	50-8HBR	LASALLE	143	62

Contract # 66645



For Sheets 1 to 18 and 22 to 26

For Sheets 19 to 21

BRAD H. SAYERS, S.E.
 IL. LIC. NO. 081-006267

MICHAEL T. HALEY, S.E.
 IL. LIC. NO. 081-005991

EXP 11/30/10
 DATE 2/3/10

EXP 11/30/10
 DATE 2/4/10

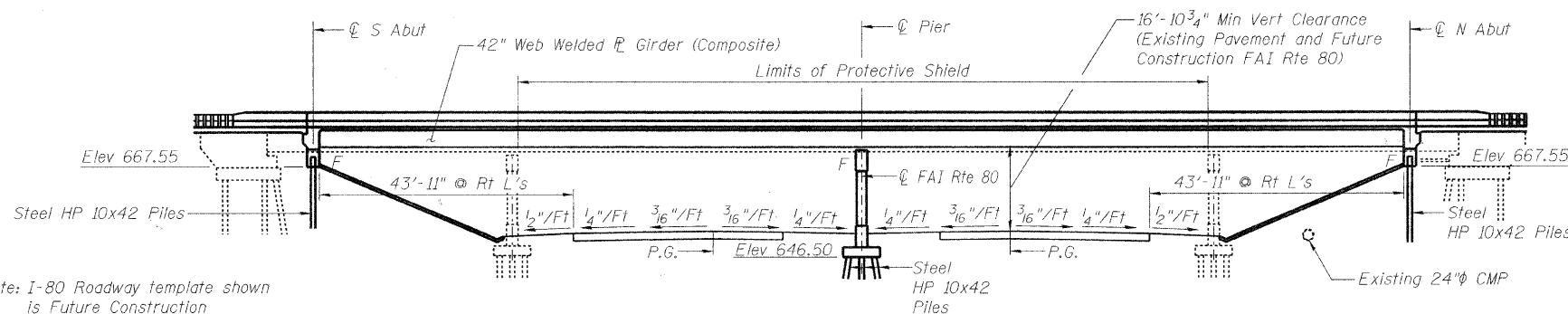

Note: I-80 Roadway template shown is Future Construction

ELEVATION

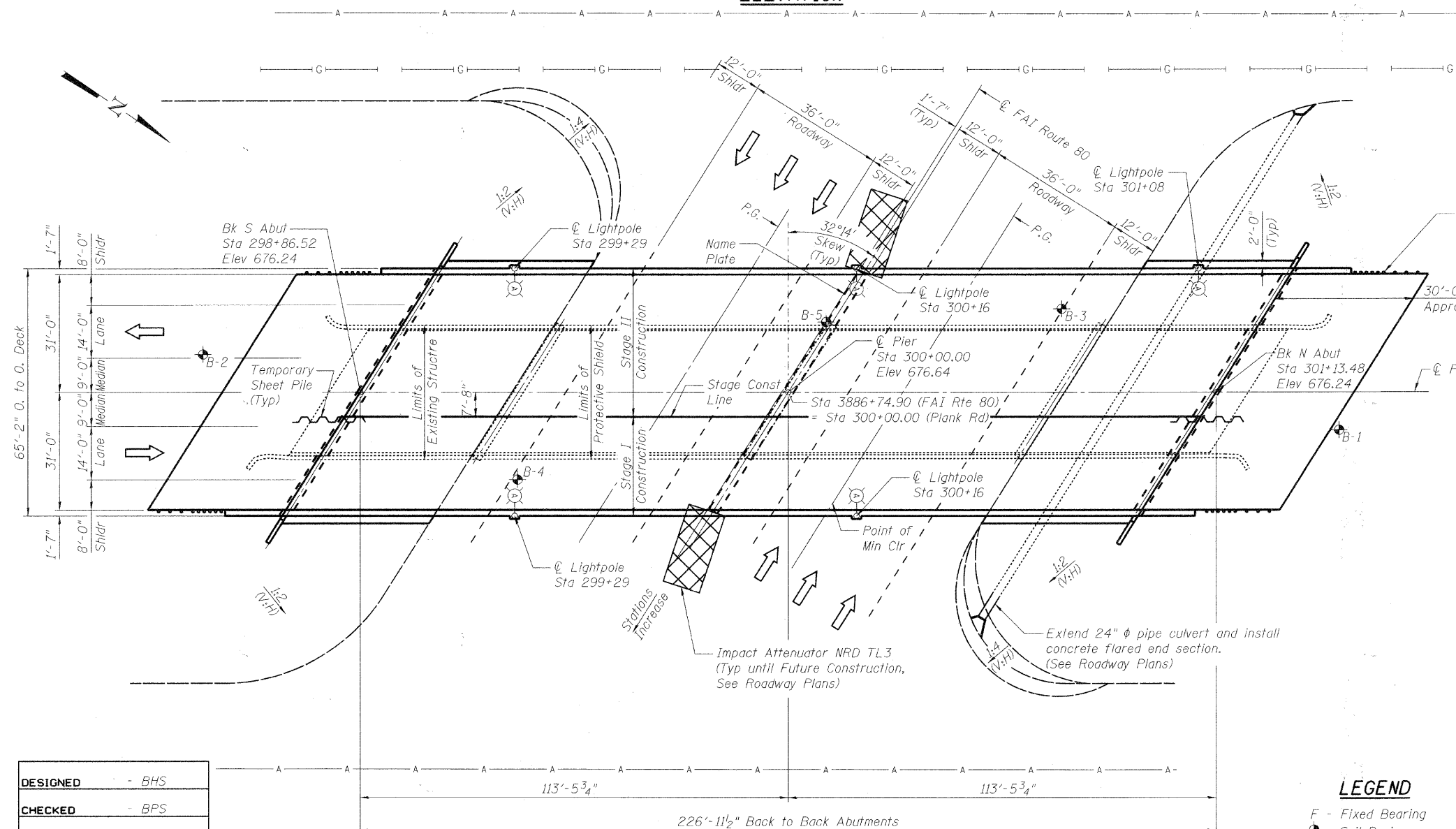

PLAN

STATION 3886+74.90
 BUILT 200_ BY
 STATE OF ILLINOIS
 F.A.I. ROUTE 80 SEC. 50-8HBR
 LOADING HS20 & ALT.
 STR. NO. 050-0249

NAME PLATE
 See Std 515001

LOADING HS20-44
 Allow 50 psf for future wearing surface.
DESIGN STRESSES
 $f_c = 3,500$ psi
 $f_y = 50,000$ psi (A270 Gr 50 Structural Steel)
 $f_y = 60,000$ psi (Reinforcement)
DESIGN SPECIFICATIONS
 2002 AASHTO Standard Specifications
 For Highway Bridges
SEISMIC DATA
 Seismic Performance Category (SPC) = A
 Bedrock Acceleration Coefficient (A) = 0.04g
 Site Coefficient (S) = 1.0

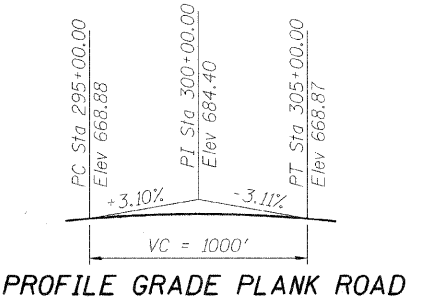

PROFILE GRADE PLANK ROAD

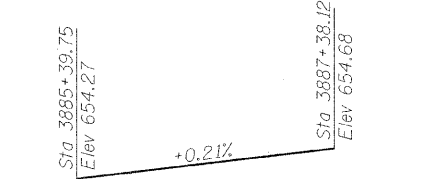

*PROFILE GRADE I-80 (WB)
 (Future Construction)

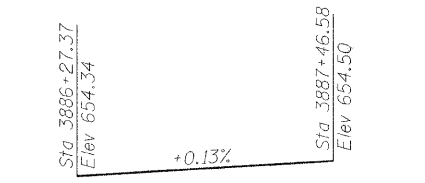

*PROFILE GRADE I-80 (EB)
 (Future Construction)

*Note: Profile Grade for Future Construction is assumed to equal the Profile Grade at Existing Lanes.

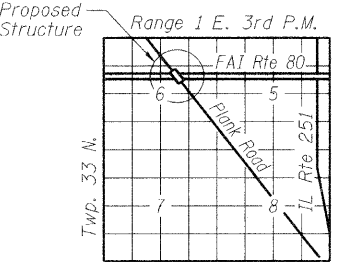

LOCATION SKETCH

LEGEND

- F - Fixed Bearing
- S - Soil Boring
- (A) - Proposed Lightpole
- (A) - Existing Aerial Line
- (G) - Existing Underground Gasline

DESIGNED	- BHS
CHECKED	- BPS
DRAWN	- RRG
CHECKED	- GSP

GENERAL PLAN
 PLANK ROAD OVER
 FAI ROUTE 80 (I-80)
 SECTION 50-8HBR
 LASALLE COUNTY
 STATION 3886+74.90
 STRUCTURE NO. 050-0249