

STATE OF ILLINOIS
DEPARTMENT OF TRANSPORTATION

ROUTE NO.	SECTION	COUNTY	TOTAL SHEETS	SHEET NO.
FAT 80	50-8HBR	LASALLE	143	95
FED. ROAD DIST. NO. 7		ILLINOIS	FED. AID PROJECT	

Contract # 66645

Bench Mark: Spike in power pole 15' Rt. Sta. 495+99.00 Elev. 653.88
Existing Structure: 050-0082 is 242'-0" long by 35'-8" wide. Built as F.A.I. Rte. 80, Section 50-8HBR at Sta. 496+22.50 in 1959. Traffic shall be maintained during the rehabilitation of the existing structure.

STATE OF ILLINOIS
DEPARTMENT OF TRANSPORTATION

ROUTE NO.	SECTION	COUNTY	TOTAL SHEETS	SHEET NO.
FAT 80	50-8HBR	LASALLE	143	95
FED. ROAD DIST. NO. 7		ILLINOIS	FED. AID PROJECT	

GENERAL NOTES

All structural steel shall be shop painted with two coats of basic lead silico chromate paint except as noted.
Reinforcement bars shall conform to the requirements of AASHTO M-31 or M-53 Grade 60.
Plan dimensions and details relative to existing structure have been taken from existing plans and are subject to nominal construction variations. It shall be the Contractor's responsibility to verify such dimensions and details in the field and make necessary approved adjustments prior to construction or ordering of materials. Such variations shall not be cause for additional compensation for a change in the scope of the work, however, the Contractor will be paid for the quantity actually furnished at the unit price bid for the work.
Protective Coat shall not be applied to surfaces to which Waterproofing Membrane System is applied.

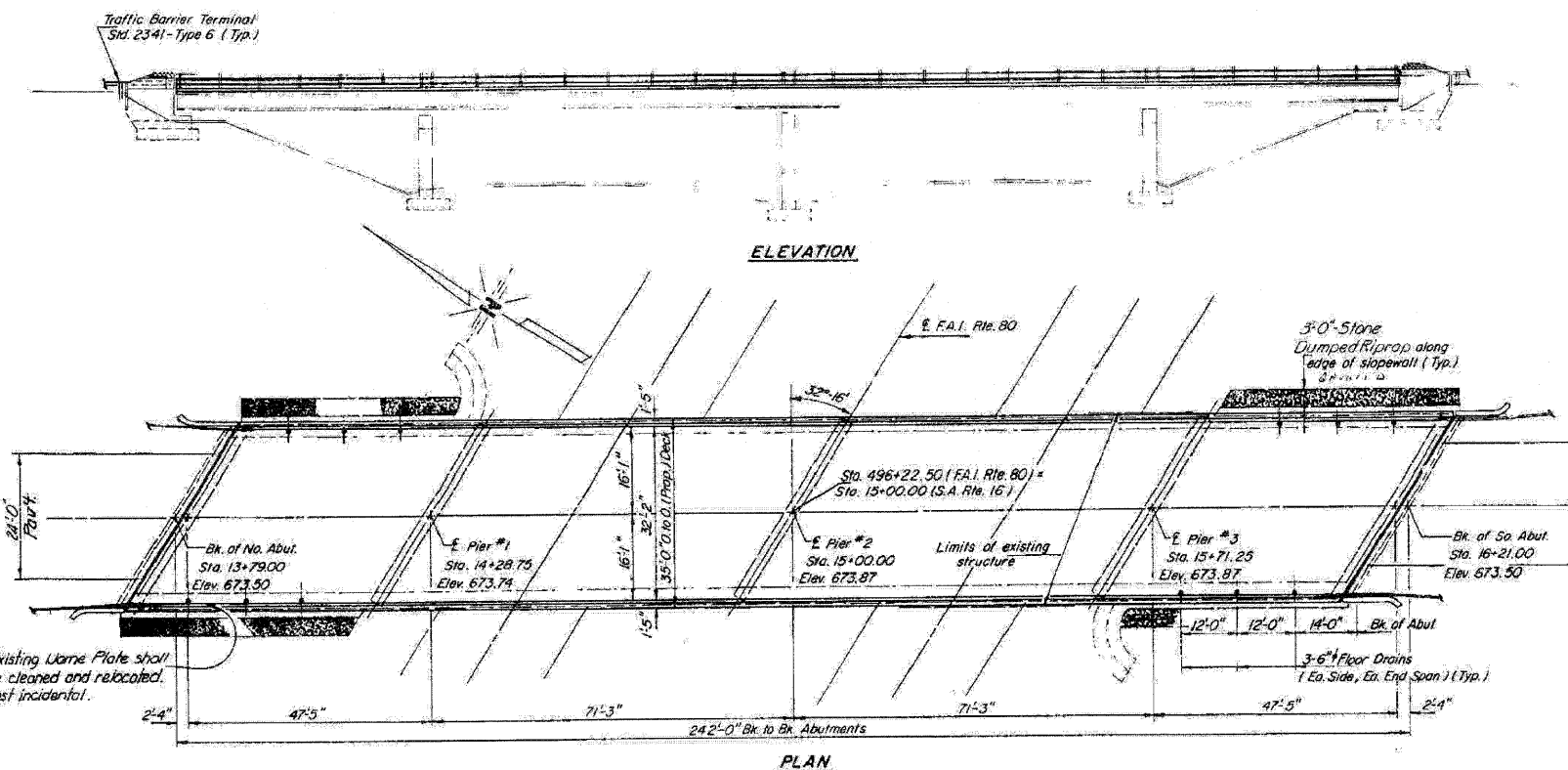

TOTAL BILL OF MATERIAL

Item	Unit	Super	Sub.	Total
Concrete Removal	Cu. Yd.	84	6	90
Floor Drains	Each	18		18
Protective Coat	Sq. Yd.	195		195
Class X Concrete	Cu. Yd.	95.9	0.4	96.3
Reinforcement Bars	Lb.	7840	520	8360
Reinforcement Bars (Epoxy Coated)	Lb.	9310		9310
Structural Steel	Lb.	5590		5590
Stone Dumped Riprap	Sq. Yd.		70	70
Preformed Joint Seal 4"	Lin. Ft.	82		82
Bridge Handrail Removal	Lin. Ft.	479		479
Bituminous Concrete Surface Course Class I	Ton	73		73
Waterproofing Membrane System	Sq. Yd.	876		876
Bituminous Surface Removal	Sq. Yd.	816		816
Deck Slab Repair (Full Depth)	Sq. Yd.	??		??
Deck Slab Repair (Partial Depth)	Sq. Yd.	81		81

For quantities for Temporary Concrete Barrier see roadway plans.

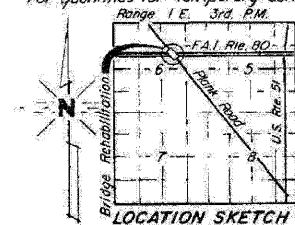

GENERAL PLAN
PLANK ROAD OVER F.A.I. Rte. 80
F.A.I. Rte. 80 SECTION (50-8HBR)
LA SALLE COUNTY
Sta. 496+22.50
STRUCTURE NUMBER 050-0082

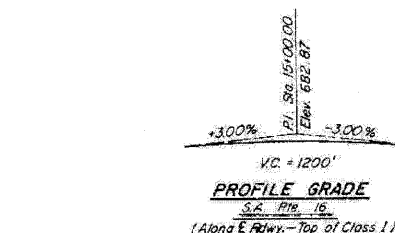

DESIGNED	EXAMINED	1985
CHECKED	PASSED	
DRAWN	APPROVED	
CHECKED		

DESIGN SPECIFICATIONS
AASHTO (1983)
DESIGN STRESSES
f_c = 1,400 psi
f_s = 24,000 psi (Reinf.)
f_s = 20,000 psi (Struct. Stl.)

EXISTING PLANS - 1985

PLANK ROAD OVER
FAI ROUTE 80 (I-80)
SECTION 50-8HBR
LASALLE COUNTY
STATION 3886+74.90
STRUCTURE NO. 050-0249

FOR INFORMATION ONLY