

STORM SEWER D
 DIAMETER: 18 IN
 LENGTH: 8 FT
 SLOPE: 0.8 %
 EX. F.L. ELEV. AT HEADWALL: 630.346
 PROP. F.L. ELEV. AT MANHOLE 1: 630.410

STORM SEWER C
 DIAMETER: 18"
 LENGTH: 46.5 FT
 SLOPE: 0.5%
 PROP. F.L. ELEV. AT MANHOLE 1: 630.41
 PROP. F.L. ELEV. AT MANHOLE 2: 630.64

STORM SEWER B
 DIAMETER: 18"
 LENGTH: 15 FT
 SLOPE: 1.93 %
 PROP. F.L. ELEV. AT MANHOLE 2: 631.49
 PROP. F.L. ELEV. AT END SECTION/DITCH: 631.78

STORM SEWER A
 DIAMETER: 18"
 LENGTH: 21 FT
 SLOPE: 2.0 %
 PROP. F.L. ELEV. AT MANHOLE 2: 631.06
 PROP. F.L. ELEV. AT END SECTION/DITCH: 631.48

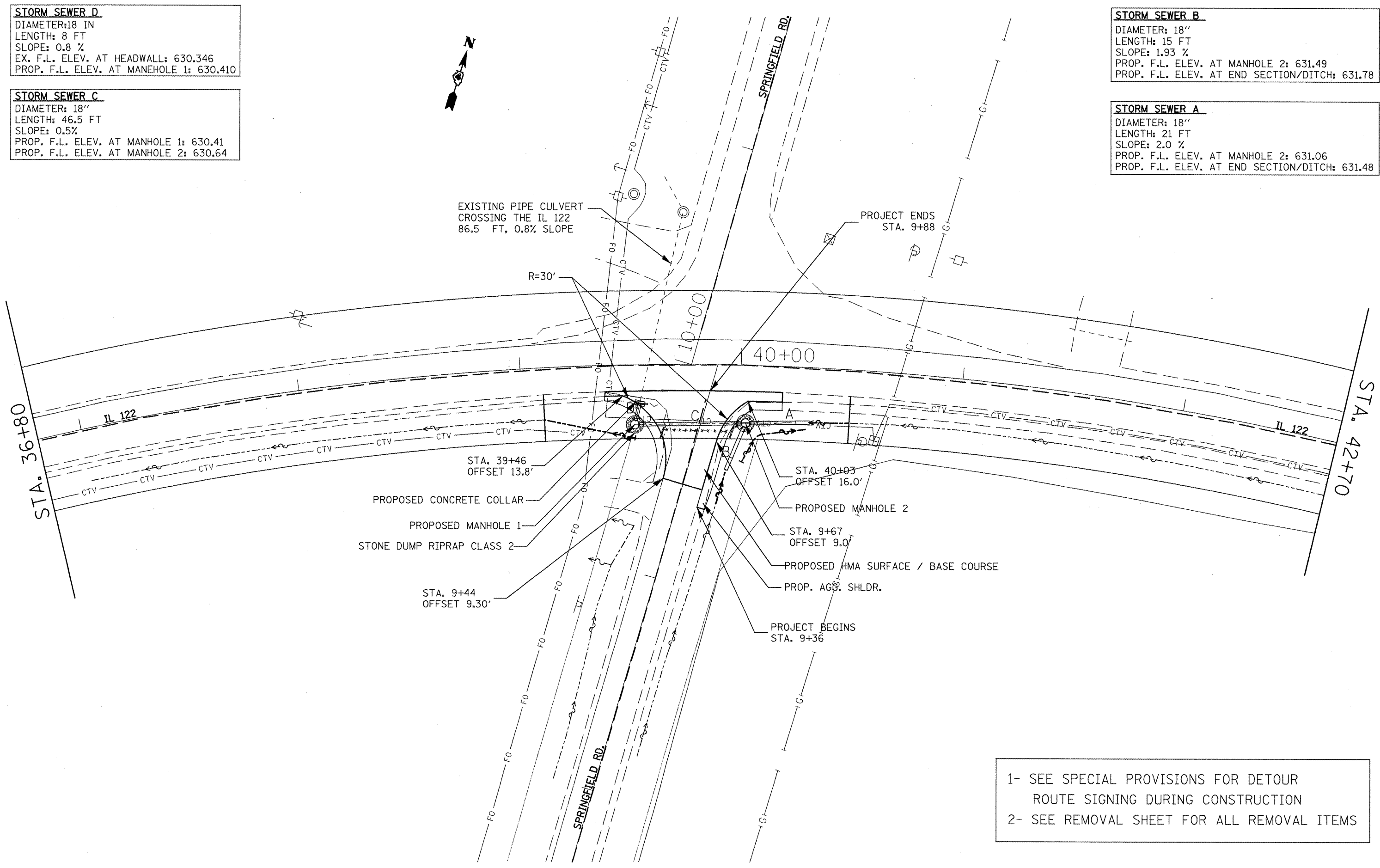

1- SEE SPECIAL PROVISIONS FOR DETOUR ROUTE SIGNING DURING CONSTRUCTION
 2- SEE REMOVAL SHEET FOR ALL REMOVAL ITEMS

FILE NAME = sheet11.dgn	USER NAME = labebidism	DESIGNED -	REVISED -
		DRAWN -	REVISED -
		CHECKED -	REVISED -
		DATE -	REVISED -

**STATE OF ILLINOIS
 DEPARTMENT OF TRANSPORTATION**

SPRINGFIELD ROAD & IL 122 PLAN SHEET

SCALE: SHEET NO. OF SHEETS STA. TO STA.

F.A.P. RTE.	SECTION	COUNTY	TOTAL SHEETS	SHEET NO.
705	(126)IL-I	TAZEWELL	36	12
CONTRACT NO. 68934				
ILLINOIS FED. AID PROJECT				