

# DETECTOR LOOPS

F.A.P. 332 (IL. ROUTE 1)  
&  
ROSS LANE



DETECTOR LOOP, TYPE 1

1182 FT.

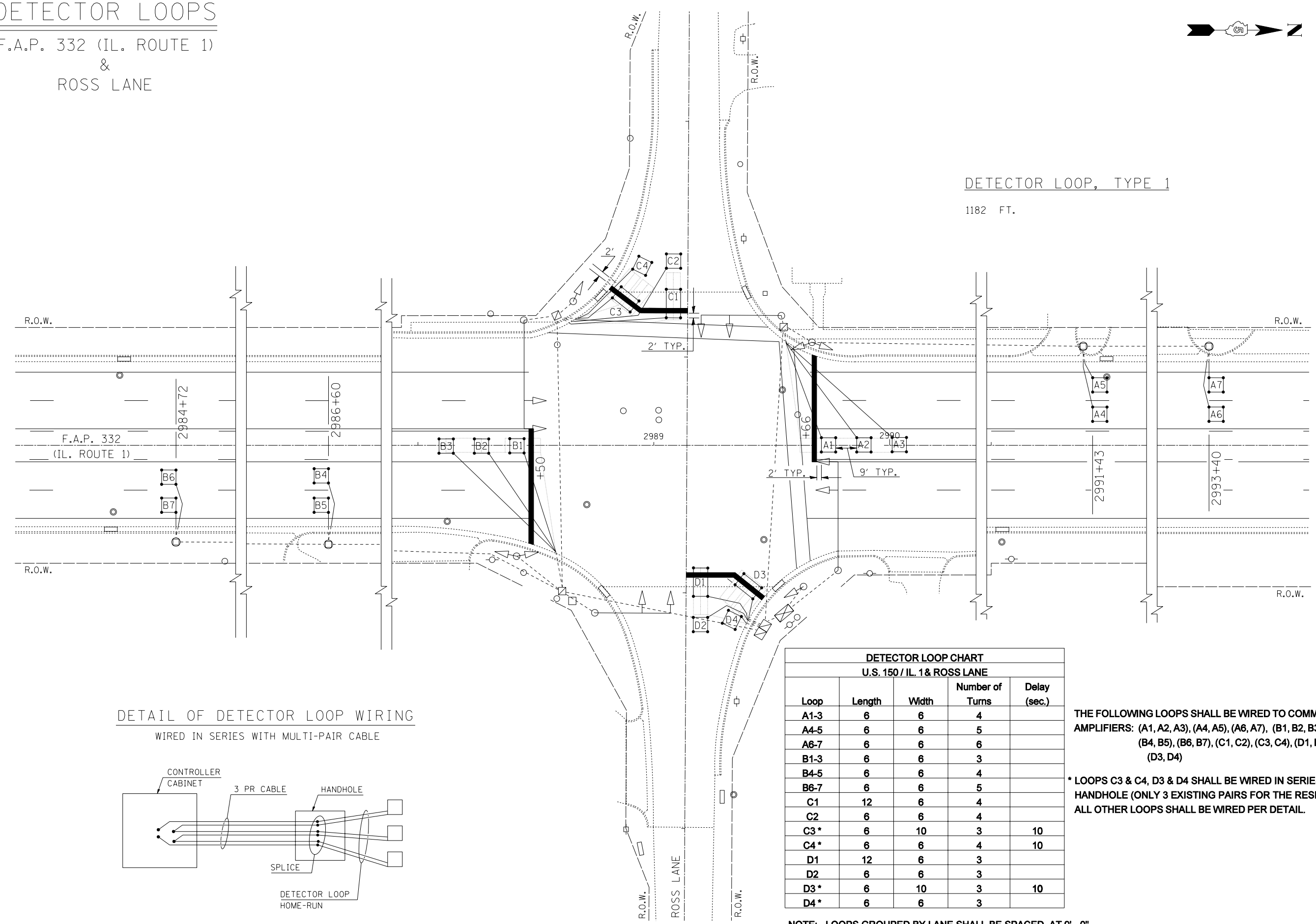

DETAIL OF DETECTOR LOOP WIRING  
WIRED IN SERIES WITH MULTI-PAIR CABLE

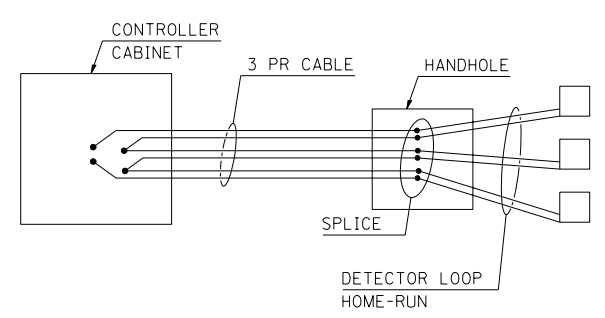

DETECTOR LOOP CHART				
U.S. 150 / IL. 1 & ROSS LANE				
Loop	Length	Width	Number of Turns	Delay (sec.)
A1-3	6	6	4	
A4-5	6	6	5	
A6-7	6	6	6	
B1-3	6	6	3	
B4-5	6	6	4	
B6-7	6	6	5	
C1	12	6	4	
C2	6	6	4	
C3*	6	10	3	10
C4*	6	6	4	10
D1	12	6	3	
D2	6	6	3	
D3*	6	10	3	10
D4*	6	6	3	

THE FOLLOWING LOOPS SHALL BE WIRED TO COMMON AMPLIFIERS: (A1, A2, A3), (A4, A5), (A6, A7), (B1, B2, B3), (B4, B5), (B6, B7), (C1, C2), (C3, C4), (D1, D2), (D3, D4)

\* LOOPS C3 & C4, D3 & D4 SHALL BE WIRED IN SERIES AT THE HANDHOLE (ONLY 3 EXISTING PAIRS FOR THE RESPECTIVE APPROACH). ALL OTHER LOOPS SHALL BE WIRED PER DETAIL.

NOTE: LOOPS GROUPED BY LANE SHALL BE SPACED AT 9' - 0"

FILE NAME =	USER NAME = leroyma	DESIGNED -	REVISED -
et:\pw\work\PWIDOT\LEROYMA\d0144976\d9505300.dgn		DRAWN -	REVISED -
		CHECKED -	REVISED -
		DATE -	REVISED -

STATE OF ILLINOIS  
DEPARTMENT OF TRANSPORTATION

DETECTOR LOOPS			
F.A.P. 332 (IL. ROUTE 1) & ROSS LANE			
SCALE:	SHEET NO.	OF SHEETS	STA. TO STA.

F.A.P. RTE.	SECTION	COUNTY	TOTAL SHEETS	SHEET NO.
332	47RS-9	VERMILION	25	17
FED. ROAD DIST. NO.			ILLINOIS FED. AID PROJECT	
			CONTRACT NO. 70123	