

**EXISTING TYPICAL CROSS SECTION 5**

④ STA. 151 + 46.04 – STA. 163 + 67.80 ⑥

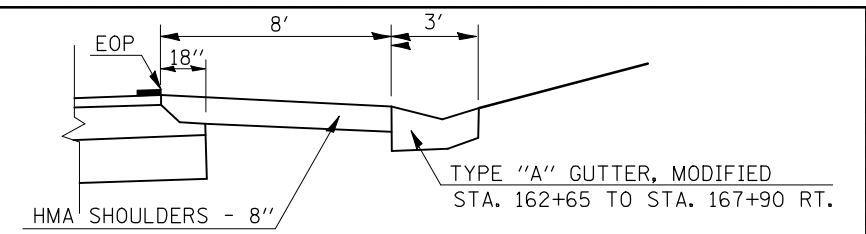

**S.E. TRANSITIONS: 161 + 27.80 – 163 + 67.80**

**TYPE "A" GUTTER, MODIFIED DETAIL**

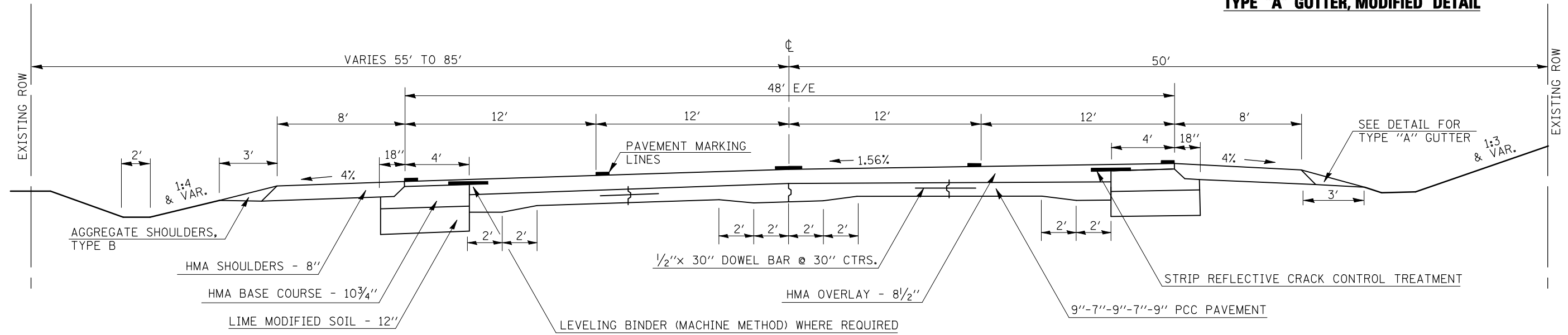

NOTE: SHOULDERS ARE A BAM MIX AND WILL NEED TO BE MILLED SEPARATELY FROM MAINLINE PAVEMENT SO THAT RAP CAN BE STOCKPILED SEPARATELY.

**PROPOSED TYPICAL CROSS SECTION 5**

④ STA. 151 + 46.04 – STA. 163 + 67.80 ⑥

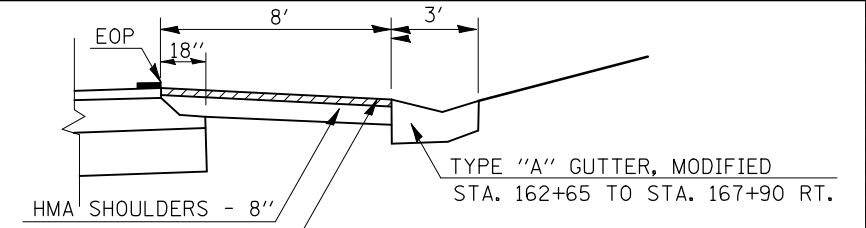

**S.E. TRANSITIONS: 161 + 27.80 – 163 + 67.80**

**TYPE "A" GUTTER, MODIFIED DETAIL**

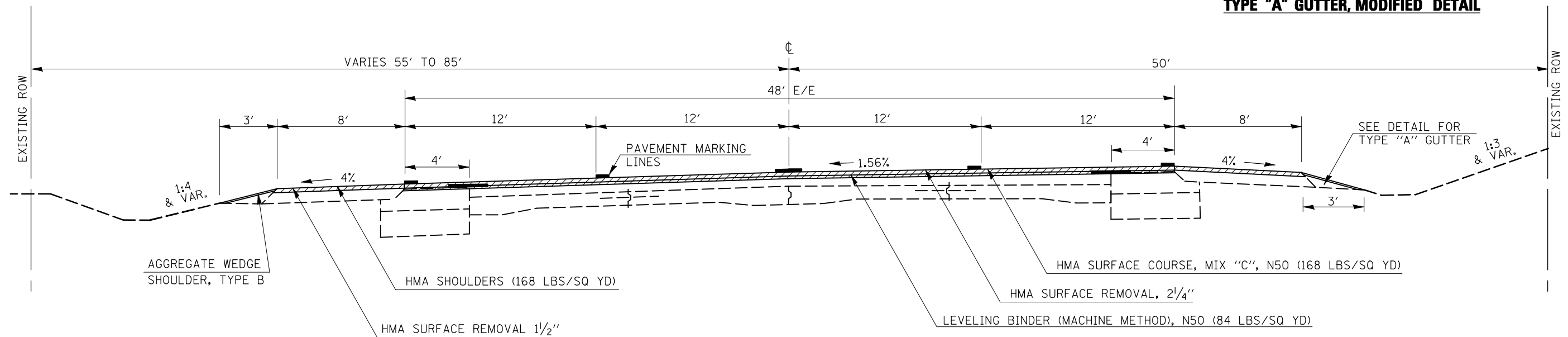

• (48-X1)RS&(48-X2,RX,RX-1)RS-1

FILE NAME =	USER NAME = bowerml	DESIGNED - MLB	REVISED -
ct:\pw\work\p\dot\bowerml\d0145216\d570124-sh-typical.dgn		DRAWN - MLB	REVISED -
PLOT SCALE = 40.0000' / IN.		CHECKED -	REVISED -
PLOT DATE = 1/27/2010		DATE - 1/06/10	REVISED -

**STATE OF ILLINOIS  
DEPARTMENT OF TRANSPORTATION**

**TYPICAL CROSS SECTIONS**

SCALE: SHEET NO. OF SHEETS STA. TO STA.

F.A. RTE.	SECTION	COUNTY	TOTAL SHEETS	SHEET NO.
		VERMILION	86	11
CONTRACT NO. 70124			ILLINOIS FED. AID PROJECT	