

P.T.
STA. 675 + 31.01

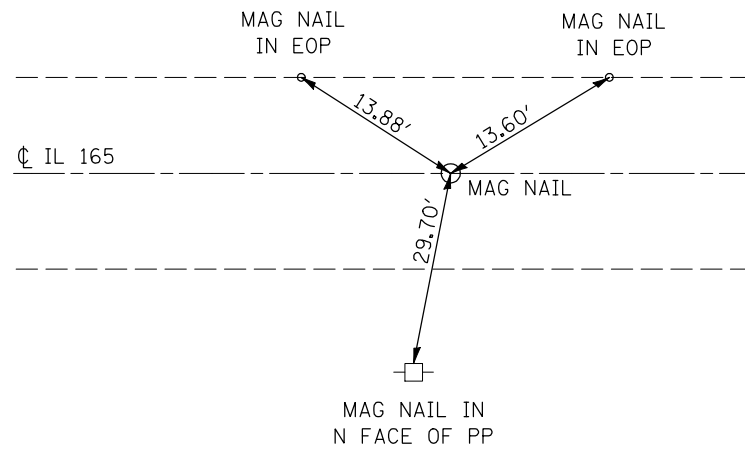

P.I. KINK
STA. 721 + 53.68, 0.0'

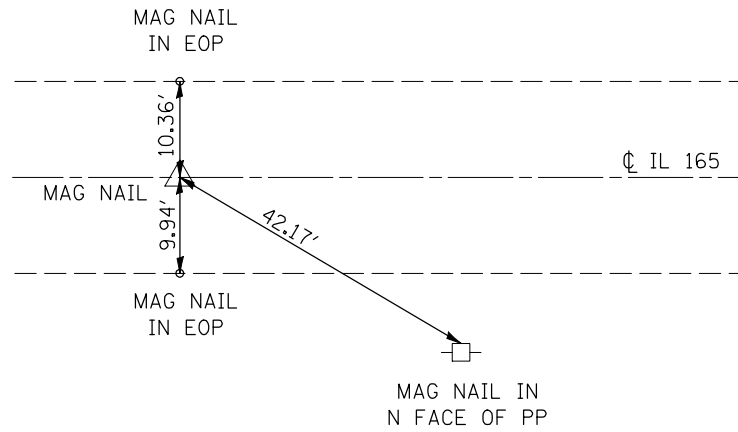

P.C.
STA. 752 + 84.31

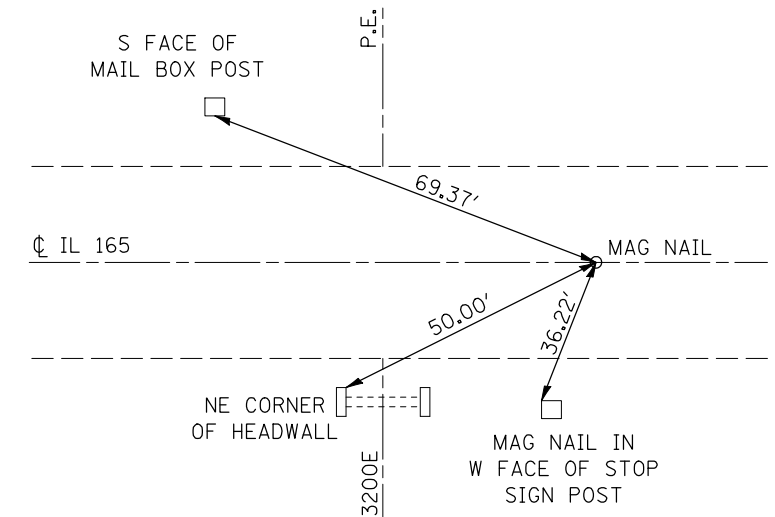

P.T.
762 + 75.83 (BK) =
762 + 84.88 (AH)

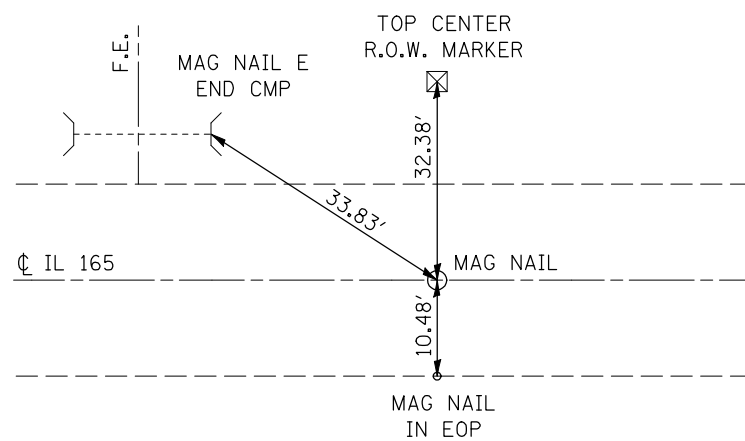

P.I. KINK
STA. 766 + 84.28, 0.0'

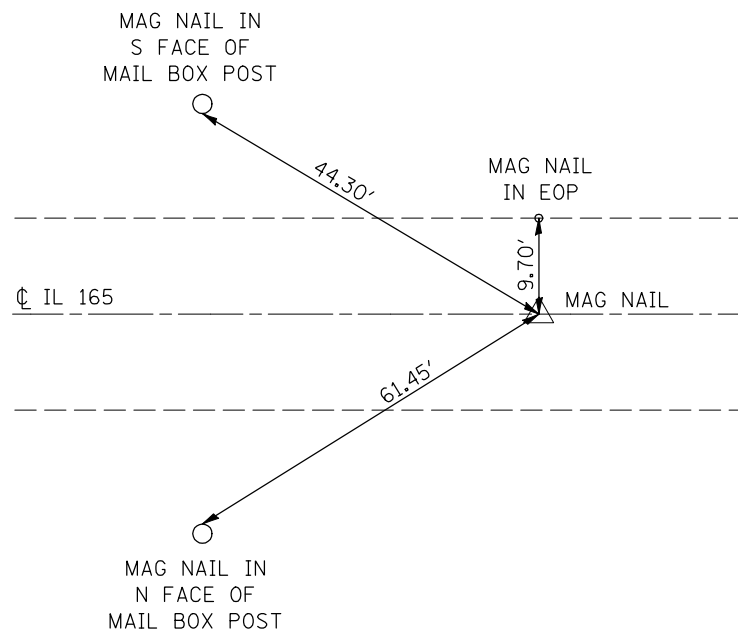

P.I. KINK
STA. 790 + 84.28, 0.0'

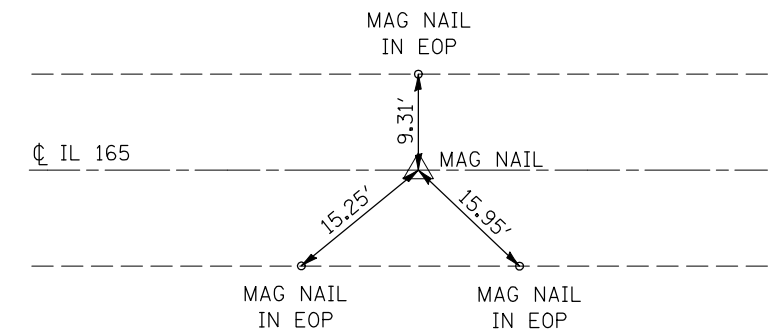

FILE NAME =	USER NAME = coombessf	DESIGNED -	REVISED -
ct:\pw\work\PWIDOT\COOMBESSF\dms87296\g770510-sht-ATB.dgn		DRAWN -	REVISED -
	PLOT SCALE = 40.0000' / IN.	CHECKED -	REVISED -
	PLOT DATE = 1/13/2010	DATE -	REVISED -

STATE OF ILLINOIS
DEPARTMENT OF TRANSPORTATION

CENTERLINE TIE POINTS

SCALE: SHEET NO. OF SHEETS STA. TO STA.

F.A.S. RTE.	SECTION	COUNTY	TOTAL SHEETS	SHEET NO.
2484	(125,126,127)RS-2	MCLEAN	122	20
CONTRACT NO. 70510				
ILLINOIS FED. AID PROJECT				