

P.C.
STA. 803 + 34.15

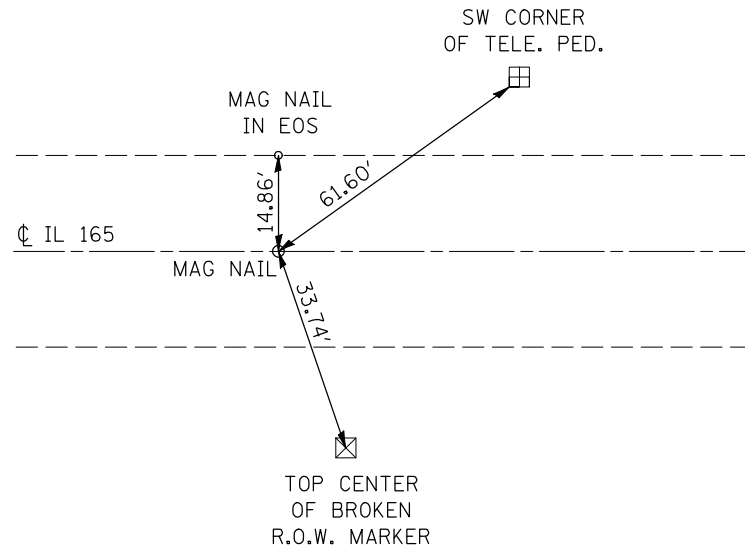

P.T.
812 + 18.51 (BK) =
813 + 54.31 (AH)

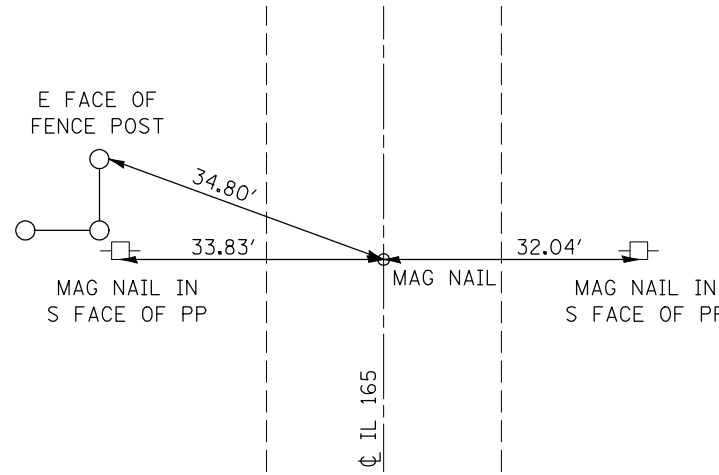

P.T.
847 + 59.00 (BK) =
849 + 88.76 (AH)

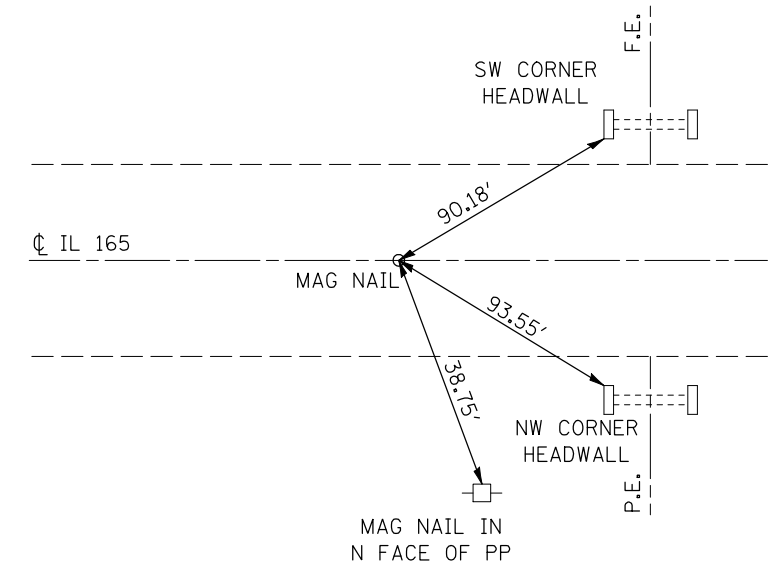

P.C.
STA. 866 + 85.00

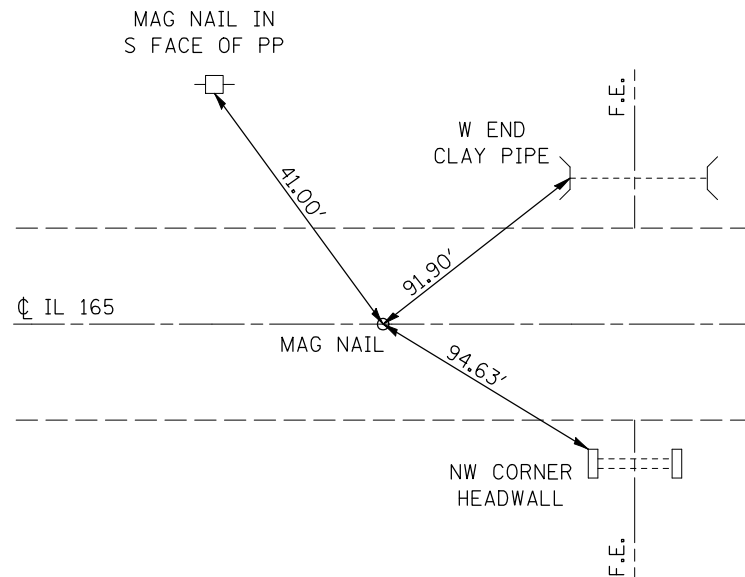

P.I.
STA. 872 + 03.65, 3.25' RT.

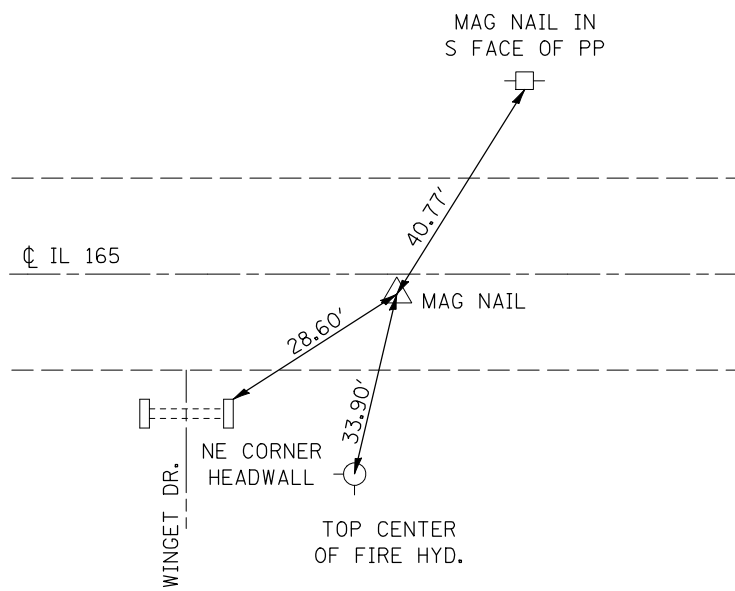

P.T.
STA. 877 + 22.25

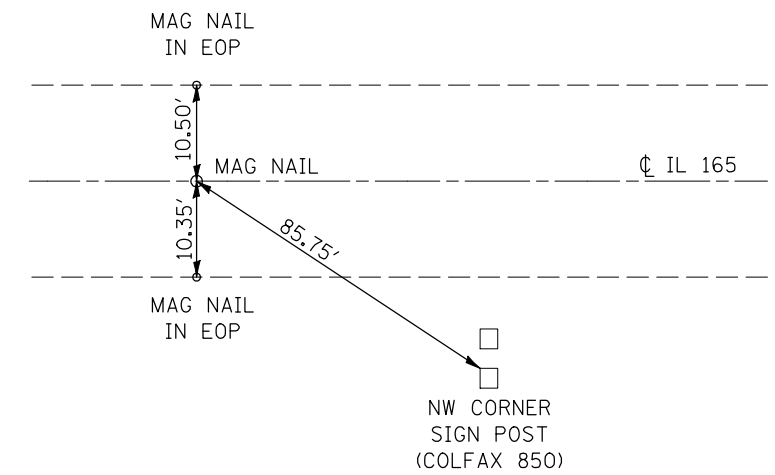

FILE NAME =	USER NAME = coombessf	DESIGNED -	REVISED -
ct:\pw\work\PWIDOT\COOMBESSF\dms87296\0770510-sht-ATB.dgn		DRAWN -	REVISED -
	PLOT SCALE = 40.0000' / IN.	CHECKED -	REVISED -
	PLOT DATE = 1/13/2010	DATE -	REVISED -

STATE OF ILLINOIS
DEPARTMENT OF TRANSPORTATION

CENTERLINE TIE POINTS

SCALE: SHEET NO. OF SHEETS STA. TO STA.

F.A.S. RTE.	SECTION	COUNTY	TOTAL SHEETS	SHEET NO.
2484	(125,126,127)RS-2	MCLEAN	122	21
CONTRACT NO. 70510				
ILLINOIS FED. AID PROJECT				