

SEC 4 , T24N, R5E, 3RD PM

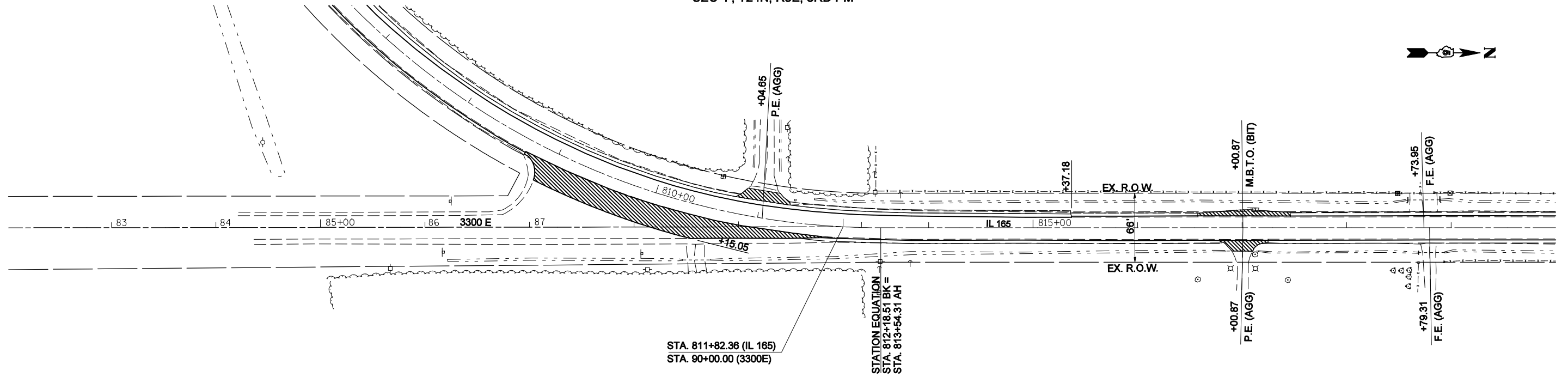

INCIDENTAL HOT-MIX ASPHALT SURFACING

SEC 4 , T24N, R5E, 3RD PM

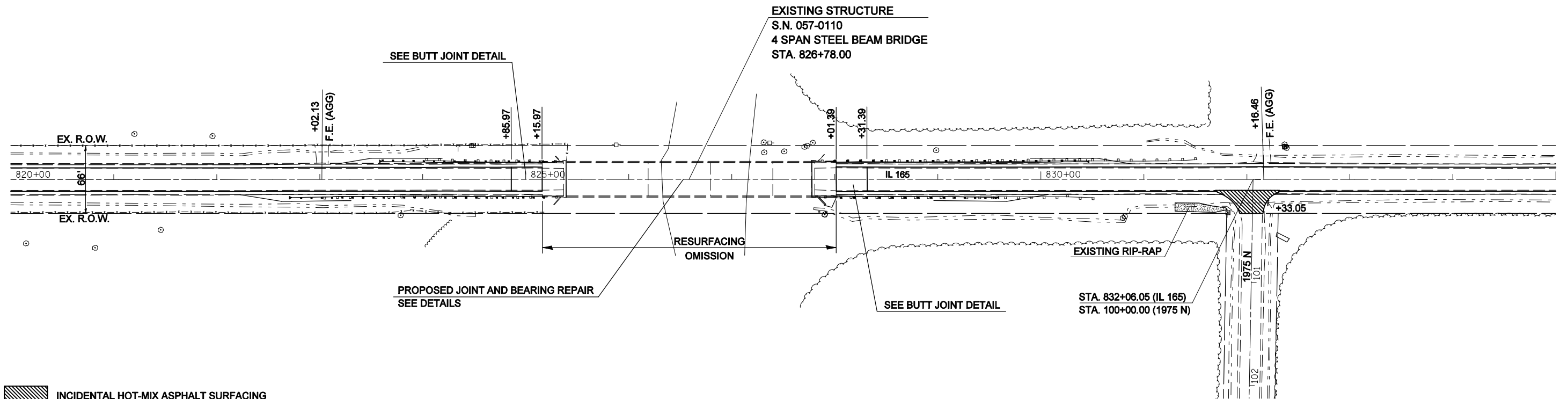

INCIDENTAL HOT-MIX ASPHALT SURFACING

FILE NAME =	USER NAME = coombessf	DESIGNED -	REVISED -
ct:\pw\work\PWIDOT\COOMBESSF\dms87296\0770510-sht-plan.dgn		DRAWN -	REVISED -
	PLOT SCALE = 100.0000' / IN.	CHECKED -	REVISED -
	PLOT DATE = 1/13/2010	DATE -	REVISED -

**STATE OF ILLINOIS  
DEPARTMENT OF TRANSPORTATION**

**PLAN SHEETS**

SCALE: SHEET NO. OF SHEETS STA. 807+00.00 TO STA. 835+00.00

F.A.S. RTE.	SECTION	COUNTY	TOTAL SHEETS	SHEET NO.
2484	(125,126,127)RS-2	MCLEAN	122	35
CONTRACT NO. 70510				
FED. ROAD DIST. NO. ILLINOIS FED. AID PROJECT				