

F.A.P. RTE.	SECTION	COUNTY	TOTAL SHEETS	SHEET NO.
317	(27,28)PT	MCLEAN	5	1
		ILLINOIS	CONTRACT NO. 70823	

STATE OF ILLINOIS
DEPARTMENT OF TRANSPORTATION
DIVISION OF HIGHWAYS

PROPOSED
HIGHWAY PLANS

F.A.P. ROUTE 317 (U.S. 24)
SECTION (27,28)PT

PATCHING
MCLEAN COUNTY

C-95-058-09

CHENOA TO LIVINGSTON CO. LINE

D-95-058-09



FOR INDEX OF SHEETS, SEE SHEET NO. 2
FOR SUMMARY OF QUANTITIES, SEE SHEET NO. 3

CURRENT TRAFFIC DATA

F.A.P. ROUTE 317 (U.S. 24)

	LEG A	LEG B
2009 ADT	4,550	5,100
PC%	81.2	82.5
SU%	6.1	6.5
MU%	12.7	11.0

LEG A - CHENOA TO WESTON
LEG B - WESTON TO END OF PROJECT

DESIGN DESIGNATION

N/A

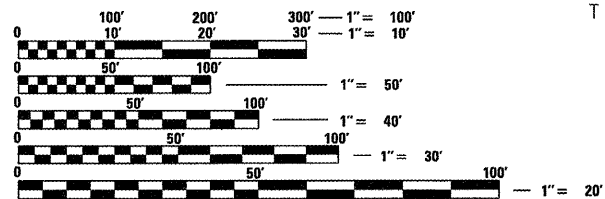

FULL SIZE PLANS HAVE BEEN PREPARED USING STANDARD ENGINEERING SCALES. REDUCED SIZED PLANS WILL NOT CONFORM TO STANDARD SCALES. IN MAKING MEASUREMENTS ON REDUCED PLANS, THE ABOVE SCALES MAY BE USED.

J.U.L.I.E.
JOINT UTILITY LOCATION INFORMATION FOR EXCAVATION
1-800-892-0123
OR 811

CHENOA, YATES TOWNSHIPS

PROJECT ENGINEER: JASON STULTS
DESIGNER: DAN O'DEAR
(217)465-4181
CONTRACT NO. 70823

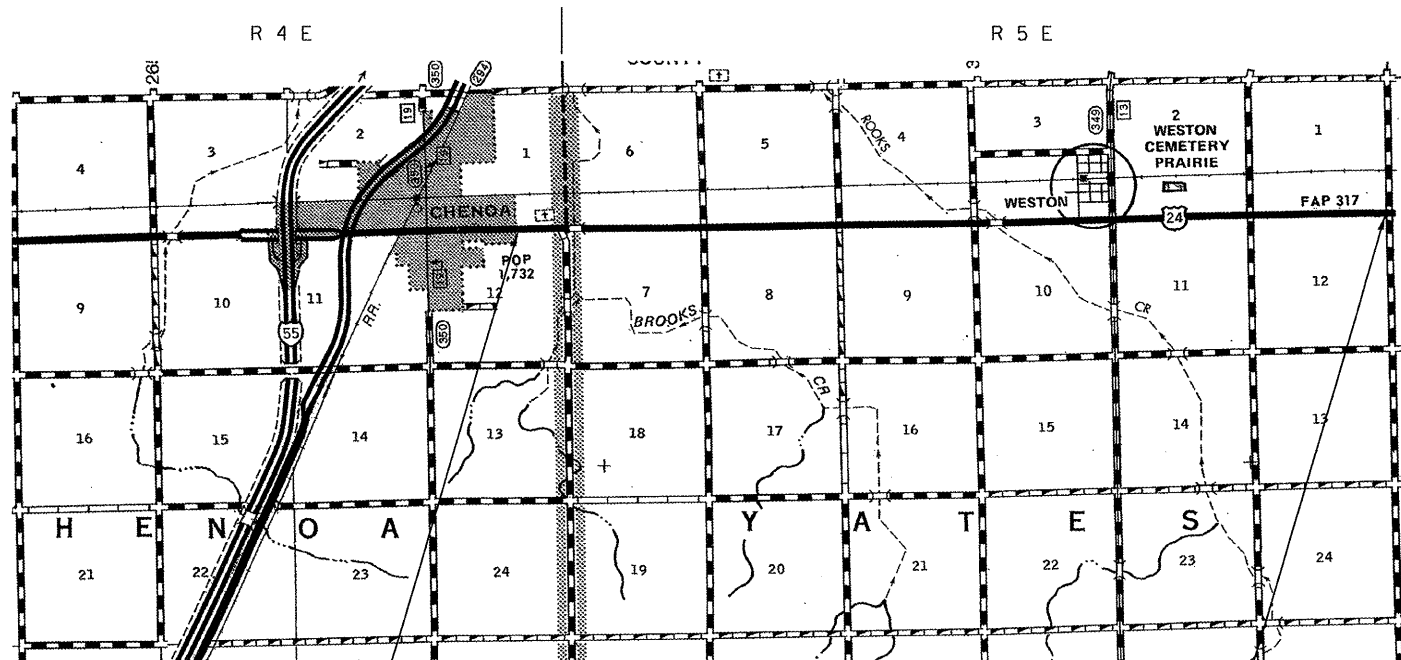

SECTION (27,28)PT
BEGIN STATION 2+67.00

SECTION (27,28)PT
END STATION 363+00.00



GROSS LENGTH OF PROJECT = 36,033.00 FT. = 6.824 MILES
NET LENGTH OF PROJECT = 36,033.00 FT. = 6.824 MILES

STATE OF ILLINOIS
DEPARTMENT OF TRANSPORTATION
DIVISION OF HIGHWAYS

SUBMITTED 2/3 2010

Jason K. Bowen
DEPUTY DIRECTOR OF HIGHWAYS, REGION ENGINEER

Scott E. Stitt P.E. PE
ENGINEER OF DESIGN AND ENVIRONMENT

Christine M. Reed
DIRECTOR OF HIGHWAYS, CHIEF ENGINEER

PRINTED BY THE AUTHORITY
OF THE STATE OF ILLINOIS