

LOCATION MAP #3
F.A.S. 1478 (LEROY SPUR), FROM U.S. 136
TO I-74

MCLEAN COUNTY / 2-LANE RURAL & CURB & GUTTER

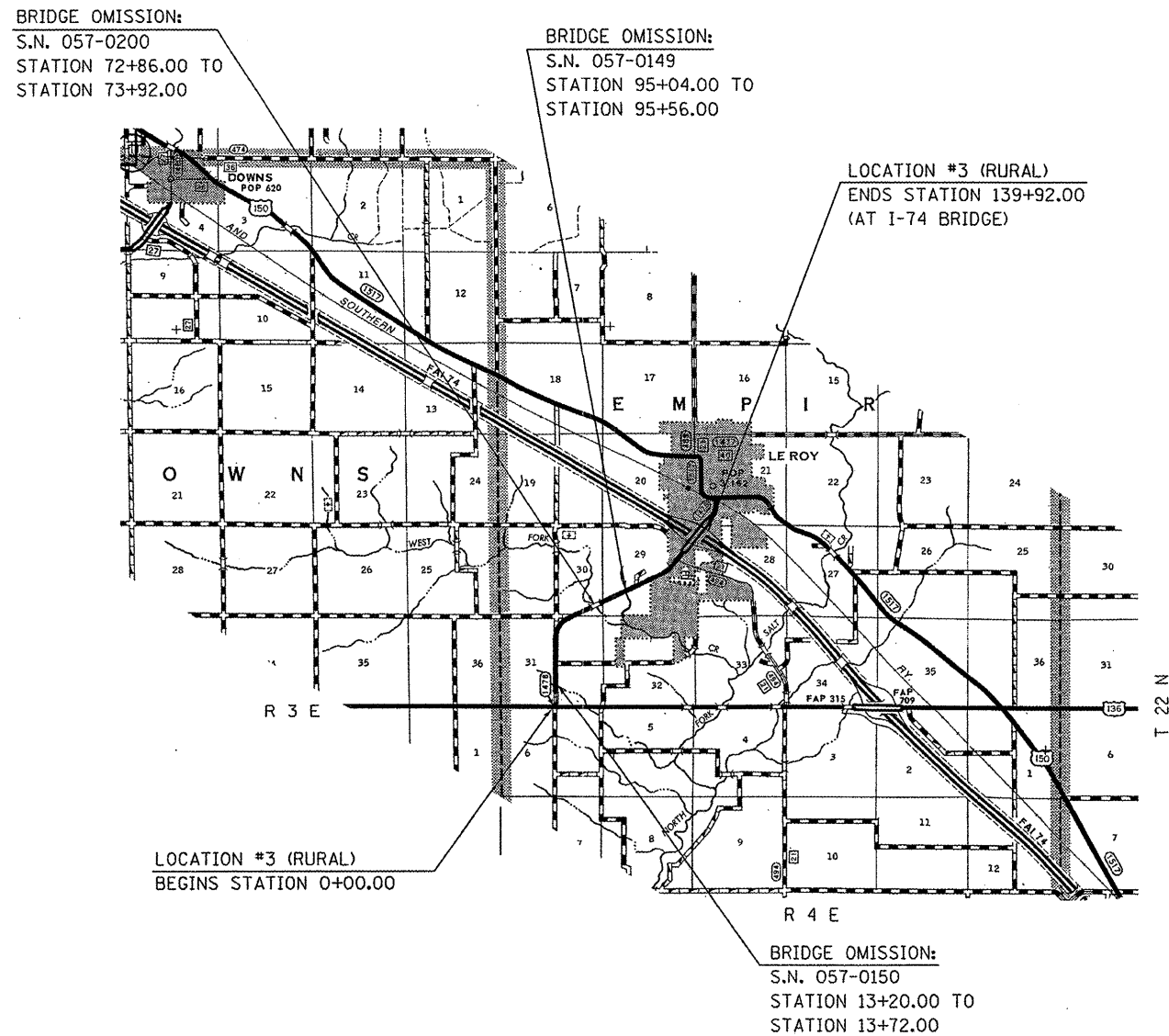

TOTAL LENGTH OF SECTION = 13,992.00 FT. = 2.650 MILES
NET LENGTH OF SECTION = 13,782.00 FT. = 2.610 MILES

LOCATION MAP #4
F.A.S. 493 (SAYBROOK SPUR), FROM SAYBROOK
TO IL 9

MCLEAN COUNTY / RURAL 2 - LANE

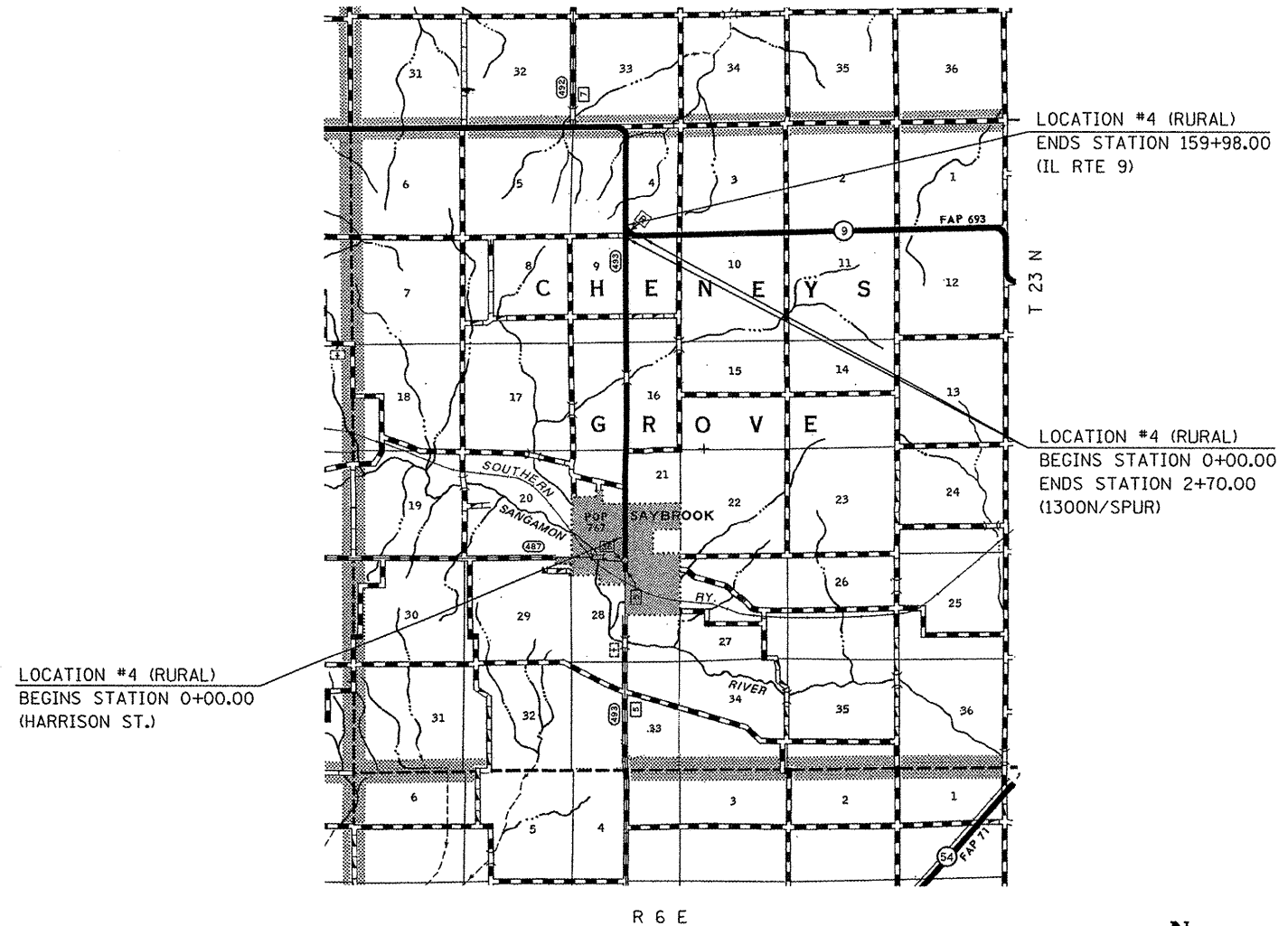

TOTAL LENGTH OF SECTION = 16,268.00 FT. = 3.081 MILES
NET LENGTH OF SECTION = 16,268.00 FT. = 3.081 MILES

FILE NAME =	USER NAME = oar-lock.jd	DESIGNED - GMR	REVISED -
ct:\p\work\PWID001\CEARLOCK.JD\01180411\070829-sh1-loc.maps.dgn		DRAWN - BBP	REVISED -
	PLDT SCALE = 40.0000 / IN.	CHECKED -	REVISED -
	PLDT DATE = 1/28/2010	DATE - 01/12/10	REVISED -

STATE OF ILLINOIS
DEPARTMENT OF TRANSPORTATION

LOCATION MAPS	
LOCATIONS 3 & 4	
SCALE:	STATION TO STATION
SHEET NO. 2 OF 3 SHEETS	STA. TO STA.

F.A.S. RTE. VAR.	SECTION	COUNTY	TOTAL SHEETS	SHEET NO.
	*	**	20	4
CONTRACT NO. 70829				
ILLINOIS FED. AID PROJECT				

*D-5 CRACK & JOINT SEAL 2010-1
 **MCLEAN & PIATT