

# LOCATION MAP 4

## IL 133

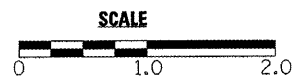
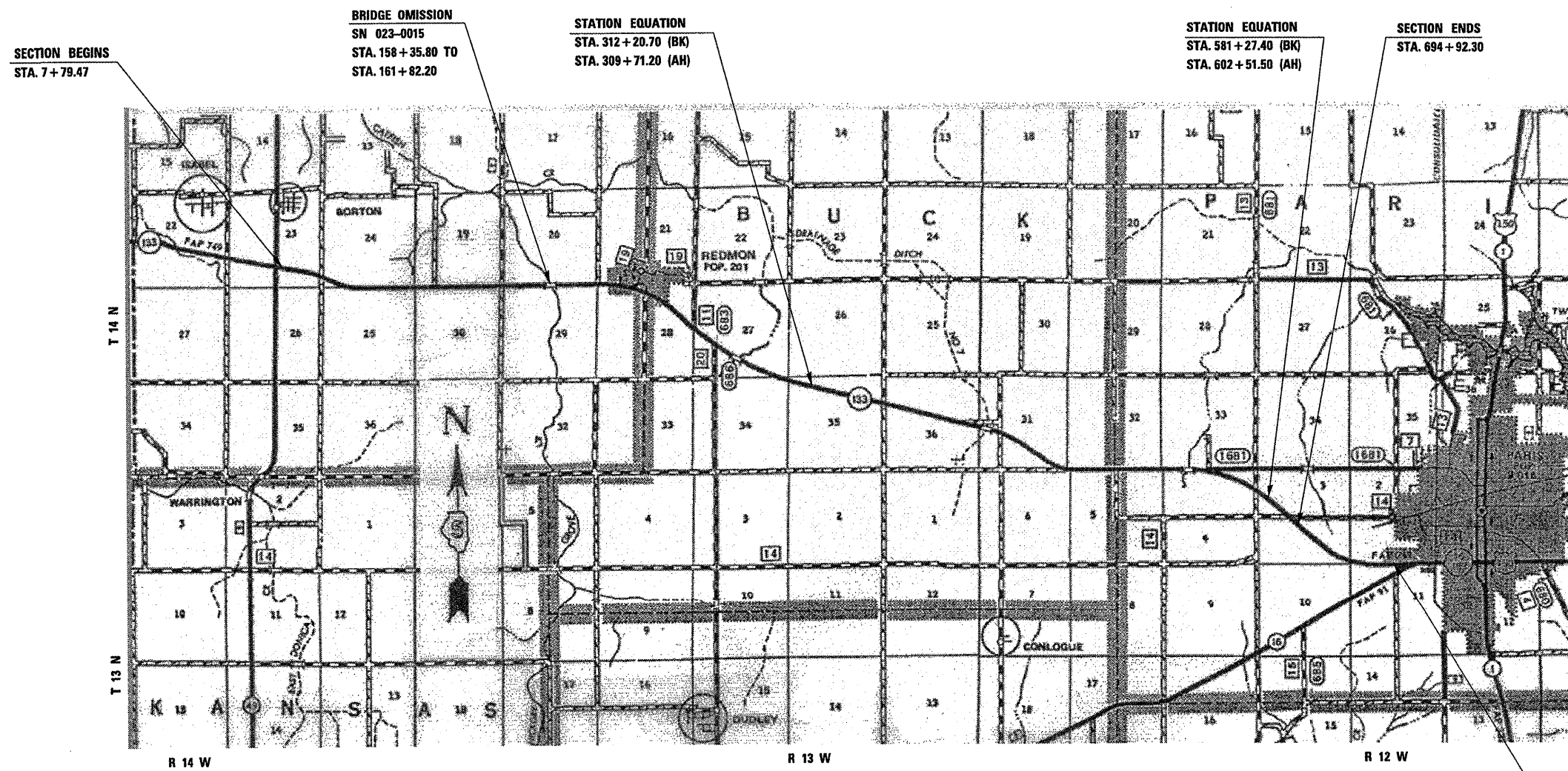

TOTAL LENGTH OF SECTION & PROJECT = 66,838.23 FEET = 12.659 MILES  
 NET LENGTH OF SECTION & PROJECT = 66,491.83 FEET = 12.593 MILES

FILE NAME =	USER NAME = creigre	DESIGNED - JAH	REVISED -
c:\pwork\pwork\creigre\d8176226\0570330-SHT-COVER.dgn	SHT-COVER.dgn	DRAWN -	REVISED -
PLOT SCALE = 40.0000 "/td> <td>CHECKED -</td> <td>REVISED -</td> <td>REVISED -</td>	CHECKED -	REVISED -	REVISED -
PLOT DATE = 2/4/2010	DATE - 12/23/09	REVISED -	REVISED -

STATE OF ILLINOIS  
 DEPARTMENT OF TRANSPORTATION

LOCATION MAP 4	
SCALE:	SHEET NO. 5 OF 5 SHEETS STA. 7+79.47 TO STA. 623+25.00

F.A. RTE.	SECTION	COUNTY	TOTAL SHEETS	SHEET NO.
VAR	*	VARIOUS	24	7
CONTRACT NO. 70830				
ILLINOIS FED. AID PROJECT				

\*D5 CRACK & JOINT SEAL 2010-2