

**STATE OF ILLINOIS
DEPARTMENT OF TRANSPORTATION
DIVISION OF HIGHWAYS**

DETAILED LOCATION MAP /F.A.I. ROUTE 55

STRUCTURE INFORMATION

STRUCTURE NO.	SCOPE OF WORK
057-8510	NO PROPOSED WORK
057-8511	MILL & HMA RESURF, 3 1/4"
057-0162	MILL & RESURF UNDER OVERHEAD
057-0163	STRUCTURE OMISSION
057-0164	STRUCTURE OMISSION
057-8512	MILL & HMA RESURF, 3 1/4"
057-8513	MILL & HMA RESURF, 3 1/4"
057-0165	MILL & RESURF UNDER OVERHEAD
057-8514	MILL & HMA RESURF, 3 1/4"
057-0166	MILL & RESURF UNDER OVERHEAD
057-8301	MILL & HMA RESURF, 3 1/4"
057-0167	STRUCTURE OMISSION
057-0168	STRUCTURE OMISSION
057-0169	STRUCTURE OMISSION
057-0170	STRUCTURE OMISSION

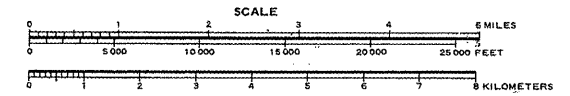
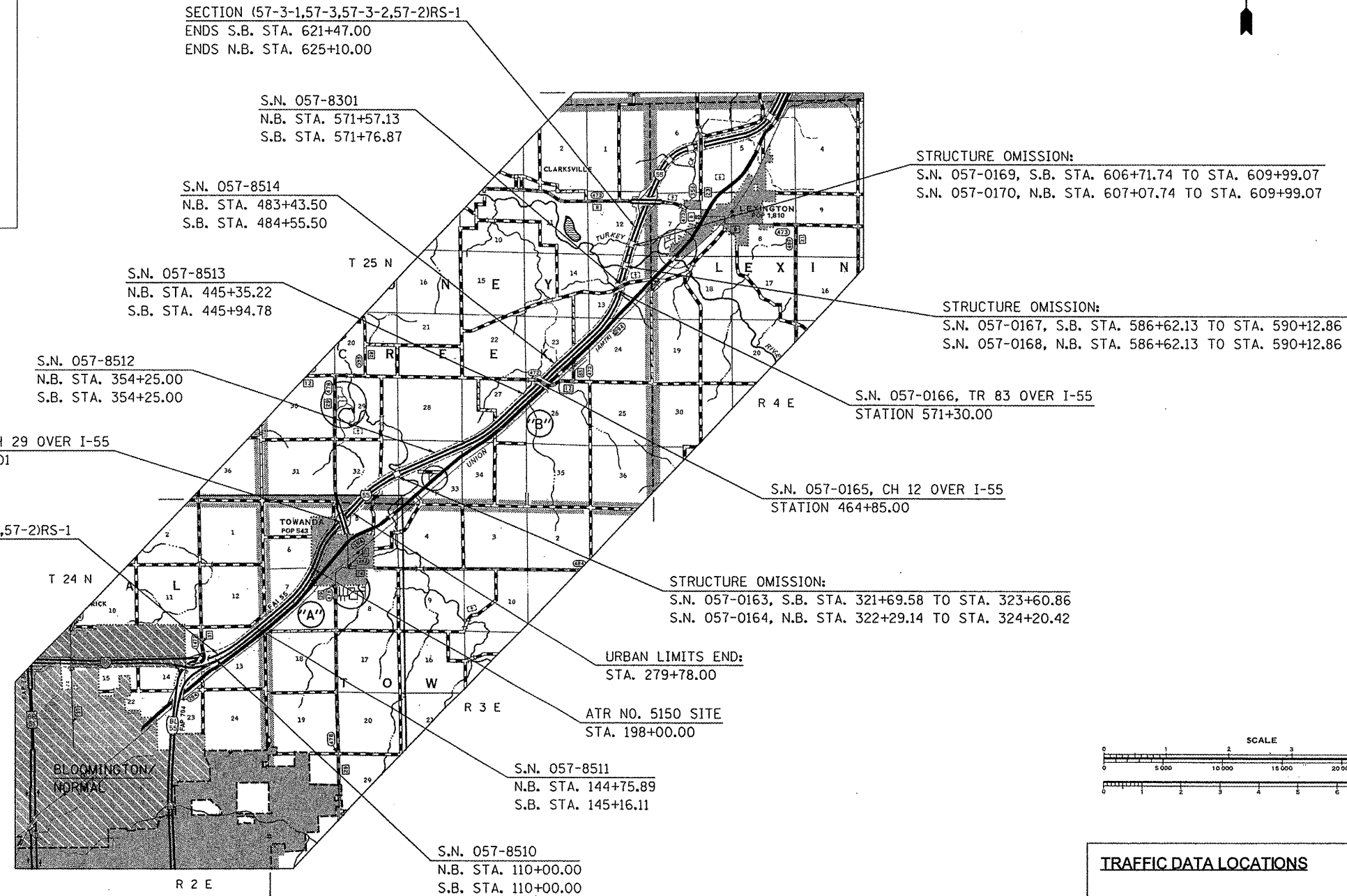

TOTAL LENGTH OF SECTION & PROJECT = 51,046.00 FEET = 9.668 MILES
NET LENGTH OF SECTION & PROJECT = 50,212.66 FEET = 9.510 MILES
(NOTE: LENGTHS ARE CALCULATED ALONG NORTHBOUND LANE)

TRAFFIC DATA LOCATIONS

F.A.I. ROUTE 55

- LEG "A" = I-55 BUSN AT NORMAL TO FAU 6431 INTERCHANGE AT TOWANDA
- LEG "B" = FAU 6431 INTERCHANGE AT TOWANDA TO FAS 473 INTERCHANGE AT LEXINGTON

FILE NAME =	USER NAME = ppersonbr	DESIGNED - GAE	REVISED -
C:\pwork\PIERSONBR\0176145\05	70847-sht-loc.mep.dgn	DRAWN - BBP	REVISED -
	PLOT SCALE = 40.0000' / IN.	CHECKED -	REVISED -
	PLOT DATE = 2/4/2010	DATE - 12/30/09	REVISED -

**STATE OF ILLINOIS
DEPARTMENT OF TRANSPORTATION**

DETAILED LOCATION MAP - F.A.I. ROUTE 55

SCALE: N/A SHEET NO. 1 OF 1 SHEETS STA. TO STA.

F.A.I. RTE.	SECTION	COUNTY	TOTAL SHEETS	SHEET NO.
55		MCLEAN	22	2
*57-3-1,57-3,57-3-2,57-2)RS-1			CONTRACT NO. 70847	
ILLINOIS FED. AID PROJECT				