

F.A.P. RTE.	SECTION	COUNTY	TOTAL SHEETS	SHEET NO.
310	69-12LS	MORGAN	16	1

STATE OF ILLINOIS
DEPARTMENT OF TRANSPORTATION
DIVISION OF HIGHWAYS
**PLANS FOR PROPOSED
FEDERAL AID HIGHWAY**

F.A.P. ROUTE 310 (U.S. HWY. 67)
SECTION 69-12LS
PROJECT LANDSCAPING
MORGAN COUNTY
C-96-175-10

FOR INDEX OF SHEETS, SEE SHEET NO. 2

STANDARD

- 000001-05
- 701101-02
- 701106-02
- 701901-01

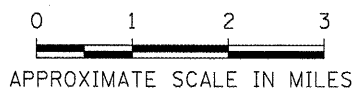
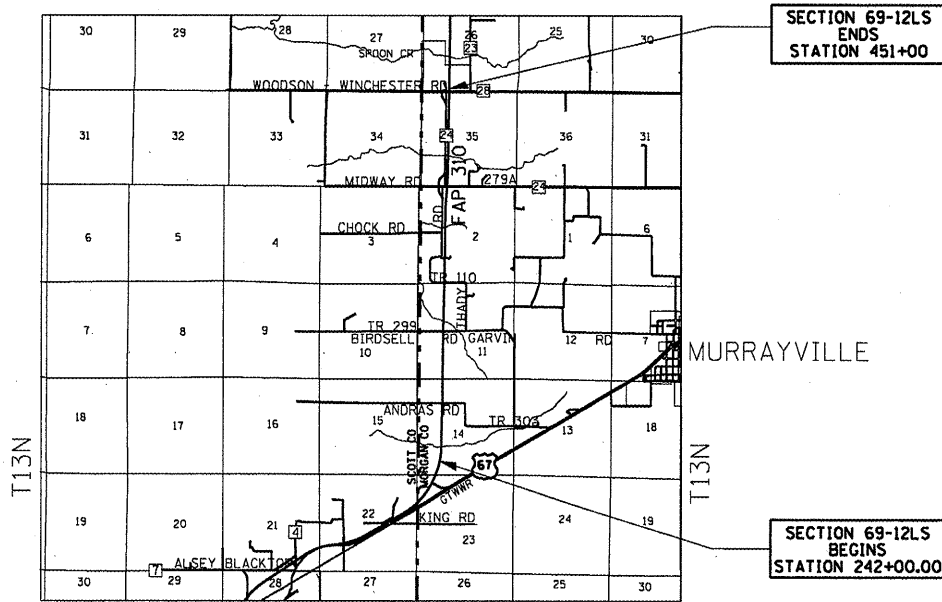
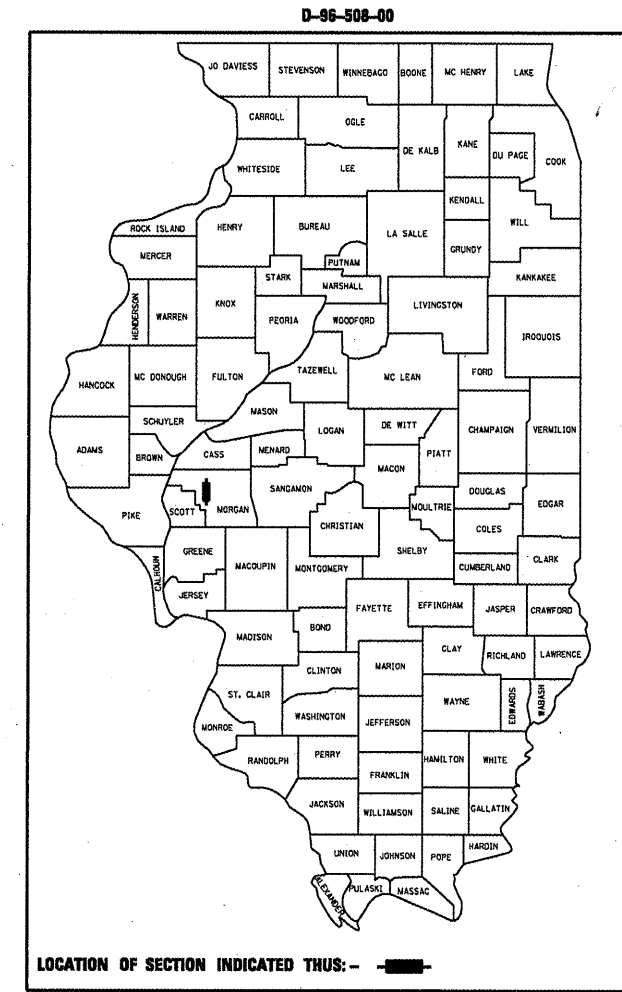

NET LENGTH OF SECTION 69-12LS = 20,900.00 FEET = 3.958 MILES

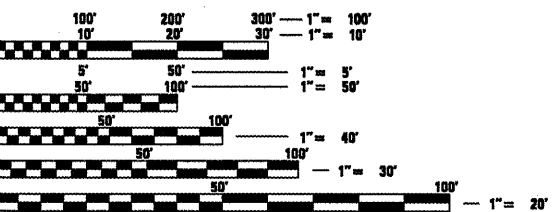

FULL SIZE PLANS HAVE BEEN PREPARED USING STANDARD ENGINEERING SCALES. REDUCED SIZED PLANS WILL NOT CONFORM TO STANDARD SCALES. IN MAKING MEASUREMENTS ON REDUCED PLANS, THE ABOVE SCALES MAY BE USED.

J.U.L.I.E.
JOINT UTILITY LOCATION INFORMATION FOR EXCAVATION
1-800-892-0123

DESIGN DESIGNATION
FAP 310
ARTERIAL
ADT = 10700 (2022)
% SU = 3
% MU = 6

CONTRACT NO. 72533



STATE OF ILLINOIS
DEPARTMENT OF TRANSPORTATION
DIVISION OF HIGHWAYS

SUBMITTED *February 3, 2010*
Roger Z. Dmoch
DISTRICT ENGINEER

March 19, 2010
Scott E. Stitt, P.E.
ENGINEER OF DESIGN AND ENVIRONMENT

March 19, 2010
Christine M. Reed
DIRECTOR, DIVISION OF HIGHWAYS

HUTCHISON ENGINEERING, INC
JACKSONVILLE, ILLINOIS

PROJECT ENGINEER: JOHN C. NEGANGARD (217) 782-6990
SENIOR SQUAD LEADER: VINCE MADONIA (217) 785-9046

F.A.P. RTE.	SECTION	COUNTY	TOTAL SHEETS	SHEET NO.
310	69-12LS	MORGAN	16	2
STA.		TO STA.		
FED. ROAD DIST. NO.		ILLINOIS FED. AID PROJECT		

100%
STATE
Y003

SUMMARY OF QUANTITIES

PAY CODE ITEM	ITEM	UNIT	TOTAL	QUANTITY PER SHEET															
				3	4	5	6	7	8	9	10	11	12	13	14	15	16		
25000750	MOWING	ACRE	38.4	5.4	4.8							3.9	4.8	5.5	2.2	8.1	1.9	1.8	
25001800	SEEDING, CLASS 4 (MODIFIED)	ACRE	38.4	5.4	4.8							3.9	4.8	5.5	2.2	8.1	1.9	1.8	
6T100100	MOBILIZATION	L SUM	1																
A2001020	TREE, ACER RUBRUM (RED MAPLE), 2-1/2" CALIPER, BALLED AND BURLAPPED	EACH	53	5	2	5	3		5	2	5	2	5	8	6			5	
A2001720	TREE, ACER SACCHARUM (SUGAR MAPLE), 2-1/2" CALIPER, BALLED AND BURLAPPED	EACH	39	3	3	2	2	3	2		3	2	6	4	5			4	
A2002320	TREE, BETULA NIGRA (RIVER BIRCH), 2-1/2" CALIPER, BALLED AND BURLAPPED	EACH	20	5					2	4		5			2	2			
A2002916	TREE, CELTIS OCCIDENTALIS (COMMON HACKBERRY), 2" CALIPER, BALLED AND BURLAPPED	EACH	17	2	3						3	3		4			2		
A2007116	TREE, QUERCUS RUBBA (RED OAK), 2" CALIPER, BALLED AND BURLAPPED	EACH	24	2	3	2	2	0			3		5	2	2			3	
A2007720	TREE, TAXODIUM DISTICHUM SHAWNEE BRAVE (SHAWNEE BRAVE BALD CYPRESS), 2-1/2" CALIPER, BALLED AND BURLAPPED	EACH	8									3	2		3				
B2001166	TREE, CERCIS CANADENSIS (EASTERN REDBUD), 6' HEIGHT, CLUMP FORM, BALLED AND BURLAPPED	EACH	18			2					2		2		5	2		5	
B2001666	TREE, CRATAEGUS CRUSGALLI INERMIS (THORN LESS COCKSPUR HAWTHORN), 6' HEIGHT, SHRUB FORM, BALLED AND BURLAPPED	EACH	13	3		2			2			3					3		
B2001966	TREE, CRATAEGUS PHAENOPYRUM (WASHINGTON HAWTHORN), 6' HEIGHT, CLUMP FORM, BALLED AND BURLAPPED	EACH	9		2			2			2						3		
B2003066	TREE, MALUS BRANDYWINE (BRANDYWINE CRAB APPLE), 6' HEIGHT, CLUMP FORM, BALLED AND BURLAPPED	EACH	10		3			3			2						2		
B2004316	TREE, MALUS RADIANT (RADIANT CRAB APPLE), 2" CALIPER, TREE FORM, BALLED AND BURLAPPED	EACH	20	3		3	2		3			2	3					2	
B2005066	TREE, MALUS SNOWDRIFT (SNOWDRIFT CRAB APPLE), 6' HEIGHT, CLUMP FORM, BALLED AND BURLAPPED	EACH	17	2		2		2	3			2	2				2	2	
D2002972	EVERGREEN, PINUS STROBUS (EASTERN WHITE PINE), 6' HEIGHT, BALLED AND BURLAPPED	EACH	227		10		10	10	10			42	24	23	37	9	26	26	
K0026700	TREE CARE	EACH	2																
K0026710	TREE CARE MULCH	L SUM	1																
K0026720	TREE INTERMEDIATE AND SHRUB WATERING	UNIT.	5																

INDEX

- 1 COVER SHEET, STANDARD
- 2 INDEX, SUMMARY OF QUANTITIES, GENERAL NOTES
- 3-16 LANDSCAPING PLANS

GENERAL NOTES

1. THE TREES SHALL BE SPACED A MINIMUM OF 20 FEET APART.
2. THE LOCATIONS OF ALL PLANTS SHOWN ON THE PLANS ARE APPROXIMATE. THE DISTRICT LANDSCAPE ARCHITECT AND THE DEPARTMENT SHALL HAVE THE RIGHT TO ADJUST THE LOCATION OF PLANTS. NO ADDITIONAL COMPENSATION WILL BE ALLOWED THE CONTRACTOR FOR CONFORMING WITH THIS PROVISION.
3. CLASS 4 SEEDING AREAS SHALL EXTEND FROM A LINE 20 FEET FROM THE EDGES OF THE OUTSIDE SHOULDERS TO THE ACCESS CONTROL OR THE RIGHT-OF-WAY LINES AT THE LOCATIONS SHOWN ON THE PLANS.
4. THE SEEDING SHALL NOT BEGIN UNTIL ALL OTHER WORK HAS BEEN COMPLETED ON THIS SECTION UNLESS OTHERWISE DIRECTED BY THE LANDSCAPE ARCHITECT OR THE ENGINEER. NO FERTILIZER NUTRIENTS OR MULCH WILL BE REQUIRED FOR THE INTER SEEDING.
5. THE CONSTRUCTION LIMITS SHOWN ON THE PLANS ARE FOR THE GRADING AND PAVING OF THE VARIOUS CONSTRUCTION SECTIONS AND SHALL NOT BE CONSTRUED TO BE THE LIMITS FOR THE LANDSCAPING ON THIS PROJECT.

COMMITMENTS

REVISIONS	
NAME	DATE

ILLINOIS DEPARTMENT OF TRANSPORTATION
**INDEX, SUMMARY OF QUANTITIES,
 AND GENERAL NOTES**
 FAP ROUTE 310
 SCALE: VERT. _____
 HORIZ. _____
 DATE _____
 DRAWN BY _____
 CHECKED BY _____

F.A.P. RTE.	SECTION	COUNTY	TOTAL SHEETS	SHEET NO.
310	69-12LS	MORGAN	16	3
STA. 242+00		TO STA. 256+00		
FED. ROAD DIST. NO.	ILLINOIS FED. AID PROJECT			

BEGIN SECTION 69-12LS
STA. 242+00.00

PROF. SEEDING CLASS 4 (MODIFIED)

CONSTRUCTION LIMITS (TYP.)

CL FAP 310 (US 67)

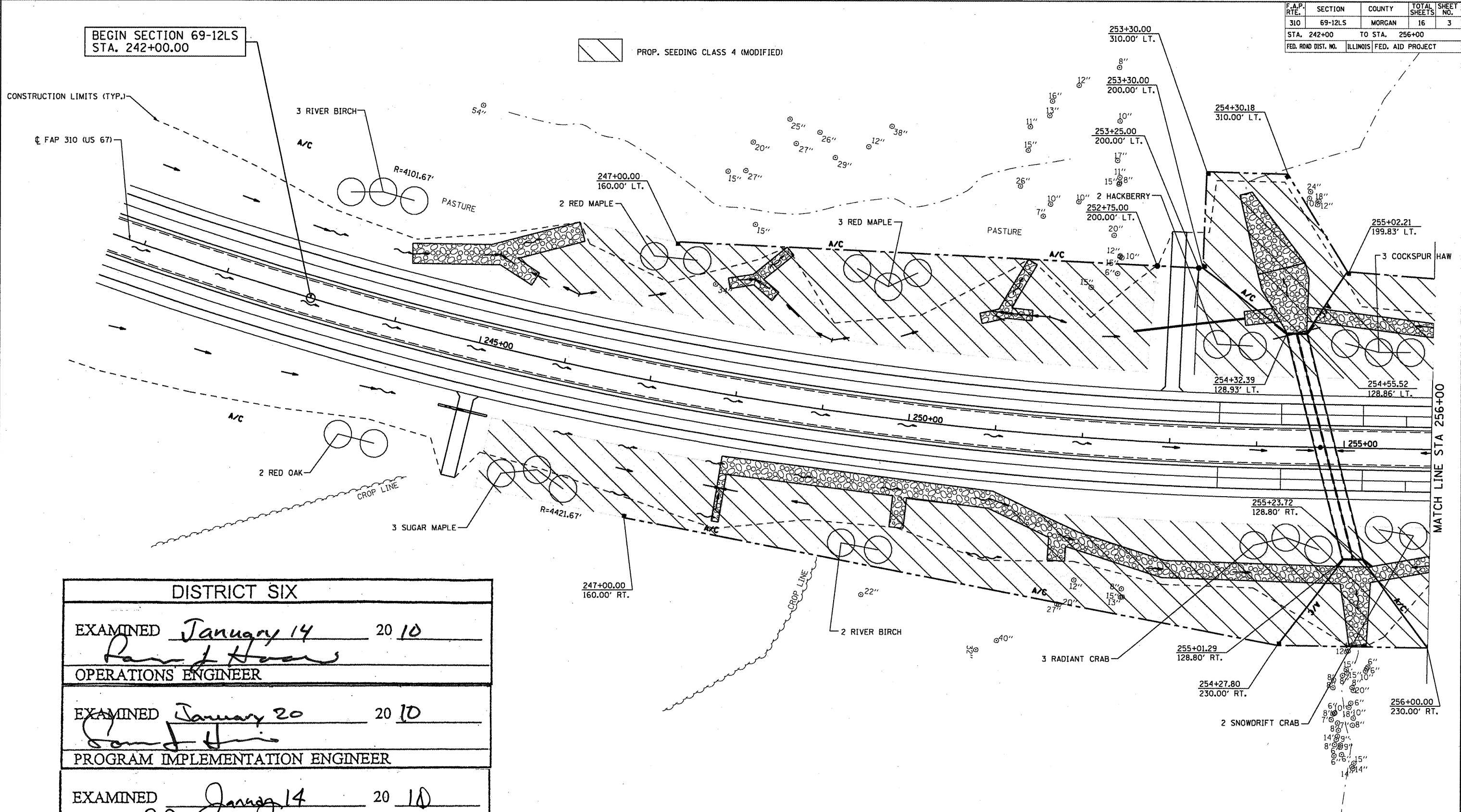

DISTRICT SIX		
EXAMINED	January 14	20 10
<i>Paul J. Hoars</i>		
OPERATIONS ENGINEER		
EXAMINED	January 20	20 10
<i>Sam J. Hill</i>		
PROGRAM IMPLEMENTATION ENGINEER		
EXAMINED	January 14	20 10
<i>ARUCI</i>		
PROGRAM DEVELOPMENT ENGINEER		

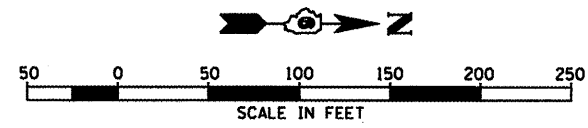

REVISIONS	
NAME	DATE

ILLINOIS DEPARTMENT OF TRANSPORTATION

FAP ROUTE 310
LANDSCAPING PLAN
STA 242+00 TO STA 256+00

SCALE: VERT. _____
HORIZ. _____

DATE _____ DRAWN BY _____
CHECKED BY _____

F.A.P. RTE.	SECTION	COUNTY	TOTAL SHEETS	SHEET NO.
310	69-12LS	MORGAN	16	4
STA. 256+00		TO STA. 271+00		
FED. ROAD DIST. NO.	ILLINOIS	FED. AID PROJECT		

 PROP. SEEDING CLASS 4 (MODIFIED)

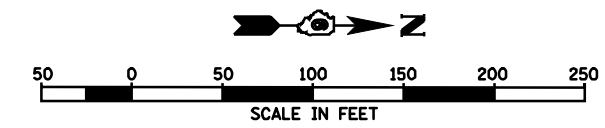
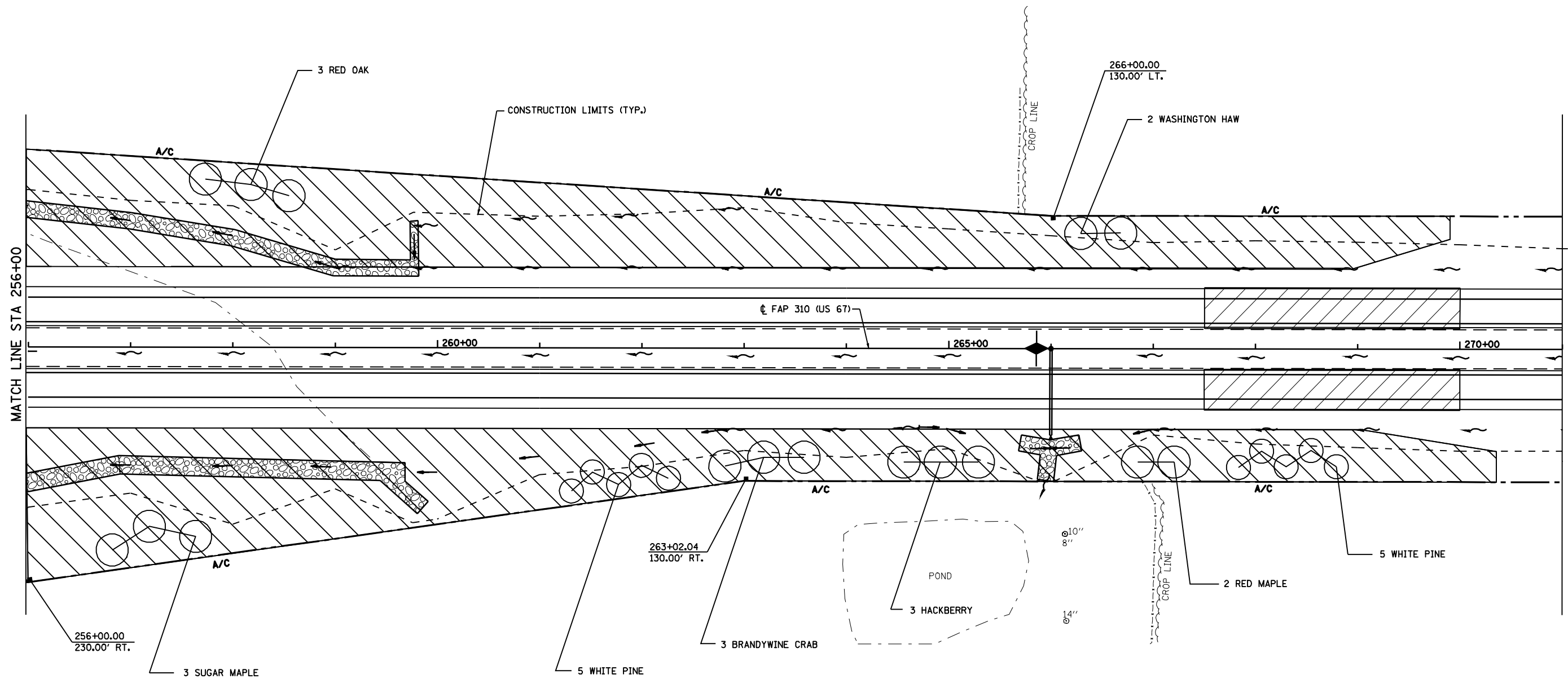

REVISIONS	
NAME	DATE

ILLINOIS DEPARTMENT OF TRANSPORTATION

FAP ROUTE 310
LANDSCAPING PLAN
STA 256+00 TO STA 271+00

SCALE: VERT. _____
 HORIZ. _____

DRAWN BY _____
CHECKED BY _____

F.A.P. RTE.	SECTION	COUNTY	TOTAL SHEETS	SHEET NO.
310	69-12LS	MORGAN	16	5
STA. 271+00		TO STA. 286+00		
FED. ROAD DIST. NO.		ILLINOIS FED. AID PROJECT		

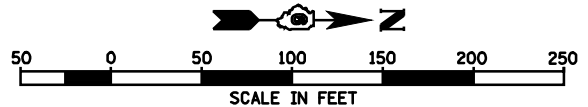
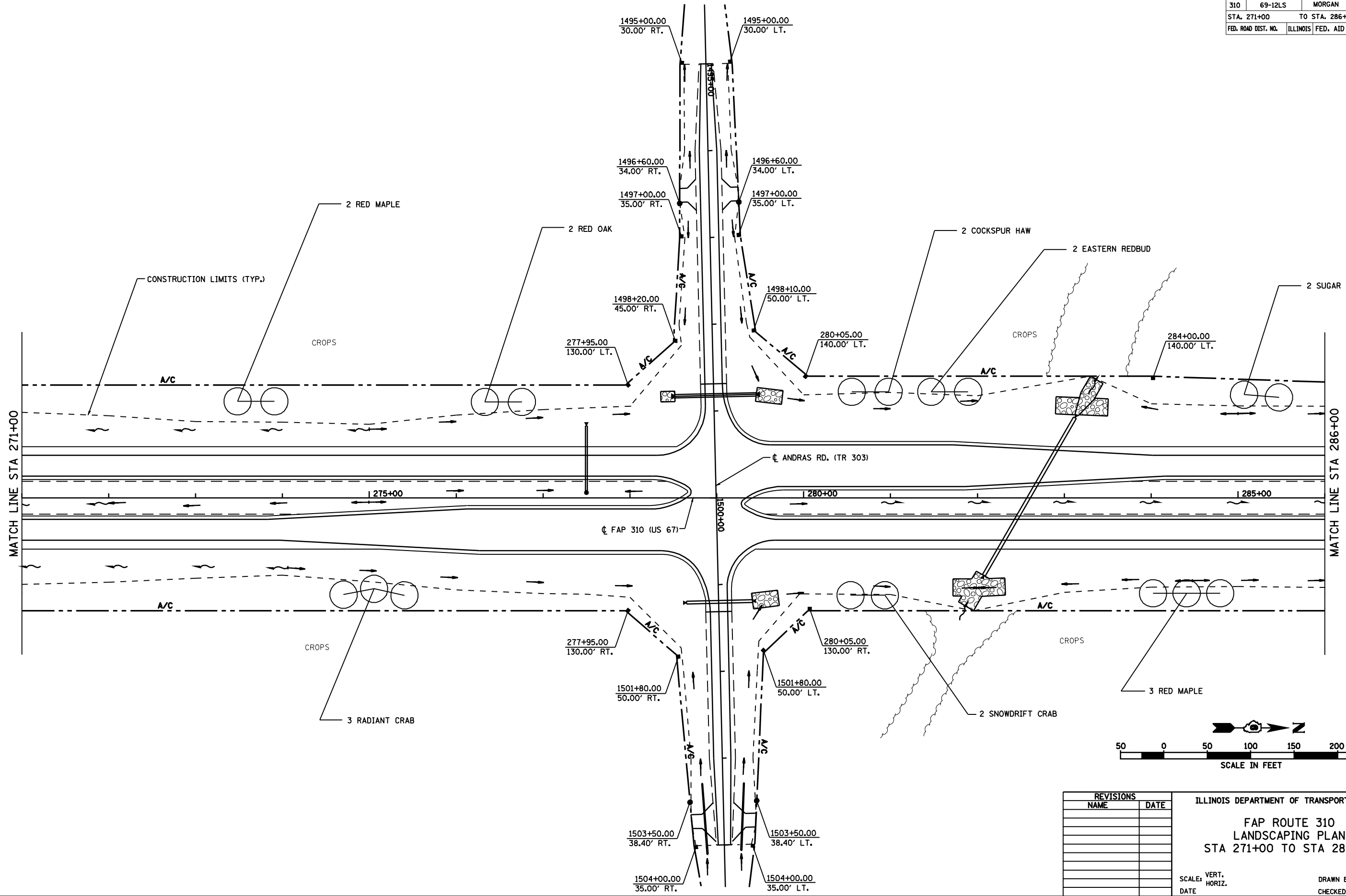

REVISIONS	
NAME	DATE

ILLINOIS DEPARTMENT OF TRANSPORTATION

FAP ROUTE 310
LANDSCAPING PLAN
STA 271+00 TO STA 286+00

SCALE: VERT. _____
HORIZ. _____

DATE _____ DRAWN BY _____
CHECKED BY _____

F.A.P. RTE.	SECTION	COUNTY	TOTAL SHEETS	SHEET NO.
310	69-12LS	MORGAN	16	6
STA. 286+00		TO STA. 301+00		
FED. ROAD DIST. NO.	ILLINOIS	FED. AID PROJECT		

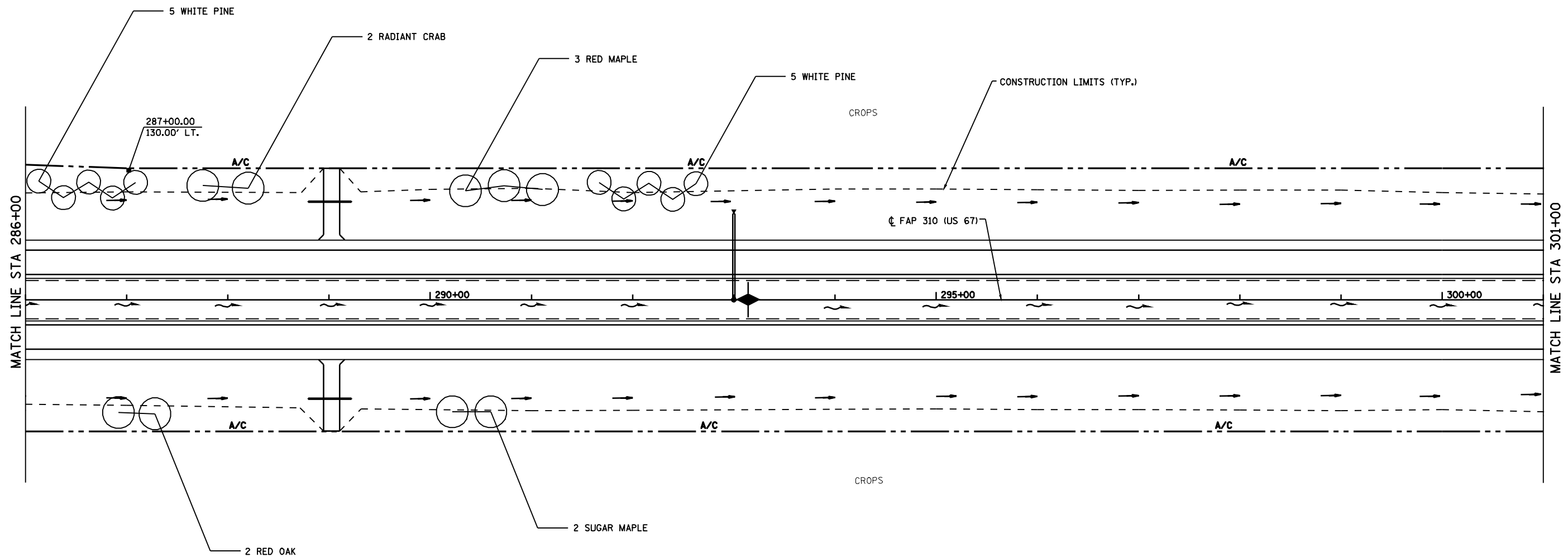

REVISIONS		ILLINOIS DEPARTMENT OF TRANSPORTATION
NAME	DATE	
		FAP ROUTE 310 LANDSCAPING PLAN STA 286+00 TO STA 301+00
SCALE:	VERT. HORIZ.	DRAWN BY
		CHECKED BY

F.A.P. RTE.	SECTION	COUNTY	TOTAL SHEETS	SHEET NO.
310	69-12LS	MORGAN	16	7
STA. 301+00		TO STA. 316+00		
FED. ROAD DIST. NO.	ILLINOIS	FED. AID PROJECT		

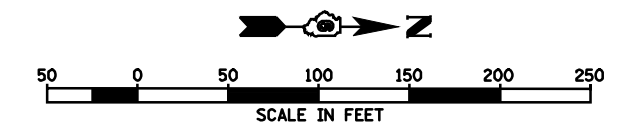
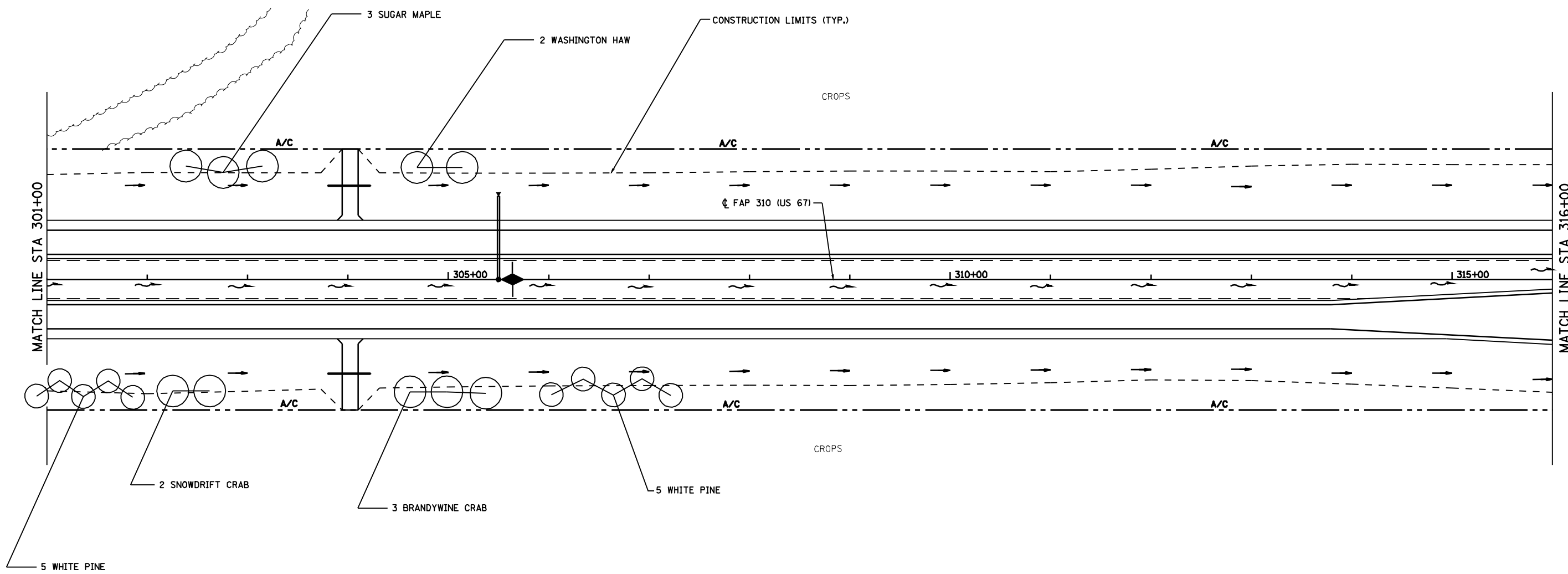

REVISIONS		ILLINOIS DEPARTMENT OF TRANSPORTATION
NAME	DATE	
		FAP ROUTE 310 LANDSCAPING PLAN STA 301+00 TO STA 316+00
SCALE:	VERT. HORIZ.	DRAWN BY
DATE		CHECKED BY

F.A.P. RTE.	SECTION	COUNTY	TOTAL SHEETS	SHEET NO.
310	69-12LS	MORGAN	16	8
STA. 316+00		TO STA. 331+00		
FED. ROAD DIST. NO.		ILLINOIS FED. AID PROJECT		

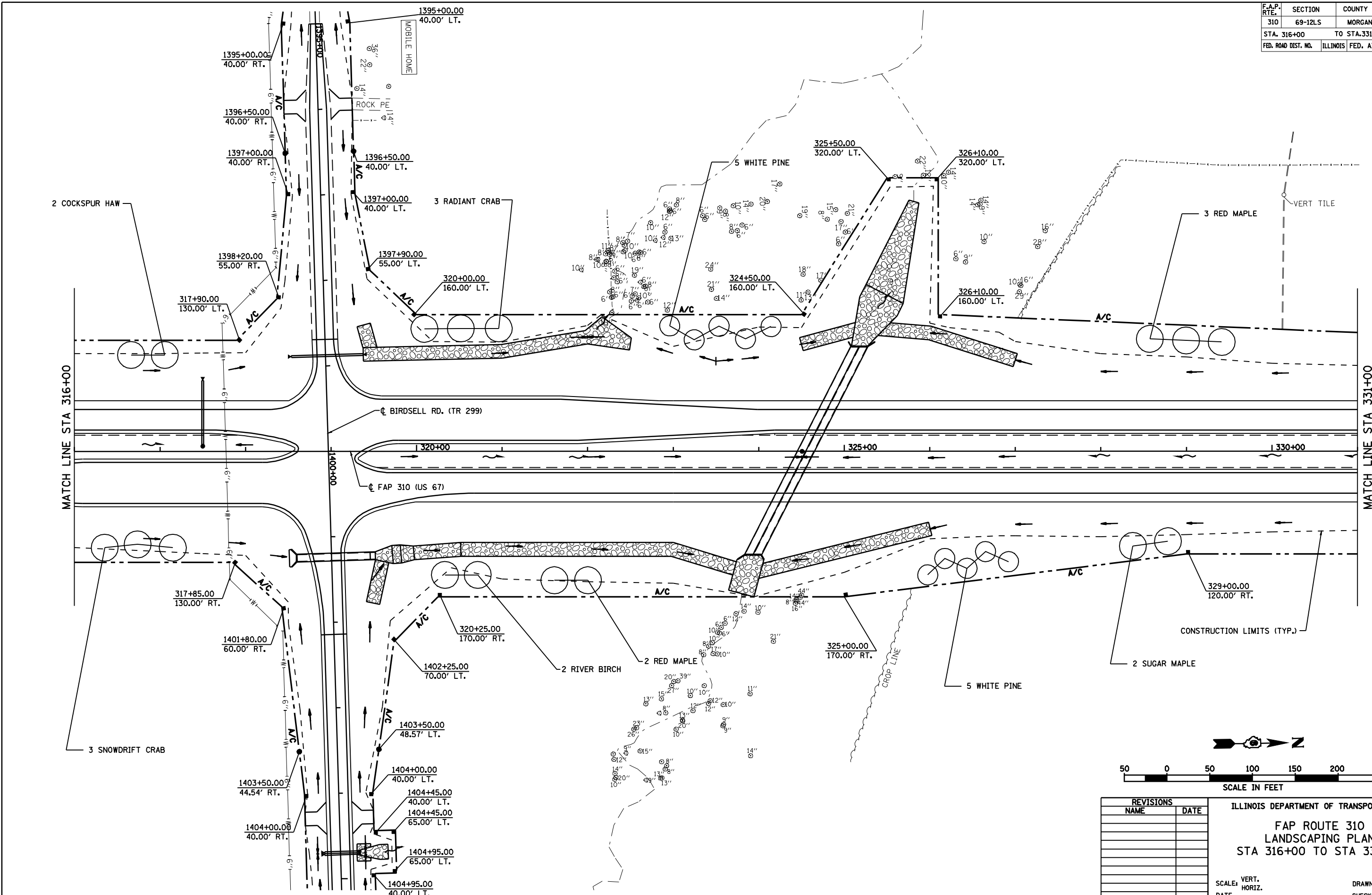

REVISIONS	
NAME	DATE

ILLINOIS DEPARTMENT OF TRANSPORTATION
 FAP ROUTE 310
 LANDSCAPING PLAN
 STA 316+00 TO STA 331+00

SCALE: VERT. DATE
 HORIZ. DATE

DRAWN BY
 CHECKED BY

F.A.P. RTE.	SECTION	COUNTY	TOTAL SHEETS	SHEET NO.
310	69-12LS	MORGAN	16	9
STA. 331+00		TO STA. 346+00		
FED. ROAD DIST. NO.		ILLINOIS	FED. AID PROJECT	

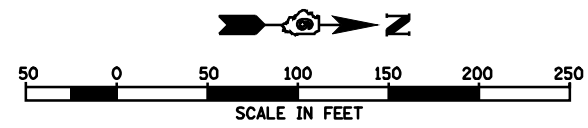
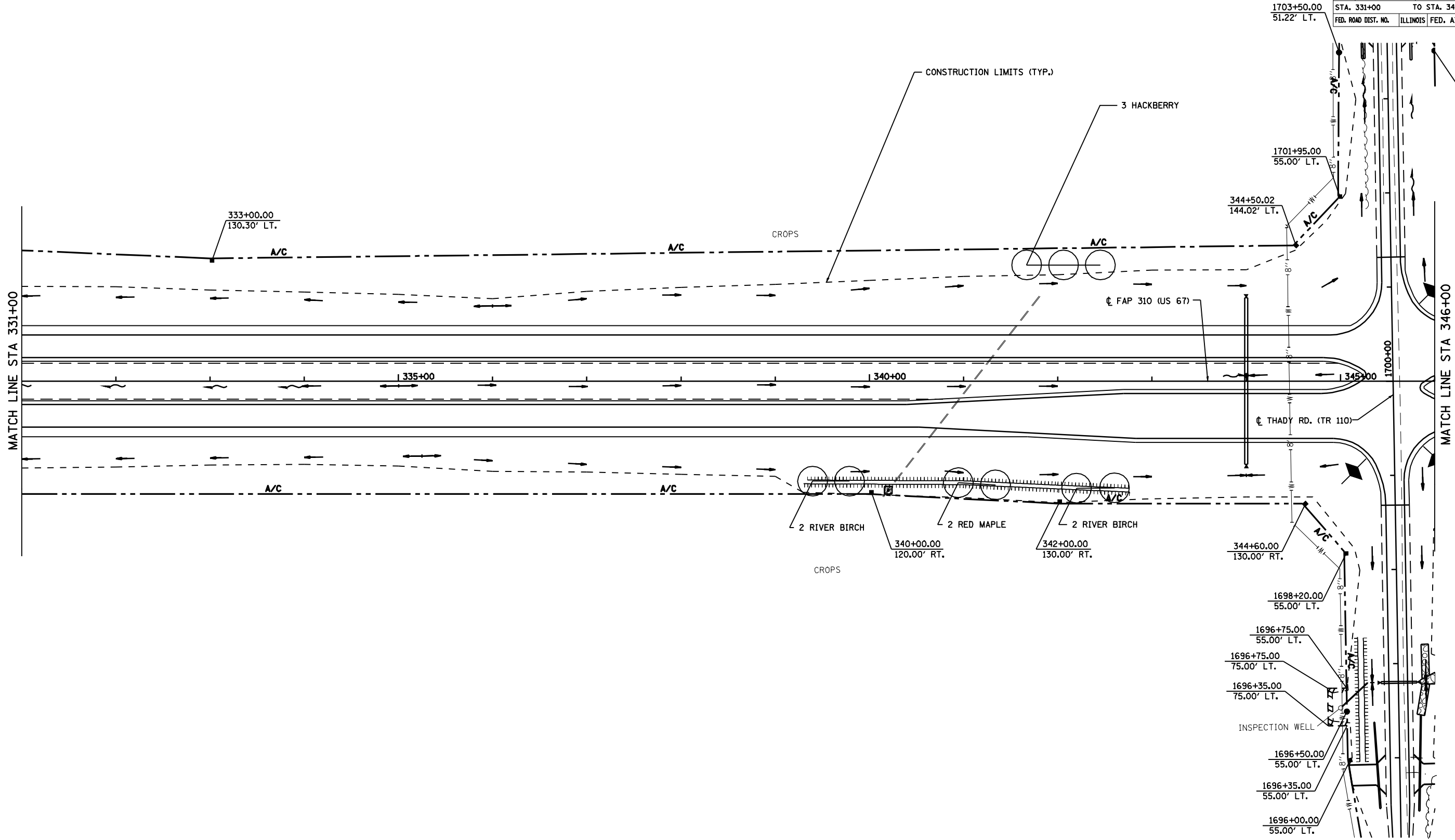

REVISIONS	
NAME	DATE

ILLINOIS DEPARTMENT OF TRANSPORTATION

FAP ROUTE 310
LANDSCAPING PLAN
STA 331+00 TO STA 346+00

SCALE: VERT. _____
HORIZ. _____

DATE _____ DRAWN BY _____
CHECKED BY _____

F.A.P. RTE.	SECTION	COUNTY	TOTAL SHEETS	SHEET NO.
310	69-12LS	MORGAN	16	10
STA. 346+00		TO STA. 361+00		
FED. ROAD DIST. NO.		ILLINOIS FED. AID PROJECT		

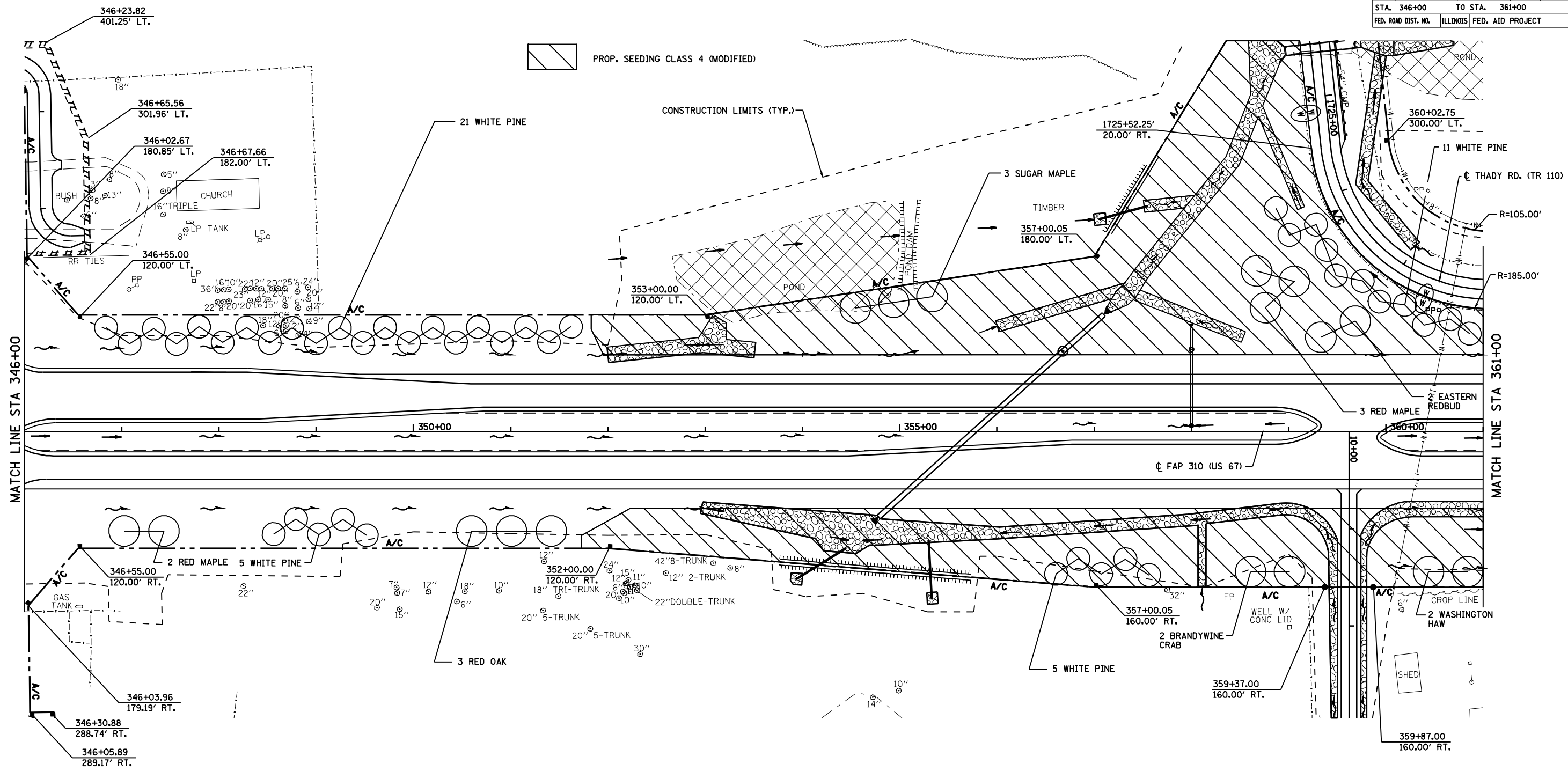

PROP. SEEDING CLASS 4 (MODIFIED)

CONSTRUCTION LIMITS (TYP.)

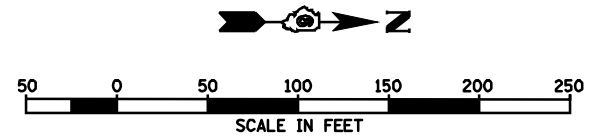

REVISIONS	
NAME	DATE

ILLINOIS DEPARTMENT OF TRANSPORTATION
**FAP ROUTE 310
 LANDSCAPING PLAN
 STA 346+00 TO STA 361+00**
 SCALE: VERT. _____
 DATE _____ HORIZ. _____
 DRAWN BY _____
 CHECKED BY _____

F.A.P. RTE.	SECTION	COUNTY	TOTAL SHEETS	SHEET NO.
310	69-12LS	MORGAN	16	11
STA. 361+00		TO STA. 376+00		
FED. ROAD DIST. NO.		ILLINOIS FED. AID PROJECT		

PROP. SEEDING CLASS 4 (MODIFIED)

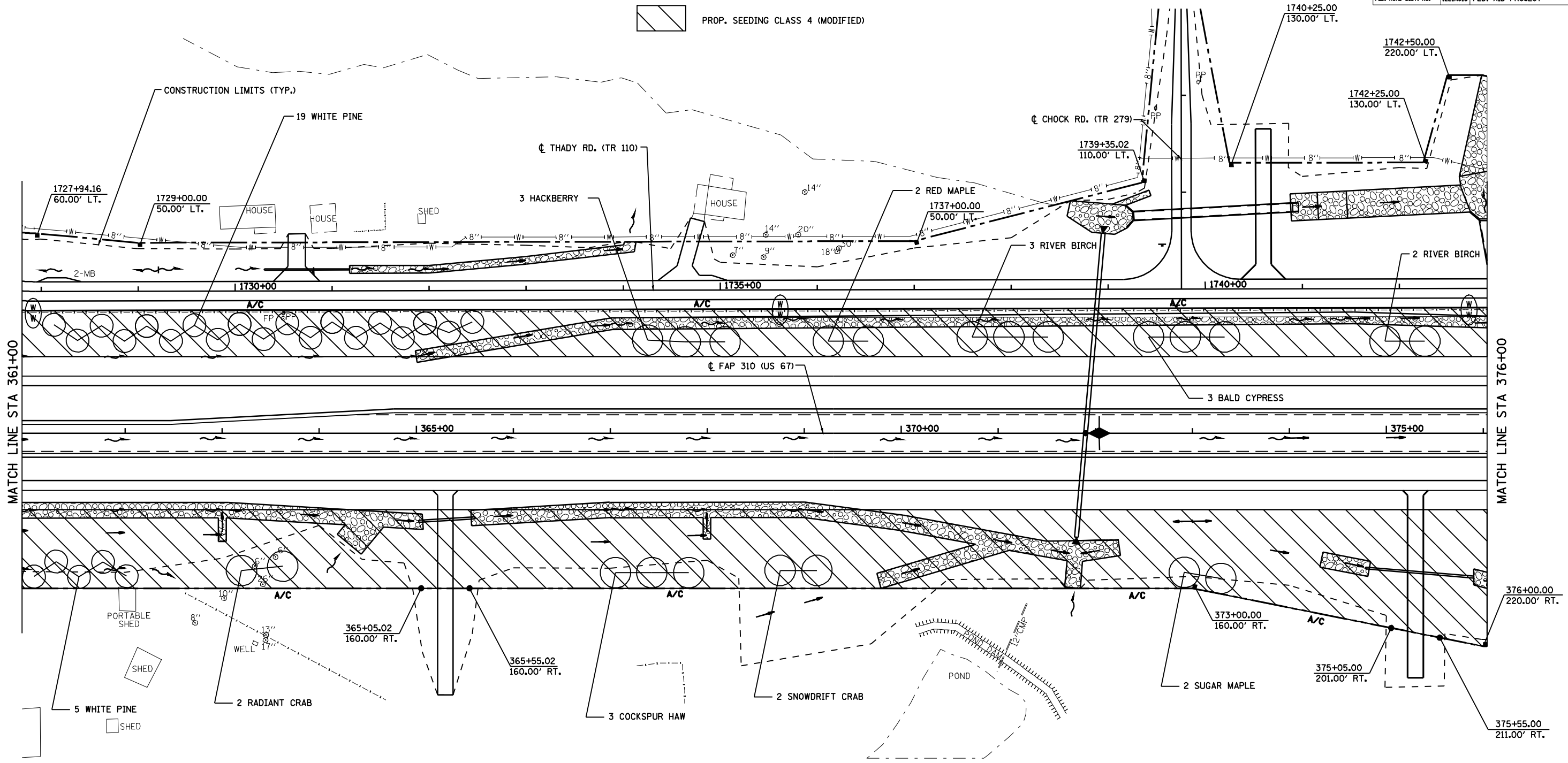

MATCH LINE STA 361+00

MATCH LINE STA 376+00

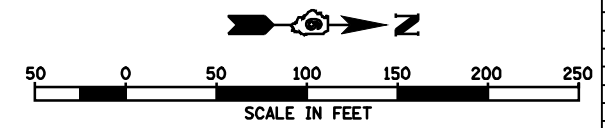

REVISIONS	
NAME	DATE

ILLINOIS DEPARTMENT OF TRANSPORTATION

FAP ROUTE 310
LANDSCAPING PLAN
STA 361+00 TO STA 376+00

SCALE: VERT. _____
HORIZ. _____

DRAWN BY _____
CHECKED BY _____

F.A.P. RTE.	SECTION	COUNTY	TOTAL SHEETS	SHEET NO.
310	69-12LS	MORGAN	16	12
STA. 376+00		TO STA. 391+00		
FED. ROAD DIST. NO.		ILLINOIS FED. AID PROJECT		

PROF. SEEDING CLASS 4 (MODIFIED)

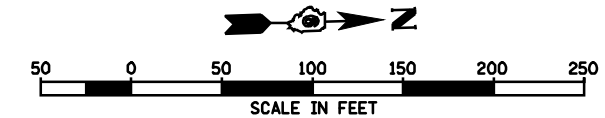
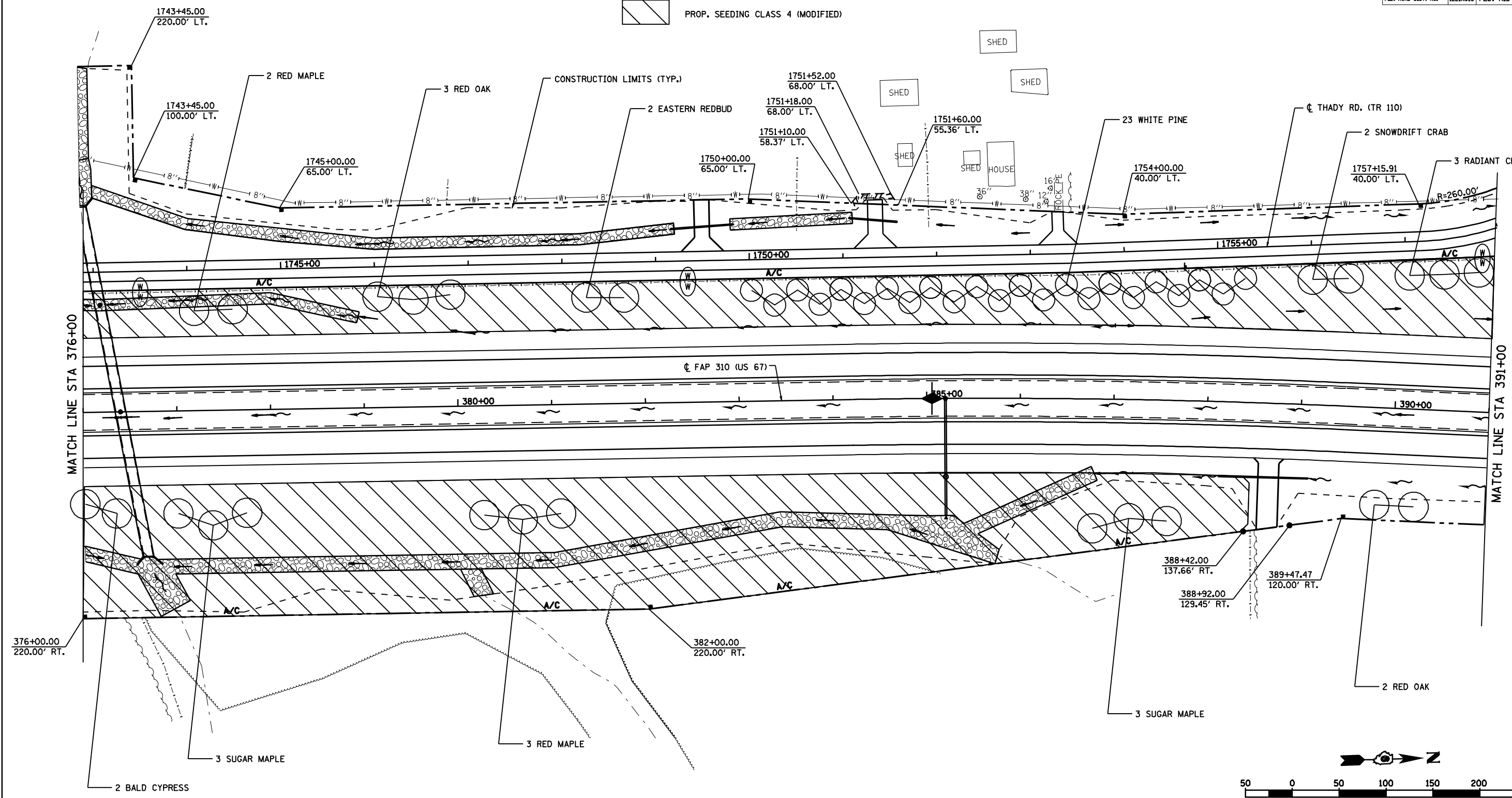

REVISIONS		ILLINOIS DEPARTMENT OF TRANSPORTATION
NAME	DATE	
		FAP ROUTE 310 LANDSCAPING PLAN STA 376+00 TO STA 391+00
SCALE:	VERT. HORIZ.	DRAWN BY
DATE		CHECKED BY

F.A.P. RTE.	SECTION	COUNTY	TOTAL SHEETS	SHEET NO.
310	69-12LS	MORGAN	16	13
STA. 391+00		TO STA. 406+00		
FED. ROAD DIST. NO.		ILLINOIS FED. AID PROJECT		

 PROP. SEEDING CLASS 4 (MODIFIED)

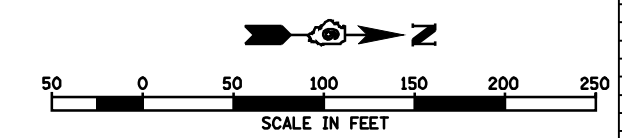
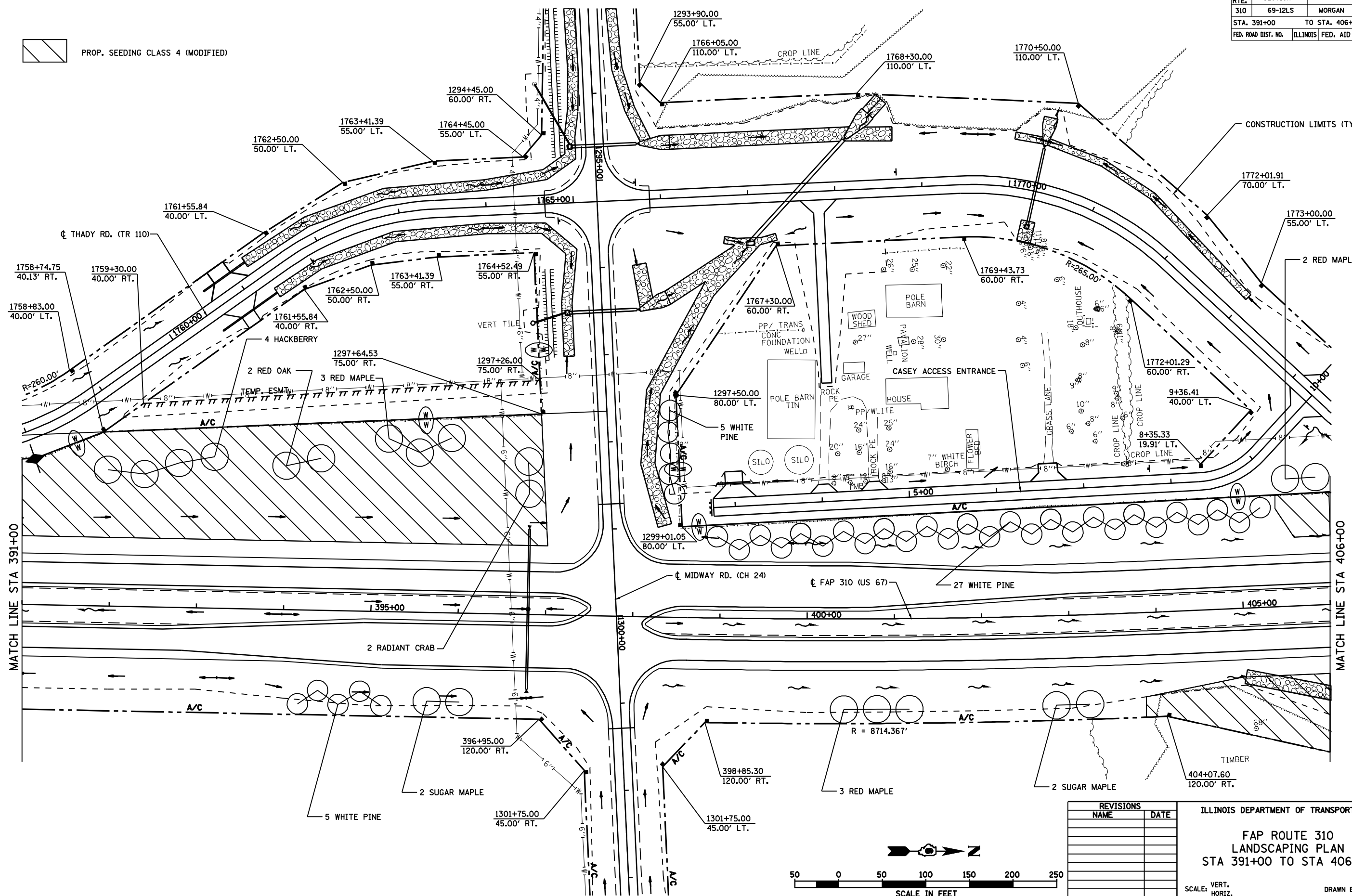

REVISIONS	
NAME	DATE

ILLINOIS DEPARTMENT OF TRANSPORTATION

**FAP ROUTE 310
LANDSCAPING PLAN
STA 391+00 TO STA 406+00**

SCALE: VERT. _____
HORIZ. _____

DRAWN BY _____
CHECKED BY _____

F.A.P. RTE.	SECTION	COUNTY	TOTAL SHEETS	SHEET NO.
310	69-12LS	MORGAN	16	14
STA. 406+00		TO STA. 421+00		
FED. ROAD DIST. NO.		ILLINOIS FED. AID PROJECT		

 PROP. SEEDING CLASS 4 (MODIFIED)

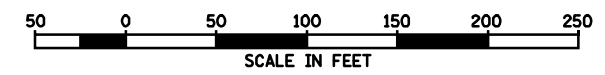
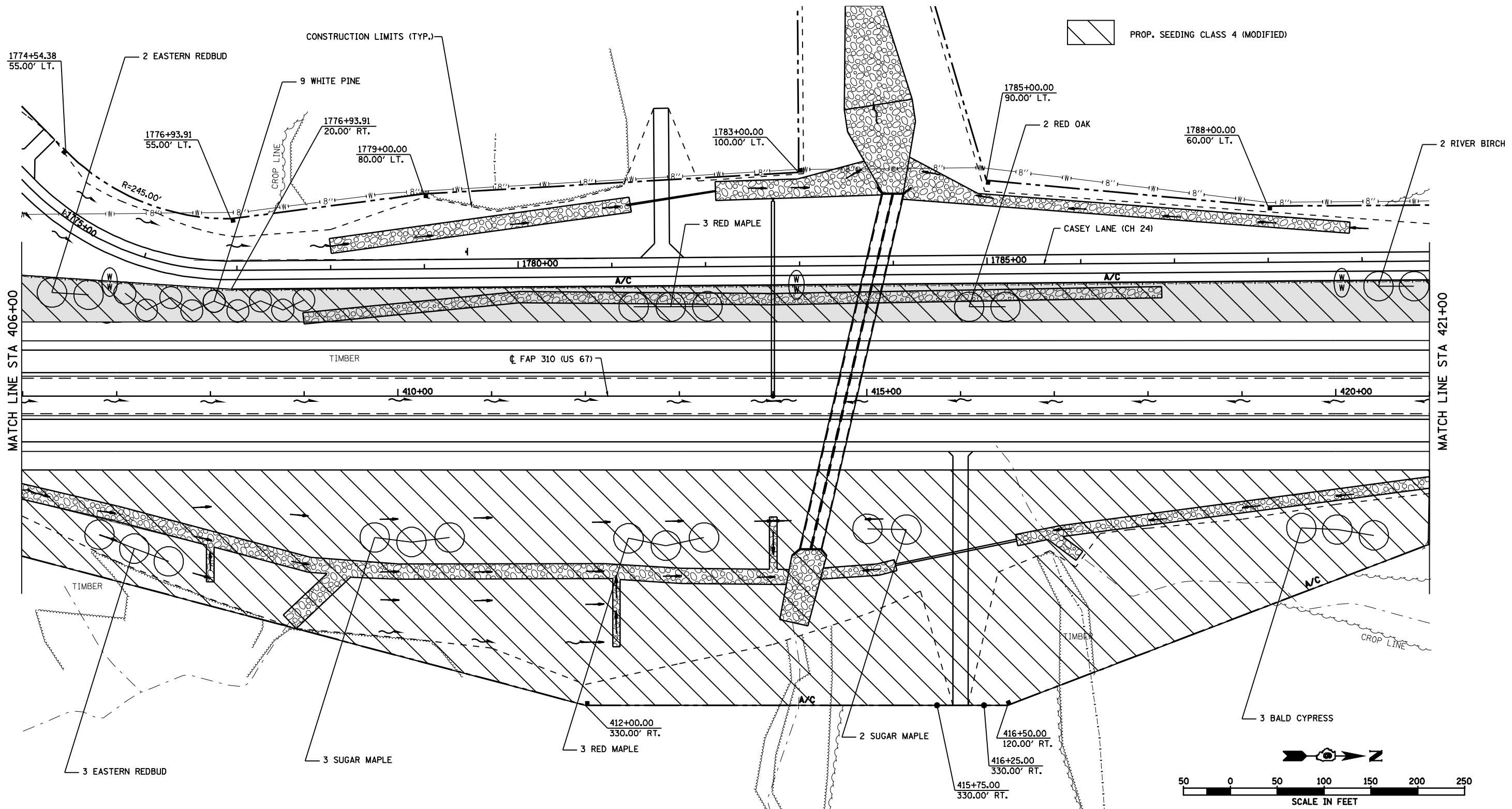

REVISIONS	
NAME	DATE

ILLINOIS DEPARTMENT OF TRANSPORTATION

FAP ROUTE 310
LANDSCAPING PLAN
STA 406+00 TO STA 421+00

SCALE: VERT. _____
HORIZ. _____

DATE _____ DRAWN BY _____
CHECKED BY _____

F.A.P. RTE.	SECTION	COUNTY	TOTAL SHEETS	SHEET NO.
310	69-12LS	MORGAN	16	15
STA. 421+00		TO STA. 436+00		
FED. ROAD DIST. NO.		ILLINOIS FED. AID PROJECT		

 PROP. SEEDING CLASS 4 (MODIFIED)

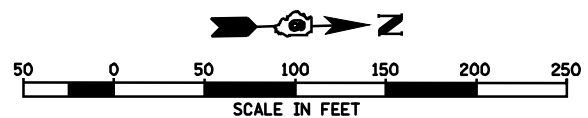
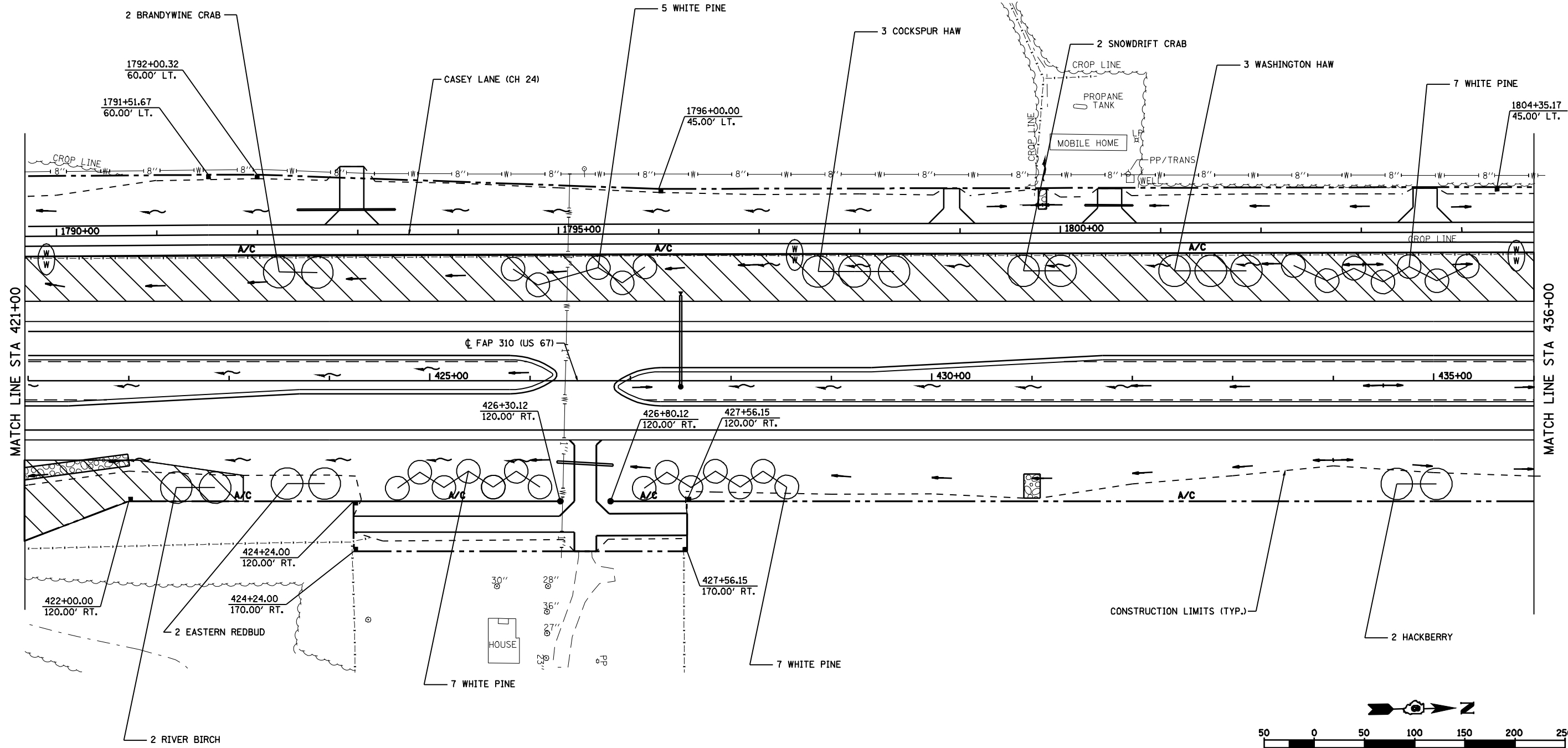

REVISIONS	
NAME	DATE

ILLINOIS DEPARTMENT OF TRANSPORTATION

FAP ROUTE 310
LANDSCAPING PLAN
STA 421+00 TO STA 436+00

SCALE: VERT. _____
HORIZ. _____

DRAWN BY _____
CHECKED BY _____

