

F.A.P. RTE.	SECTION	COUNTY	TOTAL SHEETS	SHEET NO.
310	69-12(LS-1)	MORGAN	20	1

STATE OF ILLINOIS  
DEPARTMENT OF TRANSPORTATION  
DIVISION OF HIGHWAYS

# PLANS FOR PROPOSED FEDERAL AID HIGHWAY

F.A.P. ROUTE 310 (U.S. HWY. 67)  
SECTION 69-12(LS-1)  
PROJECT LANDSCAPING  
MORGAN COUNTY  
C-96-177-10

FOR INDEX OF SHEETS, SEE SHEET NO. 2

**STANDARD**

- 000001-05
- 701101-02
- 701106-02
- 701901-01

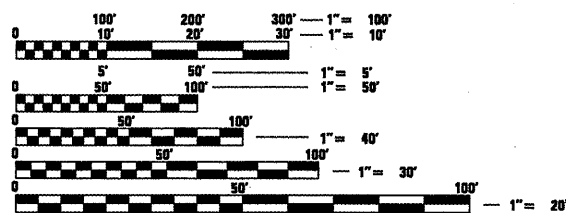
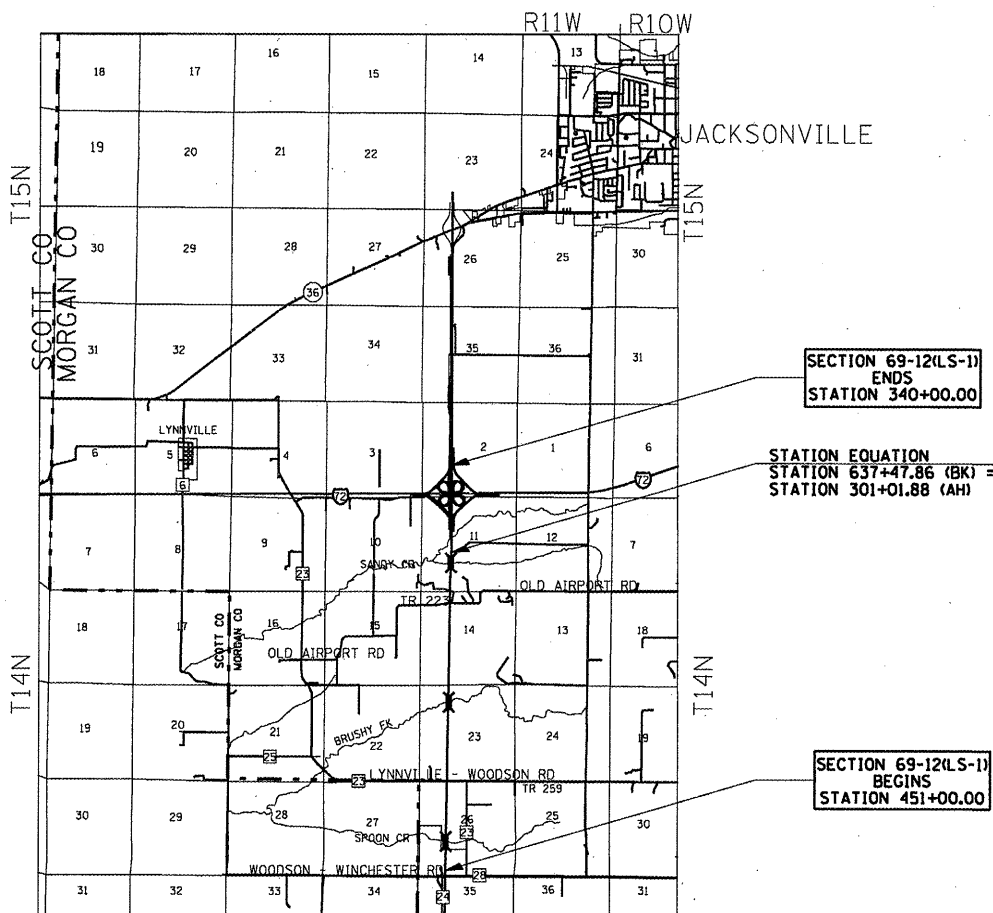
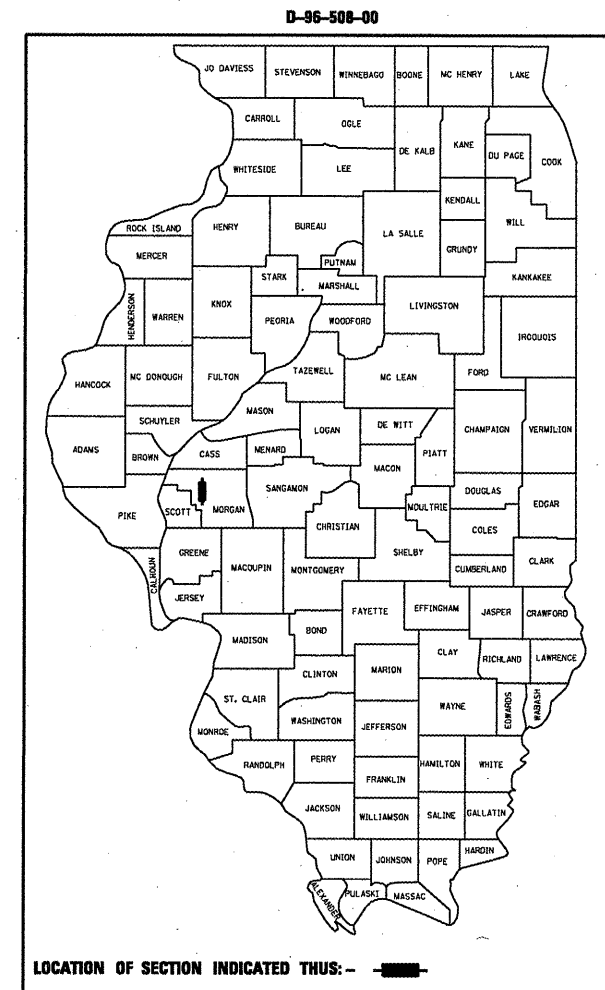

FULL SIZE PLANS HAVE BEEN PREPARED USING STANDARD ENGINEERING SCALES. REDUCED SIZED PLANS WILL NOT CONFORM TO STANDARD SCALES. IN MAKING MEASUREMENTS ON REDUCED PLANS, THE ABOVE SCALES MAY BE USED.

J.U.L.I.E.  
JOINT UTILITY LOCATION INFORMATION FOR EXCAVATION  
1-800-892-0123

**DESIGN DESIGNATION**  
FAP 310  
ARTERIAL  
ADT = 10700 (2022)  
% SU = 3  
% MU = 6

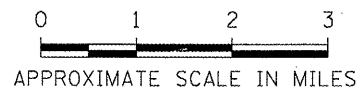

NET LENGTH OF PROJECT = 22,546.00 FEET = 4.270 MILES

STATE OF ILLINOIS  
DEPARTMENT OF TRANSPORTATION  
DIVISION OF HIGHWAYS

SUBMITTED *February 3, 2010*  
*Ryan Z. Dimpfl*  
DISTRICT ENGINEER

*March 19, 2010*  
*Scott E. Stilt, P.E.*  
ENGINEER OF DESIGN AND ENVIRONMENT

*March 19, 2010*  
*Christine M. Reed*  
DIRECTOR, DIVISION OF HIGHWAYS

HUTCHISON ENGINEERING, INC  
JACKSONVILLE, ILLINOIS