

EXIST. CURVE 102
 PI STA. = 260+95.30
 $\Delta = 2^\circ 56' 18''$ (RT)
 $D = 0^\circ 18' 15''$
 $R = 18,844.26'$
 $T = 483.30'$
 $L = 966.39'$
 $E = 6.20'$
 $e = \text{---}$
 $T.R. = \text{---}$
 $S.E. RUN = \text{---}$
 $P.C. STA. = 256+12.00$
 $P.T. STA. = 265+78.39$

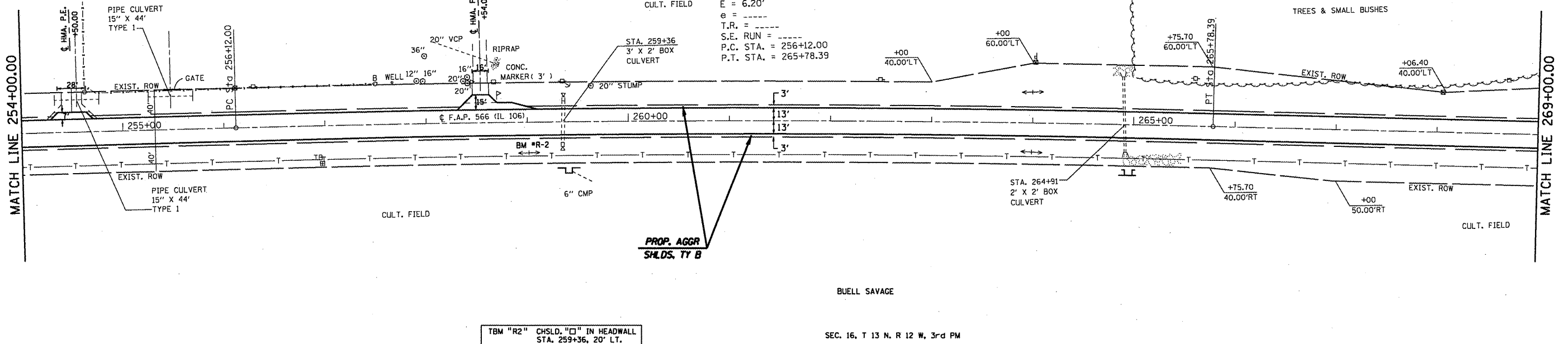
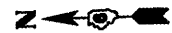

TBM "R2" CHSLD. "□" IN HEADWALL
 STA. 259+36, 20' LT.
 ELEV. = 584.77

FILE NAME =	USER NAME = cox,jw	DESIGNED - RSC	REVISED -	STATE OF ILLINOIS DEPARTMENT OF TRANSPORTATION	PLAN SHEETS		F.A.P. RTE. = 566	SECTION = (1-NRHM,2IRS-3)	COUNTY = Scott	TOTAL SHEETS = 30	SHEET NO. = 17	
CONTRACT NO. =	PLOT SCALE = 1/8" = 100'	DRAWN - JWC	REVISED -		SCALE: 50	SHEET NO. 3 OF 13 SHEETS	STA. 239+00.00 TO STA. 269+00.00	CONTRACT NO. 72882				
PLOT DATE = Aug-19-2009 07:53:53AM		CHECKED - RSC	REVISED -		FED. ROAD DIST. NO. [ILLINOIS] FED. AID PROJECT							
		DATE -	REVISED -									