

F.A.P. RTE.	SECTION	COUNTY	TOTAL SHEETS	SHEET NO.
614	12(RS-7) & 13(S-6)	CASS	14	1
FED. ROAD DIST. NO.	ILLINOIS	CONTRACT NO. 72B25		

**STATE OF ILLINOIS**  
**DEPARTMENT OF TRANSPORTATION**  
**DIVISION OF HIGHWAYS**

**PROPOSED**  
**HIGHWAY PLANS**

**FAP 614 ROUTE (IL 78)**  
**SECTION 8CS(RS-3) ; 146(RS-3)**

**RESURFACING**  
**CASS COUNTY**

C-96-102-07

INDEX OF SHEETS	
SHEET NO.	DESCRIPTION
1	COVER SHEET
2	GENERAL NOTES
3-5	SUMMARY OF QUANTITIES
6-9	SCHEDULE OF QUANTITIES
10-11	TYPICAL SECTIONS
12	ALIGNMENT SHEET
13-14	ENTRANCE DETAILS

*14A, 14B PAVEMENT MARKING DETAILS* 

IDOT HIGHWAY STANDARDS		
000001-05	701006-03	701326-03
482011-03	701011-02	701501-05
604026-02	701201-03	701901-01
604036-02	701301-03	780001-02
701001-02	701306-02	781001-03

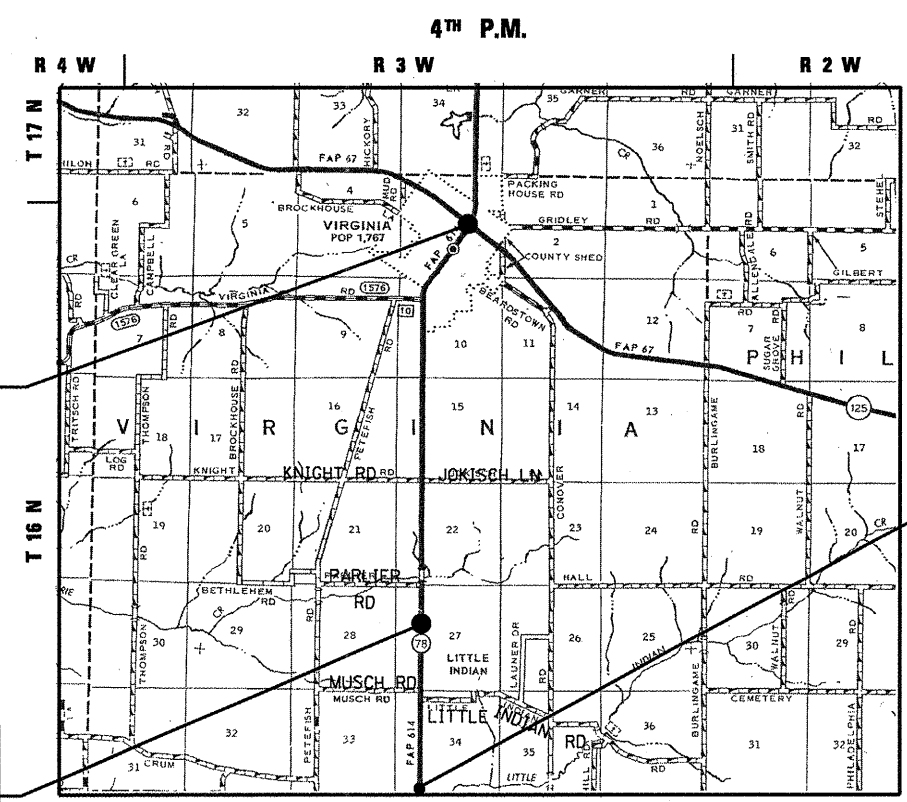
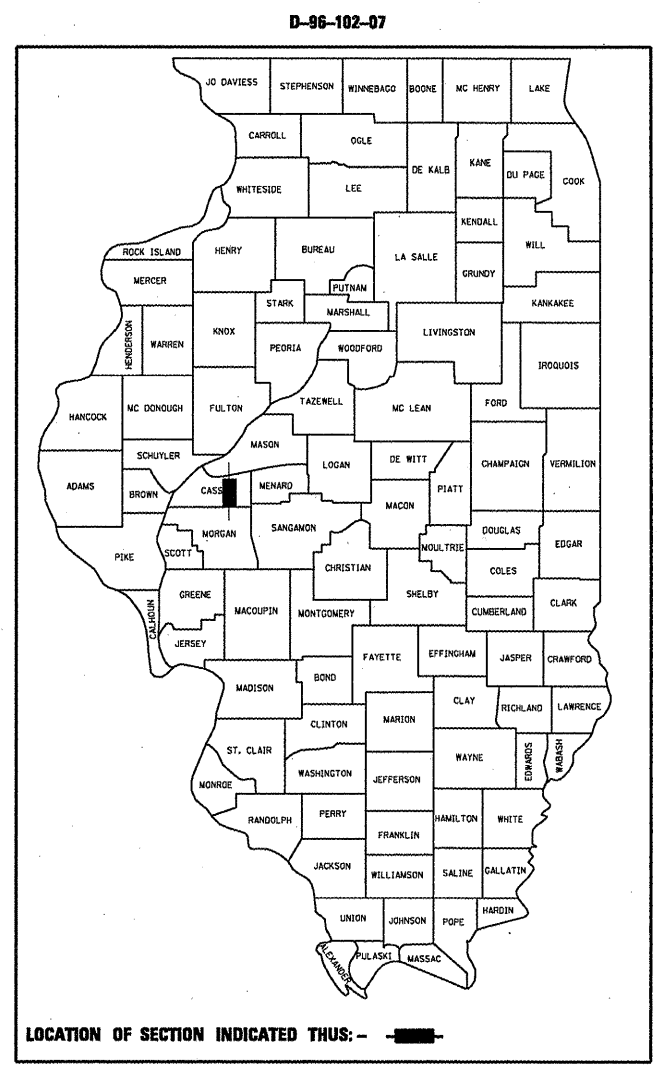

**END IMPROVEMENTS**  
**STA. 295 + 87**

**BEGIN IMPROVEMENTS**  
**STA. 3 + 11**

**STA. EQUATION**  
**STA. 85 + 62.38 BK =**  
**STA. 85 + 30.18 AH**

APPROXIMATE SCALE:  MILES

TOTAL LENGTH = 29,308.2 FEET = 5.55 MILES  
NET LENGTH OF PROJECT = 29,308.2 FEET = 5.55 MILES  
HIGHWAY CLASSIFICATION = MINOR COLLECTOR

ADT = 2039 (2007)  
PV = 1834 (90.0%)  
SU = 123 (6.0%)  
MU = 82 (4.0%)

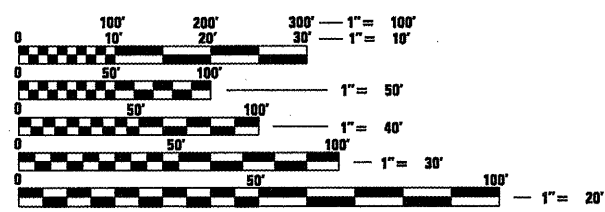

FULL SIZE PLANS HAVE BEEN PREPARED USING STANDARD ENGINEERING SCALES. REDUCED SIZED PLANS WILL NOT CONFORM TO STANDARD SCALES. IN MAKING MEASUREMENTS ON REDUCED PLANS, THE ABOVE SCALES MAY BE USED.

J.U.L.I.E.  
JOINT UTILITY LOCATION INFORMATION FOR EXCAVATION  
1-800-892-0123  
OR 811

STATE OF ILLINOIS  
DEPARTMENT OF TRANSPORTATION  
DIVISION OF HIGHWAYS

SUBMITTED *Feb 11 20 10*  
*Roger D. Diker*  
DEPUTY DIRECTOR OF HIGHWAYS, REGION ENGINEER

*March 19 20 10*  
*Scott E. Stitt, P.E.*  
ACTING ENGINEER OF DESIGN AND ENVIRONMENT

*March 19 20 10*  
*Christine M. Reader*  
DIRECTOR OF HIGHWAYS, CHIEF ENGINEER

**PRINTED BY THE AUTHORITY**  
**OF THE STATE OF ILLINOIS**

PROJECT ENGINEER: JOHN NEGANGARD (217) 782-6990  
SQUAD LEADER: MARK DUST (217) 785-0597

CONTRACT NO. 72B25

*Rev. 4-1-10*

ILLINOIS DEPARTMENT OF TRANSPORTATION

SUMMARY OF QUANTITIES

LOCATION OF WORK				CONSTRUCTION TYPE CODE			
CODE NO.	ITEM	UNIT	TOTAL QUANTITY	ROADWAY 1000 (100% STATE)			
20200600	EXCAVATING AND GRADING EXISTING SHOULDER	UNIT	482	482			
35800100	PREPARATION OF BASE	SQ YD	743	743			
40200800	AGGREGATE SURFACE COURSE, TYPE B	TON	19	19			
40600200	BITUMINOUS MATERIALS (PRIME COAT)	TON	40	40			
40600300	AGGREGATE (PRIME COAT)	TON	127	127		⚠	
40600625	LEVELING BINDER (MACHINE METHOD), N50	TON	3,566	3,566			
40600895	CONSTRUCTING TEST STRIP	EACH	1	1			
40600982	HOT-MIX ASPHALT SURFACE REMOVAL - BUTT JOINT	SQ YD	2,009	2,009			
40600985	PORTLAND CEMENT CONCRETE SURFACE REMOVAL - BUTT JOINT	SQ YD	286	286			
40600990	TEMPORARY RAMP	SQ YD	588	588			
40603310	HOT-MIX ASPHALT SURFACE COURSE, MIX "C", N50	TON	7,119	7,119		⚠	
40800050	INCIDENTAL HOT-MIX ASPHALT SURFACING	TON	354	354			
42300200	PORTLAND CEMENT CONCRETE DRIVEWAY PAVEMENT, 6 INCH	SQ YD	286	286			
44000158	HOT-MIX ASPHALT SURFACE REMOVAL, 2 1/4"	SQ YD	19,391	19,391			

⚠ Rev. 4-1-10

FILE NAME =	USER NAME = laughlinr1	DESIGNED -	REVISED -	<b>STATE OF ILLINOIS DEPARTMENT OF TRANSPORTATION</b>	<b>SUMMARY OF QUANTITIES</b>	F.A.P. RTE.	SECTION	COUNTY	TOTAL SHEETS	SHEET NO.
c:\pwwork\PWIDOT\LAUGHLINRL\dms30897\672825-ahs-S001.dgn	DRAWN - AAD	REVISED -	614			8CS(RS-3); 146(RS-3)	CASS	14	3	
PLOT SCALE = 100.0000 FT / IN.	CHECKED - JAC	REVISED -	SCALE: SHEET NO. OF SHEETS STA. TO STA.			FED. ROAD DIST. NO. ILLINOIS FED. AID PROJECT				
PLOT DATE = Feb-16-2010 09:53:05AM	DATE - 6/11/2007	REVISED -	CONTRACT NO. 72825							

ILLINOIS DEPARTMENT OF TRANSPORTATION

SUMMARY OF QUANTITIES

LOCATION OF WORK				CONSTRUCTION TYPE CODE			
CODE NO.	ITEM	UNIT	TOTAL QUANTITY	ROADWAY 1000 (100% STATE)			
44000198	HOT-MIX ASPHALT SURFACE REMOVAL, VARIABLE DEPTH	SQ YD	65,114	65,114			
44200144	PAVEMENT PATCHING, TYPE II, 12 INCH	SQ YD	800	800			
44200148	PAVEMENT PATCHING, TYPE III, 12 INCH	SQ YD	250	250			
44200150	PAVEMENT PATCHING, TYPE IV, 12 INCH	SQ YD	150	150			
48101200	AGGREGATE SHOULDERS, TYPE B	TON	4,036	4,036			△
48203021	HOT-MIX ASPHALT SHOULDERS, 6"	SQ YD	6,433	6,433			
<del>56109210</del>	<del>WATER VALVES TO BE ADJUSTED</del>	<del>EACH</del>	<del>3</del>	<del>3</del>			<del>△</del>
60300105	FRAMES AND GRATES TO BE ADJUSTED	EACH	2	2			
60402210	GRATES, TYPE 8	EACH	2	2			
60404500	FRAMES AND GRATES, TYPE 6	EACH	1	1			
67000400	ENGINEER'S FIELD OFFICE, TYPE A	CAL MO	6	6			
67100100	MOBILIZATION	L SUM	1	1			
70100450	TRAFFIC CONTROL AND PROTECTION, STANDARD 701201	L SUM	1	1			

FILE NAME *	USER NAME = laughlinr1	DESIGNED -	REVISED -
c:\pwwork\pwwork\LAUGHLINRL\dms30897\72B25-ah-5002.dgn		DRAWN - AAD	REVISED -
PLOT SCALE = 100.0000 FT / IN.		CHECKED - JAC	REVISED -
PLOT DATE = Feb-16-2010 09:53:07AM		DATE - 6/11/2007	REVISED -

STATE OF ILLINOIS  
DEPARTMENT OF TRANSPORTATION

SUMMARY OF QUANTITIES

SCALE: SHEET NO. OF SHEETS STA. TO STA.

F.A.P. RTE.	SECTION	COUNTY	TOTAL SHEETS	SHEET NO.
614	8CS(RS-3); 146(RS-3)	CASS	14	4
FED. ROAD DIST. NO. ILLINOIS FED. AID PROJECT			CONTRACT NO. 72B25	

△ Rev. 4-1-10

ILLINOIS DEPARTMENT OF TRANSPORTATION

SUMMARY OF QUANTITIES

LOCATION OF WORK				CONSTRUCTION TYPE CODE			
CODE NO.	ITEM	UNIT	TOTAL QUANTITY	ROADWAY 1000 (100% STATE)			
70100460	TRAFFIC CONTROL AND PROTECTION, STANDARD 701306	L SUM	1	1			
70102620	TRAFFIC CONTROL AND PROTECTION, STANDARD 701501	L SUM	1	1			
70100500	TRAFFIC CONTROL AND PROTECTION, STANDARD 701326	L SUM	1	1			
70103815	TRAFFIC CONTROL SURVEILLANCE	CAL DA	5	5			
70300100	SHORT-TERM PAVEMENT MARKING	FOOT	5,350	5,350			
70300230	TEMPORARY PAVEMENT MARKING - LINE 5"	FOOT	75,661	75,661			⚠
70301000	WORK ZONE PAVEMENT MARKING REMOVAL	SQ FT	1,784	1,784			⚠
*78000300	<del>THERMOPLASTIC PAVEMENT MARKING - LINE 5"</del>	<del>FOOT</del>	<del>3,640</del>	<del>3,640</del>			
*78001120	PAINT PAVEMENT MARKING - LINE 5"	FOOT	71,937	71,937			
*78004230	PREFORMED PLASTIC PAVEMENT MARKING, TYPE B - INLAID - LINE 6"	FOOT	304	304			⚠
*78004280	<del>PREFORMED PLASTIC PAVEMENT MARKING, TYPE B -</del>	<del>FOOT</del>	<del>62</del>	<del>62</del>			⚠
*78100100	RAISED REFLECTIVE PAVEMENT MARKER <i>INLAID - LINE 2 1/4"</i>	EACH	368	368			
78300200	RAISED REFLECTIVE PAVEMENT MARKER REMOVAL	EACH	368	368			
*X0323455	<del>ADJUST MONITORING WELLS</del>	<del>EACH</del>	<del>1</del>	<del>1</del>			⚠

\*Specialty Items

⚠ Rev. 4-1-10

ILLINOIS ROUTE 78 & SIDE ROAD IMPROVEMENT SCHEDULE FOR RURAL / URBAN "PPP" PROJECT (VIRGINIA, ILLINOIS)

LOCATION		EX MATERIAL TYPE SIDE ROAD	EX MATERIAL TYPE APRON	LENGTH	WIDTH	RADIUS RETURN	SIDE ROAD AREA	RADIUS RETURN AREA	TOTAL AREA	HOT-MIX ASPHALT SURF. REM. - BUTT JOINT	TEMPORARY RAMP	AGGREGATE SHOULDERS, TYPE B	EXCAVATING AND GRADING EXISTING SHOULDER	HOT-MIX ASPHALT SURFACE REMOVAL, VAR DEPTH	HOT-MIX ASPHALT SURFACE REMOVAL, 2.25"	HOT-MIX ASPHALT SHOULDERS, 6"	BITUMINOUS (P. C.)	AGGREGATE (P. C.)	LEVELING BINDER (MACHINE METHOD), NSO	HOT-MIX ASPHALT SURFACE COURSE	INCIDENTAL HOT-MIX ASPHALT SURFACING
STA.	STA.	(AGG. / O&C / BIT. / P. C. C.)	(AGG. / BIT. / P. C. C.)	FOOT	FOOT	FOOT	SQ. FT.	SQ. FT.	SQ. FT.	SQ. YD.	SQ. YD.	TON	UNIT	SQ. YD.	SQ. YD.	SQ. YD.	TON	TON	TON	TON	TON
3+11	47+57			4,446	24				106,704	80	13	676	89	11,856		988	4.6	16.9	498	996	
47+57	52+71			514	24				12,336			79	11	1,371		115	0.6	1.96	58	116	
52+71	85+62.38			3,291.38	24				78,993			500	66	8,778		732	3.4	12.51	369	738	
STATION EQUATION																					
85+30.18	104+99			1,968.82	24				47,252			299	40	5,251		438	2	7.5	221	442	
104+99	111+55			656	44				28,864				14	3,208			1.3	4.6	135	270	
111+55	117+38			583	24				13,992			89	12	1,555		130	0.6	2.3	66	131	
117+38	157+81			4,043	24				97,032			614	81	10,782		899	4.1	15.4	453	906	
157+81	239+84			8,203	24				196,872			1,246	165	21,875		1,823	8.4	31.2	919	1838	
239+84	241+48			164	24				3,936			25	4	438		37	0.2	0.7	19	37	
241+48	245+72			424	24				10,176	80		65			1,131	95	0.5	1.7	48	96	
245+72	247+58			186	24				4,464			29		496	42	0.2	0.8	21	42		
247+58	253+09			551	24				13,224			84		1,470	123	0.6	2.1	62	124		
253+09	259+80			671	24				16,104			102		1,790	150	0.7	2.6	76	151		
259+80	260+60			80	24				1,920			13		214	18	0.1	0.4	9	18		
260+60	264+05			345	24				8,280			53		920	77	0.4	1.4	39	78		
264+05	265+60			155	24				3,720					414		0.2	0.6	18	35		
265+60	267+26			166	24				3,984			26		443	37	0.2	0.7	19	38		
267+26	268+83			157	24				3,768			24		419	35	0.2	0.6	18	36		
268+83	270+10			127	24				3,048			20		339	29	0.2	0.5	15	29		
270+10	270+45			35	24				840			6		94	8	0.1	0.2	4	8		
270+45	272+34			189	24				4,536			29		504	42	0.2	0.8	22	43		
272+34	273+59			125	24				3,000			19		334	28	0.2	0.5	15	29		
273+59	274+22			63	38				2,394			10		266		0.2	0.4	12	23		
274+22	275+83			161	38				6,118			25		680		0.3	1	29	58		
275+83	276+00			17	38				646			3		72		0.1	0.2	4	7		
276+00	277+44			144	40				5,760					640		0.3	1	27	54		
277+44	279+04			160	40				6,400					712		0.3	1.1	30	60		
279+04	281+04			200	40				8,000					889		0.4	1.3	38	75		
281+04	282+46			142	40				5,680					632		0.3	1	27	54		
282+46	282+63			17	62				1,054					118		0.1	0.2	5	10		
282+63	286+23			360	62				22,320					2,480		1	3.6	105	209		
286+23	286+42			19	62				1,178					131		0.1	0.2	6	12		
286+42	287+80			138	40				5,520					614		0.3	0.9	26	52		
287+80	289+88			208	40				8,320					925		0.4	1.4	39	78		
289+88	291+42			154	40				6,160					685		0.3	1	29	58		
291+42	293+04			162	40				6,480					720		0.3	1.1	31	61		
293+04	294+58			154	40				6,160					685		0.3	1	29	58		
294+58	295+87			129	40				5,160	134	22			574		0.3	0.9	25	49		

Rev. 4-1-10

FILE NAME =	USER NAME = laughlrr1	DESIGNED -	REVISED -
ca:\pwork\PWIDOT\LAUGHLINRL\dns30897\672825-sht-entrance-schedules.dgn		DRAWN - TRF	REVISED -
	PLOT SCALE = 40.000' / IN.	CHECKED -	REVISED -
	PLOT DATE = Mar-17-2010 03:58:07PM	DATE - 7/6/2007	REVISED -

STATE OF ILLINOIS  
DEPARTMENT OF TRANSPORTATION

SCHEDULE OF QUANTITIES

SCALE: N/A	SHEET NO. OF SHEETS	STA. TO STA.
------------	---------------------	--------------

F.A.P. RTE.	SECTION	COUNTY	TOTAL SHEETS	SHEET NO.
614	8CS(RS-3)h 146(RS-3)	CASS	14	6
CONTRACT NO. 72B25				
FED. ROAD DIST. NO. [ILLINOIS] FED. AID PROJECT				

ILLINOIS ROUTE 78 & SIDE ROAD IMPROVEMENT SCHEDULE FOR RURAL / URBAN "PPP" PROJECT (VIRGINIA, ILLINOIS)

LOCATION		EX MATERIAL TYPE SIDE ROAD	EX MATERIAL TYPE APRON	LENGTH	WIDTH	RADIUS RETURN	SIDE ROAD AREA	RADIUS RETURN AREA	TOTAL AREA	HOT-MIX ASPHALT SURF. REM. - BUTT JOINT	TEMPORARY RAMP	AGGREGATE SHOULDERS, TYPE B	EXCAVATING AND GRADING EXISTING SHOULDER	HOT-MIX ASPHALT SURFACE REMOVAL, VAR DEPTH	HOT-MIX ASPHALT SURFACE REMOVAL, 2.25"	HOT-MIX ASPHALT SHOULDERS, 6"	BITUMINOUS (P.C.)	AGGREGATE (P.C.)	LEVELING BINDER (MACHINE METHOD), NSO	HOT-MIX ASPHALT SURFACE COURSE	INCIDENTAL HOT-MIX ASPHALT SURFACING
STA.	STA.	(AGG. / O&C / BIT. / P.C.C.)	(AGG. / BIT. /	FOOT	FOOT	FOOT	SQ. FT.	SQ. FT.	SQ. FT.	SQ. YD.	SQ. YD.	TON	UNIT	SQ. YD.	SQ. YD.	SQ. YD.	TON	TON	TON	TON	TON
LITTLE INDIAN RD / RURAL	RT, STA 47+57	O&C	BIT	10	30	25	300	269	569	64	17						0.1	0.1			6
MUSCH RD / RURAL	LT, STA 52+71	O&C	BIT	10	28	25	280	269	549	61	16						0.1	0.1			6
PARLIER RD / RURAL	LT, STA 117+38	O&C	BIT	10	28	25	280	269	549	61	16						0.1	0.1			6
KNIGHT RD / RURAL	LT, STA 157+81	O&C	BIT	10	39	25	390	269	659	74	22						0.1	0.2			7
JOKISCH LN / RURAL	RT, STA 157+81	AGG	BIT	10	24	20	240	172	412	46	13						0.1	0.1			4
ALLEY / URBAN	RT, STA 239+84	O&C	BIT	10	12	3	120	4	124	14	7						0.1	0.1			2
SOUTH ST / URBAN	RT, STA 241+48	O&C	BIT	10	24	20	240	172	412	46	13						0.1	0.1			4
ALLEY / URBAN	RT, STA 245+72	O&C	BIT	10	14	15	140	97	237	27	8						0.1	0.1			3
BROADWAY ST / URBAN	RT, STA 247+58	O&C	BIT	10	41	28	410	337	747	83	23						0.1	0.2			7
VIRGINIA RD / URBAN	LT, STA 253+09	O&C	BIT	10	66	50	660	1074	1,734	193	37						0.1	0.3			17
FRANKLIN ST / URBAN	RT, STA 253+09	O&C	BIT	10	23	20	230	172	402	45	13						0.1	0.1			4
ILLINI ST / URBAN	LT, STA 264+05	O&C	BIT	10	27	15	270	97	367	41	15						0.1	0.1			4
ILLINI ST / URBAN	RT, STA 264+05	O&C	BIT	0	24	20	0	172	172	20	13						0.1	0.1			2
ALLEY / URBAN	LT, STA 265+60	O&C		10	10	15	100	97	197	22	6						0.1	0.1			2
UNION ST / URBAN	LT, STA 267+26	O&C	BIT	10	20	15	200	97	297	33	11						0.1	0.1			3
UNION ST / URBAN	RT, STA 267+26	O&C	BIT	10	22	15	220	97	317	36	12						0.1	0.1			4
ALLEY / URBAN	LT, STA 268+83	O&C		10	12	14	120	85	205	23	7						0.1	0.1			2
LIBERTY ST / URBAN	LT, STA 270+45	O&C	BIT	0	18	10	0	43	43	5	10						0.1	0.1			1
LIBERTY ST / URBAN	RT, STA 270+45	O&C	BIT	10	20	15	200	97	297	33	11						0.1	0.1			3
ALLEY / URBAN	RT, STA 272+34	O&C	BIT	10	13	15	130	97	227	26	7						0.1	0.1			3
HARDIN ST / URBAN	LT, STA 274+22	O&C	BIT	10	37	58.50	370	172	542	61	21						0.1	0.1			6
HARDIN ST / URBAN	RT, STA 274+22	O&C	BIT	10	30	25	300	269	569	64	17						0.1	0.1			6
ALLEY / URBAN	LT, STA 275+83	O&C	BIT	0	10	0	0	0	0	0	6						0	0			0
WASHINGTON ST / URBAN	LT, STA 277+44	O&C	BIT	10	22	10	220	43	263	30	12						0.1	0.1			3
ADAMS ST / URBAN	LT, STA 279+04	O&C	BIT	10	15	10	150	43	193	22	8						0.1	0.1			2
ADAMS ST / URBAN	RT, STA 279+04	O&C	BIT	5	14	6	70	16	86	10	8						0.1	0.1			1
JEFFERSON ST / URBAN	LT, STA 281+04	O&C	BIT	10	14	6	140	16	156	18	8						0.1	0.1			2
JEFFERSON ST / URBAN	RT, STA 281+04	O&C	BIT	5	15	6	75	16	91	11	8						0.1	0.1			1
BEARDSTOWN ST / URBAN	RT, STA 282+63	BIT	BIT	0	41	10	0	43	43	5	23						0.1	0.1			1
BEARDSTOWN ST / URBAN	LT, STA 282+64	BIT	BIT	0	60	10	0	43	43	5	33						0.1	0.1			1
SPRINGFIELD ST / URBAN	RT, STA 286+23	BIT	BIT	0	35	10	0	43	43	5	19						0.1	0.1			1
SPRINGFIELD ST / URBAN	LT, STA 286+24	BIT	BIT	0	60	10	0	43	43	5	33						0.1	0.1			1
JACKSON ST / URBAN	LT, STA 287+80	O&C	PCC	5	16	5	80	11	91	11	9						0.1	0.1			1
JACKSON ST / URBAN	RT, STA 287+80	O&C	BIT	5	11	5	55	11	66	8	6						0.1	0.1			1
MONROE ST / URBAN	RT, STA 289+88	O&C	BIT	6	12	6	72	16	88	10	7						0.1	0.1			1
MONROE ST / URBAN	LT, STA 289+89	O&C	BIT	10	11	10	110	43	153	17	6						0.1	0.1			2
MYRTLE ST / URBAN	RT, STA 291+42	O&C	BIT	10	12	10	120	43	163	19	7						0.1	0.1			2
MYRTLE ST / URBAN	LT, STA 291+63	O&C	BIT	10	20	10	200	43	243	27	11						0.1	0.1			3
GARDEN / URBAN	RT, STA 293+07	O&C	BIT	5	20	6	100	16	116	13	11						0.1	0.1			2
SYLVAN ST / URBAN	LT, STA 294+58	O&C	BIT	10	20	15	200	97	297	33	11						0.1	0.1			3
SYLVAN ST / URBAN	RT, STA 294+66	O&C	BIT	10	22	10	220	43	263	30	12						0.1	0.1			3
TOTALS									772,463	1,651	588	4,036	482	65,114	19,391	5,846	38.0	126.7	3,566	7,119	133

Rev. 4-1-10

FILE NAME =	USER NAME = laughlinr1	DESIGNED -	REVISED -
es:\pwwork\pwwid\LAUGHLINR1\dms30897\672825-akt-entrance-schedulen.dgn		DRAWN - TRF	REVISED -
PLOT SCALE = 48,000' / IN.		CHECKED -	REVISED -
PLOT DATE = Mar-17-2010 03:58:09PM		DATE - 7/6/2007	REVISED -

STATE OF ILLINOIS  
DEPARTMENT OF TRANSPORTATION

SCHEDULE OF QUANTITIES			
SCALE: N/A	SHEET NO. OF SHEETS	STA.	TO STA.

F.A.P. RTE.	SECTION	COUNTY	TOTAL SHEETS	SHEET NO.
614	8CS(RS-3); 146(RS-3)	CASS	14	7
FED. ROAD DIST. NO. ILLINOIS FED. AID PROJECT			CONTRACT NO. 72B25	



ENTRANCE IMPROVEMENT SCHEDULE FOR RURAL / URBAN "PPP" PROJECT (VIRGINIA, ILLINOIS)

LOCATION (LT / RT) (STA) ( )	TYPE OF ENTRANCE (FE / PE / CE / MB) (RURAL / URBAN)	EX MATERIAL TYPE DRIVE	EX MATERIAL TYPE APRON	LENGTH (FROM EDGE OF PVT/ BIT SHLD TO LIMITS OF IMPROVEMENT) FOOT	WIDTH FOOT	TAPER FOOT	RADIUS RETURN FOOT	DRIVEWAY AREA SQ. FT.	TAPER/RADIUS RETURN AREA SQ. FT.	MAILBOX TURNOUT AREA SQ. FT.	TOTAL AREA SQ. FT.	PROPOSED HMA THICKNESS INCH	PCC SURF. REM. - BUTT JOINT SQ. YD.	HOT-MIX ASPHALT SURF. REM. - BUTT JOINT SQ. YD.	PREPARATION OF BASE SQ. YD.	AGGREGATE SURFACE COURSE, TYPE B TON	BITUMINOUS (P. C.) TON	PCC DRIVEWAY PAVEMENT, 6" SQ. YD.	INCIDENTAL HOT-MIX ASPHALT SURFACING TON
LT, STA. 5+81	PE/MB/RURAL	AGG	BIT/AGG	10	10		10	100	43	252	395	3.5			44	1	0.1		9
RT, STA. 6+07	PE/RURAL	AGG	BIT/AGG	10	24		25 / 15	240	158	0	398	3.5			45	1	0.1		9
RT, STA. 16+86	PE/MB/RURAL	AGG	BIT/AGG	10	14		20	140	155	194	489	3.5			55	1	0.09		11
LT, STA. 62+34	PE/MB/RURAL	AGG	BIT/AGG	10	11		15	110	94	207	411	3.5			46	1	0.07		9
RT, STA. 99+42	PE/RURAL	AGG	BIT/AGG	10	10		15	100	94	0	194	3.5			22	1	0.04		5
LT, STA. 99+42	MB/RURAL		AGG		AS	PER	STD.	0	0	368	368	3.5			41	1	0.06		9
LT, STA. 99+82	PE/RURAL	AGG	BIT/AGG	10	12		15	120	94	0	214	3.5			24	1	0.04		5
RT, STA. 99+82	PE/RURAL	AGG	BIT/AGG	10	11		25	110	221	0	331	3.5			37	1	0.06		8
LT, STA.	MB/RURAL		AGG		AS	PER	STD.	0	0	368	368	3.5			41	1	0.06		9
LT, STA.	PE/MB/RURAL	AGG	BIT/AGG	10	18		15 / 25	180	158	187	525	3.5			59	1	0.09		12
RT, STA.	PE/MB/RURAL	AGG	BIT/AGG	10	20		25	200	221	187	608	3.5			68	1	0.10		14
RT, STA.	CE/URBAN	O&C	BIT	10	26		20	260	155	0	415	2		47				0.02	6
RT, STA.	CE/URBAN	AGG	BIT/AGG	10	26		20	260	155	0	415	8			47	1	0.07		21
RT, STA.	PE/URBAN (ABANDONED)	AGG	AGG	0	10		0	0	0	0	0								0
RT, STA.	PE/URBAN	AGG	AGG	10	9		15	90	94	0	184	3.5			21		0.04		5
RT, STA.	PE/URBAN (ABANDONED)	AGG	AGG	0	12		0	0	0	0	0								0
RT, STA.	PE/URBAN	BIT	BIT	10	8		15	80	94	0	174	2		20				0.01	3
RT, STA.	PE/URBAN	AGG	AGG	10	10		15	100	94	0	194	3.5			22	1	0.04		5
RT, STA.	PE/URBAN	AGG	AGG	10	12		15	120	94	0	214	3.5			24	1	0.04		5
RT, STA.	PE/URBAN	AGG	AGG	10	10		15	100	94	0	194	3.5			22	1	0.04		5
RT, STA.	CE/URBAN	BIT	BIT	10	20		14	200	85	0	285	2		32				0.02	4
RT, STA.	CE/URBAN	BIT	BIT	10	22		14	220	85	0	305	2		34				0.02	4
RT, STA.	CE/URBAN	O&C	BIT	10	20		20	200	155	0	355	2		40				0.02	5
RT, STA.	PE/URBAN	AGG	AGG	10	8		12	80	62	0	142	3.5			16	1	0.03		4
LT, STA.	CE/URBAN	AGG	AGG	10	11		15	110	94	0	204	8			23	1	0.04		11
LT, STA.	PE/URBAN	AGG	AGG	10	12		15	120	94	0	214	3.5			24	1	0.04		5
RT, STA.	PE/URBAN	BIT	BIT	11	12		11	132	0	0	132	2		15				0.01	2
LT, STA.	PE/URBAN	AGG	AGG	10	12	11		120	0	0	120	3.5			14	1	0.03		3
RT, STA.	PE/URBAN	O&C	BIT	11	15	11		165	121	0	286	2		32				0.02	4
LT, STA.	PE/URBAN	AGG	AGG	10	11		6	110	0	0	110	3.5			13	1	0.02		3
RT, STA.	PE/URBAN	PCC	PCC	10	15	11		150	0	0	150		17					17	0
LT, STA.	PE/URBAN	BIT	PCC	10	22			220	0	0	220		25					25	0
RT, STA.	PE/URBAN	PCC	BIT/PCC	15	18		15	270	94	0	364	1.5		41				0.02	4
LT, STA.	CE/URBAN	BIT	BIT	3	35		3	105	4	0	109	2		13				0.01	2
LT, STA.	CE/URBAN	BIT	BIT	3	33		3	99	4	0	103	2		12				0.01	2
LT, STA.	PE/URBAN	AGG	BIT	10	21	5		210	0	0	210	2		24				0.01	3
RT, STA.	PE/URBAN	AGG	BIT	4	10	4		40	16	0	56	2		7				0.01	1
RT, STA.	PE/URBAN	BIT	BIT	4	15	4		60	16	0	76	2		9				0.01	1
RT, STA.	CE/URBAN	AGG	PCC	10	40		4	400	0	0	400		45					45	0
RT, STA.	CE/URBAN	AGG	PCC	10	35		4	350	0	0	350		39					39	0
LT, STA.	CE/URBAN	PCC	PCC	10	20		5	200	0	0	200		23					23	0
LT, STA.	CE/URBAN	PCC	PCC	10	45		5	450	0	0	450		50					50	0
LT, STA.	CE/URBAN	BIT	PCC	10	52		5	520	0	0	520		58					58	0
RT, STA.	PE/URBAN	AGG	PCC	10	13		4	130	0	0	130		15					15	0
LT, STA.	PE/URBAN	AGG	BIT	5	24		5	120	11	0	131	2		15			0.01		2
TOTAL =								7,091	2,859	1,763	11,713		272	341	708	18	1.4	272.0	210
5% CONTINGENCY													14	17	35	1	0	14	11
USE													286	358	743	19	1.5	286	221

Rev. 4-1-10

FILE NAME =	USER NAME = laughlinr1	DESIGNED -	REVISED -
es:\pwwork\pwwork\LAUGHLINR1\dms30897\0672825-shit-entrance-schedule.dgn		DRAWN - TRF	REVISED -
PLOT SCALE = 48.000' / IN.		CHECKED -	REVISED -
PLOT DATE = Mar-17-2010 03:58:11PM		DATE - 7/6/2007	REVISED -

STATE OF ILLINOIS  
DEPARTMENT OF TRANSPORTATION

SCHEDULE OF QUANTITIES

SCALE: N/A SHEET NO. OF SHEETS STA. TO STA.

F.A.P. RTE.	SECTION	COUNTY	TOTAL SHEETS	SHEET NO.
614	8CS(RS-3); 146(RS-3)	CASS	14	8
FED. ROAD DIST. NO. ILLINOIS FED. AID PROJECT			CONTRACT NO. 72B25	

ADJUSTMENT ITEM SCHEDULE						
LOCATION		WATERVALVES TO BE ADJUSTED	ADJUST MONITORING WELLS	FRAMES AND GRATES TO BE ADJUSTED	GRATES, TYPE 8	FRAMES AND FBGRATES, TYPE 6
STA.	OFFSET					
265+27				1	1	
267+39	13' LT			1	1	
281+14	20' LT	1				
286+04	42' LT		1			
287+70	30' LT	1				
291+53	20' LT	1				
298+81						1
TOTALS		3	1	2	2	1

ESTIMATED QUANTITIES	
PAY ITEM	QUANTITY
PAVEMENT PATCHING, TYPE II, 12 INCH	800
PAVEMENT PATCHING, TYPE III, 12 INCH	250
PAVEMENT PATCHING, TYPE IV, 12 INCH	150

PAVEMENT MARKING SCHEDULE																
LOCATION			PAINT PAVEMENT MARKING - LINE 5"			THERMOPLASTIC PAVEMENT MARKING - LINE 5"	PREFORMED PLASTIC PAVEMENT MARKING, TY B - INLAID - LINE 6"	PREFORMED PLASTIC PAVEMENT MARKING, TY B - INLAID - LINE 6"	TEMPORARY PAVEMENT MARKING - LINE 5"			RAISED REFLECTIVE PAVEMENT MARKERS	RAISED REFLECTIVE PAVEMENT MARKER REMOVAL	SHORT-TERM PAVEMENT MARKING (2 APPLICATIONS)	WORK ZONE PAVEMENT MARKING REMOVAL	
			SOLID WHITE	SOLID YELLOW	SKIP DASHED YELLOW				FOOT	FOOT	FOOT					SOLID WHITE
STA.	STA.	PASS	FOOT	FOOT	FOOT	FOOT	FOOT	FOOT	FOOT	FOOT	FOOT	FOOT	EACH	EACH	FOOT	SQ FT
3+11	85+62.38	/	16,503	2,070	2,070				16.50	2,070	2,070	104	104	1,510	504	
STATION EQUATION																
85+30.18	241+48	/	31,236	3,910	3,910				31,23	3,910	3,910	196	196	2,850	950	
241+48	295+87	CL	10,878		1,360				10,878		1,360	68	68	990	330	
CROSSWALK @ VILLAGE SQUARE							124		124							
CROSSWALK @ BEARDSTOWN ST.							90									
CROSSWALK @ SPRINGFIELD ST.							90									
STOP BARS @ B-TOWN & SPFLD ST.								62								
PARKING EDGE LINES IN VIRGINIA						3,600			3,600							
PARKING "T" S" B-TOWN ST. TO SPFLD. ST						40			0							
TOTALS			58,617	5,980	7,340	3,640	304	62	62,341	5,980	7,340	368	368	5,350	1,784	
			71,937						75,661							

Rev. 4-1-10

FILE NAME =	USER NAME = laughlinr1	DESIGNED -	REVISED -
er\pv\work\PWIDOT\LAUGHLINR1\dms30897\672825-shj-schedule.dgn		DRAWN - TRF	REVISED -
		CHECKED -	REVISED -
		DATE - 7/6/2007	REVISED -

STATE OF ILLINOIS  
DEPARTMENT OF TRANSPORTATION

SCHEDULE OF QUANTITIES

SCALE: SHEET NO. OF SHEETS STA. TO STA.

F.A.P. RTE.	SECTION	COUNTY	TOTAL SHEETS	SHEET NO.
614	8CS(RS-3); 146(RS-3)	CASS	14	9
CONTRACT NO. 72B25				
FED. ROAD DIST. NO. ILLINOIS FED. AID PROJECT				



**LEGEND**

- ① EX P.C.C. PAVEMENT (9"-6"-9")
- ② EX BITUMINOUS CONCRETE SURFACE
- ③ EX 1/2" BITUMINOUS CONCRETE SURFACE COURSE, MIXTURE C, CLASS 1, TYPE 2
- ④ EX 1/2" BITUMINOUS CONCRETE SURFACE COURSE, MIXTURE D, CLASS 1, TYPE 2
- ⑤ EX BITUMINOUS BASE COURSE, 3/2"±
- ⑥ EX PCC BASE COURSE WIDENING
- ⑦ EX PCC CURB
- ⑧ EX PCC GUTTER
- ⑨ EX PCC CURB & GUTTER
- ⑩ EX PCC BASE
- ⑪ EX SAND CUSHION
- ⑫ EX BRICK PAVEMENT
- ⑬ EX GRANULAR EMBANKMENT
- ⑭ EXCAVATING AND GRADING EXISTING SHOULDER
- ⑮ LEVELING BINDER (MACHINE METHOD), N50 (3/4")
- ⑯ HOT-MIX ASPHALT SURFACE REMOVAL - BUTT JOINT
- ⑰ HOT-MIX ASPHALT SURFACE COURSE, MIX "C", N50 (1 1/2")
- ⑱ HOT-MIX ASPHALT SURFACE REMOVAL, 2/4"
- ⑲ HOT-MIX ASPHALT SURFACE REMOVAL, VARIABLE DEPTH
- ⑳ AGGREGATE SHOULDERS, TYPE B
- ㉑ HOT-MIX ASPHALT SHOULDERS, 6"
- ㉒ PAINT PAVEMENT MARKING - LINE 5"

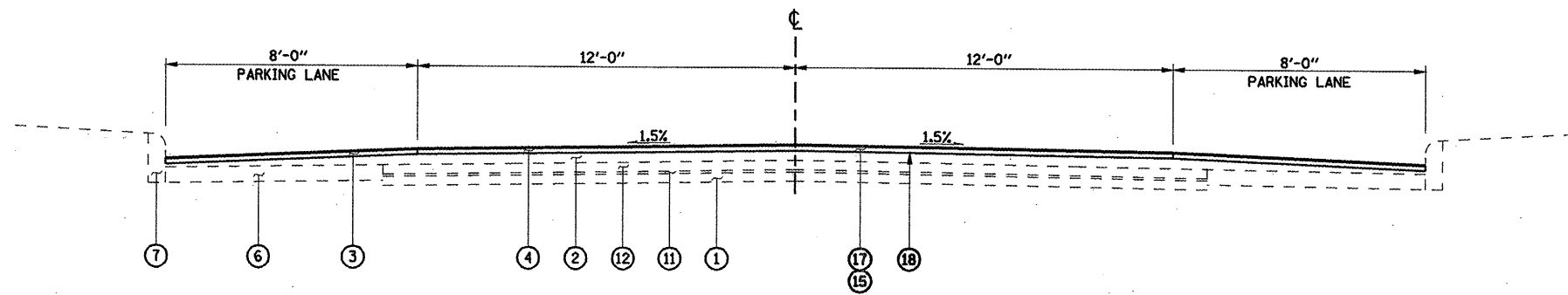

**TYPICAL SECTION**

STA 276+00 TO STA 282+46

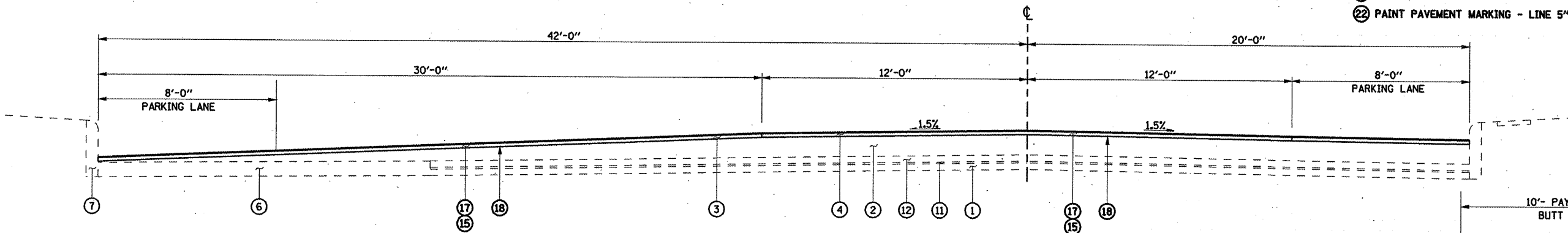

**TYPICAL SECTION**

STA 282+46 TO STA 286+42

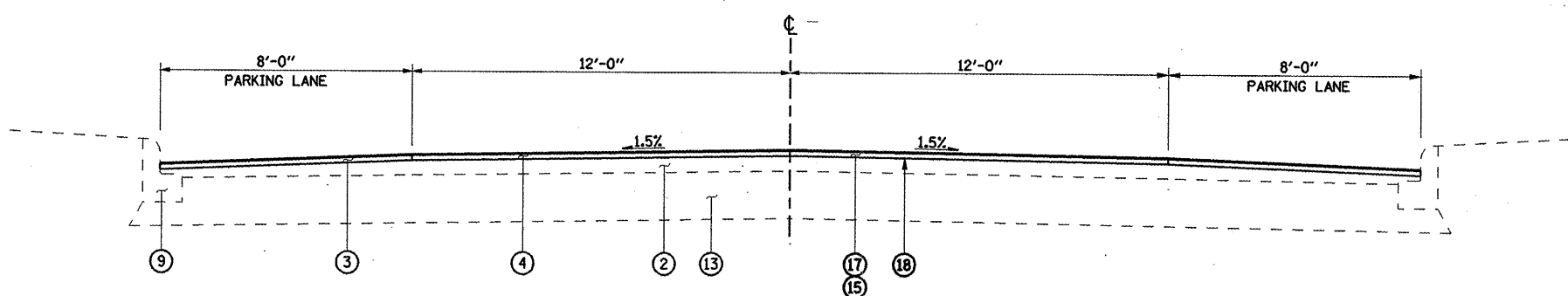

**TYPICAL SECTION**

STA 286+42 TO STA 295+87

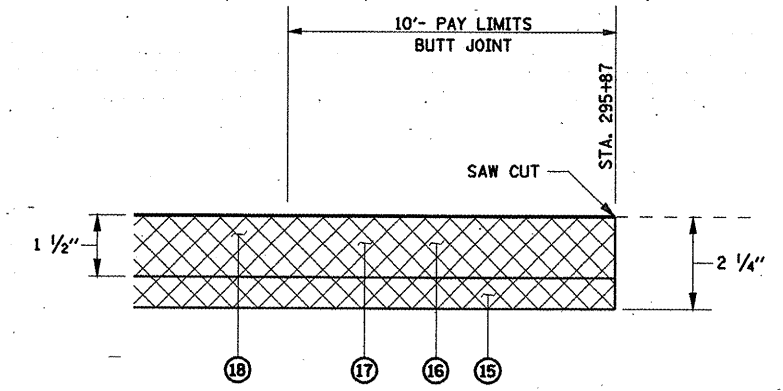

**URBAN BUTT - JOINT DETAIL**

Rev. 4-1-10

FILE NAME =	USER NAME = laughtin-l	DESIGNED -	REVISED -	<b>STATE OF ILLINOIS DEPARTMENT OF TRANSPORTATION</b>	<b>ILLINOIS ROUTE 78 TYPICAL SECTIONS</b>	F.A.P. RTE.	SECTION	COUNTY	TOTAL SHEETS	SHEET NO.
672B25-shr-typical.dgn	DRAWN -	REVISED -	614			8CS(RS-3); 146(RS-3)	CASS	14	11	
PLOT SCALE = 20.0000' / IN.	CHECKED - JAC	REVISED -	CONTRACT NO. 72B25							
PLOT DATE = Mar-17-2010 03:58:16PM	DATE - 6/11/2007	REVISED -	FED. ROAD DIST. NO. ILLINOIS FED. AID PROJECT							
				SCALE:	SHEET NO. OF SHEETS	STA.	TO STA.			

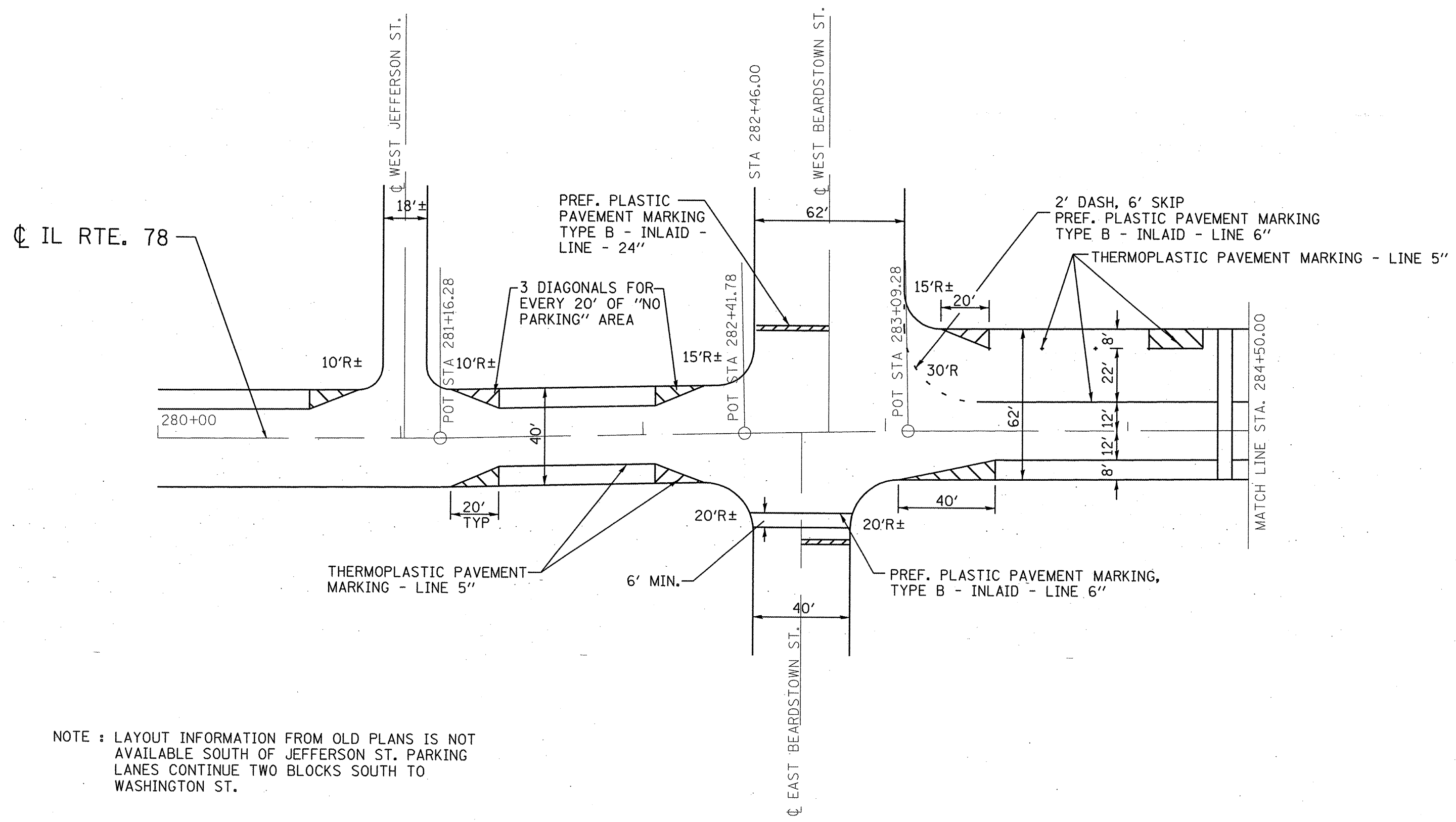

NOTE : LAYOUT INFORMATION FROM OLD PLANS IS NOT AVAILABLE SOUTH OF JEFFERSON ST. PARKING LANES CONTINUE TWO BLOCKS SOUTH TO WASHINGTON ST.

FILE NAME =	USER NAME = laughlinr1	DESIGNED -	REVISED -	<b>STATE OF ILLINOIS DEPARTMENT OF TRANSPORTATION</b>	<b>PAVEMENT MARKING DETAIL</b>			F.A.P. RTE.	SECTION	COUNTY	TOTAL SHEETS	SHEET NO.
et:\pwwork\pwwid\LAUGHLINRL\dms30897\672825-shs-Downtown Square PV.dgn		DRAWN -	REVISED -		614	8CS(RS-3), 146(RS-3)	CASS	14	14A			
PLOT SCALE = 40.0000' / IN.		CHECKED -	REVISED -		<b>CONTRACT NO. 72825</b>							
PLOT DATE = Mar-17-2010 03:58:18PM		DATE -	REVISED -		ILLINOIS FED. AID PROJECT							
				SCALE:	SHEET NO.	OF	SHEETS	STA.	TO STA.			

Added 4-1-10

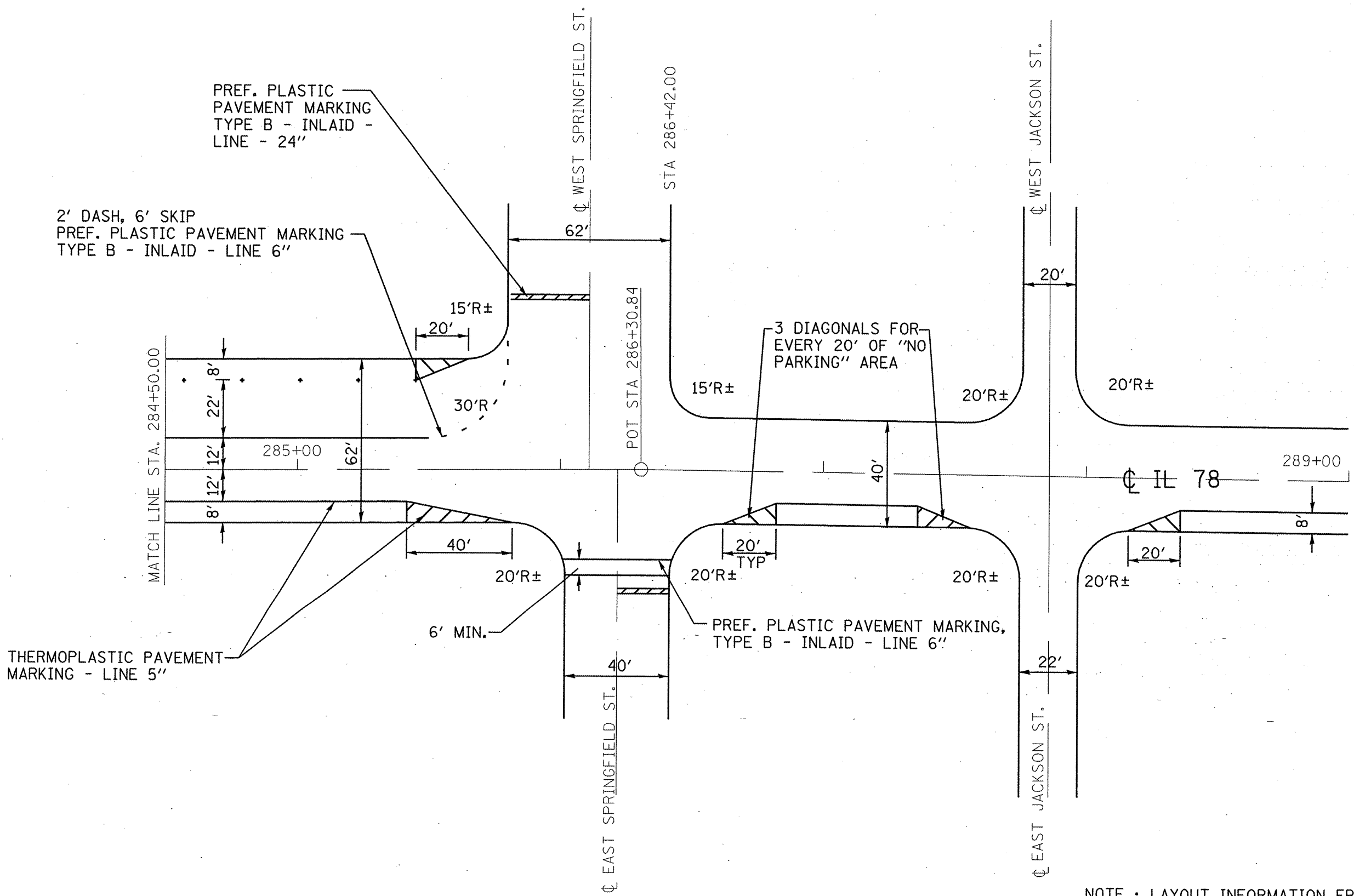

NOTE : LAYOUT INFORMATION FROM OLD PLANS IS NOT AVAILABLE BEYOND JACKSON ST. PARKING LANES CONTINUE FOUR BLOCKS NORTH TO SYLVAN ST.

*Added 4-1-10*

FILE NAME =	USER NAME = laughlinr1	DESIGNED -	REVISED -	<b>STATE OF ILLINOIS DEPARTMENT OF TRANSPORTATION</b>	<b>PAVEMENT MARKING DETAIL</b>		F.A.P. RTE.	SECTION	COUNTY	TOTAL SHEETS	SHEET NO.
cr:\pwwork\pwidot\LAUGHLINRL\dms30897\	672825-shr-Downtown Square PV.dgn	DRAWN -	REVISED -				614	8CS(RS-3); 146(RS-3)	CASS	14	14B
	PLOT SCALE = 48,0000 / IN.	CHECKED -	REVISED -				CONTRACT NO. 72B25				
	PLOT DATE = Mar-17-2010 03:50:20PM	DATE -	REVISED -				ILLINOIS FED. AID PROJECT				
					SCALE:	SHEET NO. OF SHEETS	STA.	TO STA.			