

SE 1/4 SEC. 7, T3S, R7W 4th PM.

COMMUNITY UNIT
SCHOOL DISTRICT #1

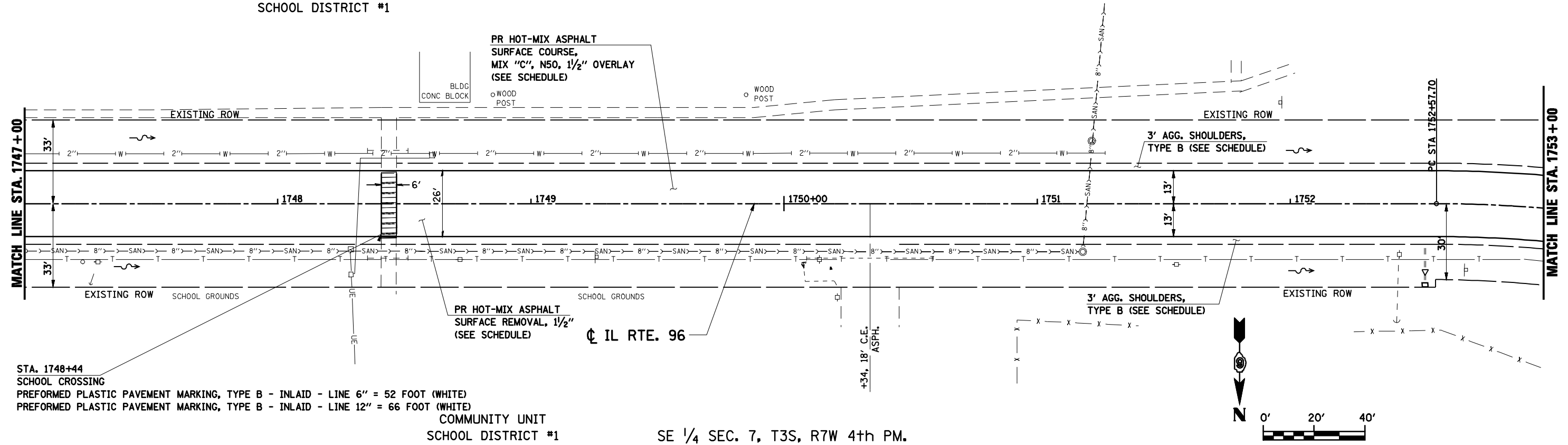

STA. 1748+44
SCHOOL CROSSING
PREFORMED PLASTIC PAVEMENT MARKING, TYPE B - INLAID - LINE 6" = 52 FOOT (WHITE)
PREFORMED PLASTIC PAVEMENT MARKING, TYPE B - INLAID - LINE 12" = 66 FOOT (WHITE)

COMMUNITY UNIT
SCHOOL DISTRICT #1

SE 1/4 SEC. 7, T3S, R7W 4th PM.

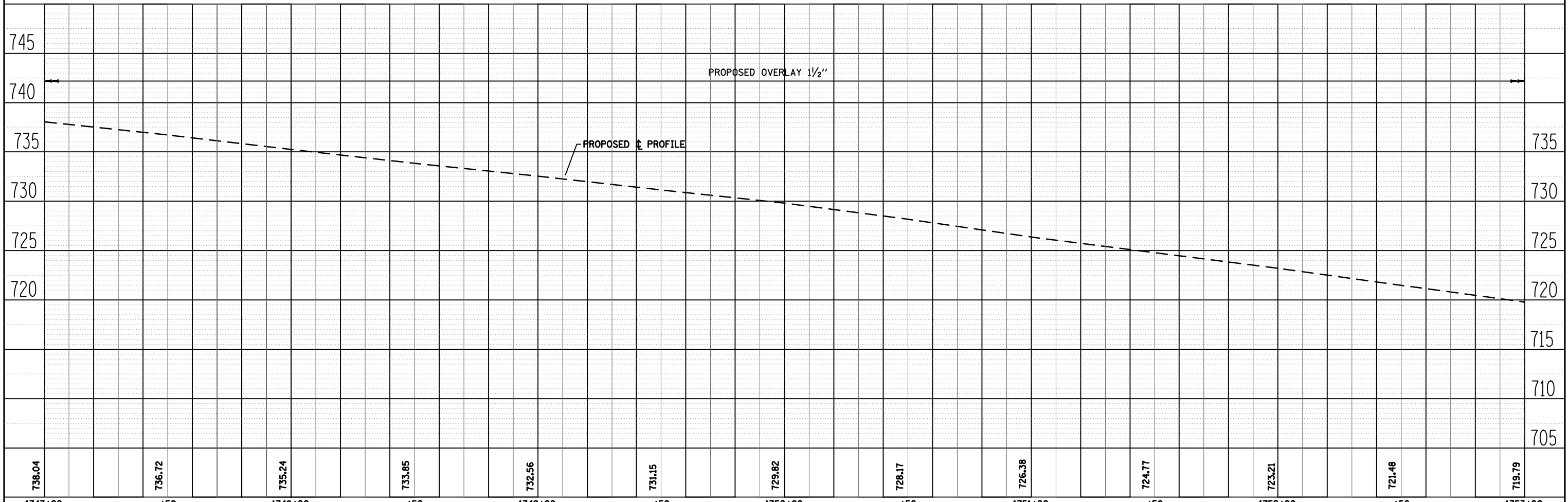

DATE	
BY	
REVIEWED	
PLANNED	
NOTE BOOK	
NO.	

DATE	
BY	
REVIEWED	
PLANNED	
NOTE BOOK	
NO.	

FILE NAME =	USER NAME = laughlinr1	DESIGNED -	REVISED -	<p align="center">STATE OF ILLINOIS DEPARTMENT OF TRANSPORTATION</p>	F.A.S. RTE.	SECTION	COUNTY	TOTAL SHEETS	SHEET NO.
c:\pwork\PWIDOT\LAUGHLINR1\dms30940\672826-sh-t-p1npr-f2.dgn		DRAWN -	REVISED -		1597	12(IRS-7) & 13(IRS-6)	ADAMS	29	17
PLOT SCALE = 48.000' / IN.		CHECKED -	REVISED -		CONTRACT NO. 72B26				
PLOT DATE = Feb-04-2010 02:25:19PM		DATE -	REVISED -		FED. ROAD DIST. NO.	ILLINOIS FED. AID PROJECT			

SCALE: SHEET NO. OF SHEETS STA. TO STA.