

TRAFFIC SIGNAL QUANTITIES

QUANTITY	UNIT	ITEM
10	EACH	MODIFY EXISTING TRAFFIC SIGNAL BACKPLATE

NOTES

- ① MODIFY EXISTING TRAFFIC SIGNAL BACKPLATE

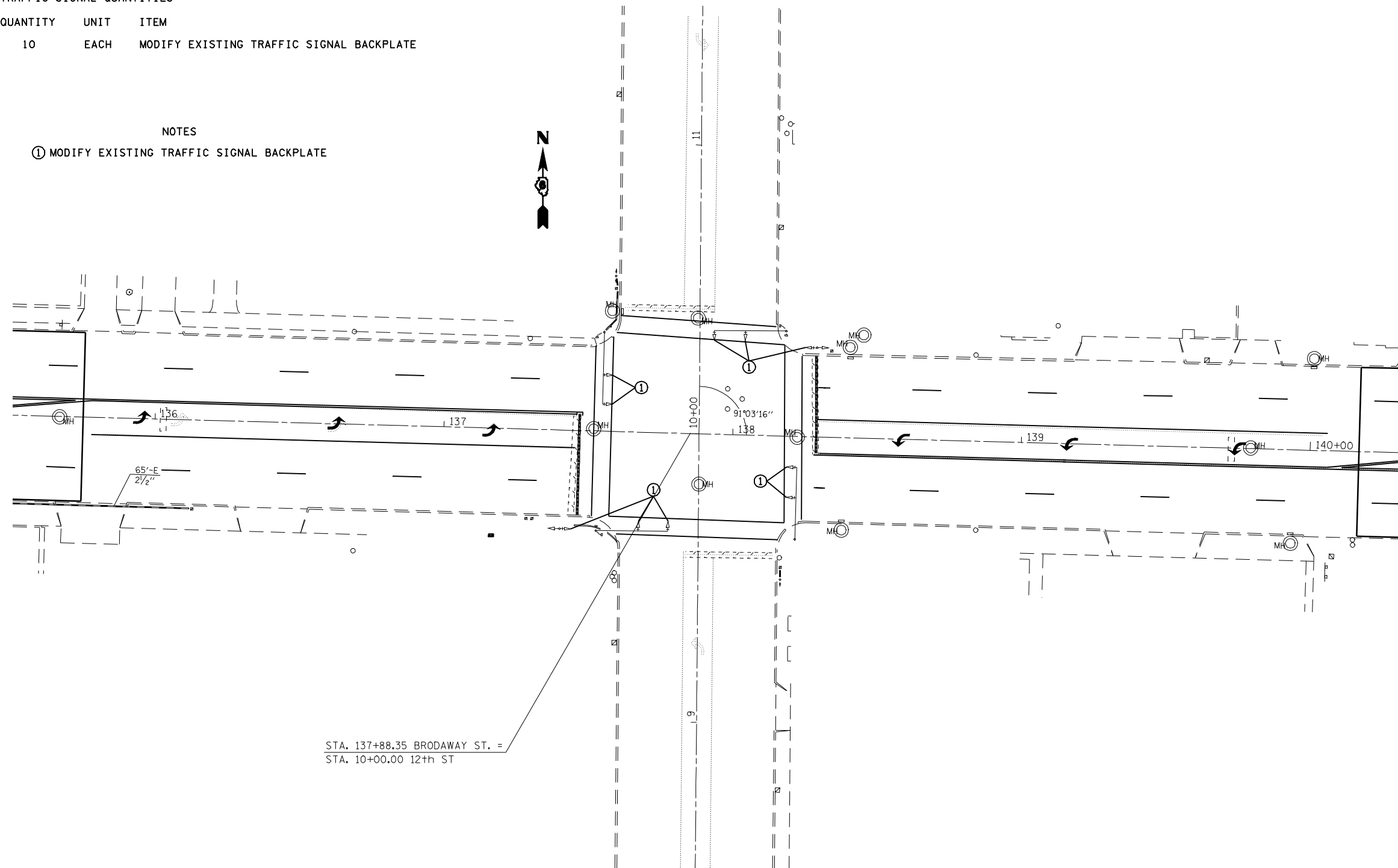

STA. 137+88.35 BROADWAY ST. =  
STA. 10+00.00 12th ST



FILE NAME =	USER NAME = laughlinr1	DESIGNED - WCD	REVISED -
er\pwork\PWIDOT\LAUGHLINRL\dms30500\672C30-shr-TS.dgn		DRAWN - CAD	REVISED -
PLOT SCALE = 40.0000' / IN.		CHECKED - WCD	REVISED -
PLOT DATE = Feb-01-2010 01:42:44PM		DATE - 12/3/99	REVISED -

**STATE OF ILLINOIS  
DEPARTMENT OF TRANSPORTATION**

TRAFFIC SIGNAL DETAILS (12th & BROADWAY)			
SCALE:	SHEET NO.	OF SHEETS	STA. TO STA.

F.A.P. RTE.	SECTION	COUNTY	TOTAL SHEETS	SHEET NO.
745	103RS-11	ADAMS	32	32
CONTRACT NO. 72C30				
FED. ROAD DIST. NO. ILLINOIS FED. AID PROJECT				