

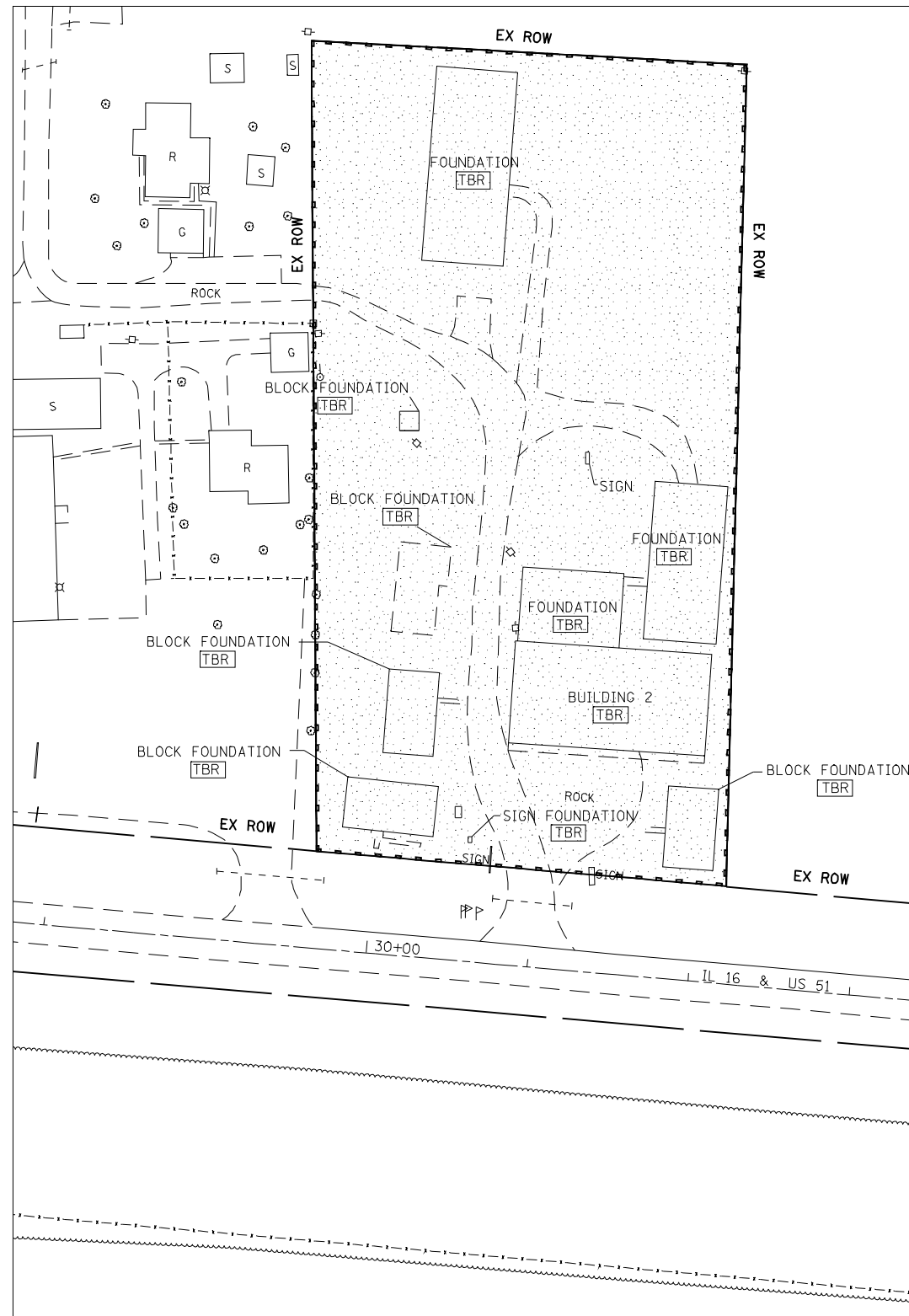

PARCEL NUMBER 6085109

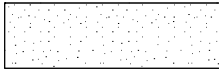

**QUANTITIES**

SEEDING, CLASS 2	3.03	ACRE
NITROGEN FERTILIZER NUTRIENT	273	POUND
PHOSPHORUS FERTILIZER NUTRIENT	273	POUND
POTASSIUM FERTILIZER NUTRIENT	273	POUND
MULCH, METHOD 2	3.03	ACRE
PERIMETER EROSION BARRIER	1,534	FOOT
TEMPORARY EROSION CONTROL SEEDING	303	POUND

	SEEDING, CLASS 2
	PERIMETER EROSION BARRIER

FILE NAME =	USER NAME = laughlinr1	DESIGNED -	REVISED -	<b>STATE OF ILLINOIS DEPARTMENT OF TRANSPORTATION</b>	<b>PARCEL NUMBER 6085109 SEEDING PLAN SHEET</b>				F.A.P. RTE.	SECTION	COUNTY	TOTAL SHEETS	SHEET NO.
e:\pwwork\pwwid\LAUGHLINRL\0169063\0672030-shr-plan.dgn		DRAWN -	REVISED -		322	*	CHRISTIAN	19	9				
PLOT SCALE = 100.0000' / IN.		CHECKED -	REVISED -		CONTRACT NO. 72D30				ILLINOIS FED. AID PROJECT				
PLOT DATE = Jan-28-2010 01:31:48PM		DATE -	REVISED -		SCALE:	SHEET NO.	OF SHEETS	STA.	TO STA.				