

F.A.P. RTE.	SECTION	COUNTY	TOTAL SHEETS	SHEET NO.
310	69-2LS	MORGAN	16	6
STA.		TO STA.		
FED. ROAD DIST. NO.		ILLINOIS FED. AID PROJECT		

SEEDING LEGEND

 PROPOSED SEEDING CLASS 4 (MODIFIED)

SEC 9, T15N, R11W, 3rd PM

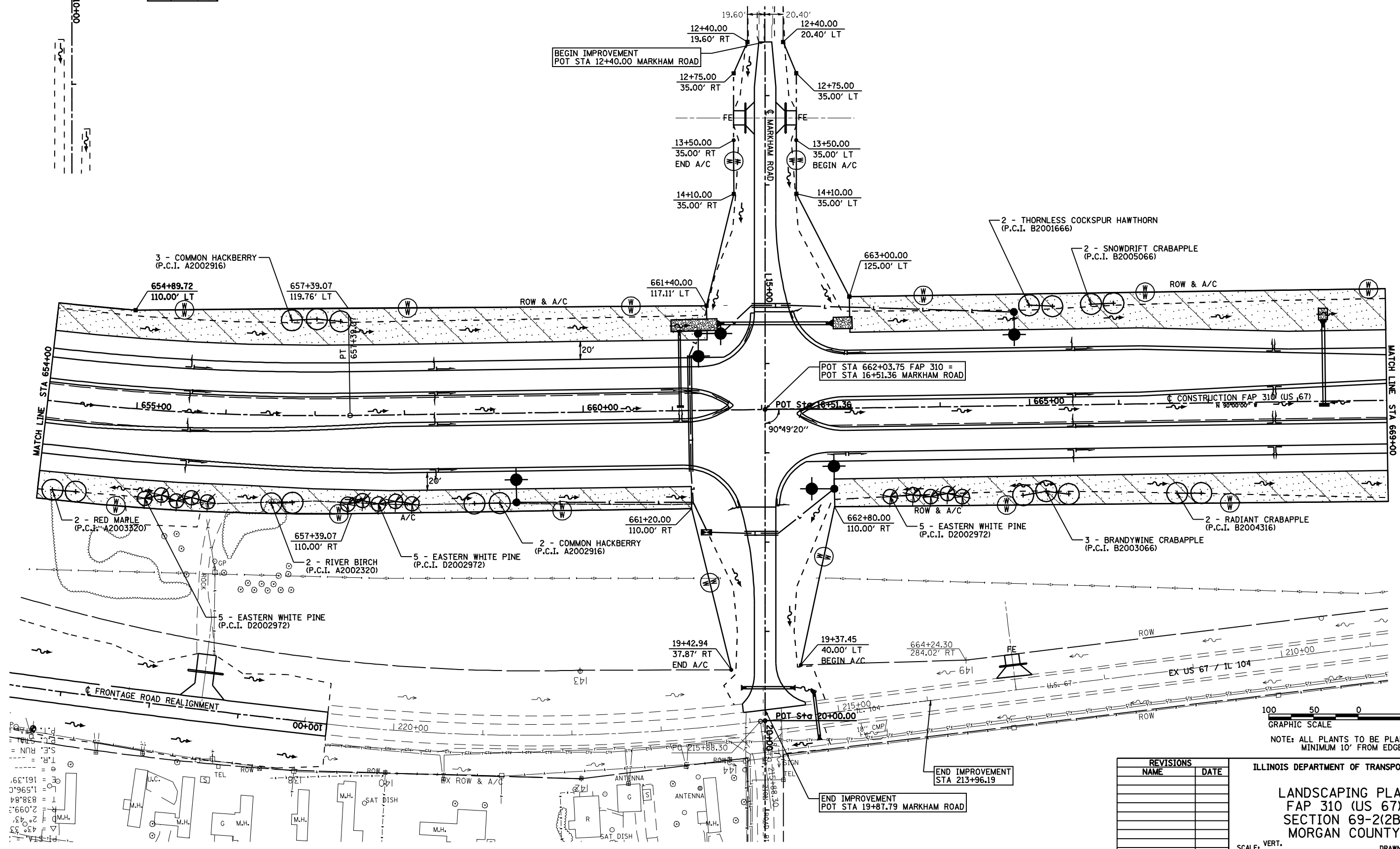

SEC 9, T15N, R11W, 3rd PM

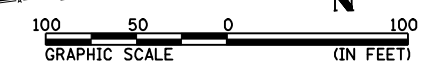

NOTE: ALL PLANTS TO BE PLANTED
MINIMUM 10' FROM EDGE ROW

REVISIONS	
NAME	DATE

ILLINOIS DEPARTMENT OF TRANSPORTATION

LANDSCAPING PLAN
FAP 310 (US 67)
SECTION 69-2(B)
MORGAN COUNTY

SCALE: VERT. _____
HORIZ. _____
DATE _____ DRAWN BY _____
CHECKED BY _____

FAP 310 STA 654+00 TO STA 669+00

FAP 310 STA 654+00 TO STA 669+00

FAP 310 STA 654+00 TO STA 669+00