

F.A.P. RTE.	SECTION	COUNTY	TOTAL SHEETS	SHEET NO.
310	69-2LS	MORGAN	16	10
STA. 714+00		TO STA. 729+00		
FED. ROAD DIST. NO.	ILLINOIS	FED. AID PROJECT		

SEEDING LEGEND

 PROPOSED SEEDING CLASS 4 (MODIFIED)

SEC 8, T15N, R11W, 3rd PM

EAST LINE OF NW 1/4 OF SEC 8

SOUTH LINE OF NE 1/4 OF SEC 8

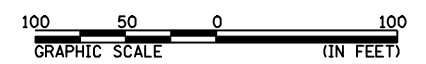
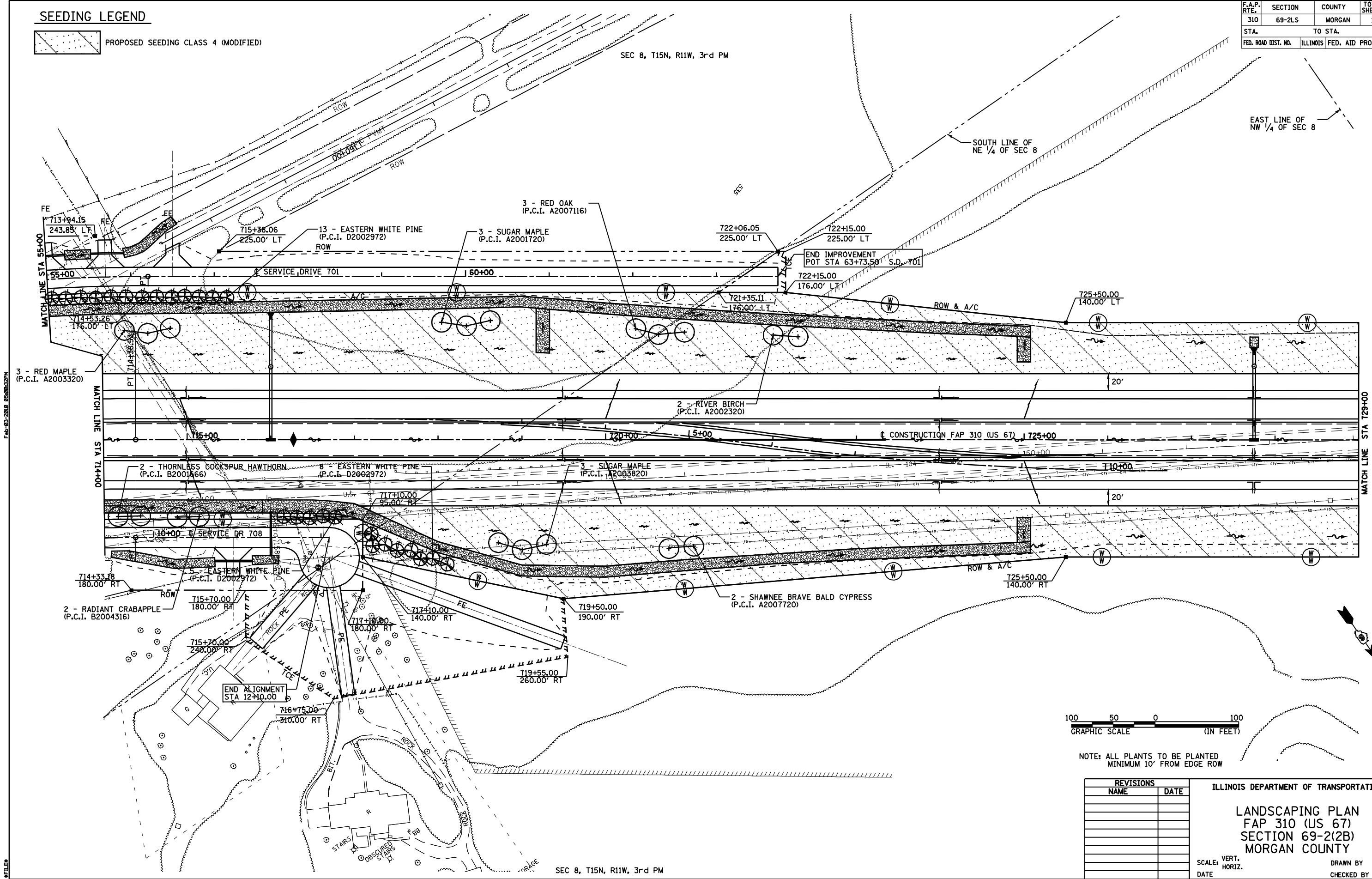

NOTE: ALL PLANTS TO BE PLANTED MINIMUM 10' FROM EDGE ROW

REVISIONS	
NAME	DATE

ILLINOIS DEPARTMENT OF TRANSPORTATION

LANDSCAPING PLAN
FAP 310 (US 67)
SECTION 69-2(2B)
MORGAN COUNTY

SCALE: VERT. _____
 HORIZ. _____

DRAWN BY _____
 CHECKED BY _____

SEC 8, T15N, R11W, 3rd PM

FAP 310 STA 714+00 TO STA 729+00