

Bench Mark: Chiseled "□" NW handrail S.N. 069-0019 Sta. 29+196.97, 5.75 m Rt. Elev. = 195.378

Existing Structure: S.N. 069-0019 Built 1961 as F.A. Rte. 92, Sec. 69WB. Existing structure consists of 3 span reinforced conc. deck on continuous steel WF stringers supported by pile bent spill-thru abuts. and pile supported hammerhead piers. 43.891 m Bk.-Bk. abuts., 10.871 m O.-O. deck. Concrete deck to be removed and replaced.

Traffic to be maintained using stage construction.

No salvage

STATE OF ILLINOIS
DEPARTMENT OF TRANSPORTATION

ROUTE NO.	SECTION	COUNTY	SHEETS	SHEET	SHEET NO. 1
FAP 310A	69VBR	MORGAN	321	137	16 SHEETS
FED. ROAD DIST. NO. 7	ALPHABETIC	FED. AID PROJECT			

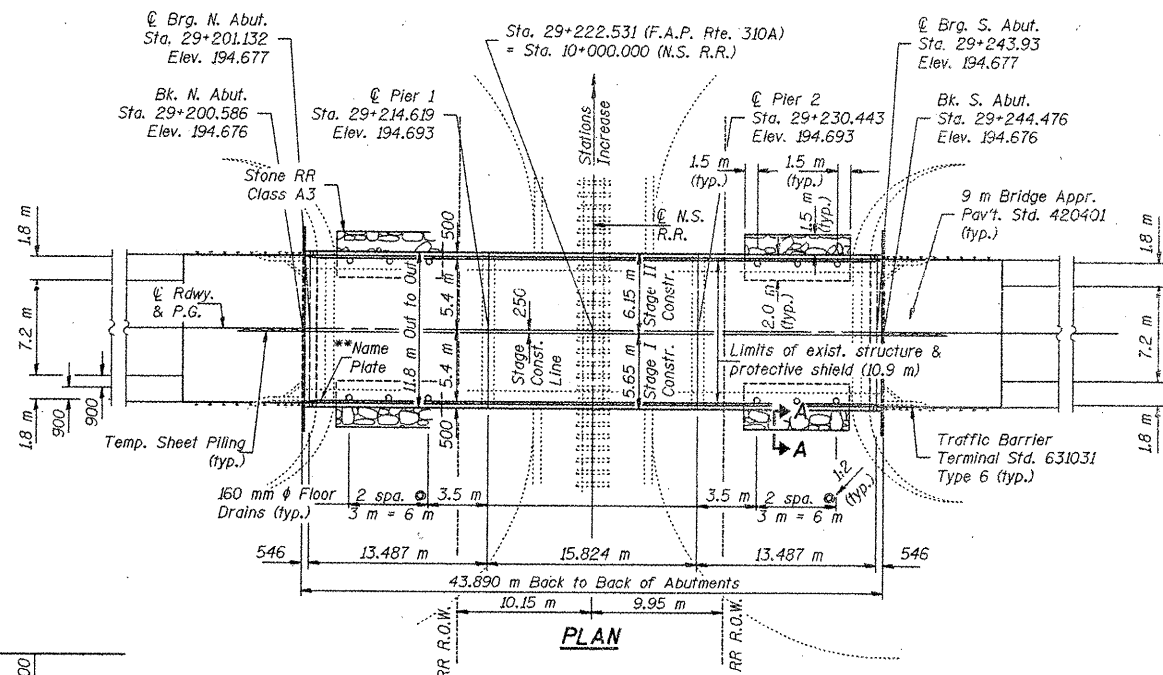
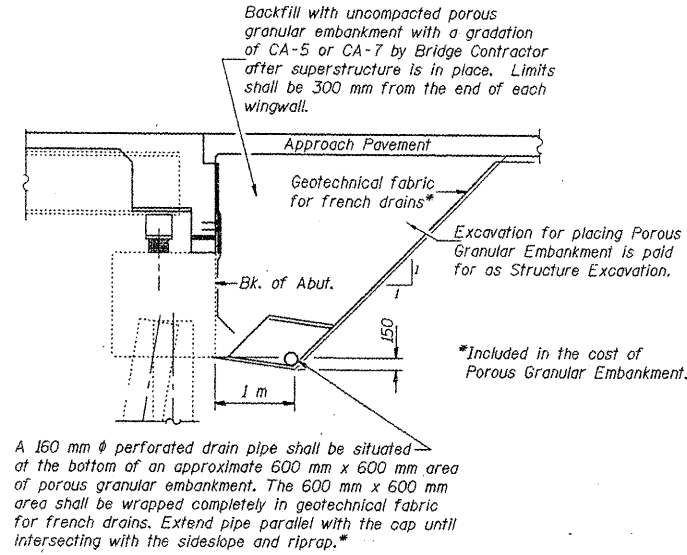
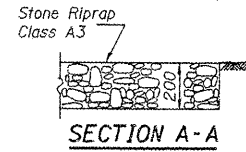
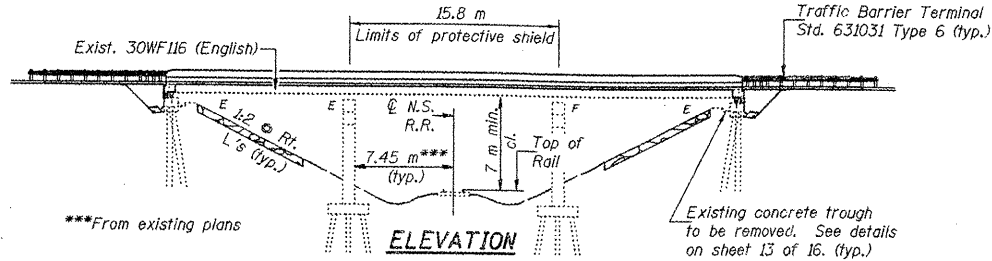

STATION 29+222.531
REBUILT 200 BY
STATE OF ILLINOIS
F.A.P. RT. 310A SEC. 69VBR
PROJECT AC-ACRHF-0009(365)
LOADING MS18
STRUCTURE NO. 069-0019

****NAME PLATE**
See Std. 515001
** Existing name plate to be cleaned and relocated next to the new name plate. Cost included with Name Plates.

LOADING MS18
Allow 1.2 kN/m² for future wearing surface.
DESIGN SPECIFICATIONS
1996 AASHTO with 1997, 1998 & 1999 Interims
1995 Seismic Retrofitting Guidelines for Highway Bridges FHWA/RD-94/052

DESIGN STRESSES
FIELD UNITS
New Construction
f_c = 24 MPa
f_y = 400 MPa (reinforcement)
f_y = 250 MPa (structural steel)
AASHTO II 270M, Gr. 250.
Existing Construction (English)
f_c = 1,000 psi (substructure)
f_s = 18,000 psi (structural steel)
f_s = 20,000 psi (reinforcement)

SEISMIC DATA
Seismic Performance Category (SPC) = A
Bedrock Acceleration Coefficient (A) = 4.8%
Site Coefficient (S) = 1.2

CURVE DATA
@ FAP Rte. 310A
P.I. Sta. = 28+749.203
Δ = 90°-08'-47"
D = 7°-38'-54"
R = 749.142 m
T = 75.1059 m
L = 1178.664 m
E = 311.661 m
S.E. = 4.00%
P.C. Sta. = 27+998.145
P.T. Sta. = 29+176.809
S.E. Removed Sta. 29+160.139 (Full S.E.)
to Sta. 29+241.439 (Normal Crown)

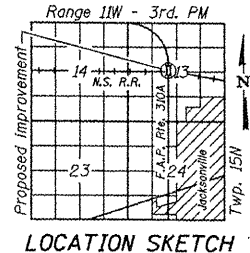

GENERAL PLAN
ILLINOIS RT. 104/U.S. 67 OVER
NORFOLK SOUTHERN RAILROAD
F.A.P. RT 310A - SECTION 69VBR
MORGAN COUNTY
STATION 29+222.531
STRUCTURE NO. 069-0019

PROFILE GRADE
(NSRR - Top of Rail)

DESIGNED	W. J. Burke
CHECKED	C. M. Eng
DRAWN	n.t. parsons
CHECKED	JSB/CPME

EXAMINED
PASSED
PROFESSOR OF BRIDGE DESIGN
ENGINEER OF BRIDGES AND STRUCTURES



EXPIRES 11-30-2002

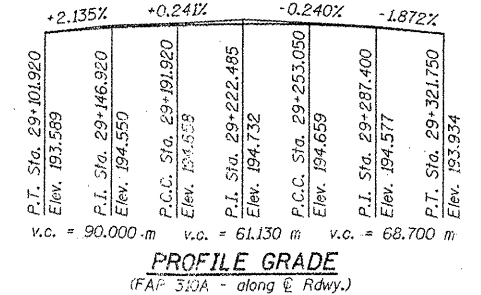

PROFILE GRADE
(FAP 310A - along @ Rdwy.)

FOR INFORMATION ONLY

EXISTING PLANS, SN 069-0019
FAP 63 (US 24) & 310 (IL 104)
D6REHAB BDGE PAINTING 2010-1
ADAMS & MORGAN COUNTIES