

SEE MISCELLANEOUS  
DETAILS FOR SEEPAGE  
FIELD TRENCH DETAIL

DATE	
BY	
REVIEWED	
PLANNED	
NOTE BOOK	
NO.	

DATE	
BY	
REVIEWED	
PLANNED	
NOTE BOOK	
NO.	

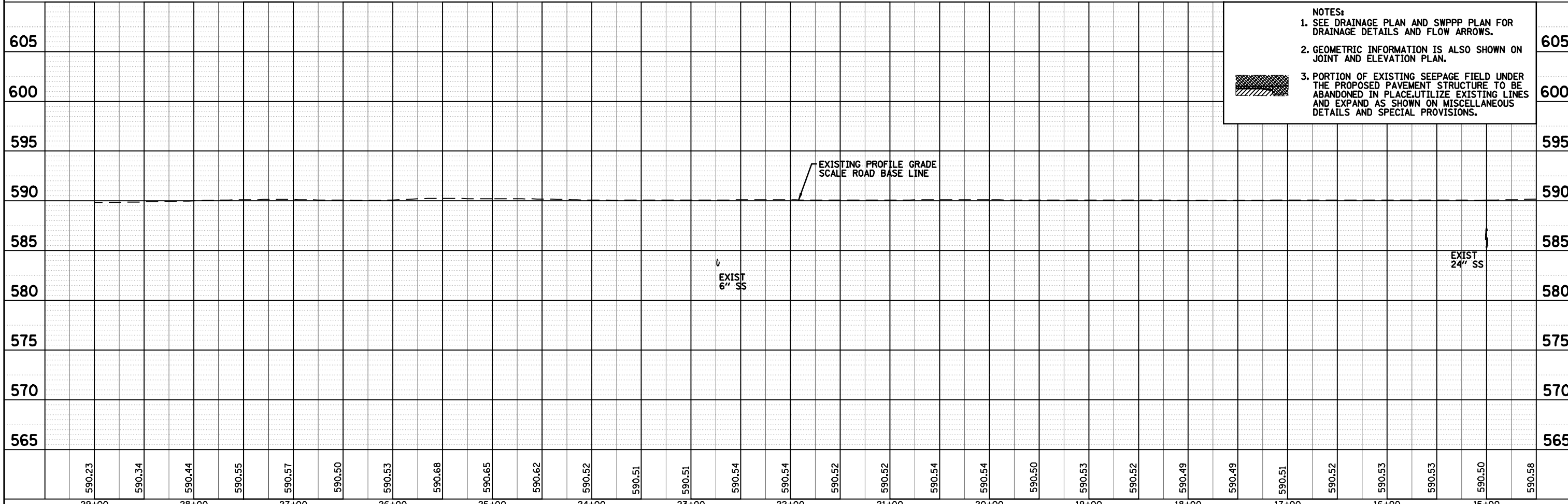
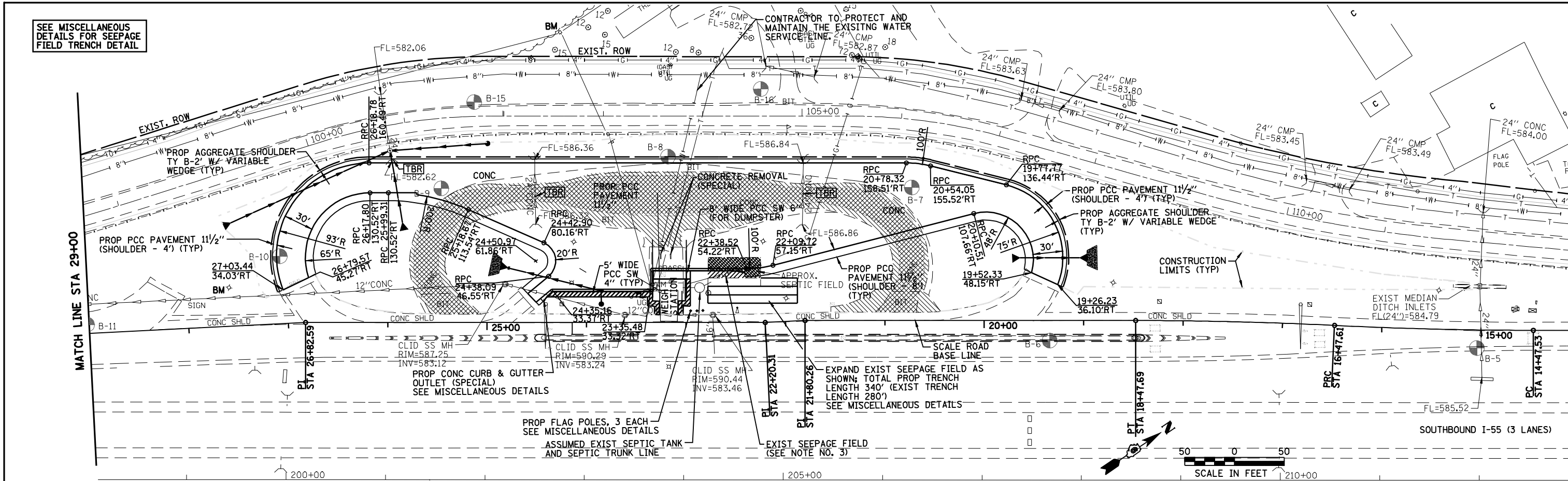

**NOTES:**

- SEE DRAINAGE PLAN AND SWPPP PLAN FOR DRAINAGE DETAILS AND FLOW ARROWS.
- GEOMETRIC INFORMATION IS ALSO SHOWN ON JOINT AND ELEVATION PLAN.
- PORTION OF EXISTING SEEPAGE FIELD UNDER THE PROPOSED PAVEMENT STRUCTURE TO BE ABANDONED IN PLACE. UTILIZE EXISTING LINES AND EXPAND AS SHOWN ON MISCELLANEOUS DETAILS AND SPECIAL PROVISIONS.

FILE NAME =	USER NAME = laughlinr1	DESIGNED - ERB	REVISED - DRR 02/22/10
ct:\pwwork\PWIDOT\LAUGHLINR1\0187096\10...	1-D100681_PLAN_PP.dgn	DRAWN - JJ	REVISED -
	PLOT SCALE = 100.0000' / IN.	CHECKED - PJM	REVISED -
	PLOT DATE = Feb-23-2010 11:34:48AM	DATE - 11/27/06	REVISED -

**STATE OF ILLINOIS  
DEPARTMENT OF TRANSPORTATION**

**WILLIAMSVILLE WEIGH STATION  
PLAN AND PROFILE**

SCALE: SHEET NO. 10 OF 36 SHEETS STA. TO STA.

F.A.I. RTE.	SECTION	COUNTY	TOTAL SHEETS	SHEET NO.
55	84-1-2WS-4	SANGAMON	36	10
CONTRACT NO. 72D58			ILLINOIS FED. AID PROJECT	