

SOUTHBOUND I-55 (3 LANES)

- RADIUS POINT
19+95.97
63.68'RT
- RADIUS POINT
19+98.53
61.18'RT

NOTE:
1. SEE TYPICAL SECTION SHEET FOR DETAILS

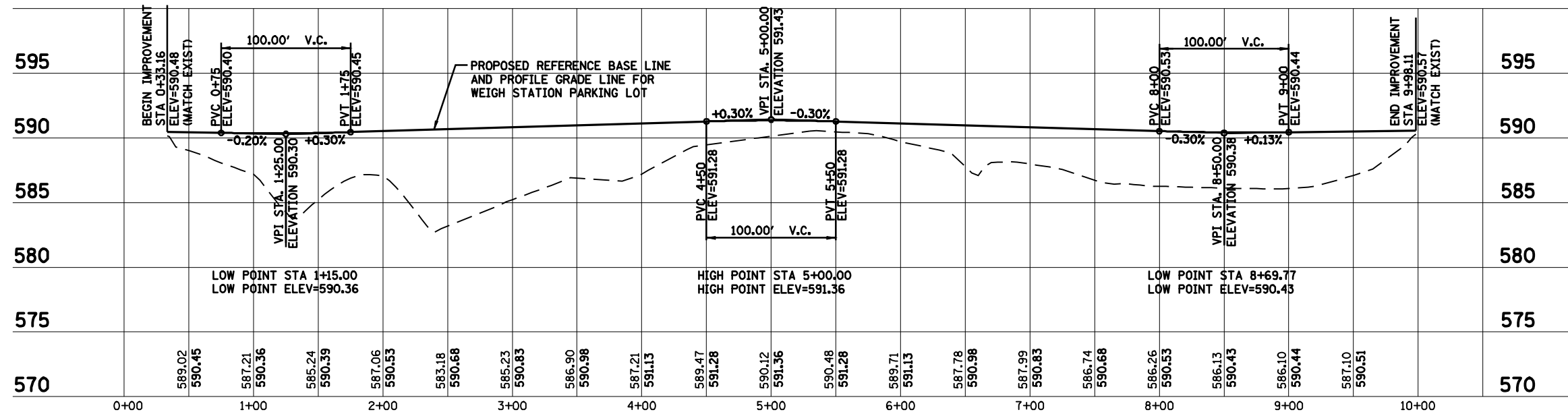

LEGEND

- E590.57 EXISTING PAVEMENT ELEVATION
- P589.99 PROPOSED PAVEMENT ELEVATION LOCATION
- ▬ COMBINATION CONCRETE CURB & GUTTER TYPE B-6.24
- ▬ 1" TRANSVERSE EXPANSION JOINT W/ DOWEL BARS
- ▬ 1/2" DIAMETER DOWEL BAR ASSEMBLY @ TRANSVERSE CONTRACTION JOINT
- ▬ LONGITUDINAL CONSTRUCTION JOINT
- ▬ LONGITUDINAL SAWED JOINT OR LONGITUDINAL CONSTRUCTION JOINT (AS DETERMINED BY THE ENGINEER)

NOTE:
SEE STANDARD 420001 FOR PAVEMENT AND JOINT DETAILS

- NOTES:**
1. ALL JOINT STUBS TO EDGE OF PAVEMENT SHALL BE 2' MINIMUM UNLESS APPROVED OTHERWISE BY THE ENGINEER.
 2. ALL STATIONS AND OFFSETS SHOWN ARE REFERENCED FROM THE WEIGH STATION SCALE ROAD ALIGNMENT.
 3. STATIONS AND OFFSETS ARE SHOWN TO THE EDGE OF PAVEMENT.
 4. CONSTRUCTION JOINTS SHALL BE ALLOWED AT LOCATIONS AS APPROVED BY THE ENGINEER.

