

Note: Trim existing long. reinf. to accommodate new joint opening (typ.)

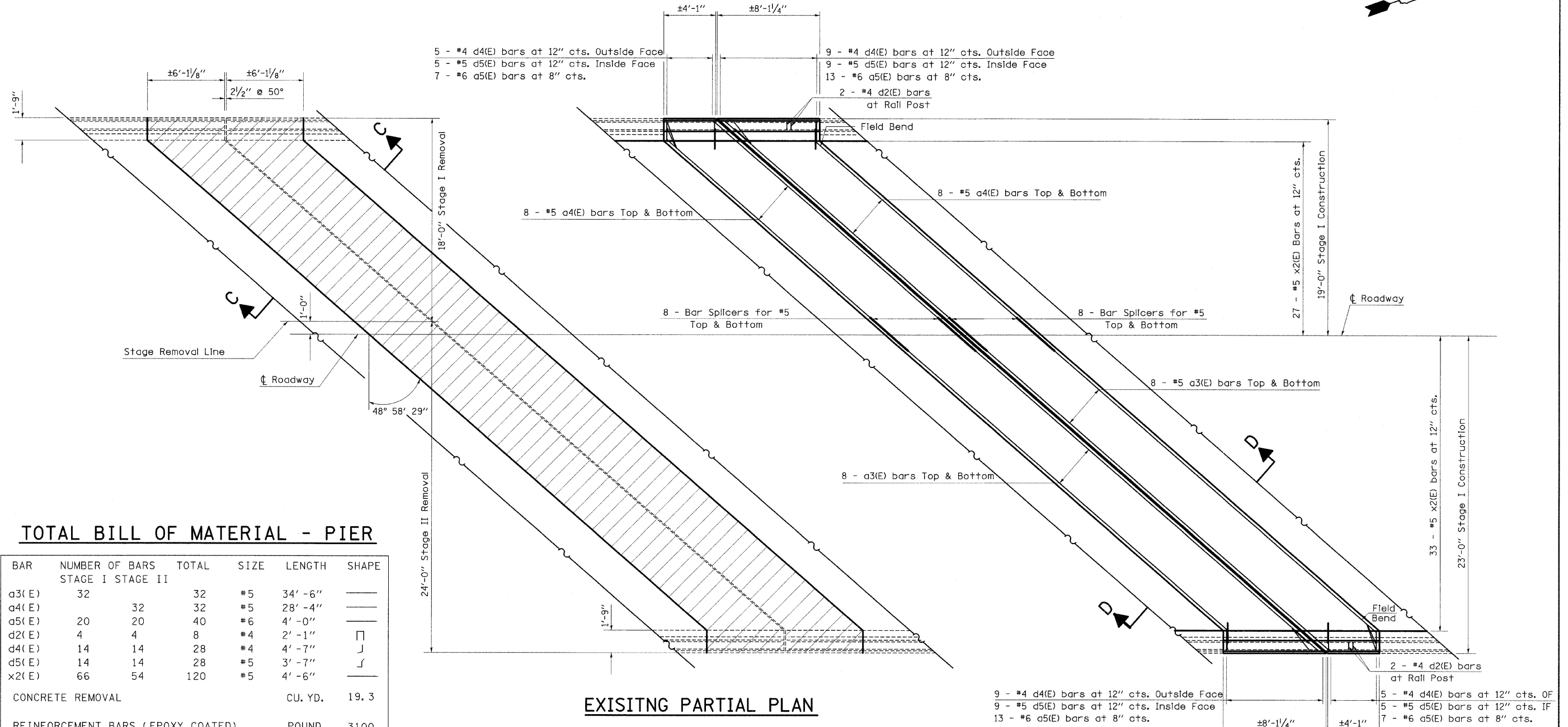

TOTAL BILL OF MATERIAL - PIER

BAR	NUMBER OF BARS		TOTAL	SIZE	LENGTH	SHAPE
	STAGE I	STAGE II				
a3(E)	32		32	#5	34' - 6"	—
a4(E)		32	32	#5	28' - 4"	—
a5(E)	20	20	40	#6	4' - 0"	—
d2(E)	4	4	8	#4	2' - 1"	□
d4(E)	14	14	28	#4	4' - 7"	J
d5(E)	14	14	28	#5	3' - 7"	J
x2(E)	66	54	120	#5	4' - 6"	—
CONCRETE REMOVAL					CU. YD.	19.3
REINFORCEMENT BARS (EPOXY COATED)					POUND	3100
CONCRETE SUPERSTRUCTURE					CU. YD.	21.9

REINFORCEMENT BARS DESIGNATED (E) SHALL BE EPOXY COATED

EXISTING PARTIAL PLAN

PROPOSED PARTIAL PLAN

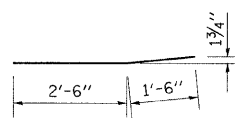

BAR a4(E)

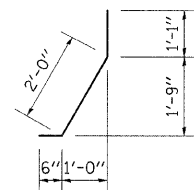

BAR d5(E)

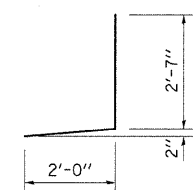

BAR d4(E)

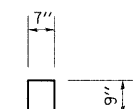

BAR d2(E)

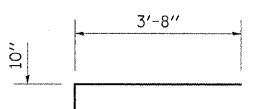

BAR x2(E)