

EXIST. CURVE CUR2  
 PI STA. = 899+20.89  
 $\Delta = 88^\circ 43' 12''$  (LT)  
 D = 4° 00' 19"  
 R = 1,430.53'  
 T = 1,398.92'  
 L = 2,215.11'  
 E = 570.32'  
 e = -----  
 T.R. = -----  
 S.E. RUN = -----  
 P.C. STA. = 885+21.97  
 P.T. STA. = 907+37.08

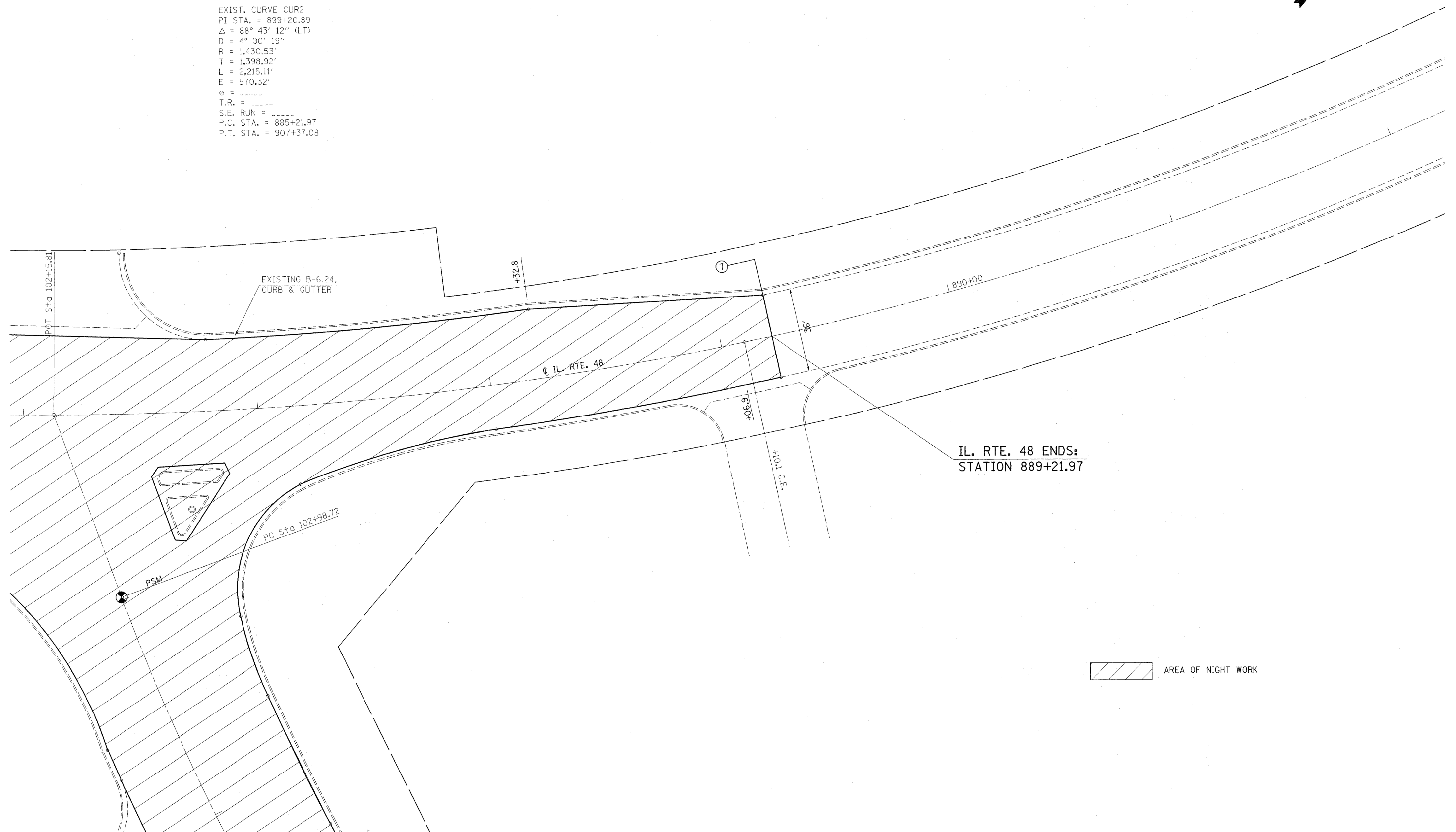
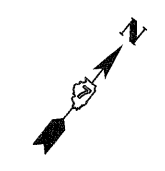

IL. RTE. 48 ENDS:  
 STATION 889+21.97

AREA OF NIGHT WORK

• (58-20)(48X-2)RS-1 & 128RS-3

FILE NAME = ct:\pw_work\PMIDOT\SMARTZRW\0146320\07	USER NAME = swartzrw 4405-sht\plan48.dgn	DESIGNED - DRAWN -	REVISED - REVISED - REVISED - REVISED -	<b>STATE OF ILLINOIS DEPARTMENT OF TRANSPORTATION</b>	<b>PLAN SHEETS IL. ROUTE 48</b>	SCALE: 20	SHEET NO. 19 OF 19 SHEETS	STA. 886+00 TO STA. 892+00	F.A.P. RTE. 714	SECTION *	COUNTY MACON	TOTAL SHEETS 100	SHEET NO. 40
PLOT SCALE = 20,000' / IN. PLOT DATE = 1/19/2010		CHECKED - DATE -		CONTRACT NO. 74405 ILLINOIS FED. AID PROJECT									