

STATE OF ILLINOIS
DEPARTMENT OF TRANSPORTATION

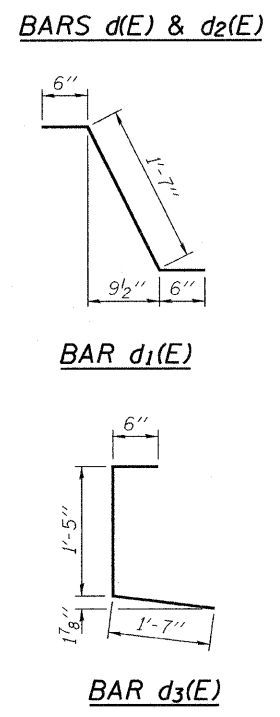
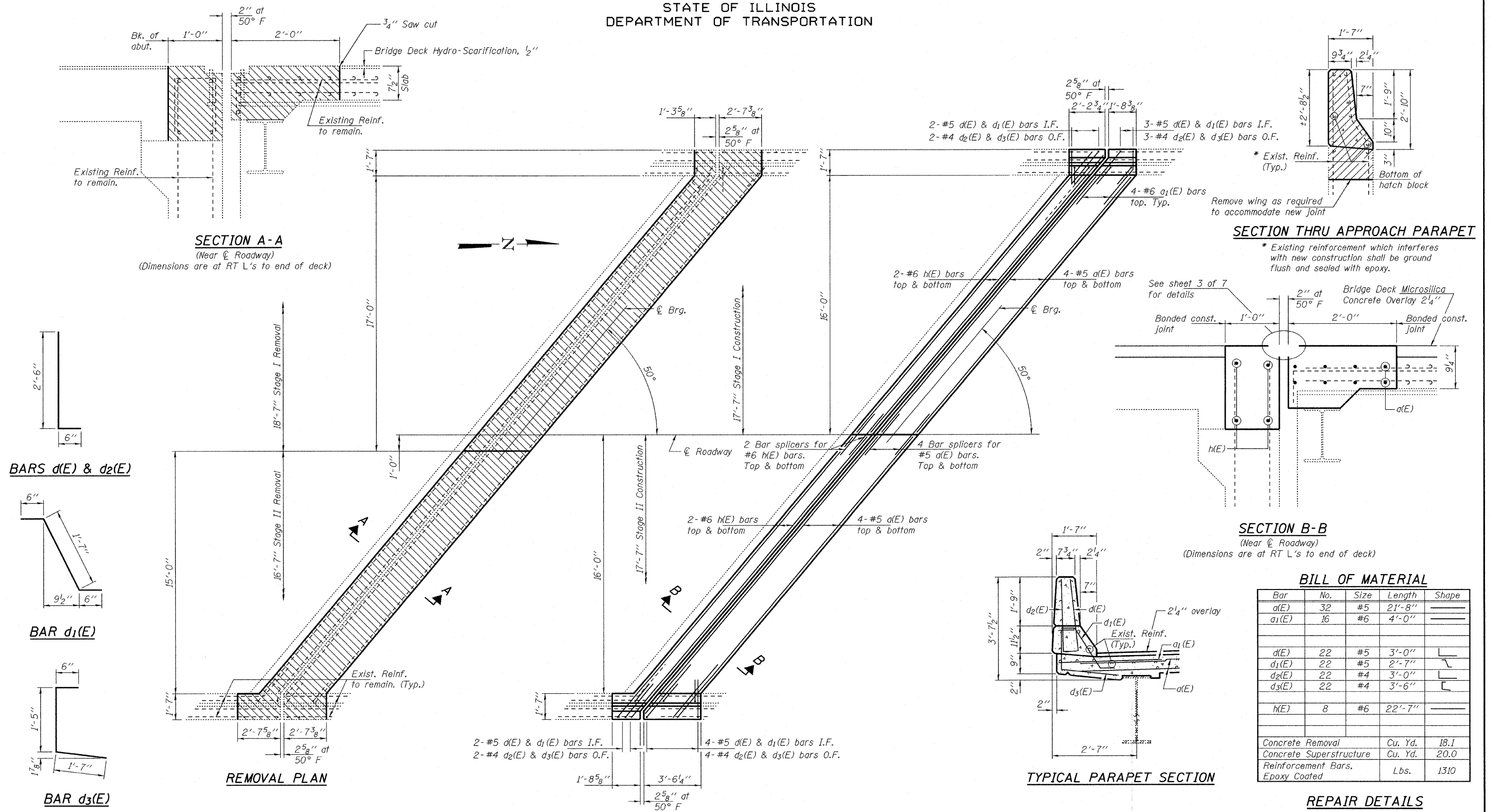

SECTION THRU APPROACH PARAPET
* Existing reinforcement which interferes with new construction shall be ground flush and sealed with epoxy.

SECTION B-B
(Near ϕ Roadway)
(Dimensions are at RT L's to end of deck)

BILL OF MATERIAL

Bar	No.	Size	Length	Shape
d(E)	32	#5	21'-8"	
a1(E)	16	#6	4'-0"	
d(E)	22	#5	3'-0"	L
d1(E)	22	#5	2'-7"	L
d2(E)	22	#4	3'-0"	L
d3(E)	22	#4	3'-6"	L
h(E)	8	#6	22'-7"	
Concrete Removal			Cu. Yd.	18.1
Concrete Superstructure			Cu. Yd.	20.0
Reinforcement Bars, Epoxy Coated			Lbs.	1310

REPAIR DETAILS
IL 33 OVER CSXT RAILROAD
SN 051-0032

DESIGNED	IJL
CHECKED	GGE
DRAWN	baliva
CHECKED	IJL GGE

MARCH 3, 2010
EXAMINED *Carl P. ...*
PASSED *Ralph E. Anderson*
ENGINEER OF STRUCTURAL SERVICES
ENGINEER OF BRIDGES AND STRUCTURES

South abutment shown.
North abutment similar by rotation.

Note:
Hatched areas indicate removal.

SHEET NO. 2 7 SHEETS	F.A.P. RTE. 783	SECTION (51-24-2,1-2)RS-1 &(1-X-1)RS-3	COUNTY LAWRENCE	TOTAL SHEETS 42	SHEET NO. 36
	CONTRACT NO. 74414				
FED. ROAD DIST. NO.		ILLINOIS FED. AID PROJECT			