

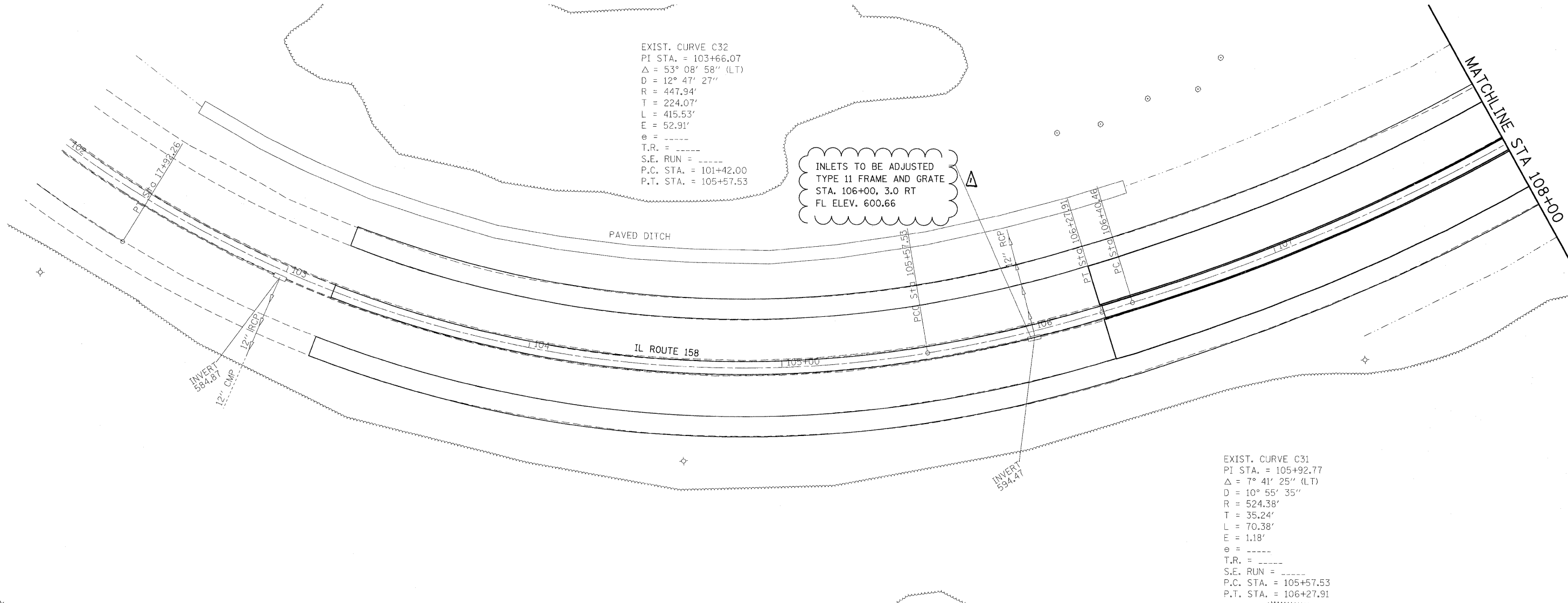

EXIST. CURVE C32
 PI STA. = 103+66.07
 $\Delta = 53^\circ 08' 58''$ (LT)
 $D = 12^\circ 47' 27''$
 $R = 447.94'$
 $T = 224.07'$
 $L = 415.53'$
 $E = 52.91'$
 $e = \text{-----}$
 T.R. = -----
 S.E. RUN = -----
 P.C. STA. = 101+42.00
 P.T. STA. = 105+57.53

INLETS TO BE ADJUSTED
 TYPE 11 FRAME AND GRATE
 STA. 106+00, 3.0 RT
 FL ELEV. 600.66



EXIST. CURVE C31
 PI STA. = 105+92.77
 $\Delta = 7^\circ 41' 25''$ (LT)
 $D = 10^\circ 55' 35''$
 $R = 524.38'$
 $T = 35.24'$
 $L = 70.38'$
 $E = 1.18'$
 $e = \text{-----}$
 T.R. = -----
 S.E. RUN = -----
 P.C. STA. = 105+57.53
 P.T. STA. = 106+27.91

MATCHLINE STA 108+00

FILE NAME =	USER NAME = owenb.j	DESIGNED -	REVISED -
cr:\pw\work\p1\dot\owenb.j\dms52558\p1\dot\26a.dgn		DRAWN -	REVISED -
PLOT SCALE = 20,0000' / IN.		CHECKED -	REVISED -
PLOT DATE = 2/5/2010		DATE -	REVISED -

**STATE OF ILLINOIS
 DEPARTMENT OF TRANSPORTATION**

DRAINAGE PLAN

SCALE:	SHEET NO. OF SHEETS	STA. TO STA.
--------	---------------------	--------------

Rev. 2-11-10

F.A.P. RTE.	SECTION	COUNTY	TOTAL SHEETS	SHEET NO.
809	67-1HBR	MONROE	144	48
FED. ROAD DIST. NO. ILLINOIS FED. AID PROJECT			CONTRACT NO. 76977	