

STATE OF ILLINOIS  
DEPARTMENT OF TRANSPORTATION

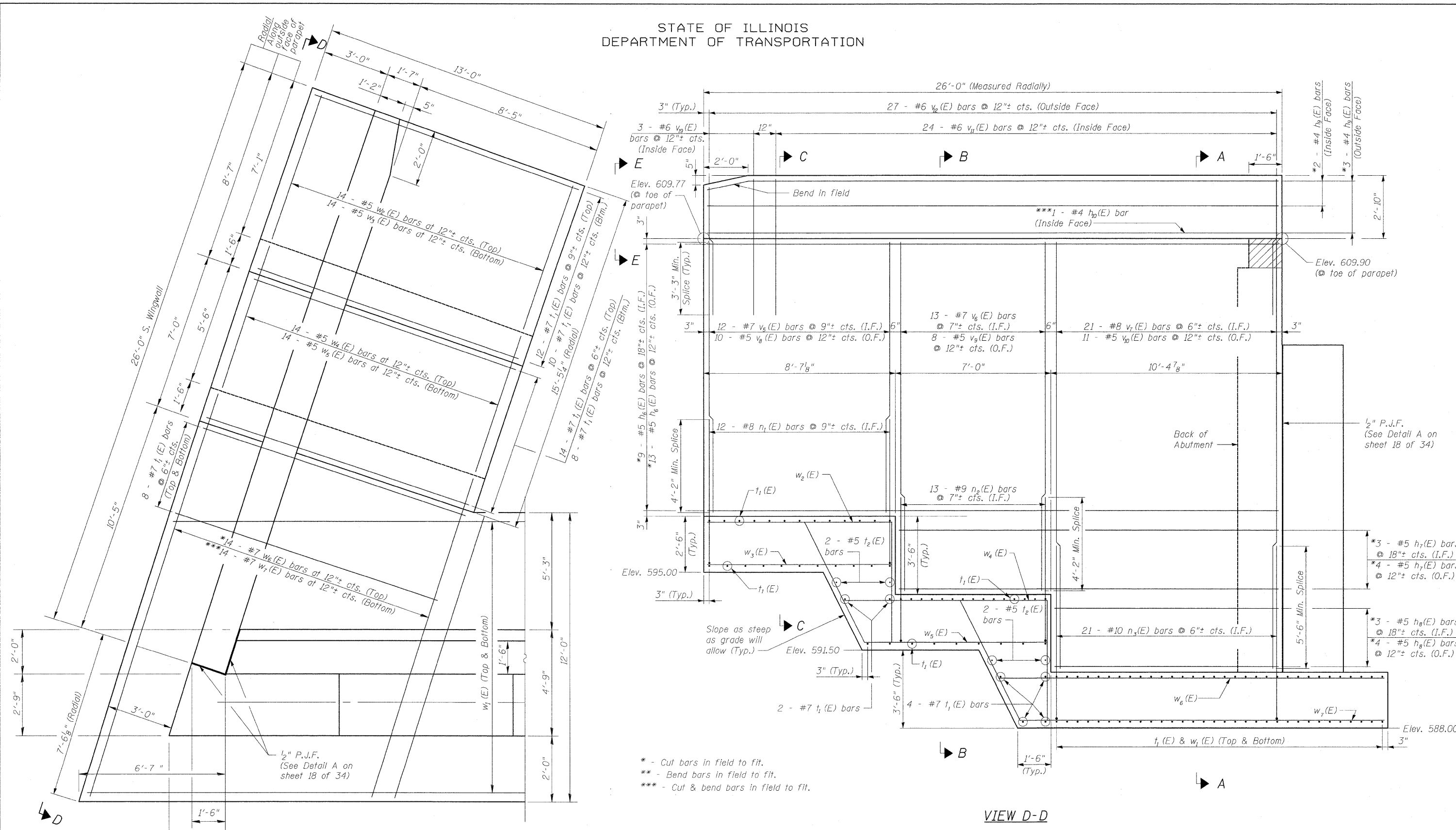

\* - Cut bars in field to fit.  
\*\* - Bend bars in field to fit.  
\*\*\* - Cut & bend bars in field to fit.

Notes:  
1. Work this sheet with sheets 18, 20 & 22 of 34.  
2. See sheet 20 of 34 for Sections A-A, B-B, C-C & E-E.  
3. I.F. - Inside Face  
4. O.F. - Outside Face  
5. Hatched area to be poured after superstructure forms have been removed. Quantity of concrete included with "Concrete Superstructures"

DESIGNED	- CCS
CHECKED	- WPM
DRAWN	- GAP
CHECKED	- CCS



PLAN

VIEW D-D

SOUTHWEST WINGWALL DETAILS I  
STRUCTURE NO. 067-0042

SHEET NO. 19 34 SHEETS	F.A.P. RTE.	SECTION	COUNTY	TOTAL SHEETS	SHEET NO.
	809	67-1HBR	Monroe	144	83
CONTRACT NO. 76977					
FED. ROAD DIST. NO. 7 ILLINOIS FED. AID PROJECT					