

PLAN
 SURVEYED
 PLOTTED
 CHECKED
 DATE
 BY

PROFILE
 SURVEYED
 PLOTTED
 CHECKED
 DATE
 BY

10-14-2009, 16:18:48 BONDHJJD
 C:\IC-WORKSPACE\BONDHJJD\VF-2044.D-TRANS.071220220866-001\CIVIL\CAD\99 ALL CONTRACTS\CONNSHEETS\CONTRACT 03\03CONN-03-SHT-DRN\11-6800.DGN

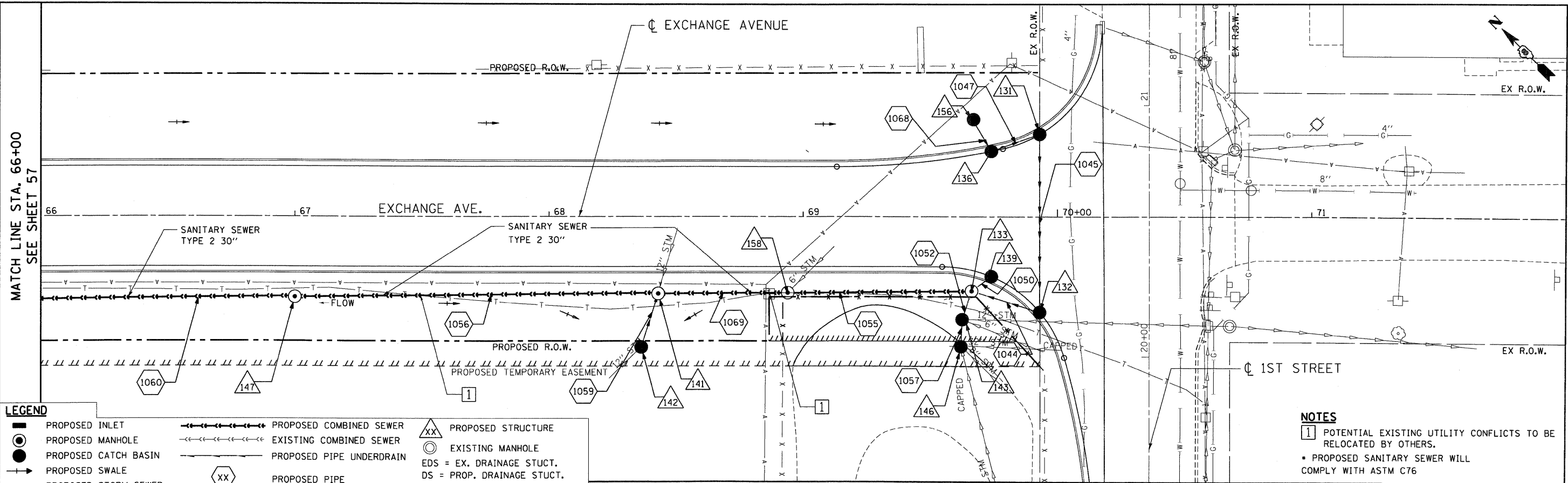

LEGEND

- PROPOSED INLET
- PROPOSED MANHOLE
- PROPOSED CATCH BASIN
- PROPOSED SWALE
- PROPOSED STORM SEWER
- PROPOSED COMBINED SEWER
- EXISTING COMBINED SEWER
- PROPOSED PIPE UNDERDRAIN
- PROPOSED PIPE
- PROPOSED STRUCTURE
- EXISTING MANHOLE
- EDS = EX. DRAINAGE STUCT.
- DS = PROP. DRAINAGE STUCT.
- CS = COMBINED SEWER

NOTES

1 POTENTIAL EXISTING UTILITY CONFLICTS TO BE RELOCATED BY OTHERS.

• PROPOSED SANITARY SEWER WILL COMPLY WITH ASTM C76

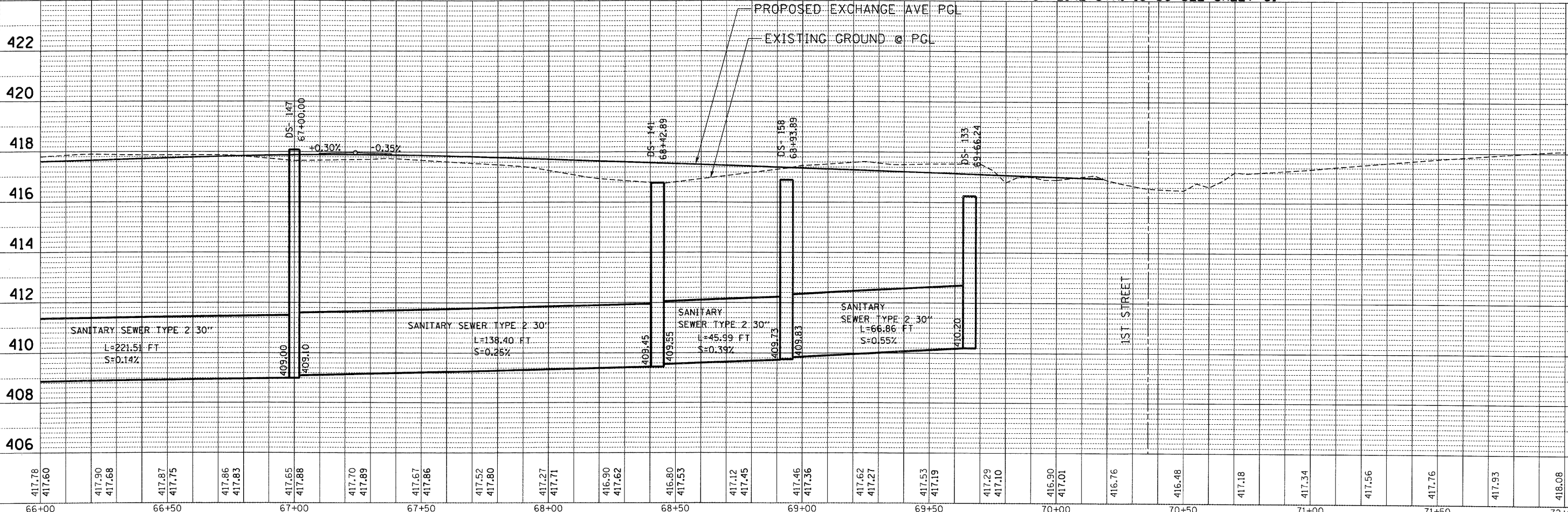

| | | | | | | | | | | | |
|--------------------|----------------------|-----------------|-----------|--|--|----------------------|---------------|---------------------|---------------------------|--------------------|--|
| FILE NAME = | USER NAME = #USER* | DESIGNED - MMCG | REVISED - | STATE OF ILLINOIS DEPARTMENT OF TRANSPORTATION I-70 CONNECTION | PROPOSED DRAINAGE PLAN & PROFILE EXCHANGE AVENUE STA. 66+00.00 TO STA. 72+00.00 | F.A.P. RTE. 9153 | SECTION 82-1K | COUNTY ST. CLAIR | TOTAL SHEETS 107 | SHEET NO. 58 | |
| #FILEL# | PLOT SCALE = #SCALE# | DRAWN - MMCG | REVISED - | | | SCALE: HORIZ. 1"=20' | VERT. 1"=2' | FED. ROAD DIST. NO. | ILLINOIS FED. AID PROJECT | CONTRACT NO. 76C40 | |
| PLOT DATE = #DATE# | DATE - 10/09/09 | CHECKED - TKL | REVISED - | | | STA. TO STA. | | | | | |
| | | DATE - 10/09/09 | REVISED - | | | | | | | | |

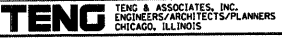

TENG & ASSOCIATES, INC.
 ENGINEERS ARCHITECTS/PLANNERS
 CHICAGO, ILLINOIS