

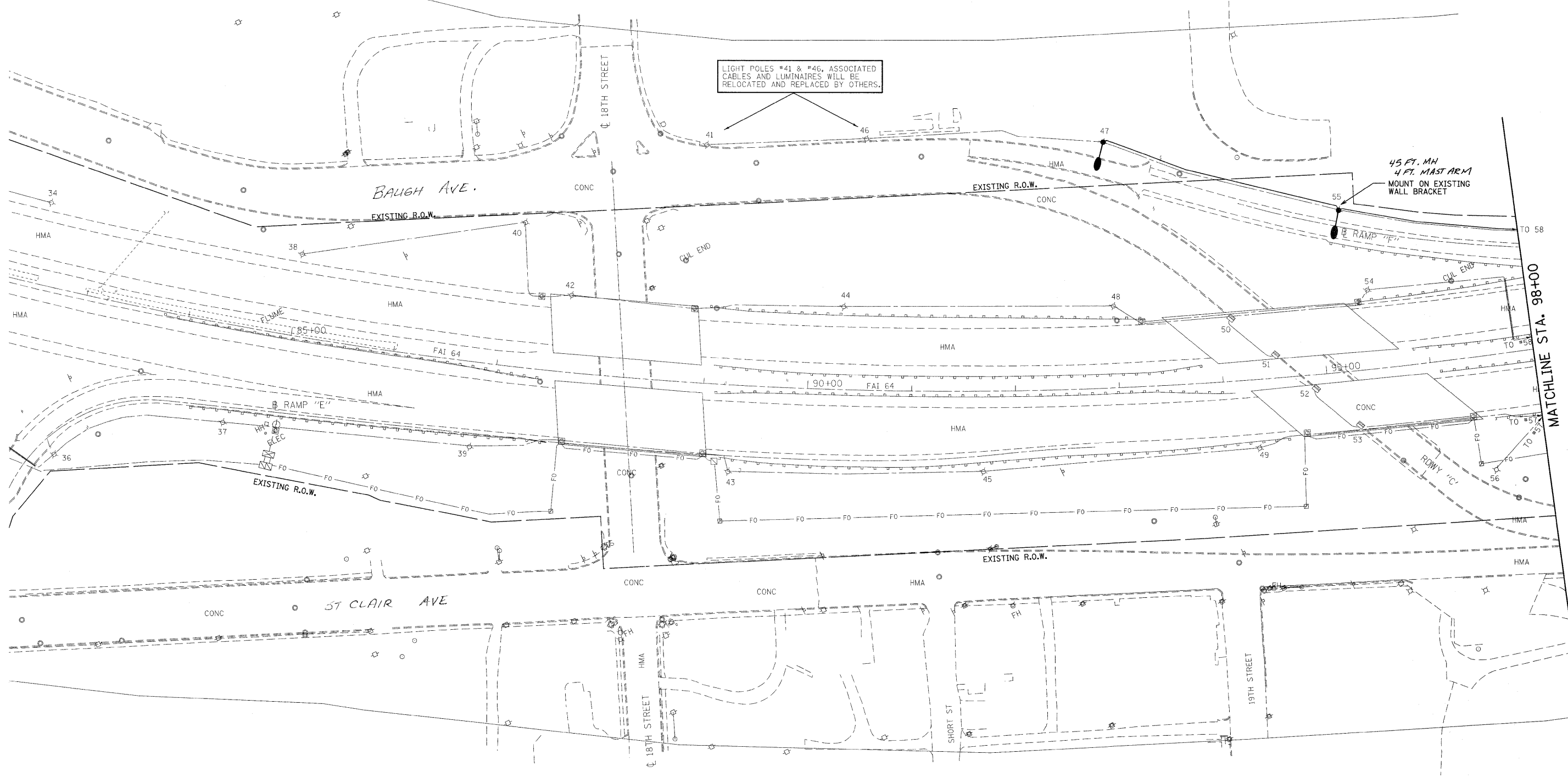

LIGHT POLES #41 & #46, ASSOCIATED CABLES AND LUMINAIRES WILL BE RELOCATED AND REPLACED BY OTHERS.

45 FT. MH
4 FT. MAST ARM
MOUNT ON EXISTING WALL BRACKET



MATCHLINE STA. 98+00

FILE NAME = c:\pwork\PWIDOT\pATELBM\d0148511\d87	USER NAME = patelbm d24-sht-light.dgn	DESIGNED - BP DRAWN - SP	REVISED - REVISED - REVISED - REVISED -	STATE OF ILLINOIS DEPARTMENT OF TRANSPORTATION	HIGHWAY LIGHTING PLAN	F.A.I. RTE. 64	SECTION 82-(1,2,3,4)I-1	COUNTY ST. CLAIR	TOTAL SHEETS 15	SHEET NO. 3
	PLOT SCALE = 50,000 ' / IN. PLOT DATE = 1/26/2010	CHECKED - DATE -	CONTRACT NO. 76D24			FED. ROAD DIST. NO.	ILLINOIS FED. AID PROJECT			
	SCALE: 1"=50'		SHEET NO. 1 OF 9 SHEETS			STA.	TO STA.			