

REMOVE EXISTING CABLES FROM CONDUIT & INSTALL NEW 3-1/2" #6 CABLE 1200' (TYP. FOR UNDERPASS LUMINAIRES)

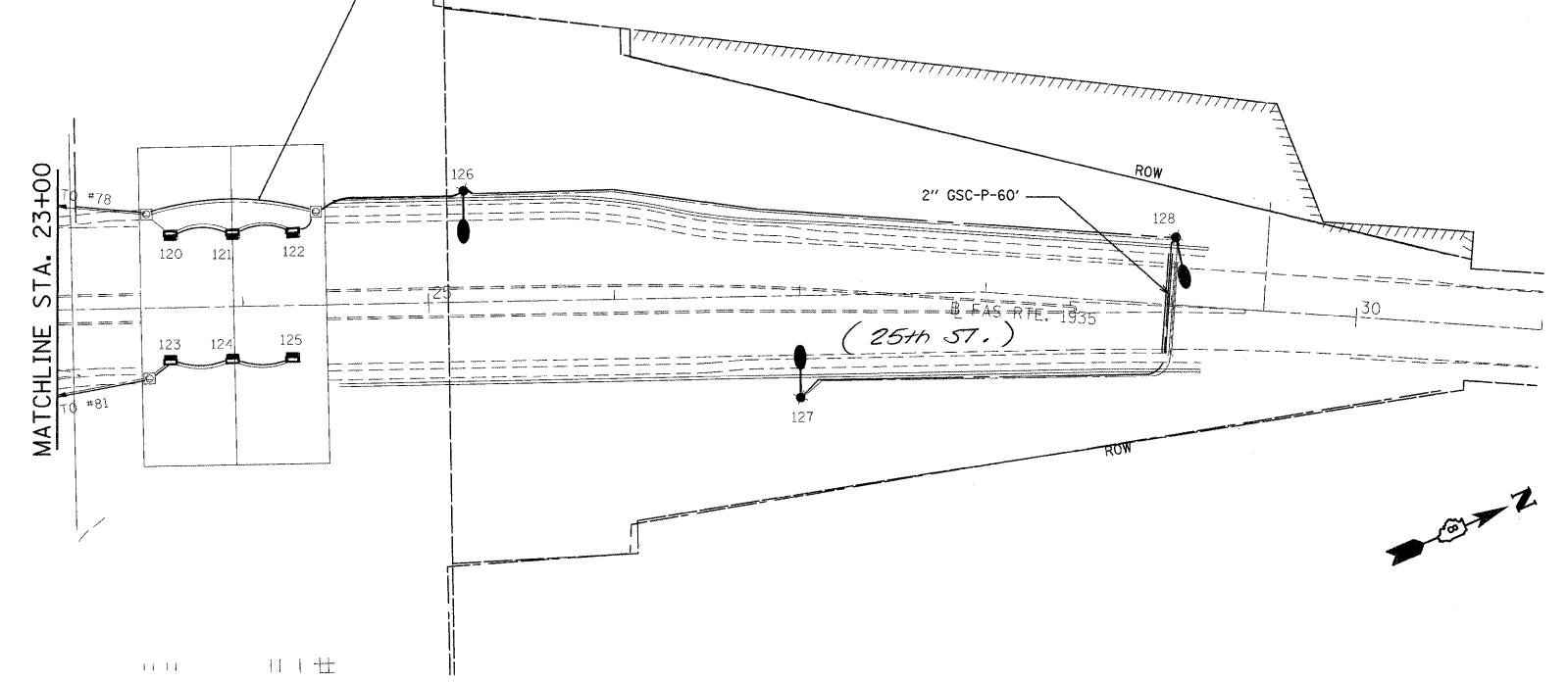

FILE NAME =	USER NAME = potelbm	DESIGNED - BP	REVISED -
ca:\pw\work\PWID001\PATELBM\d0148511\d876	24-sh1-light.dgn	DRAWN - SP	REVISED -
	PLOT SCALE = 50.0000' / IN.	CHECKED -	REVISED -
	PLOT DATE = 1/26/2010	DATE -	REVISED -

**STATE OF ILLINOIS
DEPARTMENT OF TRANSPORTATION**

HIGHWAY LIGHTING PLAN

SCALE: 1"=50' SHEET NO. 5 OF 9 SHEETS STA. TO STA.

F.A.I. RTE.	SECTION	COUNTY	TOTAL SHEETS	SHEET NO.
64	82-(1,2,3,4)I-1	ST. CLAIR	15	7
CONTRACT NO. 76D24				
FED. ROAD DIST. NO.		ILLINOIS FED. AID PROJECT		