

PROPOSED PREFORMED PLASTIC PAVEMENT MARKING
TYPE B, INLAID LINE, 4" - ABRIEVIATED SKIP DASH, WHITE

PROPOSED PREFORMED PLASTIC PAVEMENT MARKING
TYPE B, INLAID LINE, 4" - WHITE

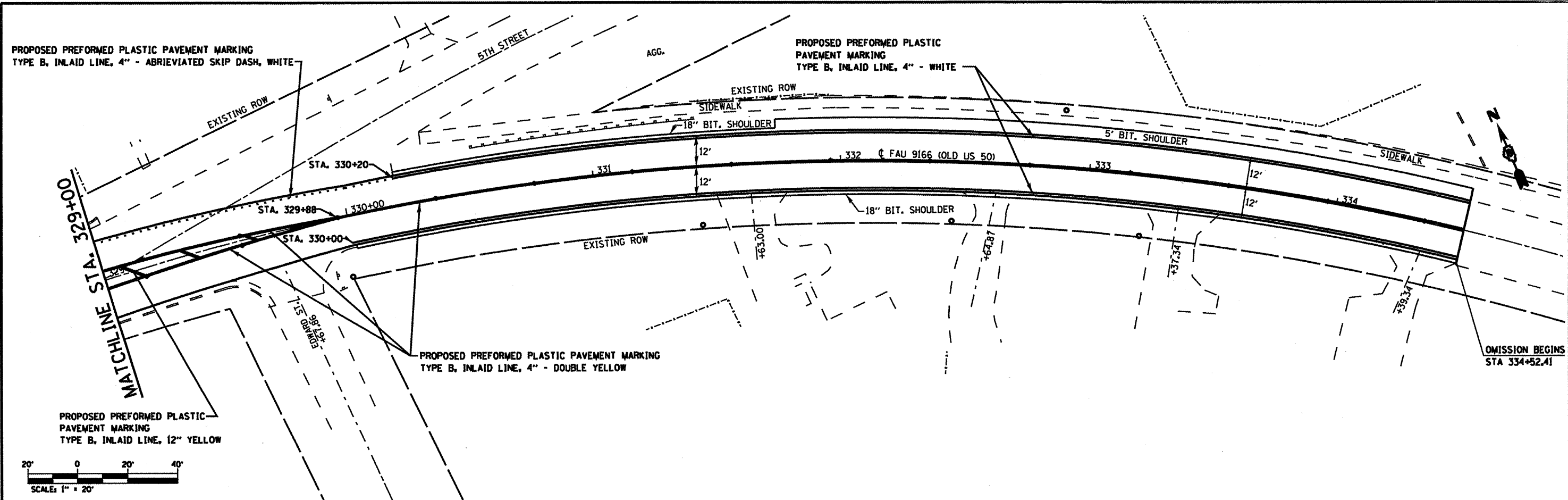

PROPOSED PREFORMED PLASTIC PAVEMENT MARKING
TYPE B, INLAID LINE, 12" YELLOW

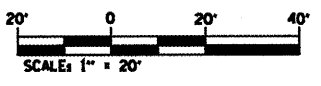

OMISSION ENDS
STA 351+90.53

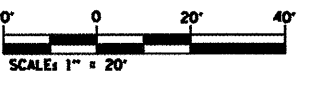
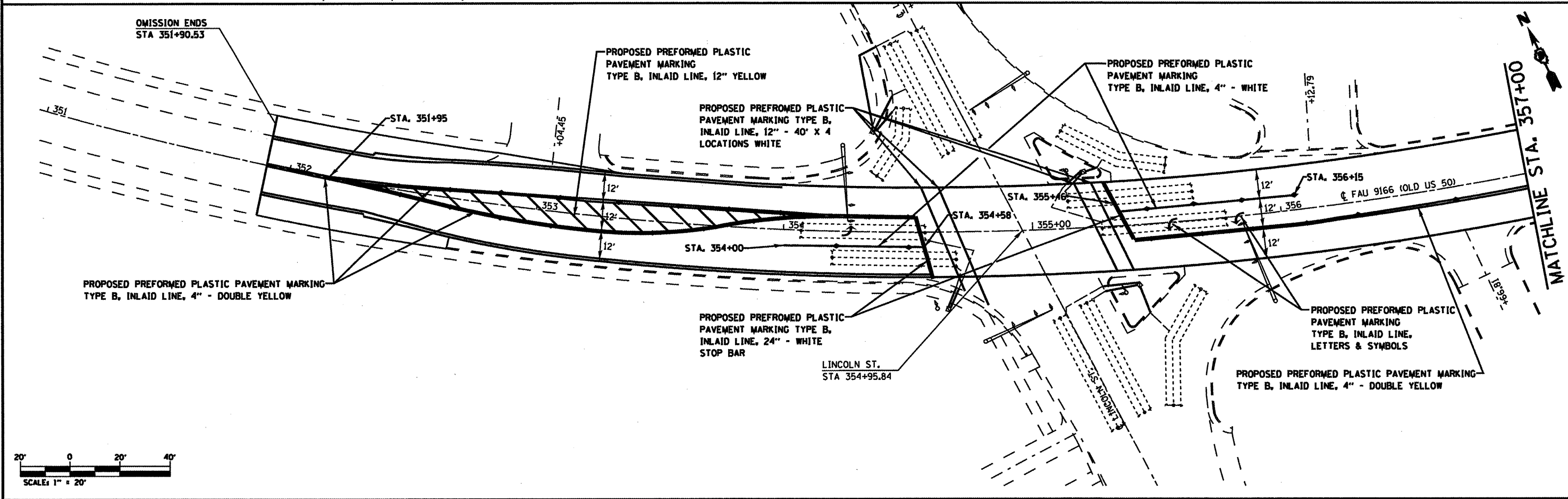

FILE NAME =	USER NAME = alfordb	DESIGNED -	REVISED -
al\p\work\pavdot\alfordb\08174224\0876\09-shc-plan.dgn		DRAWN -	REVISED -
PLOT SCALE = 48,0000' / IN.		CHECKED -	REVISED -
PLOT DATE = 3/2/2010		DATE -	REVISED -

STATE OF ILLINOIS
DEPARTMENT OF TRANSPORTATION

PAVEMENT MARKING / PLAN SHEET OLD US 50

SCALE: NONE SHEET NO. OF SHEETS

F.A.U. RTE.	SECTION	COUNTY	TOTAL SHEETS	SHEET NO.
32RS-3, 31RS-3, IRS-1		ST. CLAIR	56	27
FED. ROAD DIST. NO. ILLINOIS FED. AID PROJECT			CONTRACT NO. 76D69	