

LOOP	PHASE (Φ)	FT. X FT.	CALCULATED	CALCULATED	REQUIRED
			INDUCTANCE MICROHENRIES (μH)	RESISTANCE OHMS (Ω)	OF TURNS
1. EB CCO	6	6 X 6	238.3	1.9	5
2. EB LT CD A	1	6 X 50 0	811.1	2.2	3-6-3
3. EB LT CD B	1	6 X 50 0	794.6	1.8	3-6-3
4. EB THRU CD	6	6 X 50 0	810.6	2.2	3-6-3
5. WB CCO	2	6 X 6	347.7	2.5	6
6. WB CD	2	6 X 50 0	812.4	2.2	3-6-3
7. SB CCO	4	6 X 14	239.7	1.9	4
8. SB LT CD	4	6 X 70 0	1132.6	3.3	3-6-3
9. SB THRU CD	4	6 X 70 0	1130.7	3.2	3-6-3
10. SB RT CD	4	6 X 17 0	311.5	1.1	3-6-3

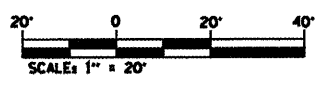
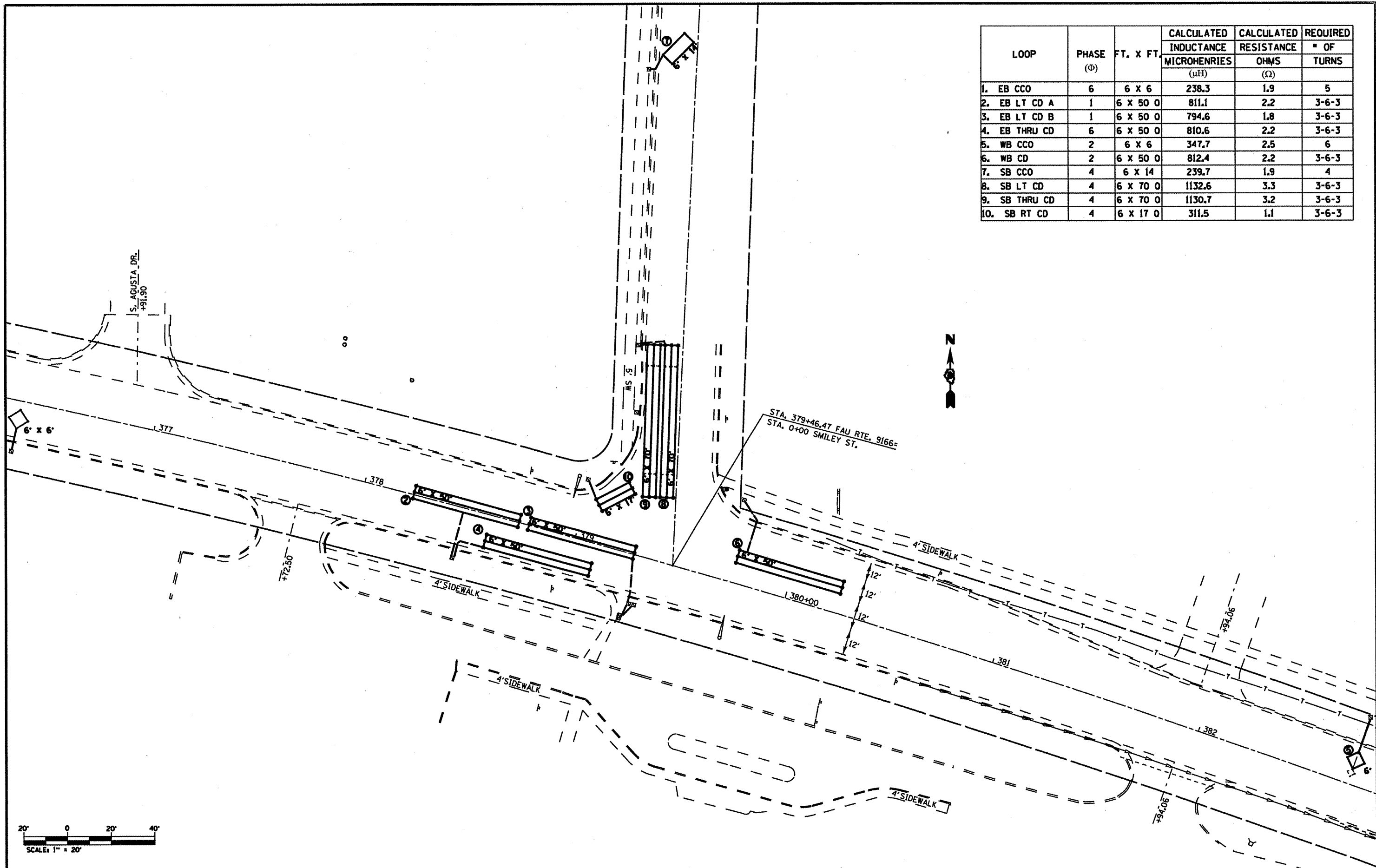

FILE NAME =	USER NAME = alfordb	DESIGNED -	REVISED -
ca\pwwork\pwwork\alfordb\174224\0876\09-shr-TSI.dgn		DRAWN -	REVISED -
PLOT SCALE = 48,0000 "/>		CHECKED -	REVISED -
PLOT DATE = 3/2/2018		DATE -	REVISED -

**STATE OF ILLINOIS
DEPARTMENT OF TRANSPORTATION**

**DETECTOR LOOP REPLACEMENT PLAN
US 50 AT SMILEY STREET**

SCALE: 1" = 20' SHEET NO. OF SHEETS

FAU RTE.	SECTION	COUNTY	TOTAL SHEETS	SHEET NO.
9166	32RS-3, 31RS-3, 1RS-1	ST. CLAIR	56	48
FED. ROAD DIST. NO.		ILLINOIS FED. AID PROJECT		
		CONTRACT NO. 76069		