

Existing Curve Data

$\Delta = 11^\circ 05'$   
 $D = 5^\circ 00'$   
 $R = 1146.28'$   
 $T = 111.2'$   
 $L = 221.7'$   
 $E = 5.38'$

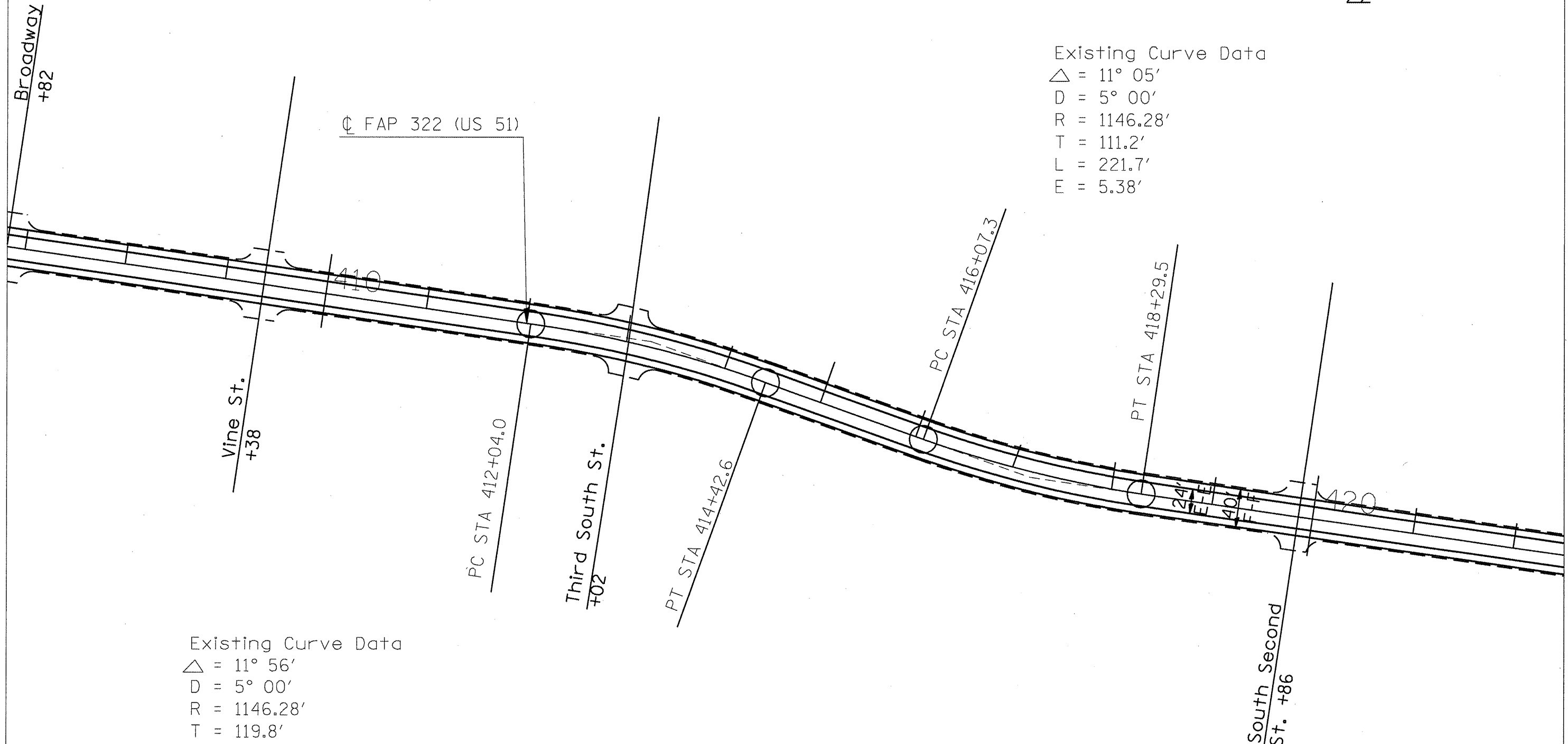

Existing Curve Data

$\Delta = 11^\circ 56'$   
 $D = 5^\circ 00'$   
 $R = 1146.28'$   
 $T = 119.8'$   
 $L = 238.6'$   
 $E = 6.24'$

NOTE:  
FOR STREETS AND ENTRANCES,  
SEE DETAIL, SHT. 34.

FILE NAME =  
c:\p\work\p\WIDOT\MCCORDKR\20169663\78

USER NAME = mccoordkr  
37-shr-plan.dgn  
PLOT SCALE = 100.0000' / IN.  
PLOT DATE = 1/25/2010

DESIGNED -	---	REVISED -	-----
DRAWN -	---	REVISED -	-----
CHECKED -	---	REVISED -	-----
DATE -	-----	REVISED -	-----

STATE OF ILLINOIS  
DEPARTMENT OF TRANSPORTATION

----- PLAN LAYOUT -----  
 STA. 406 ± 82 TO STA. 422 ± 50  
 SCALE: SHEET NO. OF SHEETS STA. TO STA.

F.A.P. RTE.	SECTION	COUNTY	TOTAL SHEETS	SHEET NO.
322	16-7185-3	PEBBY	37	21
CONTRACT NO. 78167				
ILLINOIS FED. AID PROJECT				