

**MAINTENANCE OF TRAFFIC  
TYPICAL SECTION - MAIN LINE**

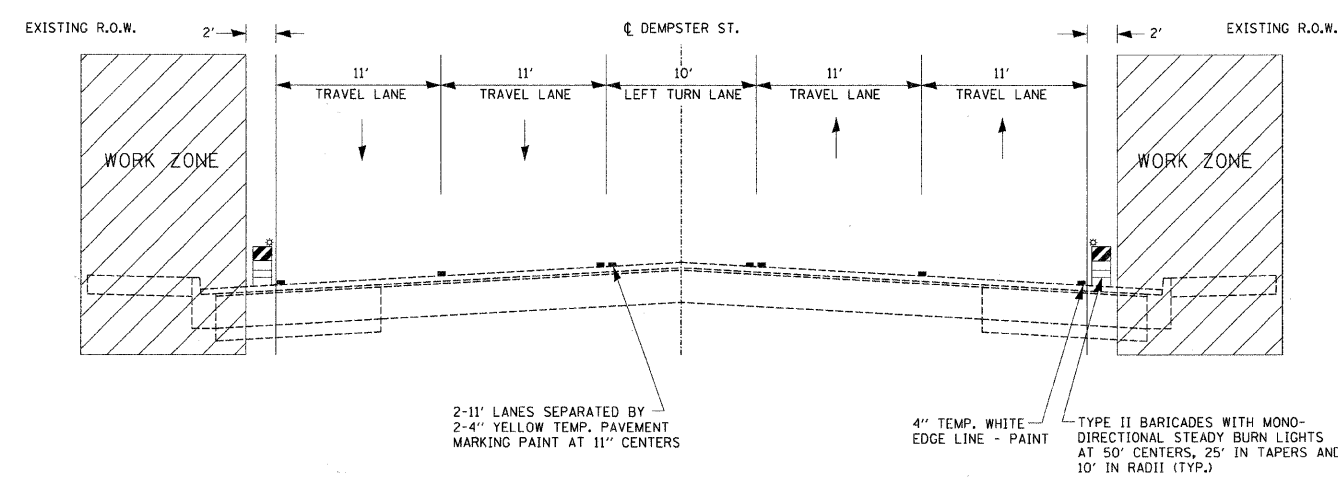

**MAINTENANCE OF TRAFFIC  
TYPICAL SECTION - SIGNALIZED INTERSECTIONS**

**CONSTRUCTION TRAFFIC CONTROL GENERAL NOTES**

1. TRAFFIC CONTROL SHALL BE PERFORMED IN ACCORDANCE WITH THE STANDARD SPECIFICATIONS FOR ROAD AND BRIDGE CONSTRUCTION, THE ILLINOIS MANUAL ON UNIFORM TRAFFIC CONTROL DEVICES AND THE APPLICABLE HIGHWAY STANDARDS OR AS HEREIN SPECIFIED.
2. THE WORK ZONE WILL BE DELINEATED AT ALL TIMES THROUGHOUT CONSTRUCTION BY TYPE II BARRICADES WITH MONODIRECTIONAL STEADY BURN LIGHTS. THE BARRICADES SHALL BE PLACED AT 50 FEET CENTERS. BARRICADES THAT MUST BE PLACED IN EXCAVATED AREAS SHALL HAVE LEG EXTENSIONS INSTALLED SUCH THAT THE TOP OF THE BARRICADE IS IN COMPLIANCE WITH THE HEIGHT REQUIREMENTS OF STANDARD 702001.
3. OPPOSING LANES OF TRAFFIC WILL BE DELINEATED AT ALL TIMES THROUGHOUT CONSTRUCTION BY TWO 4 INCHES YELLOW TEMPORARY PAVEMENT MARKING LINES AT 11 INCHES CENTERS.
4. THE COST OF FURNISHING, INSTALLING, MAINTAINING, RELOCATING AND REMOVING ALL TRAFFIC CONTROL DEVICES INCLUDING BUT NOT LIMITED TO: BARRICADES, VERTICAL PANELS, FLEXIBLE DELINEATORS, CONSTRUCTION SIGNS, WARNING LIGHTS, FLAGMEN, AND ALL OTHER MISCELLANEOUS DEVICES USED FOR THE PURPOSE OF RELOCATING OR DIRECTING TRAFFIC DURING CONSTRUCTION OF THIS IMPROVEMENT WILL BE INCLUDED IN THE CONTRACT LUMP SUM PRICE FOR EACH STANDARD AS APPLICABLE.
5. WHERE PROVIDED, EXISTING TRAFFIC SIGNS SHALL BE RELOCATED FOR EACH CONSTRUCTION STAGE.
6. ACCESS TO DRIVEWAYS AND SIDE ROADS IS TO BE MAINTAINED DURING CONSTRUCTION. ANY DELAYS OR INCONVENIENCE CAUSED BY THE CONTRACTOR BY COMPLYING WITH THESE REQUIREMENTS SHALL BE CONSIDERED AS INCIDENTAL TO THE CONTRACT AND NO ADDITIONAL COMPENSATION WILL BE ALLOWED.
7. ALL APPLICABLE PORTIONS OF TRAFFIC CONTROL STANDARDS 70101, 701301, 701602, 701701, 701801, 701901 AND IDOT DISTRICT ONE STANDARDS TC-10 AND TC-16 SHALL APPLY DURING ALL STAGES AND ALL SUB STAGES THAT ARE NOT SPECIFIED.

REVISIONS	
NAME	DATE

ILLINOIS DEPARTMENT OF TRANSPORTATION  
IL RTE 58 (DEMPSTER ST) IMPROVEMENTS  
**MAINTENANCE OF TRAFFIC  
TYPICAL SECTIONS AND NOTES**

SCALE: N.T.S. DRAWN BY: NKU  
DATE: 10-16-09 CHECKED BY: RY

**McDonough Associates Inc.**  
Engineers / Architects